

# Highland RIDGE RV

## Open Range



Serial #: 58TCM0BV5R3BD3059  
Model: 371MBH OPEN RANGE FW

Model Year: 2024 Dealer Name: LEO'S VACATION CENTER, INC  
729 ROUTE 3 NORTH  
GAMBRILLS, MD 21054  
USA

## Manufacturer's Suggested Retail Price

10233659  
\$118,082.00

TOTAL AMOUNT DOES NOT INCLUDE STATE AND LOCAL TAXES OR LICENSE FEES. THE PRICE SHOWN ABOVE MAY OR MAY NOT BE REPRESENTATIVE OF THE ACTUAL SELLING PRICE OF SIMILAR RECREATIONAL VEHICLES IN YOUR AREA.

### Standard Equipment

THE FOLLOWING ITEMS ARE STANDARD ON THIS MODEL AT NO EXTRA CHARGE

- EXTERIOR**
- 100" wide body frame
  - 2" receiver hitch
  - 3-20 lb. LP bottles
  - 50 amp service
  - ACCU-SLIDE™ slide system (42" deep 4-corner compression)
  - Battery disconnect switch
  - Brass hanger bushings with wet bolts
  - Equa-Flex® axle suspension
  - Exterior grill/griddle quick connect port
  - Frameless windows
  - Laminated block foam floor
  - LevelLoc™ - 4 or 6 point automatic leveling with JT's Strong Arms®
  - PVC roofing membrane (limited lifetime warranty)
  - Rear roof access ladder
  - Self-adjusting electric brakes
  - Spare tire
  - TuffShell™ -vacuum bonded laminated construction, reinforced with heavy-duty fiberglass and welded aluminum frames
  - Xtend Solar I Package (1-200 watt solar panel with 30 amp controller)

- INTERIOR**
- 20 cu. ft. 12V refrigerator
  - 60" x 80" residential queen bed with storage below
  - 75 lb. ball bearing drawer guides
  - Cable and satellite prep
  - Ceramic subway tile backsplash
  - Flush floor slides with residential vinyl flooring
  - Glass shower door
  - Hardwood ceiling soffit
  - Hardwood slideout fascia
  - Large freestanding oven and 3-burner range
  - LED interior lighting
  - One-piece fiberglass shower
  - Raised panel hardwood cabinet doors
  - Residential convection microwave
  - Roller day and night shades
  - Table and 4 chairs
  - Theater seating with power recline
  - USB ports in bedrooms
  - VoiceLINK™ voice command system- controls lighting, heating and cooling along with TravelLINK®
  - Wall controlled power vent (kitchen/living room area)
  - Washer/dryer prep

- FOUR SEASON PACKAGE**
- Double insulated baggage doors
  - Ducted heat to underbelly with cold air return
  - Enclosed cable operated gate valves
  - Enclosed exterior docking station with black tank flush
  - Heated and enclosed underbelly
  - High performance furnace
  - R-38 reflective foil insulation in ceiling and underbelly
  - R-9 block foam insulation in sidewalls

- EXECUTIVE PACKAGE**
- 15,000 BTU A/C with quiet residential return air-bedroom
  - 15,000 BTU A/C with quiet residential return air-main living
  - Bluetooth® ceiling speaker
  - Bluetooth® exterior speakers
  - Cutting board and sink strainer
  - Dome style digital TV antenna with Wi-Fi prep
  - Interior convenience center light
  - Keyed-Alike® entry and baggage doors
  - Motion sensor lighting in bedroom and hallway
  - Painted fiberglass front cap with LED lighting
  - Power awning with LED lighting
  - Quick recovery gas/electric water heater
  - Quick release fresh water drain
  - Residential high-rise faucet with pull-down sprayer
  - Single basin stainless steel under-mount kitchen sink
  - Smart HDTV
  - Solid swing-down entry steps
  - Solid-surface kitchen countertops
  - Stainless steel appliances
  - TravelLINK® - Smart RV system that allows for Bluetooth® control of awnings, lighting, slideouts, heating, cooling and more
  - USB/12V charging port

### Optional Equipment

OPTIONAL EQUIPMENT INSTALLED ON THIS VEHICLE BY MANUFACTURER

Base price	107,528.00
USA STANDARDS	n/c
EXECUTIVE PACKAGE	6,000.00
FOUR SEASONS PROTECTION PACKAGE	750.00
XTEND SOLAR II PACKAGE	1,343.00
NO HEAT PUMP	n/c
3RD AC 15K BTU DUCTED POWER FAN VENT BATHROOM	1,343.00
21 CU. FT. 110 VOLT REFRIGERATOR	593.00
NO GENERATOR PREP	n/c
WINDOWS STANDARD	n/c
NO PIN BOX	n/c
REAR SOFA	n/c
KING BED	525.00

UNIT TOTAL **118,082.00**

DEALER INSTALLED OPTIONS

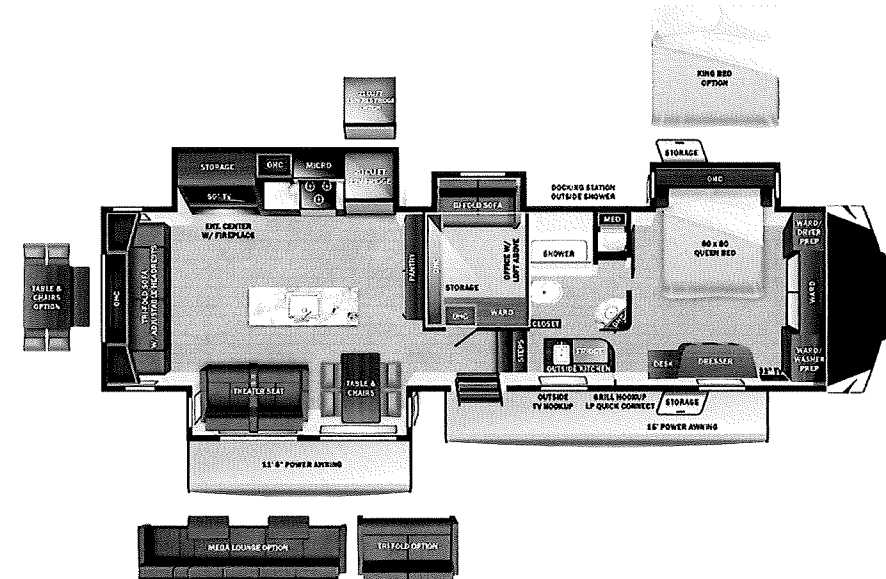

**UVW**  
13452 lbs



**Sleeps**



**Length**  
42' 4.63"

#### DIMENSIONS

Exterior height:.....159.38"  
 Exterior width:.....100.00"  
**WEIGHTS**  
 GVWR:.....15500  
 GAWR (front):.....7000  
 GAWR (rear):.....7000  
 Approx. Gross Cargo Carrying Capacity(GCCC):.....2048

#### TIRES

Tire size (front):.....ST235/85R16G  
 Tire size (mid):.....  
 Tire size (rear):.....ST235/85R16G

#### CAPACITIES

Fresh water tank (gals.):...75.00  
 Gray water tank (gals.):...80.00  
 Black water/toilet tank (gals.):.....40.00  
 Propane (lbs.):.....60  
 Propane (gals.):.....14  
 Water heater (gals.):.....10.00

#### SEATING & SLEEPING

\*\*\*Some dimensions may be rounded and may vary from the actual dimensions\*\*\*  
 \*\*\*Weights may be estimated calculations and may vary from the actual weight - refer to the vehicle weight labels for actual weights\*\*\*  
 Floorplans, features and specifications are subject to change without notice.

