

Highland RIDGE RV

Open Range



Serial #: 58TCT0BS7N3BR3111
Model: 284RLS OPEN RANGE FW

Model Year: 2022 Dealer Name: LEO'S VACATION CENTER, INC
729 ROUTE 3 NORTH
GAMBRILLS, MD 21054
USA

Manufacturer's Suggested Retail Price

07223111
\$107,117.00

TOTAL AMOUNT DOES NOT INCLUDE STATE AND LOCAL TAXES OR LICENSE FEES. THE PRICE SHOWN ABOVE MAY OR MAY NOT BE REPRESENTATIVE OF THE ACTUAL SELLING PRICE OF SIMILAR RECREATIONAL VEHICLES IN YOUR AREA.

Standard Equipment

THE FOLLOWING ITEMS ARE STANDARD ON THIS MODEL AT NO EXTRA CHARGE

- EXTERIOR**
- 100" wide body frame
 - 2" receiver hitch
 - 3-20 lb. LP bottles
 - 50 amp service
 - ACCU-SLIDE™ slide system (42" deep 4-corner compression)
 - Battery disconnect switch
 - Brass hanger bushings with wet bolts
 - Equa-Flex® axle suspension
 - Exterior grill hookup quick connect port
 - Frameless windows
 - Laminated block foam floor
 - LevelLoc™ - 4 or 6 point automatic leveling with JT's Strong Arms®
 - Marine grade exterior speakers (2)
 - PVC roofing membrane (limited lifetime warranty)
 - Rear roof access ladder
 - Self-adjusting electric brakes
 - Spare tire
 - TuffShell™ - vacuum bonded laminated construction, reinforced with heavy-duty fiberglass and welded aluminum frames
- EXECUTIVE PACKAGE**
- 13,500 BTU A/C with quiet residential return air - bedroom
 - 15,000 BTU A/C with quiet residential return air - main living
 - 76" X 28" entrance door with euro latch and swing shot screen door
 - AM/FM/HDMI/USB/AUX Bluetooth® sound bar stereo with outdoor zoned speakers
 - Cutting board and sink strainer
 - Digital TV antenna
 - Interior convenience center light
 - Keyed-Alike® entry and baggage doors
 - LED HDTV
 - Motion sensor lighting in bedroom and hallway
 - Painted fiberglass front cap with LED lighting
 - Power awning with LED lighting
 - Quick recovery gas/electric water heater
 - Quick release fresh water drain
 - Residential high-rise faucet with pull-down sprayer
 - Single basin stainless steel under-mount kitchen sink
 - Solar prep
 - Solid swing-down entry steps
 - Solid-surface kitchen countertops
 - Stainless steel appliances
 - TravelINK™ - Smart RV system that allows for Bluetooth® control of awnings, lighting, slides, heating, cooling, auto-levelers and more
 - USB/12V charging port

- INTERIOR**
- 75 lb. ball bearing drawer guides
 - 60" X 80" residential size queen bed
 - Cable and satellite prep
 - Flush floor slides with residential vinyl flooring
 - Glass shower door
 - Hardwood ceiling soffit
 - Hardwood slideout fascia
 - Hardwood valances
 - Large freestanding oven and 4-burner range
 - LED interior lighting
 - Observation camera prep
 - One-piece fiberglass shower
 - Raised panel hardwood cabinet doors
 - Residential convection microwave
 - Roller day and night shades
 - Table and chairs
 - Theater seating with heat and massage
 - USB ports in master bedroom
 - Wall controlled power vent (kitchen/living room area)
 - Washer/dryer prep
 - Wi-Fi ready
- FOUR SEASON PACKAGE**
- Double insulated baggage doors
 - Ducted heat to underbelly with cold air return
 - Enclosed cable operated gate valves
 - Enclosed exterior docking station with black tank flush
 - Heated and enclosed underbelly
 - High performance furnace
 - R-38 reflective foil insulation in ceiling and underbelly
 - R-9 block foam insulation in sidewalls

Optional Equipment

OPTIONAL EQUIPMENT INSTALLED ON THIS VEHICLE BY MANUFACTURER

Base price	96,818.00
USA Standards	n/c
Executive Package	6,000.00
Four Seasons Protection Package	750.00
RVIA	135.00
21 Cu. Ft. Refrigerator	2,393.00
No Generator Prep	n/c
No Bedroom TV	n/c
Windows Standard	n/c
Power Fan Vent Wall Control (Bathroom)	375.00
BBQ Grill	203.00
No Pin Box	n/c
2 Additional Dinette Folding Chairs	443.00

UNIT TOTAL **107,117.00**

DEALER INSTALLED OPTIONS:

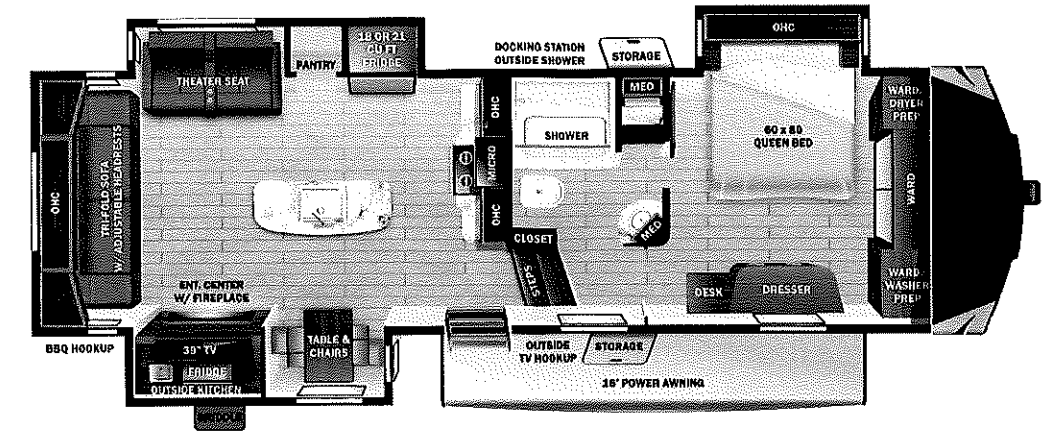

UVW
10561 lbs



Sleeps
Up to 6



Length
34' 3.38"

DIMENSIONS

Exterior height:	154.50"
Exterior width:	100.00"
WEIGHTS	
GVWR:	12500
GAWR (front):	6000
GAWR (rear):	6000
Approx. Gross Cargo Carrying Capacity(GCCC):	1939

TIRES

Tire size (front):	ST235/80R16E
Tire size (mid):	
Tire size (rear):	ST235/80R16E

CAPACITIES

Fresh water tank (gals.):	75.00
Gray water tank (gals.):	97.00
Black water/toilet tank (gals.):	40.00
Propane (lbs.):	60
Propane (gals.):	14
Water heater (gals.):	10.00

SEATING & SLEEPING

Queen Bed:	60 X 80
------------	---------

Some dimensions may be rounded and may vary from the actual dimensions
Weights may be estimated calculations and may vary from the actual weight - refer to the vehicle weight labels for actual weights
Floorplans, features and specifications are subject to change without notice.

