

OUTBACK

PREMIUM TRAVEL TRAILERS • ULTRA-LITE TRAVEL TRAILERS

2021
FALL
UPDATES



LIVE IT OUT.



MODERN FARMHOUSE GETS A REFRESH AND NEW FLOOR PLANS

Outback, Keystone's luxury travel trailer brand, ups the ante again on their oh-so-cool interior style and the addition of 5 new innovative floor plans. Beginning with fall production, Outback models will be updated with a lighter wallboard and new white countertops for a more open and airy feel. While staying true to their modern farmhouse inspiration the brand has also selected slightly more refined flooring, furniture, cabinet hardware and fascia options.

New & Noteworthy

- All new graphics package with black and gold accents
- Coleman-Mach Quiet Series™ A/C will offer campers a significant reduction of in-cabin sound levels
- Upgraded 10 cu. ft. 12V GE refrigerator with an 8 cu. ft. gas/electric option
- ZAMP solar power prep with port for solar panels on roof and side
- Astro-foil barrier added to the fully enclosed underbelly with ducted heat to further extend the camping season
- Laminated rear walls added to units without rear slides/ramps
- Rear ladder with walkable roof added to Outback Ultra-lite models (Previously available only on full-sized Outbacks)
- Added washer/dryer prep to select models (328RL, 330RL, 332ML, 341RD)

blade

HIGH-PERFORMANCE AIR FLOW SYSTEM



BLADE™ HIGH PERFORMANCE AIR HANDLING SYSTEMS

Engineered to maximize the output from today's high-performance RV air conditioners, Keystone's NEW patented air handling system delivers an average of 20% more cooling power and is built to withstand the rigors of the road. The Blade™ system is designed to accelerate air flow, eliminate leakage and failure points, deliver 360° circulation in the cabin, and withstand environmental and road stressors that lead to reduced performance.

ELEMENTS™ CLIMATE CONTROL PACKAGE

- Astro-foiled fully heated and enclosed underbelly
- Coleman-Mach® "the quiet series" air conditioner
- Race track dual-ducted A/C system.
- Vented attic space



ELEMENTS

CLIMATE CONTROL PACKAGE

PREMIUM | OUTBACK TRAVEL TRAILER FLOORPLANS

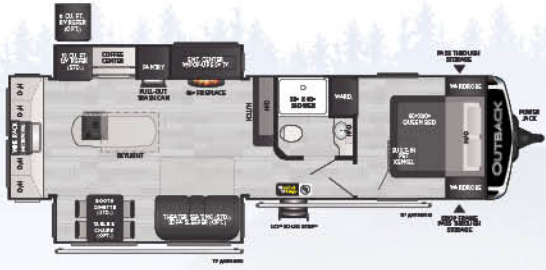

300ML | Mid-living room, two slides, kitchen island

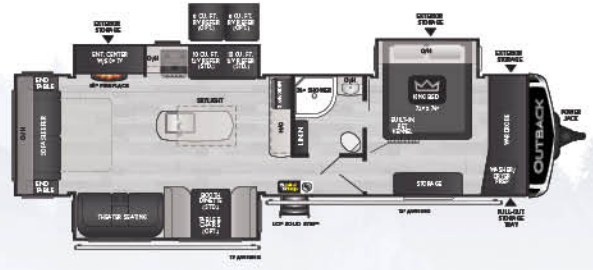

328RL | Rear living, three slides, double refrigerator



330RL | Rear living, three slides, outside kitchen

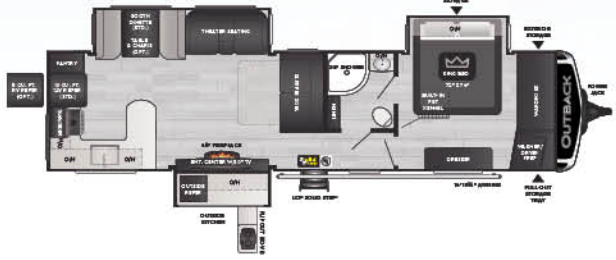

NEW! **332ML** | Mid-living, three slides, outside kitchen



335CG | Cargo garage, two slides, outside kitchen

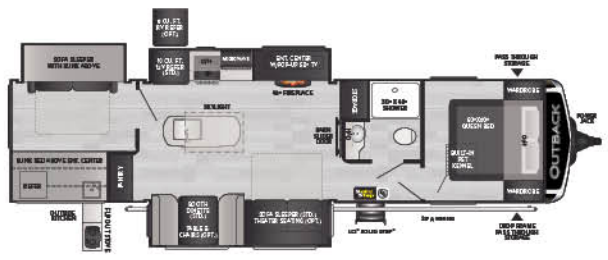

340BH | Burkhouse, three slides, outside kitchen

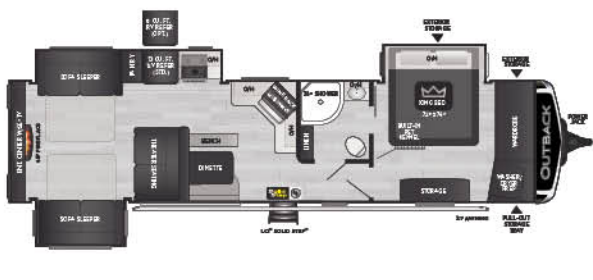

341RD | Rear den entertainment, three slides, 55" TV



NEW! **342CG** | Cargo garage, two slides, wheelchair accessible

ULTRA-LITE | OUTBACK TRAVEL TRAILER FLOORPLANS

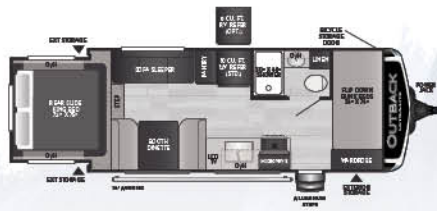

210URS | Rear bedroom slide, double bunks, king bed

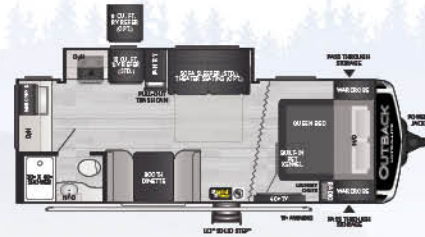

221UMD | Mid-dinette, rear bath, queen bed



240URS | Rear bedroom slide, cargo garage, king bed



NEW! **244URB** | Double over double bunks, rear cargo door, outside kitchen



252URS | Rear slide, hidden pantry, extra large bathroom



260UML | Mid-living room, rear kitchen, large pantry

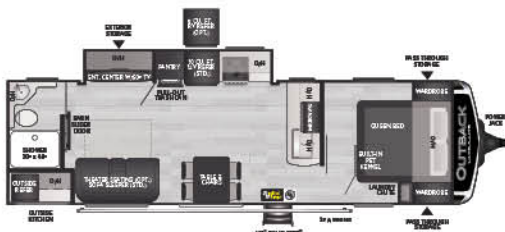

280URB | Rear bath, mid-living, outside kitchen

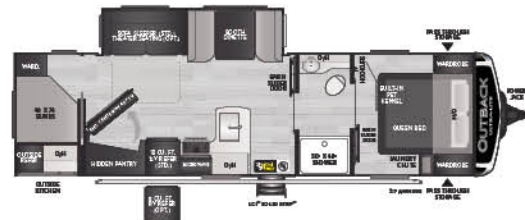

291UBH | Bunkhouse, hidden pantry, outside kitchen

ULTRA-LITE | OUTBACK TRAVEL TRAILER FLOORPLANS

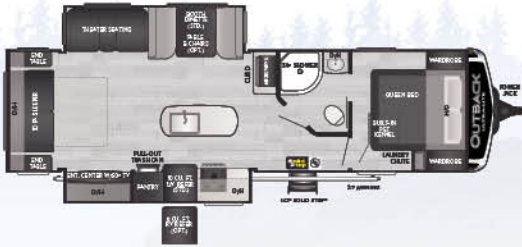

NEW! 292URL | Rear living, kitchen island, large pantry



301UBH | Rear-slide bunkhouse, 1 1/2 bath, outside kitchen



NEW! 302UBH | Rear bunkhouse, fireplace, outside kitchen

OUTBACK | MODEL SPECIFICATIONS

PREMIUM TRAVEL TRAILERS

MODEL	WEIGHT	CARRYING CAPACITY	HITCH WEIGHT	FRESH WATER	WASTE WATER	GRAY WATER	LPG	LENGTH*	WIDTH	HEIGHT	AWNING
300ML	8040	1460	1050	60	38	76	60	34' 9"	8'	11' 2"	11'/11'
328RL	8767	1733	1075	60	38	76	60	37' 7"	8'	11' 4"	11'/13'
330RL	8839	1661	1100	60	38	76	60	37' 7"	8'	11' 4"	13'
332ML	8580	1920	1015	60	38	76	60	37' 10"	8'	11' 4"	21'
335CG	8228	2272	1155	60	38	76	60	37'	8'	11' 4"	21'
340BH	8787	1713	1040	60	38	76	60	38' 6"	8'	11' 4"	20'
341RD	8425	2075	1045	60	38	76	60	38' 1"	8'	11' 4"	21'
342CG	TBD	TBD	TBD	60	38	76	60	38' 0"	8'	11' 4"	21'

ULTRA-LITE TRAVEL TRAILERS

MODEL	WEIGHT	CARRYING CAPACITY	HITCH WEIGHT	FRESH WATER	WASTE WATER	GRAY WATER	LPG	LENGTH*	WIDTH	HEIGHT	AWNING
210URS	4670	1830	485	60	30	30	60	23' 0"	8'	11' 1"	14'
221UMD	4971	2229	600	60	30	30	60	27' 0"	8'	11' 1"	19'
240URS	5189	2401	590	60	30	30	60	28' 3"	8'	11' 1"	20'
244URB	5650	2020	670	60	30	60	60	28' 11"	8'	11' 1"	21'
252URS	6245	1495	745	60	30	60	60	29' 7"	8'	11' 1"	21'
260UML	5912	1688	600	60	30	60	60	30' 6"	8'	11' 1"	21'
280URB	6004	1596	650	60	30	60	60	32' 6"	8'	11' 1"	21'
291UBH	6601	1599	655	60	30	60	60	33' 8"	8'	11' 1"	21'
292URL	TBD	TBD	TBD	60	30	60	60	33' 11"	8'	11' 1"	21'
301UBH	7134	2366	900	60	60	60	60	34' 9"	8'	11' 2"	20'
302UBH	7010	2490	930	60	30	60	60	34' 10"	8'	11' 2"	21'

DISCLAIMER: Product information is as accurate as possible as of the date of publication of this brochure. All features, floor plans, and specifications in this brochure are subject to change without notice. Please also consult Keystone's web site at www.keystonerv.com for more current product information and specifications. Tow Vehicle Disclaimer. CAUTION: Owners of Keystone recreational vehicles are solely responsible for the selection and proper use of tow vehicles. All customers should consult with a motor vehicle manufacturer or their dealer concerning the purchase and use of suitable tow vehicles for Keystone products. Keystone disclaims any liability or damages suffered as a result of the selection, operation, use or misuse of a tow vehicle. KEYSTONE'S LIMITED WARRANTY DOES NOT COVER DAMAGE TO THE RECREATIONAL VEHICLE OR THE TOW VEHICLE AS A RESULT OF THE SELECTION, OPERATION, USE OR MISUSE OF THE TOW VEHICLE. *Length is defined as the distance from the centerline of hitch pin/coupler to rear bumper of trailer. Please review owner's manual prior to purchase for more information on service warranties, extended use, towing and maintenance. Owner's manuals can be found at keystonerv.com.