

PRODUCT PRESENTATION – GCKS395



**GENESIS
SUPREME**

- **SUNSATION® Exterior Wall Laminate for Extreme UV Resistance and Color Stability**
- **102" Wide-Body Design**
- **12" I-Beam Chassis**
- **Flat Floor Wall-to-Wall / No Wheel Wells**
- **16" Deluxe Aluminum Alloy Wheels**
- **40" Living Room TV & Electric Fireplace w/Heat**
- **Optional 32" Bedroom TV**
- **Bedroom Slideout w/Vanity & Wardrobe**
- **3-Season Door/Glass Panel**
- **Garage Entertainment Center w/30" Fireplace**
- **On-Board Air Compressor/Tank Option**
- **Power Awning w/LED Light Strip**



The Journey Begins...

GCKS395 — EXTERIOR

102" Wide-Body, 16" Aluminum Alloy Wheels, Optional On-Board Air



GCKS395 — FLOORPLAN & SPECS

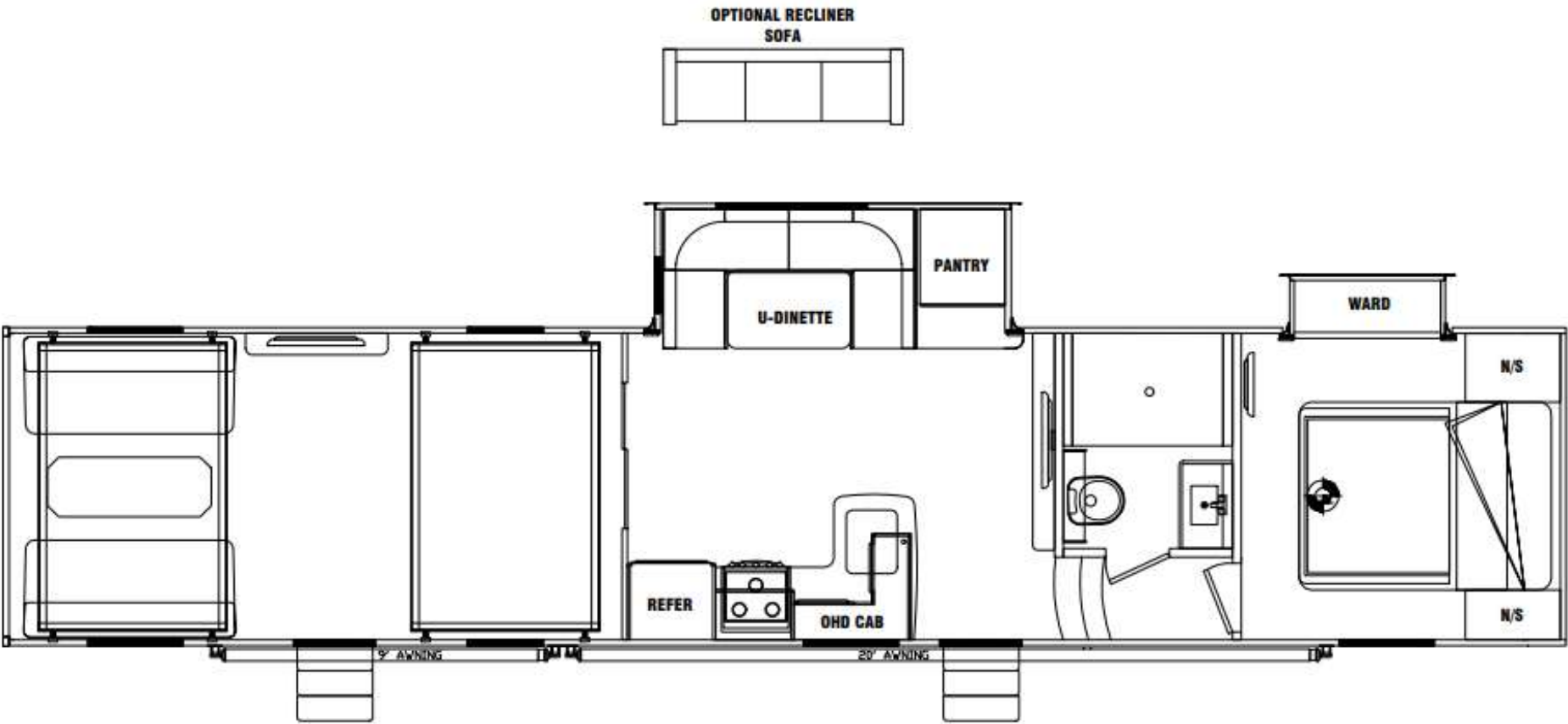

All product data, graphics, and photography in this document were as accurate as possible at time of publication. Subsequent refinements during the model year may be evident in the actual product. Genesis Supreme reserves the right to change colors, material, equipment and specifications without notice, and to add, modify or discontinue models shown in promotional materials. Standard/Optional Features and Specs may change without notice. Photographs of interiors & exteriors depicted on this website are strictly representational - colors, materials, appliances, fabrics, etc. may vary or change without notice. Unloaded vehicle weight and carrying capacity capacities will vary depending on optional equipment. Dry weight is measured from standard build and will vary with options. Weight of water, LP gas, fuel and options are not included in Cargo Capacity payload.

UNIT SPECS	
	VCKS395
OVERALL LENGTH	42'-4"
GVWR (lbs)	18,000
DRY WEIGHT (lbs)	13,987
HITCH WEIGHT (lbs)	2,952
AXLE WEIGHT (lbs)	11,035
AXLE CAPACITY (lbs) (Triple)	7,000
CARGO CAPACITY (lbs)**	4,013
TIRE SIZE	16
FRESH WATER (GAL)	160
BLACK TANK (GAL)	50
GRAY TANK(GAL)	50/40
Note: Weights may change due to options added.	

- 12" I-Beam (Chassis)
- Two (2) Rear Stab Jacks
- 160 Gallons Fresh Water
- 50 Gallon Black
- 40 Gallon Gray - Galley
- 50 Gallon Gray - Shower
- 102" Wide-Body Design
- Integrated Rear Spoiler
- Dual 30-LB Propane Tanks
- Extra-Large Windows (Radius & Tinted) & Valances
- 30K Furnace
- Power Awning w/LED Light Strip 20'
- 9' Second Side Awning
- Slide Out w/U-Shape Dinette Pantry
- Short Leg Happi-Jack® w/Upper Bed Only
- Bedroom Slideout
- Spray Away®
- 26" Front & Rear Entry Doors
- Exterior Metal Diamond Plate Skirting
- Plumbed for Exterior LP Hookup
- Triple 9" Radius Entry Door Step
- Seamless One-Piece PVC Roof
- Key Hooks
- 12V Powered Fan Lavy Roof Vents
- Upgraded Galley Fan w/ Remote
- LED Interior Lighting Throughout
- Tie Downs in Garage Area
- 10 Cu. Ft. 12V Refrigerator
- AM/FM/CD/DVD Player w/4 Inside/2 Outside Speakers
- 21" Three-Burner Stove w/Oven & Rangehood
- 40" Living Room TV w/Fireplace
- Garage Entertainment Center w/30"
- Ceramic Toilet
- Upgraded Galley Fan w/Remote
- Exterior Ladder
- Three-Season Door & Glass Panel to Garage
- TV Antenna w/Cable & Satellite Hook-Up

➤ **EZ-Flex® Suspension**

➤ **Tool Box**

➤ **Rear Power Patio Awning**

➤ **Hydraulic Jacks**

➤ **Wireless Backup Camera**

➤ **Central Vacuum System**

➤ **Recliner Sofa IPO U-Shaped Dinette**

➤ **Winterized**

➤ **50" Living Room TV IPO 40"**

➤ **32" Bedroom TV**

➤ **Full Happi-Jac® w/4 Chairs**

➤ **Short Leg Happi-Jac® w/Sofa & 2 Chairs**

➤ **Double Insulated Roof**

➤ **Upgraded Lavy Fan w/Remote**

➤ **Upgraded Bedroom Fan w/Remote**

➤ **Arctic Package**

➤ **Entertainment Center w/50" TV & Fireplace (Garage)**

Power & Cooling Upgrade Package

Includes: 6.0KW Yamaha Generator Upgrade

(3) Hi Efficiency 13.5K BTU Bedroom/Ducted Galley/Rear AC w/ Wall Control -
50-Amp Service

Premier Package (Forced Option)

Aluminum-Framed, Hi-Gloss Laminated Fiberglass Sidewalls

Stylish Fiberglass Front Cap

10-Gallon Gas Water Heater

Sewer Hose Storage Compartment

Exterior Lights – Security (4), Rear (2), Front (2)

LED Exterior Running Lights & Taillights

Supreme Package (Forced Option)

7000 Lb. Triple Axles with 16" Wheels/Load Range G Tires

40-Gallon Fuel Station

External 110V Electrical Outlets

Spare Tire & Carrier

Arctic Package

Includes: Heated, Enclosed Tanks/Valves

Reflected Floor Insulation

Heat Ducting System For Furnace

Double Ceiling Insulation

Deluxe Package (Forced Option)

48x36 Shower w/Glass Door

Galley Sink w/Faucet

Deluxe Shower Head

.6 Cu. Ft. Microwave

USB 12V Chargers (2 - Garage, 1 - Bedroom)

Black Roller Shades Throughout

Solid Surface Galley Countertop w/Covers

Happi-Jac® w/Upper Bed and Opposing Dinette (Rear)

RV King Mattress w/ Coordinated Bedspread

Beautifully-Appointed Interior, Well-Equipped & Functional



Slideout U-Dinette



Garage Entertainment Center



Happi-Jac w/Upper Bed



Dual Euro Swivel/Rockers



Living Room Entertainment Center

Interior Features



Short Leg Happi-Jac (Upper Bed Above)



Dual Facing Dinette w/Table

Interior Features



*3-Season Door/Glass Panel
(View from Living Room to Garage)*



*3-Season Door/Glass Panel
(View from Garage to Living Room)*

Interior Features



*Media Storage/Control Center
w/40" TV*



Slideout Pantry



Slideout Overhead Storage



30" Living Room Electric Fireplace



*Convenient Control
& Monitor Center*

Efficient, Well-Appointed Galley w/Generous Storage



Bedroom w/Walkaround King Bed / Slideout w/Wardrobe & Vanity





*48X36 Fiberglass Shower
w/Glass Door*



Stainless Sink/Designer Fixtures



Generous Storage



GCKS395 — EXTERIOR OPTIONS & FEATURES



Pass-Thru Storage



Onan 5.5KW Generator



40-Gallon Fuel Station



1500W Inverter



Spray-Away



Exterior TV Hookups & Bracket



Tool Box



"Arctic" Package



*Exterior Folding Ladder
& Walk-On Roof*

GCKS395 — Exterior Features & Options



Triple Radius Entry Door Step



*7000 Lb. Triple Axles w/16\"
Wheels & LR G Tires*



Patented Spoiler/Wireless Backup Camera



Optional On-Board Air Compressor

GCKS395

Thank you – please contact us & visit our website!



Genesis Supreme RV
23129 Cajalco Road
Perris, CA 92570
(951) 337-0254
genesissupremerv.com



The Journey Begins...