

WESTERN

# SPRINGDALE

TRAVEL TRAILERS • FIFTH WHEELS



**KEYSTONE**  
RV COMPANY

**LIVE IT OUT.**

WESTERN

# SPRINGDALE

TRAVEL TRAILERS • FIFTH WHEELS



**KEYSTONE**  
RV COMPANY

**LIVE IT OUT.**

# SPRINGDALE



SPRINGDALE | TRAVEL TRAILERS | FIFTH WHEELS

## MAKE EVERY WEEKEND MATTER

For the past 20 years, Keystone Springdale has been building quality RVs for weekend family adventures big and small. From single-axle minis to a wide selection of travel trailer floorplans to spacious fifth wheel camping, the 2021 Springdale models introduce new, unexpected features designed to make it more enjoyable than ever to get outside. Fresh new interior design, loads of windows and natural light, power stabilizer jacks, WiFi prep, and family-sized fresh water capacity are just a handful of delightful innovations owners will find in their new Springdale.

For more information, please visit [keystonerv.com/Springdale](https://www.keystonerv.com/Springdale)

# SPRINGDALE



SPRINGDALE | TRAVEL TRAILERS | FIFTH WHEELS

## MAKE EVERY WEEKEND MATTER

For the past 20 years, Keystone Springdale has been building quality RVs for weekend family adventures big and small. From single-axle minis to a wide selection of travel trailer floorplans to spacious fifth wheel camping, the 2021 Springdale models introduce new, unexpected features designed to make it more enjoyable than ever to get outside. Fresh new interior design, loads of windows and natural light, power stabilizer jacks, WiFi prep, and family-sized fresh water capacity are just a handful of delightful innovations owners will find in their new Springdale.

For more information, please visit [keystonerv.com/Springdale](https://www.keystonerv.com/Springdale)

# KEYSTONE EXCLUSIVE INNOVATIONS

Designed to deliver superior performance, quality, and a best-in-class camping experience, every Springdale model includes engineering innovations available EXCLUSIVELY to Keystone owners. For more information about these features and the Keystone Innovation Lab, visit us online at [www.keystonerv.com/innovations](http://www.keystonerv.com/innovations).



## 3-YEAR LIMITED STRUCTURAL WARRANTY, 1-YEAR LIMITED BASE WARRANTY

Every new Keystone RV comes with the industry's best three-year limited structural warranty AND a one-year limited base warranty. Ask your dealer, visit [keystonerv.com](http://keystonerv.com), or call Keystone Owner Relations for details.



### Blade™ High-Performance Air Flow System

Blade™ is designed to accelerate air flow, eliminate leakage and failure points, and deliver 360° circulation.



### 4G LTE and Wi-Fi Prep

All units are equipped with a new antenna that integrates 4G LTE and Wi-Fi with standard VHF/UHF/AM/FM reception.



### Color-Coded Unified Wiring Standard

Easy-to-trace circuits simplify electrical and entertainment system troubleshooting.



### In-floor Heating Ducts

Distributes heat evenly through your coach for superior comfort.



### Tuf-Lok™ A/C Duct Joiners

Crush resistant design securely joins ductwork and A/C units, and drastically reduces chilled-air leaks to boost cooling efficiency and comfort.



### Tru-fit™ Slide Construction

A more durable slide room design that minimizes functional motor and structural stress and resists leaking.

# KEYSTONE EXCLUSIVE INNOVATIONS

Designed to deliver superior performance, quality, and a best-in-class camping experience, every Springdale model includes engineering innovations available EXCLUSIVELY to Keystone owners. For more information about these features and the Keystone Innovation Lab, visit us online at [www.keystonerv.com/innovations](http://www.keystonerv.com/innovations).



## 3-YEAR LIMITED STRUCTURAL WARRANTY, 1-YEAR LIMITED BASE WARRANTY

Every new Keystone RV comes with the industry's best three-year limited structural warranty AND a one-year limited base warranty. Ask your dealer, visit [keystonerv.com](http://keystonerv.com), or call Keystone Owner Relations for details.



### Blade™ High-Performance Air Flow System

Blade™ is designed to accelerate air flow, eliminate leakage and failure points, and deliver 360° circulation.



### 4G LTE and Wi-Fi Prep

All units are equipped with a new antenna that integrates 4G LTE and Wi-Fi with standard VHF/UHF/AM/FM reception.



### Color-Coded Unified Wiring Standard

Easy-to-trace circuits simplify electrical and entertainment system troubleshooting.



### In-floor Heating Ducts

Distributes heat evenly through your coach for superior comfort.

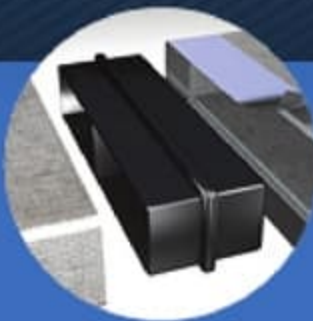

### Tuf-Lok™ A/C Duct Joiners

Crush resistant design securely joins ductwork and A/C units, and drastically reduces chilled-air leaks to boost cooling efficiency and comfort.



### Tru-fit™ Slide Construction

A more durable slide room design that minimizes functional motor and structural stress and resists leaking.



more product detail at  
[www.keystonerv.com/Springdale](http://www.keystonerv.com/Springdale)



## INTERIORS

This year Springdale was revamped from top to bottom. The new interior features soft gray oak cabinetry, lighter vinyl flooring throughout and a white washed brick accent wall. You'll also enjoy more natural light from the added fully-operable, extra large windows.





more product detail at  
[www.keystonerv.com/Springdale](http://www.keystonerv.com/Springdale)



## INTERIORS

This year Springdale was revamped from top to bottom. The new interior features soft gray oak cabinetry, lighter vinyl flooring throughout and a white washed brick accent wall. You'll also enjoy more natural light from the added fully-operable, extra large windows.







## THE MAGIC IS IN THE DETAILS

We've added an all-new modern black kitchen sink with a stainless steel rolling drying rack.



## FUNCTIONAL STORAGE IN CREATIVE PLACES

We've included so much more storage throughout each floorplan to maximize each space.





## THE MAGIC IS IN THE DETAILS

We've added an all-new modern black kitchen sink with a stainless steel rolling drying rack.



## FUNCTIONAL STORAGE IN CREATIVE PLACES

We've included so much more storage throughout each floorplan to maximize each space.



# blade

HIGH-PERFORMANCE AIR FLOW SYSTEM



## BLADE™ HIGH PERFORMANCE AIR HANDLING SYSTEMS

Engineered to maximize the output from today's high-performance RV air conditioners, Keystone's NEW patented air handling system delivers an average of 20% more cooling power and is built to withstand the rigors of the road. The Blade™ system is designed to accelerate air flow, eliminate leakage and failure points, deliver 360° circulation in the cabin, and withstand environmental and road stressors that lead to reduced performance.

\*Not available on single axle models

## WINEGARD AIR 360+ OMNIDIRECTIONAL ANTENNA

With 360° VHF/UHF/FM signal reception and signal amplification, the combination of the Air 360+ and KeyTV provides Keystone RV owners with the most reliable, easiest to operate over-the-air entertainment package in the industry.



# blade

HIGH-PERFORMANCE AIR FLOW SYSTEM



## BLADE™ HIGH PERFORMANCE AIR HANDLING SYSTEMS

Engineered to maximize the output from today's high-performance RV air conditioners, Keystone's NEW patented air handling system delivers an average of 20% more cooling power and is built to withstand the rigors of the road. The Blade™ system is designed to accelerate air flow, eliminate leakage and failure points, deliver 360° circulation in the cabin, and withstand environmental and road stressors that lead to reduced performance.

\*Not available on single axle models

## WINEGARD AIR 360+ OMNIDIRECTIONAL ANTENNA

With 360° VHF/UHF/FM signal reception and signal amplification, the combination of the Air 360+ and KeyTV provides Keystone RV owners with the most reliable, easiest to operate over-the-air entertainment package in the industry.



## MODERN AMENITIES

From USB ports and storage nets to magnetic knife strips in the kitchen Springdale makes family camping so much more practical.

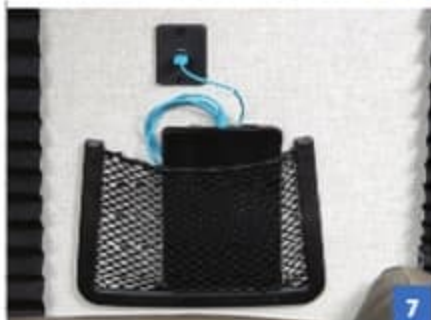

### 1. POWER STABILIZER JACKS

With the push of two buttons, your camper can be stabilized in seconds.

### 2. VAULTED CEILINGS

6"10" clearance in the center of the trailer allows for more head room and an open feeling.

### 3. MAGNETIC KNIFE/TENSIL BLOCK

Will hold and organize your knives and cooking utensils while not taking up valuable drawer space.

### 4. FIREPLACE\*

Can be used as another heat source or to just create a nice calm ambiance. Our fireplace offers several different heat and glow settings.

### 5. OPERABLE WINDOWS THROUGHOUT

All of Springdale's windows can open or close based on the customers desire for fresh air.

### 6. DOUBLE BEDROOM SHELF

Double shelf equals double the storage. It's that simple.

### 7. STORAGE NETS THROUGHOUT

Large storage nets are located near each USB port for convenient storage of all your devices while charging.

### 8. LCI SOLIDSTEPS®

An absolute must have in a camper. Our LCI SolidSteps provide stable footing for young and old alike.

### 9. DO-MORE DINETTE TABLE

The most versatile dinette table on the market. Take it anywhere inside or outside for your convenience.

# MODERN AMENITIES

From USB ports and storage nets to magnetic knife strips in the kitchen Springdale makes family camping so much more practical.



**1. POWER STABILIZER JACKS**

With the push of two buttons, your camper can be stabilized in seconds.

**2. VAULTED CEILINGS**

6"10" clearance in the center of the trailer allows for more head room and an open feeling.

**3. MAGNETIC KNIFE/UTENSIL BLOCK**

Will hold and organize your knives and cooking utensils while not taking up valuable drawer space.

**4. FIREPLACE\***

Can be used as another heat source or to just create a nice calm ambiance. Our fireplace offers several different heat and glow settings.

**5. OPERABLE WINDOWS THROUGHOUT**

All of Springdale's windows can open or close based on the customers desire for fresh air.

**6. DOUBLE BEDROOM SHELF**

Double shelf equals double the storage. It's that simple.

**7. STORAGE NETS THROUGHOUT**

Large storage nets are located near each USB port for convenient storage of all your devices while charging.

**8. LCI SOLIDSTEPS®**

An absolute must have in a camper. Our LCI SolidSteps provide stable footing for young and old alike.

**9. DO-MORE DINETTE TABLE**

The most versatile dinette table on the market. Take it anywhere inside or outside for your convenience.

\*Select Models

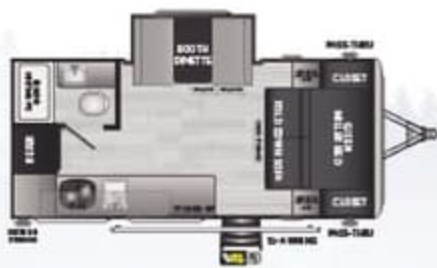

**NEW!** **T740RK** | Rear kitchen, incredible countertop space, Miller bed



**T750RD** | Rear dinette, w/ panoramic view



**T760BH** | Single axle, bunkhouse w/ dinette slide



**T790FQ** | Couple's coach, dinette slide room, large bathroom



**1800BH** | #1 Selling floorplan, bunkhouse



**1860SS** | Large slide room w/ pantry/wardrobe combo

**SPRINGDALE** | SINGLE AXLE TRAVEL TRAILER FLOORPLANS

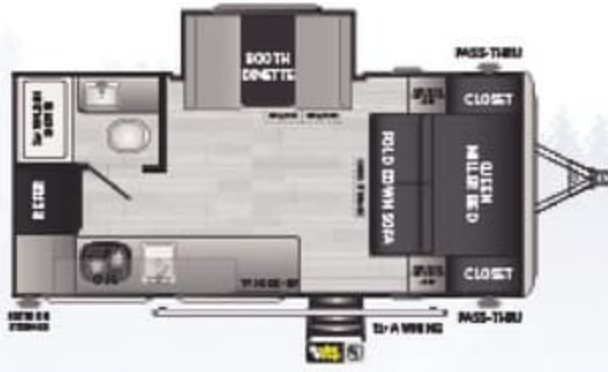

**NEW! 1740RK** | Rear kitchen, incredible countertop space, Miller bed



**1750RD** | Rear dinette, w/ panoramic view



**1760BH** | Single axle, bunkhouse w/ dinette slide



**1790FQ** | Couple's coach, dinette slide room, large bathroom



**1800BH** | #1 Selling floorplan, bunkhouse



**1860SS** | Large slide room w/ pantry/wardrobe combo





**179QBWE** | Rear dinette, panoramic view



**202QBWE** | Rear dinette, panoramic view



**220BHWE** | Double bunks, outdoor kitchen



**222RDWE** | Rear dinette and sofa w/panoramic view



**240BHWE** | Small slide, double bunks, outdoor kitchen



**179QBWE** | Rear dinette, panoramic view



**202QBWE** | Rear dinette, panoramic view



**220BHWE** | Double bunks, outdoor kitchen



**222RDWE** | Rear dinette and sofa w/panoramic view



**240BHWE** | Small slide, double bunks, outdoor kitchen



**242RKWE** | Small slide, rear kitchen, dual entry bath



**260TBWE** | Double bunks, lightweight



**271RLWE** | Rear living, built for entertaining



**280BHWE** | Large slide, walk-in pantry, double bunks

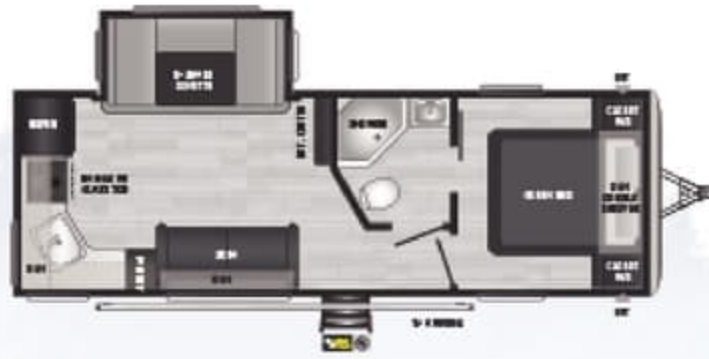

**242RKWE** | Small slide, rear kitchen, dual entry bath



**260TBWE** | Double bunks, lightweight

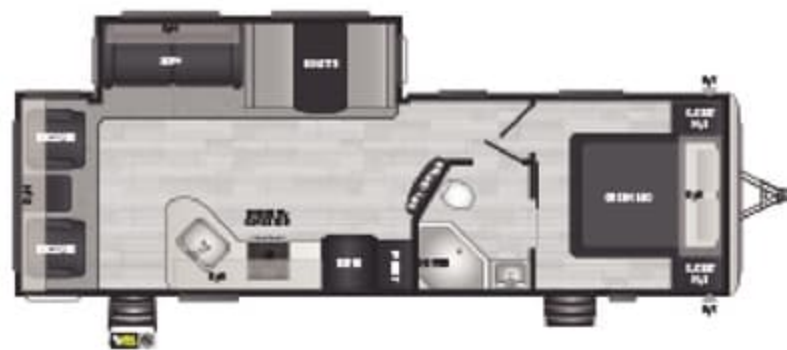

**271RLWE** | Rear living, built for entertaining



**280BHW** | Large slide, walk-in pantry, double bunks



**282BHWE** | Large slide, double entry, double bunks



**295BHWE** | Double-over-double w/ ultimate closet and pantry, outdoor kitchen



**298BHWE** | Large slide, quad bunks, outside kitchen



**335BHWE** | Bath & a half, ultimate bunkhouse w/ fireplace, large walk-in pantry

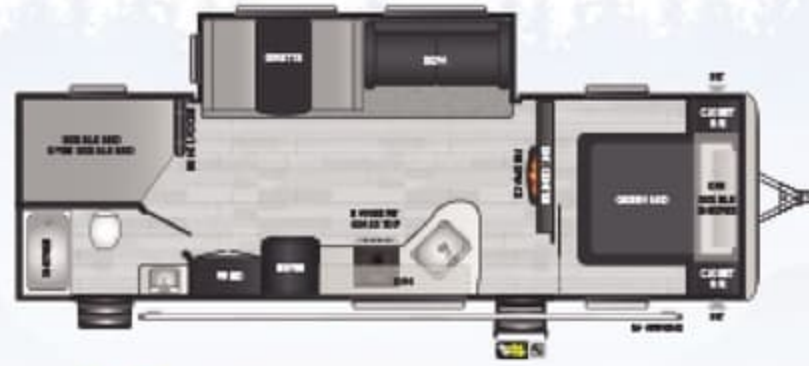

**282BHWE** | Large slide, double entry, double bunks



**295BHWE** | Double-over-double w/ ultimate closet and pantry, outdoor kitchen



**298BHWE** | Large slide, quad bunks, outside kitchen

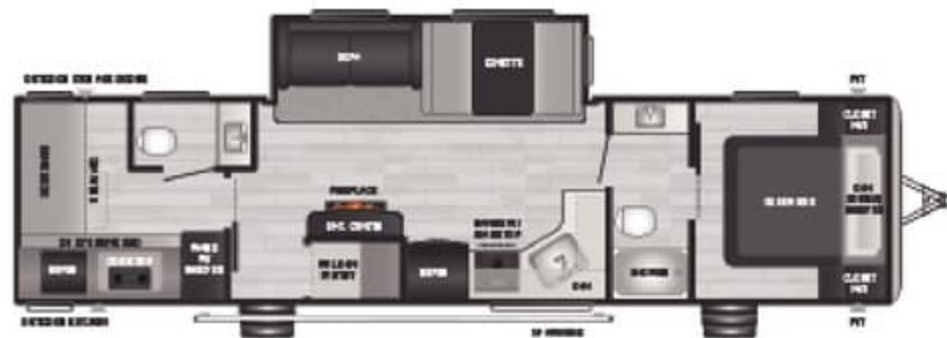

**335BHWE** | Bath & a half, ultimate bunkhouse w/ fireplace, large walk-in pantry

**SPRINGDALE** | DESTINATION TRAILER FLOORPLANS

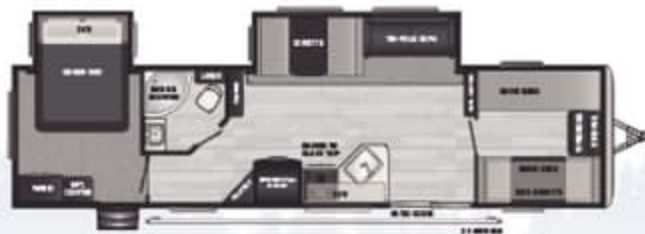

**38BH** | Private bunkroom, maximum sleeping capacity, glass patio door

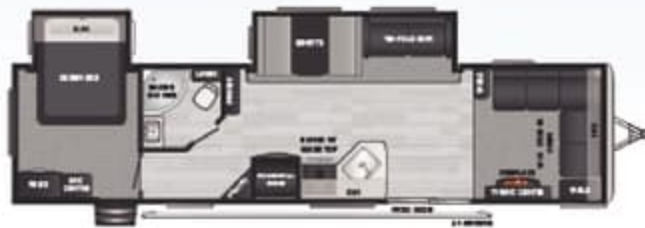

**38FL** | Front lounge w/ fireplace, glass patio door

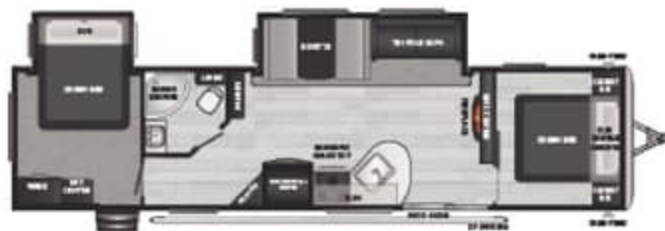

**38FQ** | Two queen bedrooms, glass patio door

**SPRINGDALE** | TRAVEL TRAILER TOY HAULER FLOORPLANS



**27TH** | Toyhauler with 13' garage

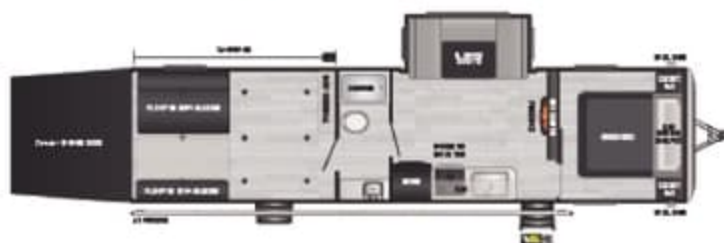

**32TH** | Toyhauler, enclosed 12' garage, dinette slide room

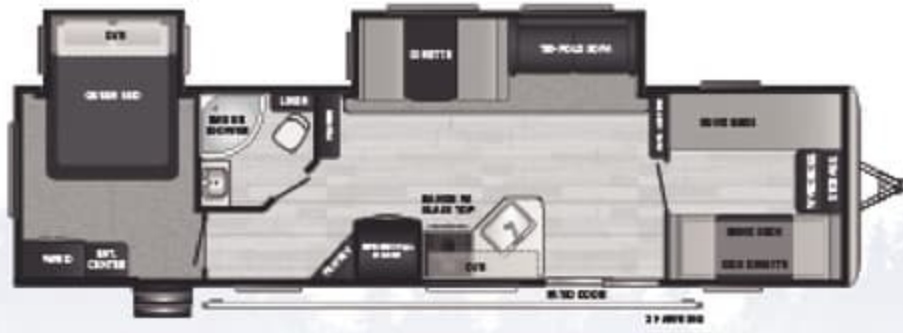

**38BH** | Private bunkroom, maximum sleeping capacity, glass patio door

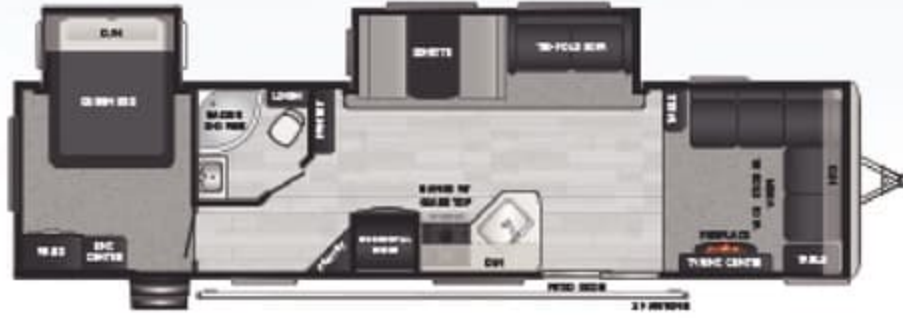

**38FL** | Front lounge w/ fireplace, glass patio door

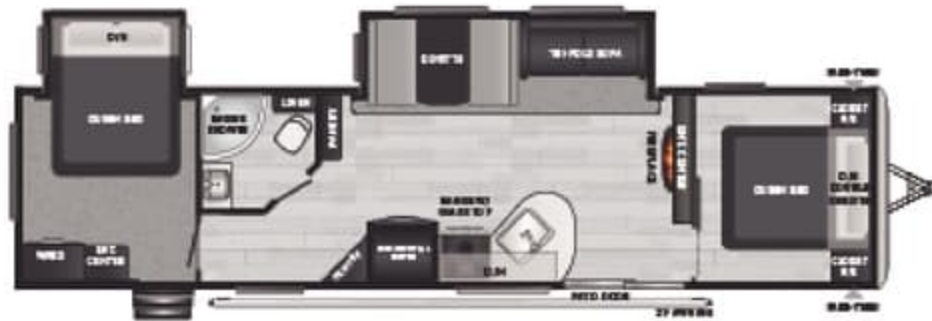

**38FQ** | Two queen bedrooms, glass patio door



**27TH** | Toyhauler with 13' garage

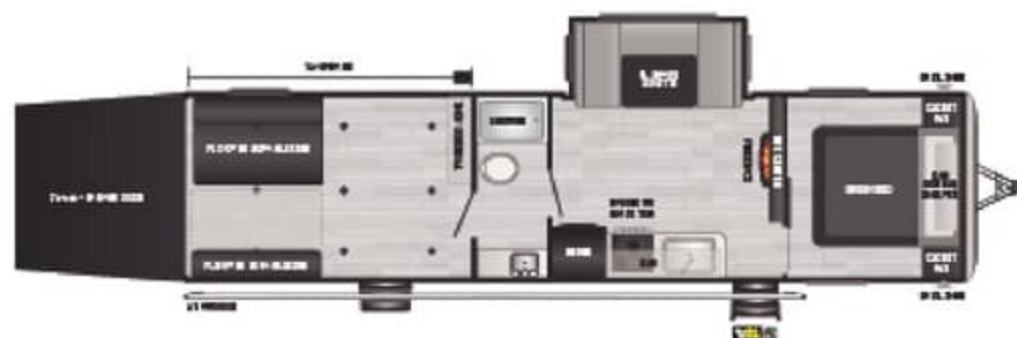

**32TH** | Toyhauler, enclosed 12' garage, dinette slide room





**253FWRE** | Three slides, rear entertainment w/ fireplace



**300FWBH** | Bunkhouse, bath & a half, outside kitchen



**302FWRK** | Rear kitchen, huge countertop, amazing living area

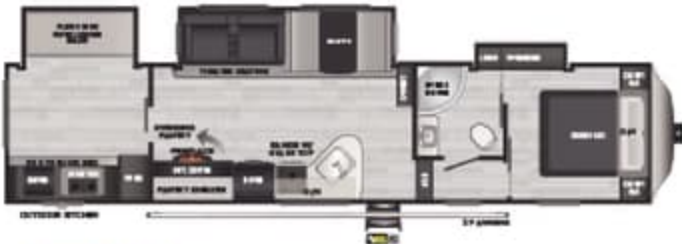

**NEW! 340FWBH** | Three slides, private bunkroom, outside kitchen



**253FWRE** | Three slides, rear entertainment w/ fireplace

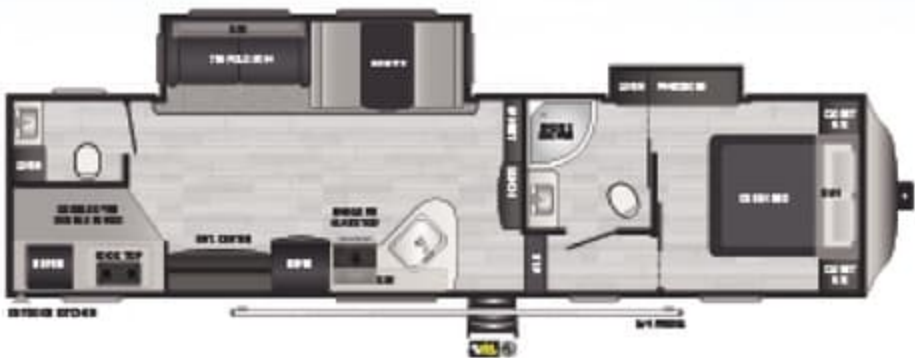

**300FWBH** | Bunkhouse, bath & a half, outside kitchen



**302FWRK** | Rear kitchen, huge countertop, amazing living area



**NEW! 340FWBH** | Three slides, private bunkroom, outside kitchen

# SPRINGDALE | MODEL SPECIFICATIONS

MODEL	WEIGHT	CARRYING CAPACITY	HITCH WEIGHT	FRESH WATER	WASTE WATER	GRAY WATER	LPG	LENGTH*	WIDTH	HEIGHT	AWNING
179QBWE	4152	1868	530	60	40	40	60	21' 10"	8'	10' 9"	12'
202QBWE	4527	1973	550	60	40	40	60	24' 10"	8'	10' 9"	12'
220BHWE	4883	2687	570	60	38	78	60	26' 10"	8'	11' 4"	14'
222RDWE	4729	2791	520	60	40	40	60	26' 0"	8'	10' 11"	16'
240BHWE	5947	1743	690	60	38	78	60	28' 11"	8'	10' 11"	18'
242RKWE	5890	1840	730	60	38	80	60	28' 6"	8'	10' 11"	14'
260TBWE	5139	2386	525	60	38	40	60	28' 6"	8'	10' 9"	16'
27RLWE	6609	3091	900	60	40	38	60	31' 10"	8'	11' 3"	16'
280BHWE	6878	2712	790	60	40	78	60	32' 11"	8'	11' 3"	18'
282BHWE	6676	2844	720	60	38	78	60	32' 1"	8'	11' 3"	18'
295BHWE	6986	2734	920	60	38	78	60	29' 10"	8'	10' 11"	18'
298BHWE	6857	2623	680	60	38	78	60	32' 8"	8'	10' 11"	18'
335BHWE	8010	3190	1050	52	69	117	60	37' 9"	8'	10' 11"	16'
38BH	8632	2523	995	56	39	69	60	38' 11"	8'	11' 4"	21'
38FL	8584	2521	945	56	39	69	60	38' 11"	8'	11' 4"	21'
38FQ	8617	2518	975	56	39	69	60	38' 11"	8'	11' 4"	21'
MODEL	WEIGHT	CARRYING CAPACITY	HITCH WEIGHT	FRESH WATER	WASTE WATER	GRAY WATER	LPG	LENGTH*	WIDTH	HEIGHT	AWNING
1740RK	4039	1161	525	27	30	30	20	21' 5"	8'	10' 2"	10'
1750RD	3378	1022	520	27	30	30	20	21' 5"	8'	10' 2"	10'
1760BH	3757	743	520	27	30	30	20	21' 5"	8'	10' 2"	10'
1790FQ	3694	786	480	27	32	30	20	21' 5"	8'	10' 2"	10'
1800BH	3375	1025	485	27	30	30	20	21' 5"	8'	10' 2"	10'
1860SS	4179	821	675	27	30	30	20	22' 10"	8'	10' 4"	14'
MODEL	WEIGHT	CARRYING CAPACITY	HITCH WEIGHT	FRESH WATER	WASTE WATER	GRAY WATER	LPG	LENGTH*	WIDTH	HEIGHT	AWNING
253FWRE	8633	1667	1500	52	39	39	60	32' 10"	8'	12' 4"	10'
300FWBH	8747	1603	1555	52	69	108	60	34' 10"	8'	12' 4"	18'
302FWRK	8944	1376	1520	52	39	78	60	33' 9"	8'	12' 4"	18'
340FWBH	TBD	TBD	TBD	52	39	78	60	37' 10"	8'	12' 4"	21'

DISCLAIMER: Product information is as accurate as possible as of the date of publication of this brochure. All features, floor plans, and specifications in this brochure are subject to change without notice. Please also consult Keystone's web site at [www.keystonerv.com](http://www.keystonerv.com) for more current product information and specifications. Tow Vehicle Disclaimer. CAUTION: Owners of Keystone recreational vehicles are solely responsible for the selection and proper use of tow vehicles. All customers should consult with a motor vehicle manufacturer or their dealer concerning the purchase and use of suitable tow vehicles for Keystone products. Keystone disclaims any liability or damages suffered as a result of the selection, operation, use or misuse of a tow vehicle. KEYSTONE'S LIMITED WARRANTY DOES NOT COVER DAMAGE TO THE RECREATIONAL VEHICLE OR THE TOW VEHICLE AS A RESULT OF THE SELECTION, OPERATION, USE OR MISUSE OF THE TOW VEHICLE. \*Length is defined as the distance from the centerline of hitch pin/coupler to rear bumper of trailer. Please review owner's manual prior to purchase for more information on service warranties, extended use, towing and maintenance. Owner's manuals can be found at [keystonerv.com](http://keystonerv.com).

# SPRINGDALE | MODEL SPECIFICATIONS

MODEL	WEIGHT	CARRYING CAPACITY	HITCH WEIGHT	FRESH WATER	WASTE WATER	GRAY WATER	LPG	LENGTH*	WIDTH	HEIGHT	AWNING
179QBWE	4162	1868	530	60	40	40	60	21' 10"	8'	10' 9"	12'
202QBWE	4527	1973	550	60	40	40	60	24' 10"	8'	10' 9"	12'
220BHWE	4883	2687	570	60	38	78	60	26' 10"	8'	11' 4"	14'
222RDWE	4729	2791	520	60	40	40	60	26' 0"	8'	10' 11"	16'
240BHWE	5947	1743	690	60	38	78	60	28' 11"	8'	10' 11"	18'
242RKWE	5890	1840	730	60	38	80	60	28' 6"	8'	10' 11"	14'
260TBWE	5139	2386	525	60	38	40	60	28' 6"	8'	10' 9"	16'
271RLWE	6609	3091	900	60	40	38	60	31' 10"	8'	11' 3"	16'
280BHWE	6878	2712	790	60	40	78	60	32' 11"	8'	11' 3"	18'
282BHWE	6676	2844	720	60	38	78	60	32' 1"	8'	11' 3"	18'
295BHWE	6986	2734	920	60	38	78	60	29' 10"	8'	10' 11"	18'
298BHWE	6857	2623	680	60	38	78	60	32' 8"	8'	10' 11"	18'
335BHWE	8010	3190	1050	52	69	117	60	37' 9"	8'	10' 11"	16'
38BH	8632	2523	995	56	39	69	60	38' 11"	8'	11' 4"	21'
38FL	8584	2521	945	56	39	69	60	38' 11"	8'	11' 4"	21'
38FQ	8617	2518	975	56	39	69	60	38' 11"	8'	11' 4"	21'
MODEL	WEIGHT	CARRYING CAPACITY	HITCH WEIGHT	FRESH WATER	WASTE WATER	GRAY WATER	LPG	LENGTH*	WIDTH	HEIGHT	AWNING
1740RK	4039	1161	525	27	30	30	20	21' 5"	8'	10' 2"	10'
1750RD	3378	1022	520	27	30	30	20	21' 5"	8'	10' 2"	10'
1760BH	3757	743	520	27	30	30	20	21' 5"	8'	10' 2"	10'
1790FQ	3694	786	480	27	32	30	20	21' 5"	8'	10' 2"	10'
1800BH	3375	1025	485	27	30	30	20	21' 5"	8'	10' 2"	10'
1860SS	4179	821	65	27	30	30	20	22' 10"	8'	10' 4"	14'
MODEL	WEIGHT	CARRYING CAPACITY	HITCH WEIGHT	FRESH WATER	WASTE WATER	GRAY WATER	LPG	LENGTH*	WIDTH	HEIGHT	AWNING
253FWRE	8633	1667	1500	52	39	39	60	32' 10"	8'	12' 4"	10'
300FWBH	8747	1603	1555	52	69	108	60	34' 10"	8'	12' 4"	18'
302FWRK	8944	1376	1520	52	39	78	60	33' 9"	8'	12' 4"	18'
340FWBH	TBD	TBD	TBD	52	39	78	60	37' 10"	8'	12' 4"	21'

DISCLAIMER: Product information is as accurate as possible as of the date of publication of this brochure. All features, floor plans, and specifications in this brochure are subject to change without notice. Please also consult Keystone's web site at [www.keystonerv.com](http://www.keystonerv.com) for more current product information and specifications. Tow Vehicle Disclaimer. CAUTION: Owners of Keystone recreational vehicles are solely responsible for the selection and proper use of tow vehicles. All customers should consult with a motor vehicle manufacturer or their dealer concerning the purchase and use of suitable tow vehicles for Keystone products. Keystone disclaims any liability or damages suffered as a result of the selection, operation, use or misuse of a tow vehicle. KEYSTONE'S LIMITED WARRANTY DOES NOT COVER DAMAGE TO THE RECREATIONAL VEHICLE OR THE TOW VEHICLE AS A RESULT OF THE SELECTION, OPERATION, USE OR MISUSE OF THE TOW VEHICLE. \*Length is defined as the distance from the centerline of hitch pin/coupler to rear bumper of trailer. Please review owner's manual prior to purchase for more information on service warranties, extended use, towing and maintenance. Owner's manuals can be found at [keystonerv.com](http://keystonerv.com).

	TT	FW	TH	SINGLE
<b>INTERIOR STANDARD FEATURES</b>				
Tri-fold sleeper sofa (FWs & 3Bs)		•		
Range hood w/ light and exhaust fan	•	•	•	
Oven w/glass top and LED lights	•	•	•	
LED lighting	•	•	•	•
12v 10.7 cu. ft. EverChill refrigerator (FW & TH only)		•		
7 cu. ft. gas/electric refrigerator N/A 25BH (Optional FW & TH)	•			
Bluetooth stereo w/ AM/FM/USB	•	•	•	
Portable Bluetooth speaker				•
Upgraded pull down faucet	•	•	•	
Turntable Microwave	•	•	•	•
Hidden laundry chute (most models)	•		•	
Single-basin undermount sink	•	•	•	•
Cable TV hookup w/booster	•	•	•	•
Master bedroom TV prep	•	•	•	
Fitted bedspread	•	•	•	•
Teddy Bear bunk mattresses (select models)	•	•		•
Bathroom exhaust fan	•	•	•	
Quick recovery 6-gallon gas/electric DSI water heater	•	•	•	
Quick recovery 6-gallon gas DSI water heater				•
Quick recovery 10-gallon gas/ electric DSI water heater (30's)	•			
8000 BTU Air Conditioner (1750RD, 1800BH)				•
13,500 BTU ducted air conditioner w/ thermostat (STD select models)	•		•	
15,000 BTU ducted air conditioner w/ thermostat (STD select models)	•	•	•	
20,000 BTU furnace				•
30,000 BTU furnace	•	•	•	
12V 55 AMP converter	•	•	•	•
Operable windows in slide-out	•	•	•	•
Fireplace (IG select models)	•	•	•	
<b>EXTERIOR STANDARD FEATURES</b>				
Laminated sidewalls w/ aluminum framework		•		
Friction hinge entry doors	•	•	•	•
Power tongue jack	•		•	
Smooth metal front	•		•	
Mega pass-through storage compartment	•	•	•	•
Dexter E-Z Lube axles	•	•	•	•

	TT	FW	TH	SINGLE
<b>EXTERIOR STANDARD FEATURES (CONT)</b>				
E-Coated corrosion-resistant wheels	•	•	•	•
2 interior and 2 all-weather exterior speakers	•	•	•	
Quick-release gas line (select models)	•	•	•	
Seamless, one piece TPO roof membrane	•	•	•	•
Fully walkable roof	•	•	•	
Micro Diamond plate rock guard	•		•	•
LCI SolidStep triple entry solid steps on main door	•	•	•	
LCI Solid double step				•
4G LTE and Wi-Fi ready	•	•	•	
Extended rain gutters	•	•	•	•
Backup camera/observation prep	•	•	•	
Power Stab Jacks (Excluding single-axle models & 38BH, 38FL, 38FQ models)	•	•	•	
<b>CONSTRUCTION STANDARD FEATURES</b>				
24" x 8" Dyma Span sub-flooring	•	•	•	•
2" x 3" floor joists, 12" on center	•	•	•	•
Floorplan-specific frame	•	•	•	•
Full width outriggers	•	•	•	•
Triple-seal slide w/ steel C-channel moisture barrier	•	•	•	•
Tuf-Lok crush-resistant ductwork couplers	•	•	•	•
Color-coded unified wiring system	•	•	•	•
3-year fully transferable Limited Structural Warranty	•	•	•	•
<b>SG FW PACKAGES</b>				
<b>FIFTH WHEEL LEGACY PACKAGE (253FWRE, 272FWRE, 300FWBH, 302FWBK) (MANDATORY):</b> Upgraded pressed countertops, fold-out solid step, LED adjustable power awning, 11 cu. ft. - 12V EverChill refrigerator, central control panel, external TV hookup/mount, bedroom TV prep, heated and enclosed underbelly, LED accent lighting, aluminum wheels, tri-fold sleeper sofa, "Do-More" dinette table, utensil hook, magnetic knife holder, elastic storage nets, stainless steel drying rack for kitchen sink				
<b>SG TT PACKAGES</b>				
<b>TRAVEL TRAILER LEGACY PACKAGE (MANDATORY):</b> Vaulted ceiling, power tongue jack, upgraded pressed countertops, solid step, LED adjustable power awning, central control panel, external TV hookup/mount, bedroom tv prep, heated and enclosed underbelly (slide models NA 275BH & toyhaulers), LED accent lighting, utensil hook, magnetic knife holder, elastic storage nets, stainless drying rack for kitchen sink				
<b>OPTIONS</b>				
15,000 BTU A/C IP0 13,500 BTU A/C (select models)				
13,500 BTU direct-blow A/C (replaces the 8000 BTU, side-mount A/C) (1750RD, 1800BH ONLY)				
2nd A/C (select models)				
LED TV 32", 40" or 50" by model (SLIDE MODELS ONLY)				

	TT	FW	TH	SINGLE
<b>INTERIOR STANDARD FEATURES</b>				
Tri-fold sleeper sofa (FWs & 38s)		•		
Range hood w/ light and exhaust fan	•	•	•	
Oven w/glass top and LED lights	•	•	•	
LED lighting	•	•	•	•
12v 10.7 cu. ft. Everchill refrigerator (FW & TH only)		•	•	
7 cu. ft. gas/electric refrigerator N/A 251BH (Optional FW & TH)	•			
Bluetooth stereo w/ AM/FM/USB	•	•	•	
Portable Bluetooth speaker				•
Upgraded pull down faucet	•	•	•	
Turntable Microwave	•	•	•	•
Hidden laundry chute (most models)	•		•	
Single-basin undermount sink	•	•	•	•
Cable TV hookup w/booster	•	•	•	•
Master bedroom TV prep	•	•	•	
Fitted bedspread	•	•	•	•
Teddy Bear bunk mattresses (select models)	•	•		•
Bathroom exhaust fan	•	•	•	
Quick recovery 6-gallon gas/electric DSI water heater	•	•	•	
Quick recovery 6-gallon gas DSI water heater				•
Quick recovery 10-gallon gas/ electric DSI water heater (38's)	•			
8000 BTU Air Conditioner (1750RD, 1800BH)				•
13,500 BTU ducted air conditioner w/ thermostat (STD select models)	•		•	
15,000 BTU ducted air conditioner w/ thermostat (STD select models)	•	•	•	
20,000 BTU furnace				•
30,000 BTU furnace	•	•	•	
12V 55 AMP converter	•	•	•	•
Operable windows in slide-out	•	•	•	•
Fireplace (16 select models)	•	•	•	
<b>EXTERIOR STANDARD FEATURES</b>				
Laminated sidewalls w/ aluminum framework		•		
Friction hinge entry doors	•	•	•	•
Power tongue jack	•		•	
Smooth metal front	•		•	
Mega pass-through storage compartment	•	•	•	•
Dexter E-Z Lube axles	•	•	•	•

	TT	FW	TH	SINGLE
<b>EXTERIOR STANDARD FEATURES (CONT.)</b>				
E-Coated corrosion-resistant wheels	•	•	•	•
2 interior and 2 all-weather exterior speakers	•	•	•	
Quick-release gas line (select models)	•	•	•	
Seamless, one piece TPO roof membrane	•	•	•	•
Fully walkable roof	•	•	•	
Micro Diamond plate rock guard	•		•	•
LCI SolidStep triple entry solid steps on main door	•	•	•	
LCI Solid double step				•
4G LTE and Wi-Fi ready	•	•	•	
Extended rain gutters	•	•	•	•
Backup camera/observation prep	•	•	•	
Power Stab Jacks (Excluding single-axle models & 38BH, 38FL, 38FQ models)	•	•	•	
<b>CONSTRUCTION STANDARD FEATURES</b>				
24" x 8' Dyma Span sub-flooring	•	•	•	•
2" x 3" floor joists, 12" on center	•	•	•	•
Floorplan-specific frame	•	•	•	•
Full width outriggers	•	•	•	•
Triple-seal slide w/ steel C-channel moisture barrier	•	•	•	•
Tuf-Lok crush-resistant ductwork couplers	•	•	•	•
Color-coded unified wiring system	•	•	•	•
3-year fully transferable Limited Structural Warranty	•	•	•	•
<b>SG FW PACKAGES</b>				
<b>FIFTH WHEEL LEGACY PACKAGE (253FWRE, 272FWRE, 300FWBH, 302FWRK) (MANDATORY):</b> Upgraded pressed countertops, fold-out solid step, LED adjustable power awning, 11 cu. ft. - 12V EverChill refrigerator, central control panel, external TV hookup/mount, bedroom TV prep, heated and enclosed underbelly, LED accent lighting, aluminum wheels, tri-fold sleeper sofa, "Do-More" dinette table, utensil hook, magnetic knife holder, elastic storage nets, stainless steel drying rack for kitchen sink				
<b>SG TT PACKAGES</b>				
<b>TRAVEL TRAILER LEGACY PACKAGE (MANDATORY):</b> Vaulted ceiling, power tongue jack, upgraded pressed countertops, solid step, LED adjustable power awning, central control panel, external TV hookup/mount, bedroom tv prep, heated and enclosed underbelly (slide models NA 275BH & toyhaulers), LED accent lighting, utensil hook, magnetic knife holder, elastic storage nets, stainless drying rack for kitchen sink				
<b>OPTIONS</b>				
15,000 BTU A/C IPO 13,500 BTU A/C (select models)				
13,500 BTU direct-blow A/C (replaces the 8000 BTU, side-mount A/C) (1750RD, 1800BH ONLY)				
2nd A/C (select models)				
LED TV 32", 40" or 50" by model (SLIDE MODELS ONLY)				

# BUILT FOR THE LONG HAUL



## 1 EASIER SHOPPING.

At Keystone, we make choosing an RV as easy as finding the Big Dipper on a dark summer night. With comprehensive online product information, Key Connect™ product advisors, and an unparalleled dealer network, we will help you select the perfect RV for your family's adventure.

## 2 INNOVATIVE THINKING.

The road's a nicer place when you have the industry's smartest features behind you. Keystone leads the pack in patented innovations that make our RVs safer, more comfortable, and easier to operate.

## 3 LONG HAUL QUALITY.

To keep you on the road, there are certain things we just won't build a Keystone RV without. Game-changing features like our Unified Wiring Standard, Tru-Fit™ five-point slide construction, and no-fail Tuf-Lok™ A/C duct joiners combined with exhaustive testing and inspections are some of the reasons why Keystone is able to offer our owners the industry's best 3-year limited structural warranty.

## 4 WORRY-FREE CUSTOMER SERVICE.

Wherever the road takes you, you're never too far from an authorized Keystone service center. We also offer live service assistance, ultra-fast parts shipping, online maintenance tips and tricks, and a single-point warranty claims policy. *That's* peace of mind.

## 5 KEYSTONE NATION.

When you choose Keystone, you become a part of one of the largest camping families in the country. We're Keystone Nation. A friendly community where people share photos, travel tips and amazing stories — all in the spirit of camaraderie and adventure. Come join us.

# BUILT FOR THE LONG HAUL



## 1 EASIER SHOPPING.

At Keystone, we make choosing an RV as easy as finding the Big Dipper on a dark summer night. With comprehensive online product information, Key Connect™ product advisors, and an unparalleled dealer network, we will help you select the perfect RV for your family's adventure.

## 2 INNOVATIVE THINKING.

The road's a nicer place when you have the industry's smartest features behind you. Keystone leads the pack in patented innovations that make our RVs safer, more comfortable, and easier to operate.

## 3 LONG HAUL QUALITY.

To keep you on the road, there are certain things we just won't build a Keystone RV without. Game-changing features like our Unified Wiring Standard, Tru-Fit™ five-point slide construction, and no-fail Tuf-Lok™ A/C duct joiners combined with exhaustive testing and inspections are some of the reasons why Keystone is able to offer our owners the industry's best 3-year limited structural warranty.

## 4 WORRY-FREE CUSTOMER SERVICE.

Wherever the road takes you, you're never too far from an authorized Keystone service center. We also offer live service assistance, ultra-fast parts shipping, online maintenance tips and tricks, and a single-point warranty claims policy. *That's* peace of mind.

## 5 KEYSTONE NATION.

When you choose Keystone, you become a part of one of the largest camping families in the country. We're Keystone Nation. A friendly community where people share photos, travel tips and amazing stories — all in the spirit of camaraderie and adventure. Come join us.