

SHOCKWAVE

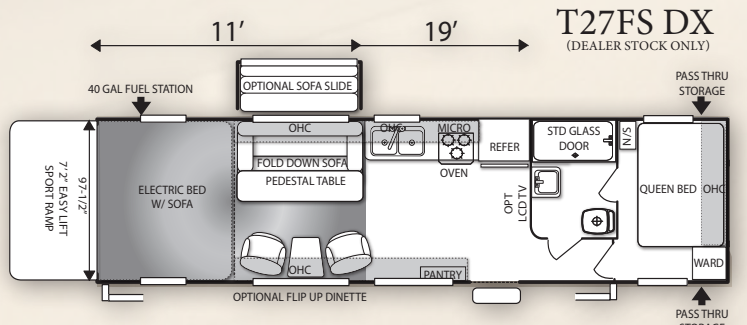
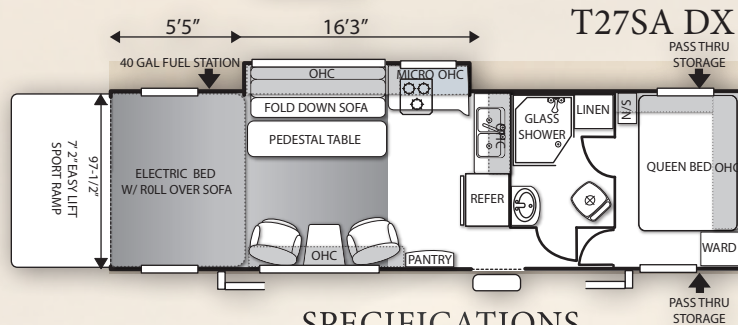
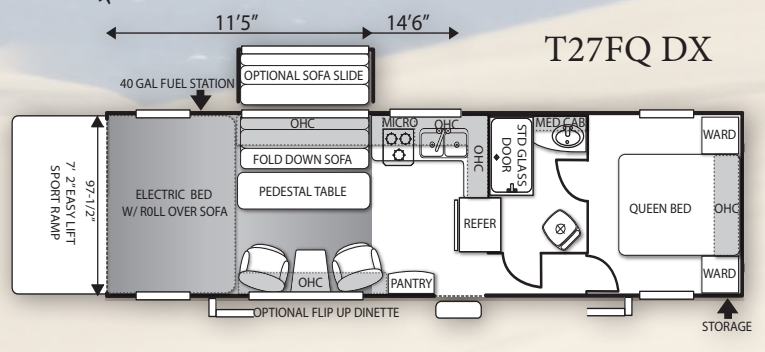
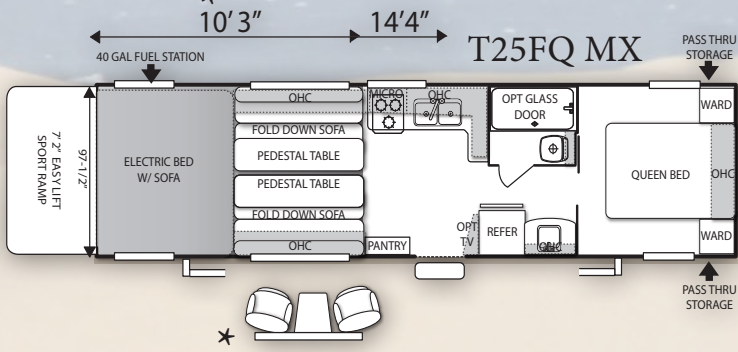
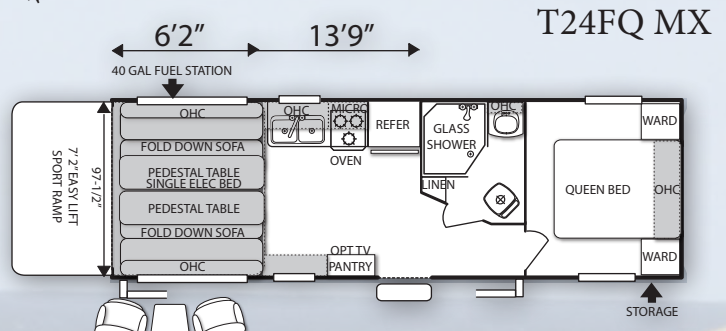
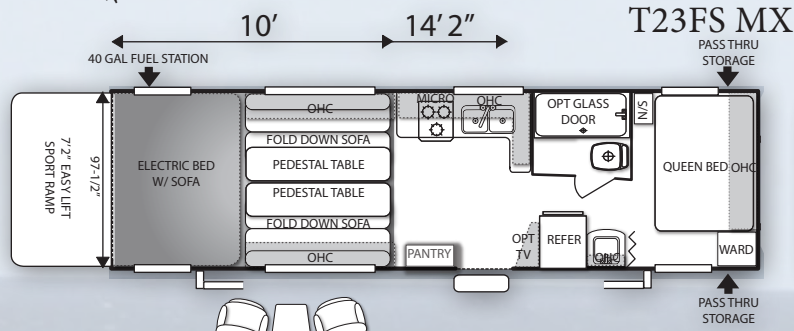
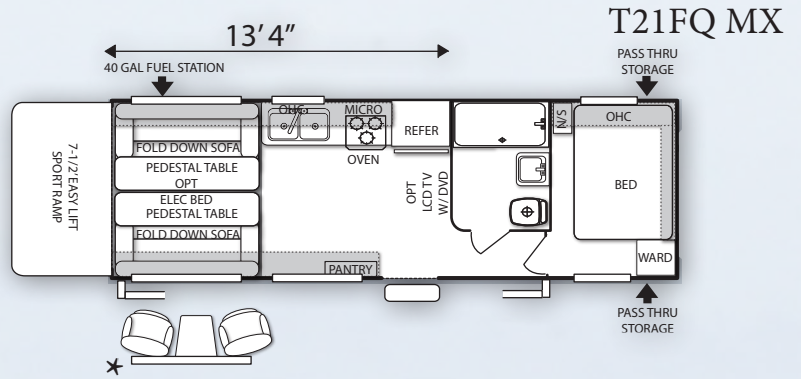
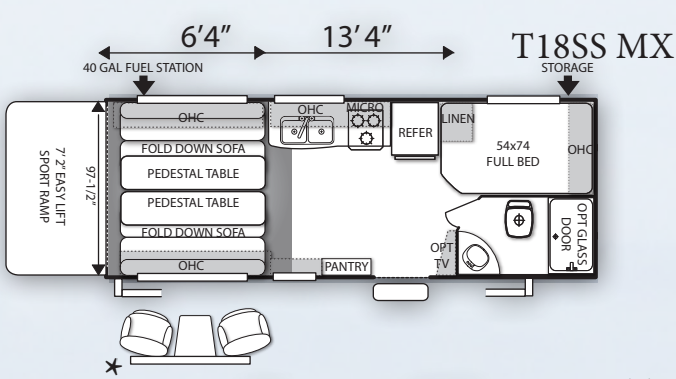

SPECIFICATIONS

Model	Hitch Weight	Dry Weight	GVWR	CCC	Box Length	Total Height	Fresh Water	Grey/Black
T18SS	758 lbs	5,250 lbs	7,758 lbs	2,470 lbs	19' 9"	12'	106 gal	60/40 gal
T21FQ	822 lbs	5,990 lbs	9,980 lbs	3,952 lbs	22' 11"	12'	106 gal	60/40 gal
T23FS	1,094 lbs	6,562 lbs	9,980 lbs	3,380 lbs	24' 9"	12'	106 gal	60/40 gal
T24FQ	867 lbs	6,485 lbs	9,985 lbs	3,462 lbs	25' 6"	12'	106 gal	60/40 gal
T25FQ	987 lbs	6,671 lbs	9,980 lbs	3,271 lbs	26' 3"	12'	106 gal	60/40 gal
T27FQ	1,030 lbs	6,990 lbs	9,980 lbs	2,952 lbs	28' 5"	12'	106 gal	60/40 gal
T27SA	1,097 lbs	7,937 lbs	12,100 lbs	4,125 lbs	29' 5"	12' 2"	106 gal	60/40 gal
T27FS	1,076 lbs	7,250 lbs	10,660 lbs	3,272 lbs	28' 7"	12'	106 gal	60/40 gal

*The Cargo Carrying Capacity does not include the weight of water, fluids, all popular options. Weights and capacities are approximate, the addition of optional equipment including fiberglass siding will increase the overall weight. All illustrations and specifications contained in this literature are based on the latest product information at time of publication. Forest River reserves the right to make changes in price, colors, materials, equipment, and specifications at any time without notice and assumes no responsibility for any error in this literature.

*

 OPTIONAL SWIVEL CHAIRS
 W/ BAY WINDOW ON MX MODELS



A Berkshire Hathaway company.

Forest River Inc.
California Division
 909 873 3777

www.ForestRiverInc.com/Shockwave

SHOCKWAVE

**OFF ROAD
APPROVED**



STANDARD FEATURES:

- 102" Wide Body Construction
- 106 gal Fresh Water
- 13.5 BTU Ducted Air Conditioner
- 17" Gas Oven w/ 3 Burner Cook Top
- 30# LP Btls w/ Cover (20# on MX)
- 30,000 BTU Furnace, Ducted Heat Throughout
- 40 gal Fuel Station Tank
- 4 Corner Stabilizer Jacks
- 7'2" Radius Ramp Door
- 8" or 10" I-Beam Powder Coated Chassis w/ Z-Outriggers
- Black Tank Flush (Opt on MX)
- Deep Single Bowl Sink w/ 2 Covers
- Drive Up Wheel Well
- Electric Bed w/ Sofa (T23FS, T25FQ, T27FQ, T27FS, T27SA)
- Exterior Marine Grade Speakers
- EZ Lube Axles & Self Adjusting Brakes
- Family Message Center w/ Electronic Charging Stations (Bedroom & LR)
- Full Extension Metal Drawer Guides
- Fully Insulated 2" Floor w/ 5/8" Tongue & Groove Marine Decking
- Generator Prep (MX)
- Built In Generator (DX)
- Matching Spare Tire w/ Carrier
- Microwave w/ Carousel
- Oversized Kitchen Window
- Power Awning (DX Models)
- Single Electric Bed (T24FQ MX) (OPT T21FQ & T18SS)

POPULAR OPTIONAL EQUIPMENT:

- 15k BTU Air Conditioner
- 200W Solar Power & LED Light Pkg
- Additional 60 gal Fresh Water (NA T18SS, T21FQ)
- Tankless Water Heater
- Aluminum Wheels
- Built In Onan Generator (STD on DX)
- Carpet Kit
- Pleated Window Shades
- Glass Shower Enclosure (18'-25' Models, STD T24FQ, & T27SADX)
- Flipped Axles
- Kicker Audio Sound System
- LED TV
- Power Tongue Jack
- Retractable Roof Ladder
- Stainless Steel Appearance Appliance Pkg
- Swivel Chairs w/ Bay Window (MX)
- Toy Lok Security System
- Water Filter System
- Water Heater By Pass

Available at your Local Shockwave Dealer:

G-Series Package MX:

- Alumina Wall Fiberglass Exterior
- Aluminum Wheels w/ Matching Spare
- Kicker Audio Sound System
- Day / Night Shades
- Power Awning

G-Series Package DX:

- Alumina Wall Fiberglass Exterior
- Aluminum Wheels w/ Matching Spare
- Kicker Audio Sound System
- Pleated Window Shades
- Fender Skirts
- Radius Auto Mold
- Stainless Steel Package

Arctic Package:

- Reflex Foil Insulation on Roofs and Floors (R-38)
- Insulated & Enclosed Tanks
- 12V Heat Strips
- R-7 Insulation Throughout