

HIDEOUT

by Keystone

TRAVEL TRAILERS // FIFTH WHEELS

EDITION
EASTERN

RIGHT FEATURES. RIGHT PRICE.
RIGHT NOW



KEYSTONERV.COM/HIDEOUT



Keystone RV
Company

**COLE
DAVIS**

Founder, Keystone RV Company
Started Keystone RV with 110 employees
and 1 production line in 1996.



**Keystone RV
Company**

AN ICONIC COMPANY

When Cole Davis founded Keystone RV in 1996 his vision was clear: Build a quality RV loaded with features priced thousands less than other RVs on the market. To accomplish his goal, Cole built a strong team, focused on keeping overhead low, and empowered employees closest to the customer to make decisions. Within a few short months after opening the doors, Keystone produced its very first camper. Delivering big on quality, features and value, the public fell in love and a star was born.

As customers appetite skyrocketed, new Keystone models were added to satisfy growing customer demand. Along with this tremendous growth came the need for expanded production. To meet this need, more manufacturing plants were built and staffed. By the beginning of 2000, Keystone was leading the industry in fifth wheel and trailer sales. Today, Keystone RV Company has grown to encompass over 1 million square feet of manufacturing space with facilities in Goshen, Indiana and Pendleton, Oregon. While Keystone is no longer the small "start up" we once were, our mission has remained true to Cole's vision—"Do the job right and make sure we deliver a quality product every time."



WIRED FOR PERFORMANCE

THE ONLY TOWABLE MANUFACTURER TO INCORPORATE COLOR-CODED AND NUMBERED ELECTRICAL WIRING ON ALL PRODUCTS

- Creates a clean, well organized wiring layout
- Makes it easy to trace electrical circuits and saves troubleshooting time

SUPERCHARGED A/C COOLING



TUF-LOK THERMOPLASTIC COUPLERS FORM A PERMANENT, CRUSH-RESISTANT SEAL IN YOUR AIR-CONDITIONING DUCT

- Securely joins ductwork and air-conditioning units
- Crush-resistant design won't pull apart due to rough roads, heat and stress
- Drastically reduces chilled-air leaks to boost cooling efficiency and comfort

IN-FLOOR RESIDENTIAL HEAT-DUCTS



Keystone RV

Competitor

RESIDENTIAL IN-FLOOR HEAT-DUCT SYSTEM JUST LIKE IN YOUR HOME

- In-floor, hot air vents spaced for greatest comfort
- Distributes heat evenly and warms the floor

MOST RELIABLE PRODUCTS IN THE INDUSTRY / QUALITY, PROCESS DRIVEN MANUFACTURING / CONSU

BUILT

FOR THE LONG HAUL



TRU-FIT FIVE-POINT SLIDE ROOM CONSTRUCTION BACKED BY THE INDUSTRY'S-BEST 3-YEAR LIMITED STRUCTURAL WARRANTY

- Rain channels direct rain away from the slide openings
- Exterior bulb-seals in a locking track stay secure through extreme heat and cold
- Composite slide-room "glide" bar enables the room to move with no binding
- Reinforced roof, walls and floor
- Beefed-up aluminum header above slide room for greater strength

INNOVATION THAT STARTS WITH A SOLID FOUNDATION

110



110 RVDA QUALITY CIRCLE AWARDS

- Keystone Brands have earned 110 DSI Quality Circle Awards since 2007

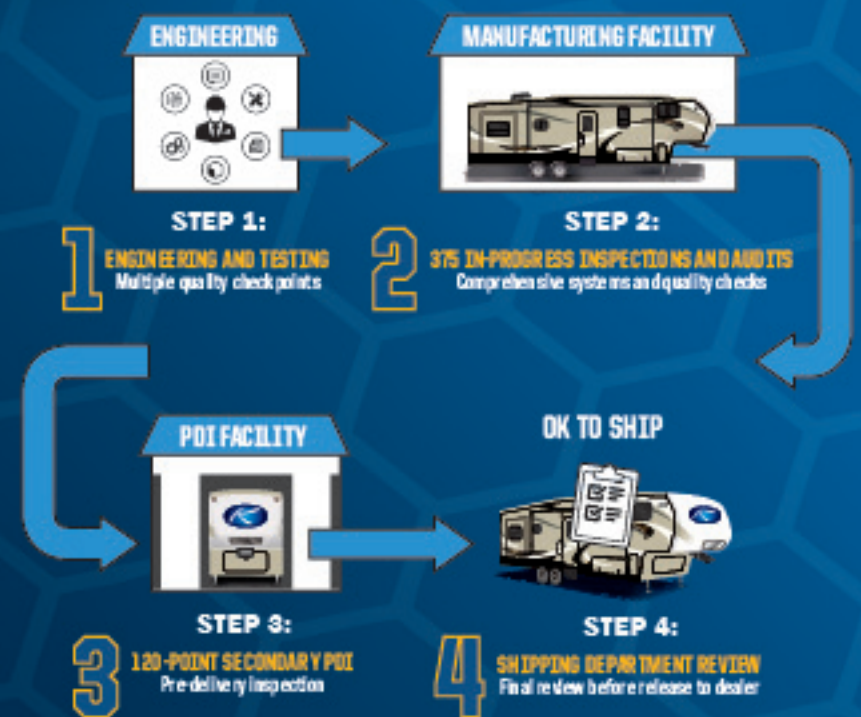

CUSTOMER FOCUSED PRODUCTS AND SERVICE / MOST "DEALER SATISFACTION INDEX" AWARDED RECIPIENT

HIDEOUT

by Keystone

TRAVEL TRAILERS

FIFTH WHEELS

EDITION
EASTERN



RIGHT NOW is the right time for anyone to enjoy camping in a Keystone Hideout Travel Trailer or Fifth Wheel. With a wide range of floorplans that appeal to any size family, Hideout offers the perfect combination of luxury, features and camping convenience—all at the **RIGHT PRICE**.

Aside from having eye catching exterior appeal and beautiful interior decors, Hideout also provides award winning quality and exactly the **RIGHT FEATURES** to make your camping experience comfortable, convenient and trouble free. You will find that Keystone Hideout truly is the best value in its category—with the **RIGHT FEATURES** and the **RIGHT PRICE** all **RIGHT NOW**.



Keystone RV
Company

www.keystonerv.com/Hideout

HIDEOUT

LUXURY TRAVEL TRAILERS

28RKS SHOWN IN TIMBER DECOR



BEST-IN-CLASS ADVANTAGES

SOLID ONE PIECE COUNTERTOP W/ LED

UNDERMOUNT SINK W/ SPRAYER FAUCET

CENTRAL VACUUM



OUTDOOR KITCHEN (SELECT MODELS)

BACKUP CAMERA PREP

POWER STAB JACKS



HIDEOUT

LUXURY TRAVEL TRAILERS



WEIGHT 6564 LENGTH 31' **26RLS**



WEIGHT 6695 LENGTH 32' 4" **28RBS**
NEW



WEIGHT 6521 LENGTH 31' 6" **27DBS**



WEIGHT 7053 LENGTH 32' 11" **28RKS**

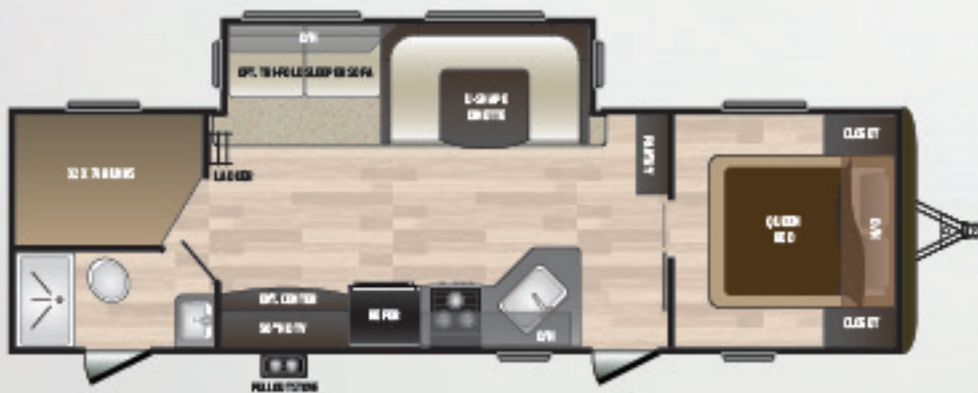

WEIGHT 6857 LENGTH 32' 9" **28BHS**



WEIGHT 6958 LENGTH 33' 4" **29BKS**

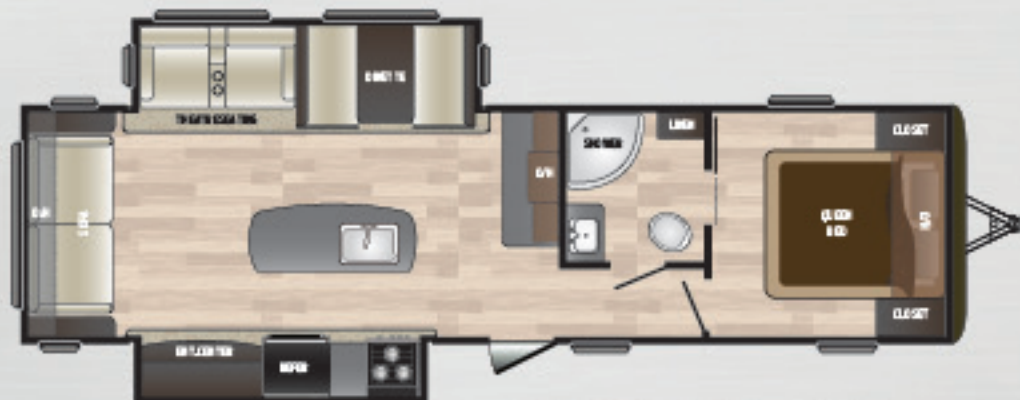

WEIGHT 7733 LENGTH 34' 11" **30RLDS**

HIDEOUT

LUXURY TRAVEL TRAILERS



WEIGHT 8013 LENGTH 35' **31FBDS**



WEIGHT 8335 LENGTH 39' 11\"/>



WEIGHT 7880 LENGTH 35' 8\"/>



WEIGHT 8360 LENGTH 39' 11\"/>



WEIGHT 8590 LENGTH 37' 8\"/>

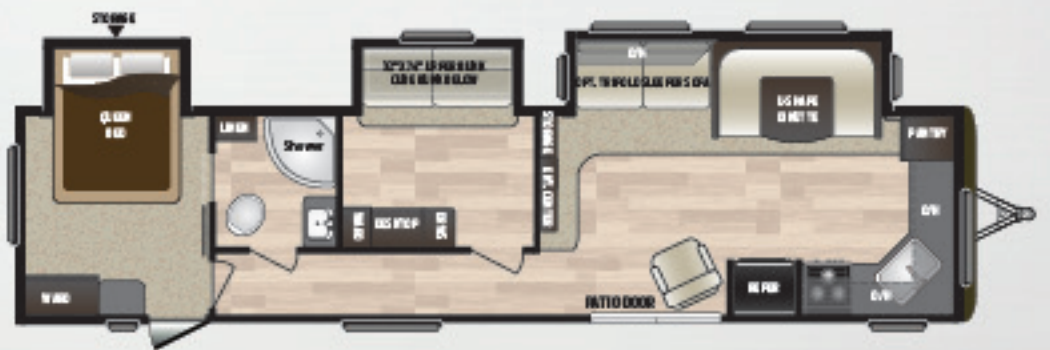

WEIGHT 9719 LENGTH 39' 11\"/>



WEIGHT 9308 LENGTH 39' 11\"/>

HIDEOUT

LHS SERIES TRAVEL TRAILERS

258LHS SHOWN IN TIMBER DECOR



HIDEOUT LHS TRAVEL TRAILER ADVANTAGES



LED LIGHTED COUNTERTOP



CENTRAL VACUUM SYSTEM



LAUNDRY CHUTE



PORCELAIN TOILET



BACKUP CAMERA PREP



OUTDOOR KITCHEN (SELECT MODELS)

HIDEOUT

LHS SERIES TRAVEL TRAILERS

272LHS SHOWN IN TIMBER DECOR



EXPERIENCE VIRTUAL TOURS

LOOK FOR THIS ICON **360° View**



Also Works with VR App



Explore 3D Space

SINGLE AXLE



WEIGHT 3300 LENGTH 21' 5" **175LHS**



WEIGHT 3335 LENGTH 21' 5" **177LHS**



WEIGHT 3240 LENGTH 21' 5" **178LHS**



WEIGHT 3410 LENGTH 21' 5" **185LHS**

HIDEOUT

LHS SERIES TRAVEL TRAILERS



WEIGHT 4500
LENGTH 23' 11"

192LHS



WEIGHT 5895
LENGTH 28' 8"

252LHS



WEIGHT 4455
LENGTH 24' 11"

202LHS



WEIGHT 6115
LENGTH 29' 11"

258LHS

NEW



WEIGHT 4700
LENGTH 26' 4"

212LHS



WEIGHT 5044
LENGTH 29' 3"

262LHS

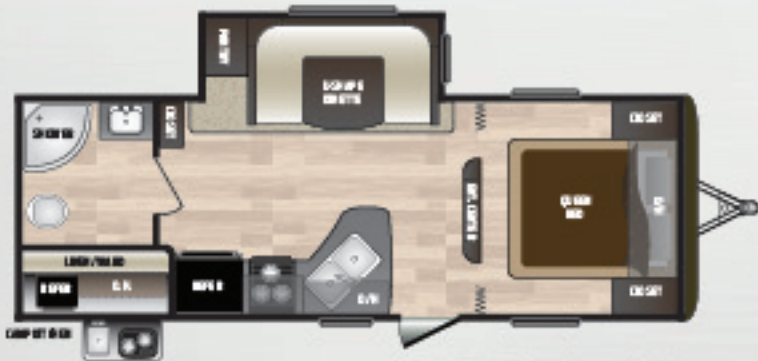

WEIGHT 5590
LENGTH 28' 11"

232LHS



WEIGHT 6026
LENGTH 30' 8"

272LHS



WEIGHT 5639
LENGTH 28' 5"

242LHS

HIDEOUT

LUXURY FIFTH WHEELS

292MLS SHOWN IN TIMBER DECOR



HIDEOUT LUXURY FIFTH WHEEL ADVANTAGES

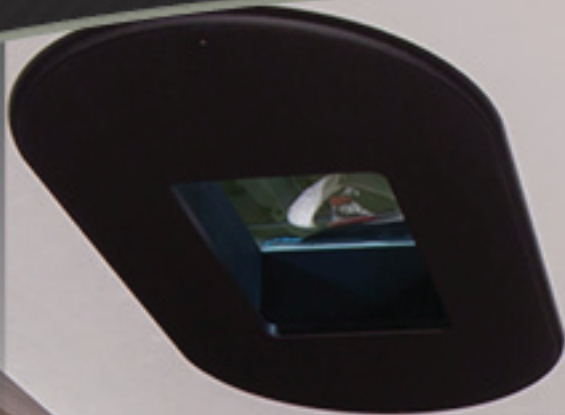

SKYLIGHT



GLASS STOVE TOP COVER



CENTRAL VACUUM SYSTEM



SOLID PRESSED COUNTERTOP W/ LED



UNDERMOUNT SINK W/ SPRAYER FAUCET



OUTDOOR KITCHEN (SELECT MODELS)

HIDEOUT

LUXURY FIFTH WHEELS



292MLS SHOWN IN TIMBER DECOR



WEIGHT 7860 LENGTH 30' 11" **262RES**
NEW



WEIGHT 8375 LENGTH 33' 7" **292MLS**
NEW



WEIGHT 8095 LENGTH 32' 4" **281DBS**



WEIGHT 9060 LENGTH 35' 5" **298BHDS**

HIDEOUT

LUXURY FIFTH WHEELS

292MLS SHOWN IN TIMBER DECOR



WEIGHT 8820 LENGTH 33' **299RLDS**



WEIGHT 9062 LENGTH 35' 6" **308BHDS**



WEIGHT 9105 LENGTH 34' 11" **303RLI**
NEW



WEIGHT 9632 LENGTH 36' 8" **315RDTS**

HIDEOUT

SPECIFICATIONS

LHS SERIES TRAVEL TRAILERS

MODEL	WEIGHT	CC	HITCH	FRESH WATER	WASTE WATER	GRAY WATER	LPG	LENGTH*	HEIGHT
175LHS	3300	1100	485	27	30	30	20	21' 5"	10' 2"
177LHS	3335	1065	540	27	30	30	20	21' 5"	10' 2"
178LHS	3240	1200	440	27	30	32	20	21' 5"	10' 2"
185LHS	3410	1040	450	27	30	30	20	21' 5"	10' 2"
192LHS	4500	2500	540	43	30	30	40	23' 11"	10' 3"
202LHS	4455	2745	490	43	39	39	40	24' 11"	10' 3"
212LHS	4700	2500	545	43	30	39	40	26' 4"	10' 3"
232LHS	5590	2020	610	43	30	39	40	28' 1"	11' 1"
242LHS	5639	2011	650	43	30	30	40	28' 5"	11' 1"
252LHS	5895	1805	700	43	39	39	40	28' 8"	11' 1"
258LHS	6115	1645	760	43	39	69	40	29' 11"	11' 1"
262LHS	5044	2501	545	43	30	39	40	29' 3"	10' 3"
272LHS	6026	1754	780	43	30	30	40	30' 8"	11' 1"

LUXURY TRAVEL TRAILERS

MODEL	WEIGHT	CC	HITCH	FRESH WATER	WASTE WATER	GRAY WATER	LPG	LENGTH*	HEIGHT
26RLS	6564	1261	825	43	39	39	40	31' 0"	11' 1"
27DBS	6521	1269	790	43	30	39	40	31' 6"	11' 0"
28BHS	6857	2808	865	43	39	69	40	32' 9"	11' 0"
28RBS	6695	3020	915	43	39	78	40	32' 4"	11' 0"
28RKS	7053	2607	860	43	39	78	40	32' 11"	11' 0"
29BKS	6958	2637	795	43	39	39	40	33' 4"	11' 0"
30RLDS	7733	2122	1055	43	39	78	40	34' 11"	11' 2"
31FBDS	8013	1682	895	43	39	78	40	35' 0"	11' 2"
31RBDS	7880	1740	820	43	39	39	40	35' 8"	11' 2"
32BHTS	8590	2610	1040	43	39	60	40	37' 8"	11' 2"
38BHDS	8360	1610	1170	43	39	39	60	39' 11"	11' 2"
38FDDS	8335	1665	1205	43	39	39	60	39' 11"	11' 2"
38FKTS	9179	1821	1200	43	39	78	60	39' 11"	11' 4"
38FQTS	9308	2052	1200	43	78	78	60	39' 11"	11' 4"

LUXURY FIFTH WHEELS

MODEL	WEIGHT	CC	HITCH	FRESH WATER	WASTE WATER	GRAY WATER	LPG	LENGTH*	HEIGHT
262RES	7860	2640	1610	43	39	78	60	30' 11"	12' 4"
281DBS	8095	2505	1615	43	69	30	60	32' 4"	12' 4"
292MLS	8375	2625	1505	43	39	78	60	33' 7"	12' 5"
298BHDS	9060	2440	1930	43	39	81	60	35' 5"	12' 5"
299RLDS	8820	2380	1520	43	39	78	60	33' 0"	12' 5"
303RLI	9105	2295	1705	43	39	78	60	34' 11"	12' 5"
308BHDS	9062	2638	1820	43	78	39	60	35' 6"	12' 5"
315RDTs	9632	2333	1805	43	39	78	60	36' 8"	12' 5"

DISCLAIMER: Product information is as accurate as possible as of the date of publication of this brochure. All features, floor plans, and specifications in this brochure are subject to change without notice. Please also consult Keystone's web site at www.keystonerv.com for more current product information and specifications. Tow Vehicle Disclaimer. CAUTION: Owners of Keystone recreational vehicles are solely responsible for the selection and proper use of tow vehicles. All customers should consult with a motor vehicle manufacturer or their dealer concerning the purchase and use of suitable tow vehicles for Keystone products. Keystone disclaims any liability or damages suffered as a result of the selection, operation, use or misuse of a tow vehicle. KEYSTONE'S LIMITED WARRANTY DOES NOT COVER DAMAGE TO THE RECREATIONAL VEHICLE OR THE TOW VEHICLE AS A RESULT OF THE SELECTION, OPERATION, USE OR MISUSE OF THE TOW VEHICLE. REFERENCE KEYSTONE RV COMPANY OWNERS MANUAL FOR LIMITED WARRANTY DETAILS. *Length is defined as the distance from the centerline of hitch pin/coupler to rear bumper of trailer.

HIDEOUT

SPECIFICATIONS

EXTERIOR	LUXURY TT	LUXURY FW	LHS TT	SINGLE AXLE
HIDEOUT PATENTED HITCH VISION	-	S	-	-
GEL COATED MAXTURN FIBERGLASS FRONT CAP	-	S	-	-
ELECTRIC ADJUSTABLE FRONT LANDING GEAR	-	S	-	-
DIAMOND PLATE	S	-	S	S
LIGHTED ADJUSTABLE POWER AWNING	S	S	S	-
MANUAL PATIO AWNING	-	-	-	S
BLACK TANK FLUSH	S	S	-	-
OUTSIDE 110 RECEPTACLE	S	S	S	S
E-COATED WHEELS	S	-	S	S
XL ENTRY ASSIST HANDLE	S	S	-	-
EXTERIOR TV HOOKUP/CABLE & BRACKET	S	S	S	-
COLD MOUNTAIN PACKAGE	S	S	-	-
POWDER COATED I-BEAM FRAME	S	S	S	S
EASY LUBE AXLES	S	S	S	S
FULL LENGTH OUTRIGGERS	S	S	S	S
DUAL BATTERY RACK	S	S	S	-
EXTERIOR SPEAKERS	S	S	S	S
BLACK RADIUS WINDOW FRAMES	S	S	S	S
TV ANTENNA WITH BOOSTER	S	S	S	S
CABLE HOOK UP	S	S	S	S
FULL WALK ON ROOF	S	S	-	-
RADIUS ENTRY DOORS W/INTEGRATED STRUTS	S	S	S	S
OVERSIZED PASS THRU STORAGE	S	S	S	S
RAIN GUTTERS WITH DOWN SPOUTS	S	S	S	S
TRU-FIT FIVE POINT SLIDE OUT CONSTRUCTION	S	S	S	-
ROTO-CAST SEAMLESS HOLDING TANKS	S	S	S	S
HURRICANE STRAPS REINFORCED STRUCTURE	S	S	S	S
FOUR HEAVY DUTY STABILIZER JACKS	S	S	S	S
RADIAL TIRES	S	S	S	S
CAMBERED CHASSIS	S	S	S	S
96" EXTERIOR WIDTH	S	S	S	S
EXTERIOR SHOWER	0	S	0	-
SPARE TIRE AND CARRIER	0	0	0	0
REAR LADDER (MOST MODELS)	0	0	-	-

INTERIOR	LUXURY TT	LUXURY FW	LHS TT	SINGLE AXLE
TRI-FOLD SLEEPER SOFA	0	S	-	-
FREESTANDING DINETTE (SELECT MODELS)	0	0	-	-
PLEATED SHADES IN LIVING AREA	S	S	-	-
FULL STRUTTED STORAGE UNDER MASTER BED	S	S	-	-
HD LED TV	S	S	0	-
INTERIOR SURROUND SOUND SPEAKERS	S	S	S	S
BLUETOOTH DVD/CD/MP3 STEREO	S	S	S	-
HIDDEN LAUNDRY CHUTE	S	-	S	-
MICROWAVE	S	S	S	S
MONITOR PANEL	S	S	S	S
6 CU. FT. REFRIGERATOR	S	-	S	-
8 CU. FT. REFRIGERATOR	-	S	-	-
RESIDENTIAL REFRIGERATOR (38BHDS, 38FDDS, 38FKTS, 38FQTS ONLY)	S	-	-	-
BALL BEARING DRAWER GUIDES	S	S	S	S
12 VOLT 55 AMP CONVERTER	S	S	S	-
15,000 BTU AIR CONDITIONER	0	S	0	-
13,500 BTU AIR CONDITIONER	S	-	S	0
8K BTU AIR CONDITIONER	-	-	-	S
BUILT-IN 30,000 BTU FURNACE	S	S	S	-
20K BTU FURNACE	-	-	-	S
3 CU. FT. GAS/ELECTRIC REFER	-	-	-	S
GAS/ELECTRIC DSI WATER HEATER	0	S	-	-
FLEX PEX TUBING WITH 10 YEAR WARRANTY	S	S	S	S
81" INTERIOR HEIGHT	S	-	S	-
TUB SURROUND	S	S	S	-
FOOT FLUSH TOILET	S	S	S	S
RG6 CABLE AND SATELLITE WIRING	S	S	S	S
4 1/2" CROWNED ROOF	S	S	S	S
LOOMED COLOR CODED WIRING	S	S	S	S
RANGE WITH HI-OUTPUT BURNER	S	S	S	S
REVERSIBLE DINETTE CUSHIONS	S	S	S	S
HIGH RISE KITCHEN FAUCET	S	S	S	S

LUXURY TT = LUXURY TRAVEL TRAILERS
LUXURY FW = LUXURY FIFTH WHEELS
LHS = LHS TRAVEL TRAILERS
SINGLE AXLE = LHS SINGLE AXLE TRAVEL TRAILERS

STANDARD FEATURES AND OPTIONS ARE SUBJECT TO CHANGE WITHOUT NOTICE.

S STANDARD | 0 OPTIONAL | - NOT AVAILABLE

HIDEOUT

by Keystone



HIDEOUT BRANDS ARE A PROUD RECIPIENT OF THE DEALER SATISFACTION QUALITY CIRCLE AWARD

STAY IN TOUCH



Hideout is always just a touch away. You'll find 360 virtual tours, location of your nearest dealer, photos, videos and all of the latest information about Hideout on our easy to navigate website. Everything you need can be accessed anytime, day or night, from home or on the road. You can also find us on the Keystone RV facebook.

BUY LOCALLY

PURCHASING YOUR RV LOCALLY

It's up to you where you purchase your new Hideout, but may we suggest your local dealer? Not only does it help your local economy and provide jobs, but it will also give you an opportunity to develop a service relationship with someone that will come to know you and your coach. Congratulations on finding the best built, best equipped and best value in the industry.

YOUR LOCAL DEALER IS:



JANUARY 2018

HIDEOUT
by Keystone
WWW.KEYSTONERV.COM/HIDEOUT

RIGHT FEATURES. RIGHT PRICE.
RIGHT NOW

Go RVing.

Member
RVIA
RECREATIONAL VEHICLE
INDUSTRY ASSOCIATION

DSI
Annual RVDA DEALER
SATISFACTION INDEX

DISCLAIMER: Product information is as accurate as possible as of the date of publication of this brochure. All features, floor plans, and specifications in this brochure are subject to change without notice. Please also consult Keystone's web site at www.keystonerv.com for more current product information and specifications. Tow Vehicle Disclaimer. CAUTION: Owners of Keystone recreational vehicles are solely responsible for the selection and proper use of tow vehicles. All customers should consult with a motor vehicle manufacturer or their dealer concerning the purchase and use of suitable tow vehicles for Keystone products. Keystone disclaims any liability or damages suffered as a result of the selection, operation, use or misuse of a tow vehicle. KEYSTONE'S LIMITED WARRANTY DOES NOT COVER DAMAGE TO THE RECREATIONAL VEHICLE OR THE TOW VEHICLE AS A RESULT OF THE SELECTION, OPERATION, USE OR MISUSE OF THE TOW VEHICLE. *REFERENCE KEYSTONE RV COMPANY OWNERS MANUAL FOR LIMITED WARRANTY DETAILS. *Length is defined as the distance from the centerline of hitch pin/coupler to rear bumper of trailer.

Keystone RV Company