



NOBO
NO BOUNDARIES

10 SERIES
(under 2,000 LBS)



16 SERIES
(under 3,500 LBS)



19 SERIES
(under 5,000 LBS)





WHAT IF THERE WERE NO•BOUNDARIES?

Designed for those who push limits, the versatile and exceptionally light weight No Boundaries (**NOBO**) travel trailer is rugged enough for any outdoor enthusiast. It's innovative and durable rooftop Rhino-Rack offers adaptable storage for Kayaks, mountain bikes, snowboards, fishing equipment, or just simply extra luggage. Towable by both 4- and 6-cylinder vehicles, **NOBO** is ready when you are.



FEATURES



**JBL FLIP 4 PORTABLE
BLUETOOTH SPEAKER**



**MORRYDE STEPS
W/LED ENTRY STEP LIGHT**



**BEVERAGE OPENER
(STANDARD)**



**BATWING CANOPY
270° COVERAGE**



**WHEEL STEP/SEAT
(STANDARD IN OVERLANDER PACKAGE)**



**OUTDOOR KITCHEN
(STANDARD ON 10.5/10.6)**



**SEAMLESS PANORAMIC FRONT WINDOW
60" X 22" TEMPERED GLASS**



WHEN YOU LIVE LIFE BY A COMPASS, NOT A CLOCK.

With industry-leading ground clearance, larger diameter tires and a nimble suspension system, you'll be able to explore and set up camp in places that would otherwise be inaccessible. Additionally, the upscale interior focuses on thoughtful, useful design with ample storage and an ergonomic and refreshing living space.

NO•BO is attractively equipped with both familiar standard equipment as well as fresh features for a truly unforgettable adventure.



NB10.6



SPECIFICATIONS

MODEL	NB10.5	NB10.6
Unloaded Vehicle Weight	1570	1606
Hitch Weight (lbs.)	210	198
Cargo Carrying Capacity	2140	1992
Roof Capacity (lbs.)	500	500
Exterior Length	13' 10"	13' 9"
Exterior Width	88"	88"
Exterior Height (w/ A/C)	6' 11"	7' 5"
Fresh Water (gal.)	30	30
Grey Water (gal.)	N/A	N/A
Black Water (gal.)	N/A	N/A

NOTE - Definitions for specifications can be found on the back page of this brochure.

KEY FEATURES

- **10.6 can haul a full-size ATV**
- **Standard Enclosed Underbelly**
- **30 gal. Fresh Water Capacity**

FLOORPLANS

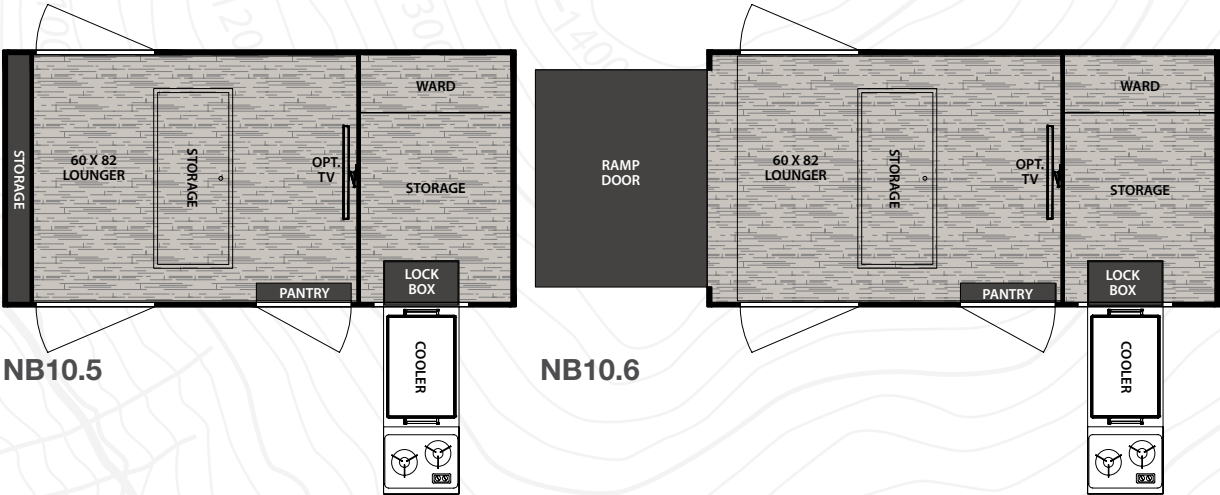



10 SERIES STANDARDS/OPTIONS

DISCOVERER PACKAGE

KEY STANDARD EQUIPMENT

JBL FLIP 4 Portable Bluetooth Speaker
Featuring Exclusive Custom Cradle Mount
Complete Interior/Exterior LED Lighting PKG
LED Entry Step Light
1000 Lumen Amber/White Scare Light
Light Weight Ply Counter-Top Material
Stainless Steel Utility Hooks
Bottle Opener
Matte Satin Nickel Appointments
(where applicable)
2-Burner Cook Top
Black-Out Shades
Xtreme Ply PVC Roof Material
USB Charging Station
Fuji White Exterior Lamilux 1000 Fiberglass Shell
Featuring Satin Matte Graphics
Fully Walkable Fenders – 300 lb. Capacity

OVERLANDER PACKAGE

Standard RVT Track (Rhino Rack #RTV148)
Two Vortex Bars (Rhino Rack #VA180B)
J-Cradle Kayak Holder (Rhino Rack #S510)
Wheel Step/Seat (Rhino Rack #RWS)
Matte Finish 6-Lug Wheels

OPTIONAL EQUIPMENT

13.5 BTU Low Profile Air Conditioning
28" LED Flat Screen 12V TV
Power Tongue Jack w/LED Light
Pioneer Platform (Rhino Rack #TBD
(IPO Vortex Bars, J-Cradle Kayak Rack))
Hybrid Single Bike Carrier
(Rhino Rack #RBC050)
Snowboard/Ski/Fishing Rod/Paddle Holder
(Rhino Rack #573)
Wheel Step/Seat (Rhino Rack #RWS)
One standard in Overlander Package
Batwing Awning (Available only 10.5, 10.6)
Dinette Package (Available only 10.5, 10.6)
5,000 BTU Heat Strip
Mag Screen for 10.6



LOAD.



LOUNGE.



DINE.



RELAX.



REST.

REPEAT.



WHEN YOUR NEXT PATH IS OFF THE GRID.

Count on **NO•BO** to take you into uncharted territory. Escape the crowds into the remote rugged wilderness and take your gear with you. Whether in search of a big catch or a big wave, you don't have to leave amenities behind. Explore, get dirty, then return to home base to clean up, relax and recharge.



NB16.7

SPECIFICATIONS

MODEL	NB16.5	NB16.7	NB16.8
Unloaded Vehicle Weight	2991	3478	TBD
Hitch Weight (lbs.)	312	355	TBD
Cargo Carrying Capacity	1721	1277	TBD
Roof Capacity (lbs.)	500	500	500
Exterior Length w/o Spare Tire	20'	20'	TBD
Exterior Width	96"	96"	TBD
Exterior Height (w/ A/C)	9' 7"	9' 7"	TBD
Interior Height	78"	78"	78"
Box Width	6' 6"	6' 6"	6' 6"
Fresh Water (gal.)	30	30	TBD
Grey Water (gal.)	30	30	TBD
Black Water (gal.)	30	30	TBD

NOTE - Definitions for specifications can be found on the back page of this brochure.

FLOORPLANS

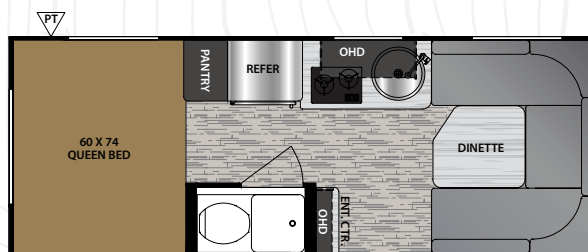

NB16.5

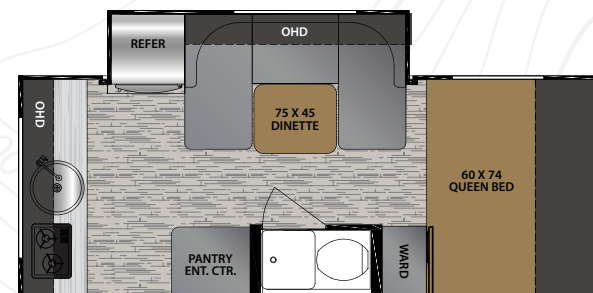

NB16.7

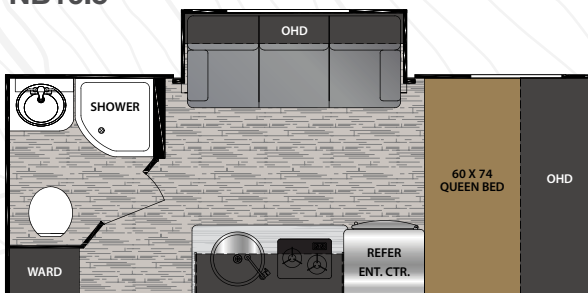

NB16.8

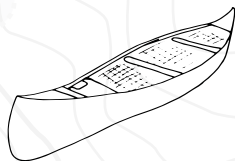

16 SERIES STANDARDS/OPTIONS

DISCOVERER PACKAGE

KEY STANDARD EQUIPMENT

JBL FLIP 4 Portable Bluetooth Speaker
Featuring Exclusive Custom Cradle Mount
Complete Interior/Exterior LED Lighting PKG
LED Entry Step Light
1000 Lumen Amber/White Scare Light
60" x 22" Tempered Seamless
Panoramic Front Window
Light Weight Ply Counter-Top Material
Stainless Steel Utility Hooks
Bottle Opener
Exclusive 12' Thule Box Awning
(16 Series only)
Rear Ladder
Avalanche Cooler (10.5 and 10.6 Series only)
Matte Satin Nickel Appointments
(where applicable)
2-Burner Cook Top
Stainless Steel Sink
Black-Out Shades
Xtreme Ply Roof Material
USB Charging Station
Fuji White Exterior Lamulux 1000 Fiberglass Shell
Featuring Satin Matte Graphics
Industry-Leading Interior Storage
Fully Walkable Fenders – 300 lb. Capacity

OVERLANDER PACKAGE

Standard RVT Track (Rhino Rack #RTV148)
Two Vortex Bars (Rhino Rack #VA180B)
J-Cradle Kayak Holder (Rhino Rack #S510)
Wheel Step/Seat (Rhino Rack #RWS)
Matte Finish 6-Lug Wheels

OPTIONAL EQUIPMENT

13.5 BTU Low Profile Air Conditioning
28" LED Flat Screen 12V TV
Power Tongue Jack w/LED Light
Stainless Steel Convection Microwave
(N/A on 16.5)
Pioneer Platform (Rhino Rack #TBD
(IPO Vortex Bars, J-Cradle Kayak Rack))
Hybrid Single Bike Carrier
(Rhino Rack #RBC050)
Snowboard/Ski/Fishing Rod/Paddle Holder
(Rhino Rack #573)
Wheel Step/Seat (Rhino Rack #RWS)
One standard in Overlander Package



NB16.7



NB16.7



NB16.7



WHEN YOU THRIVE ON PUSHING THE LIMITS.

NO•BO 19 Series delivers a true 7' wide box to align perfectly with smaller tow vehicles. Combine this with our enclosed underbelly and gate valves, panoramic front window, and torsion axle suspension system to offer you the most versatile, capable, and affordable towable on the market. Each **NO•BO** 19 series also features factory installed RVT tracks on the roof, ready to accept and integrate your personalized Rhino Rack Roof System!



NB19.5

SPECIFICATIONS

MODEL	NB19.1	NB19.5	NB19.7
Unloaded Vehicle Weight	TBD	3456	3809
Hitch Weight (lbs.)	TBD	365	388
Cargo Carrying Capacity	TBD	1309	979
Roof Capacity (lbs.)	500	500	500
Exterior Length w/o Spare Tire	23' 6"	22' 8"	23' 8"
Exterior Width	TBD	88"	88"
Exterior Height (w/ A/C)	TBD	9' 7"	9' 7"
Interior Height	78"	78"	78"
Fresh Water (gal.)	TBD	30	30
Grey Water (gal.)	TBD	30	30
Black Water (gal.)	TBD	30	30

NOTE - Definitions for specifications can be found on the back page of this brochure.

FLOORPLANS

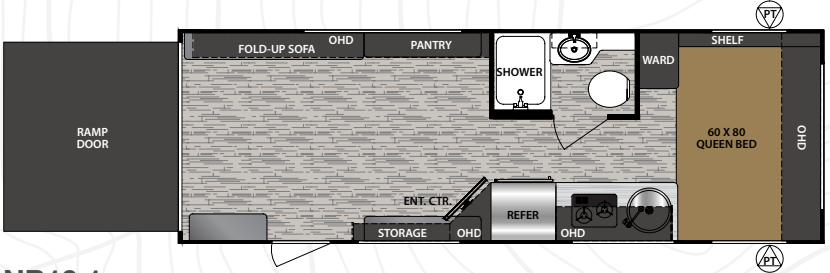

NB19.1

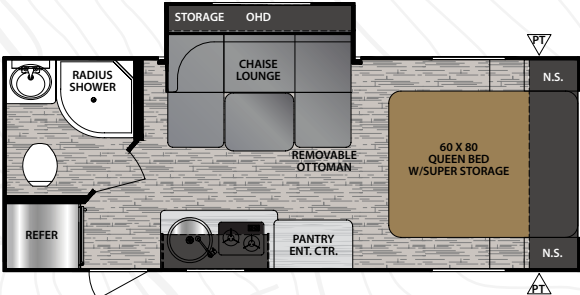

NB19.5

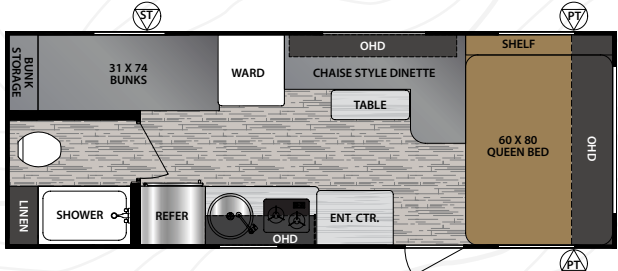

NB19.7

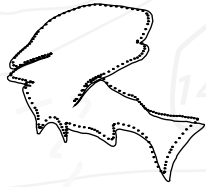

NOBO
NO BOUNDARIES



19 SERIES STANDARDS/OPTIONS

DISCOVERER PACKAGE KEY STANDARD EQUIPMENT

JBL FLIP 4 Portable Bluetooth Speaker
Featuring Exclusive Custom Cradle Mount
Complete Interior/Exterior LED Lighting PKG
LED Entry Step Light
1000 Lumen Amber/White Scare Light
60" x 22" Tempered Seamless Panoramic Front Window (where applicable)
13.5K A/C
Lightweight Ply Counter-Top Material
Stainless Steel Utility Hooks
Power Awning w/LED Backlighting
Matte Finish 6-Lug Wheels
Rear Ladder
Beverage Opener
Matte Satin Nickel Appointments (where applicable)
2-Burner Cook Top
Stainless Steel Sink
Pleated Shades
Standard RVT Track (#RTV148)
USB Charging Station
Fuji White exterior Lamulux 1000 Fiberglass Shell
Featuring Satin Matte Graphics

OVERLANDER PACKAGE (OPTIONAL)

Two Vortex Bars (Rhino Rack #VA180B)
J-Cradle Kayak Holder (Rhino Rack #S510)
Wheel Step/Seat (Rhino Rack #RWS)

OPTIONAL EQUIPMENT

Stainless Steel Convection Microwave Oven
28" LED Flat Screen 12V TV
Power Tongue Jack w/LED Light
Hybrid Single Bike Carrier (Rhino Rack #RBC050)
Snowboard/Ski/Fishing Rod/Paddle Holder (Rhino Rack #573)
Wheel Step/Seat (Rhino Rack #RWS)
One standard in Overlander Package
J-Cradle Kayak Holder (Rhino Rack #S510)
One standard in Overlander Package





NB19.5

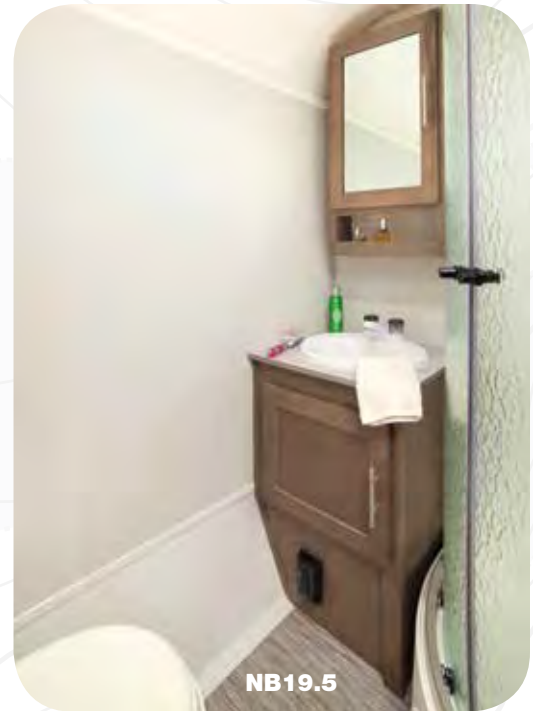

NB19.5



NB19.5



NB19.5



NB19.7



NB19.7

*TO THOSE WITH
NO BOUNDARIES*





Heather H./16.5
Picacho Peak State Park, AZ



Justin Landry/10.6
Winnipeg, MB



Kristine S./19.5
Wild Duck Campground, Scarborough, ME



Matt & Eva James/16.7
Hudson Valley, NY



Heather H.
Chiricahua National Monument, AZ

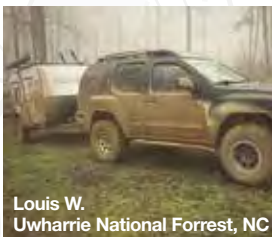

Louis W.
Uwharrie National Forrest, NC



Josh U./19.5
Lac La Hache, BC



Forest River Owner "Digital Kit" App

Now you can have your Owner's Manual with you wherever you are. Download our FREE App from the App Store or Google Play and you'll have the information right at your fingertips.



Find us on
Facebook

GVWR (Gross Vehicle Weight Rating) - is the maximum permissible weight of the unit when fully loaded. It includes all weights, inclusive of all fluids, cargo, optional equipment and accessories. For safety and product performance do NOT exceed the GVWR.

GAWR (Gross Axle Weight Rating) - is the maximum permissible weight, including cargo, fluids, optional equipment and accessories that can be safely supported by a combination of all axles.

UVW (Unloaded Vehicle Weight)* - is the typical weight of the unit as manufactured at the factory. It includes all weight at the unit's axle(s) and tongue or pin and LP Gas. The UVW does not include cargo, fresh potable water, additional optional equipment or dealer installed accessories.

*Estimated Average based on standard build optional equipment.

CCC (Cargo Carrying Capacity)** - is the amount of weight available for fresh potable water, cargo, additional optional equipment and accessories. CCC is equal to GVWR minus UVW. Available CCC should accommodate fresh potable water (8.3 lbs per gallon). Before filling the fresh water tank, empty the black and gray tanks to provide for more cargo capacity.

** Estimated average based on standard build optional equipment.

Each Forest River RV is weighed at the manufacturing facility prior to shipping. A label identifying the unloaded vehicle weight of the actual unit and the cargo carrying capacity is applied to every Forest River RV prior to leaving our facilities. The load capacity of your unit is designated by weight, not by volume, so you cannot necessarily use all available space when loading your unit.

FREE MEMBERSHIP
to Forest River Owners' Group

www.forestriverfrog.com



CUSTOMER SATISFACTION



www.ForestRiverBuyLocal.com

No Boundaries Division

Forest River, Inc.
1702 Century Dr.
Goshen, IN 46528
(574) 642.3119

www.forestriverinc.com/nobo
www.forestriveraccessories.com



PRE-DELIVERY INSPECTION FACILITY

20,000 square feet of quality assurance. The bare essentials for a premium product. This state-of-the-art facility gives immediate daily feedback to production for quality assurance in every unit built.

24/7 EMERGENCY ROADSIDE ASSISTANCE

For a worry-free ownership experience

Forest River includes one

year of Coach-Net RV Technical & Roadside Assistance

Assistance with each RV purchase. Whether new to the RV lifestyle or an experienced RV enthusiast, Forest River owners have 24/7 access to technical, operational and emergency road service coverage throughout the US & Canada.

Coach-Net's fast, dependable service is just a phone call away.

Coach-Net®

RV Technical & Roadside Assistance

Your local **NOBO** dealer



Learn More

Scan this barcode using a QR Reader on your smart phone to learn more about Forest River.



A Berkshire Hathaway company.

All information contained in this brochure is believed to be accurate at the time of publication. However, during the model year, it may be necessary to make revisions and Forest River, Inc., reserves the right to make all such changes without notice, including prices, colors, materials, equipment and specifications as well as the addition of new models and the discontinuance of models shown in this brochure. Therefore, please consult with your Forest River dealer and confirm the existence of any materials, design or specifications that are material to your purchase decision. 1/19

©Copyright 2019 Forest River Inc - All Rights Reserved.