

# LAREDO

*by Keystone*



Super-Lite Travel Trailers | Super-Lite Fifth Wheels | Mid-Profile Fifth Wheels

The leader in  
**AFFORDABLE LUXURY**



**Keystone RV  
Company**

[WWW.KEYSTONERV.COM/LAREDO](http://WWW.KEYSTONERV.COM/LAREDO)





# Enjoy the Life-Sized CAMPING EXPERIENCE.

The amenities in your home are life sized and they should be like that in your camper, too. Laredo doesn't settle for smaller RV sized features. Instead we make them "life sized" the way you are used to. Laredo enhances your camping experience by giving you the perfect combination of features, floor plans and value. Couple Laredo's "Life Sized" features with industry leading quality and customer service and sacrifice nothing in your home away from home.



330RL ENTERTAINMENT/LIVING ROOM

330RL BEDROOM





358BP SHOWN IN MADURO DECOR



358BP BUTLERS PANTRY



358BP KITCHEN



298SRL KITCHEN



298SRL BEDROOM WITH WARDROBE





MID-PROFILE FIFTH WHEELS

## AFFORDABLE LUXURY FEATURES

- ✔ 18 CU. FT. GAS/ELECTRIC REFRIGERATOR
- ✔ SOLID SURFACE KITCHEN COUNTERTOPS
- ✔ FLUSH MOUNT STAINLESS STEEL SINK
- ✔ KING SIZE BED (SELECT MODELS)
- ✔ WASHER/DRYER PREP
- ✔ 50" LED HDTV
- ✔ FIREPLACE (SELECT MODELS)
- ✔ 32" BEDROOM TV (MOST MODELS)
- ✔ FIBERGLASS FRONT CAP WITH MAX TURN TECHNOLOGY
- ✔ POWER ADJUSTABLE AWNING
- ✔ 50 AMP SERVICE
- ✔ AUTO LEVEL SYSTEM
- ✔ FRICTION HINGE ENTRY DOOR W/SHADE
- ✔ FRAMELESS WINDOWS
- ✔ RAISED PANEL CABINET DOORS



# FLOOR PLANS



**WEIGHT** 11055 **LENGTH** 36' 8" **325RL**



**WEIGHT** 10785 **LENGTH** 37' 7" **340FL**



**WEIGHT** 11257 **LENGTH** 38' 4" **342RD**



**WEIGHT** 11480 **LENGTH** 39' 9" **358BP**

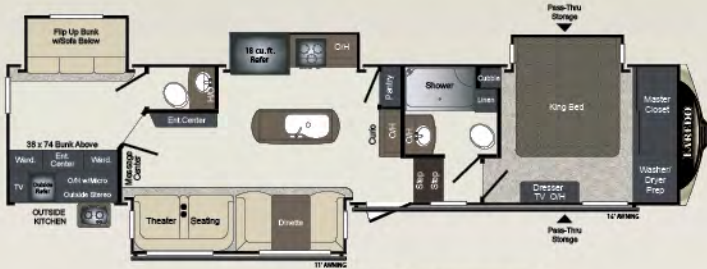

**WEIGHT** 12130 **LENGTH** 39' 9" **367BH**

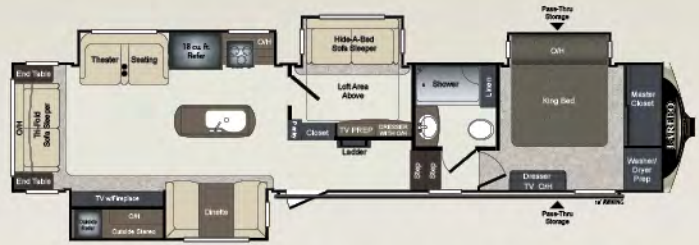

**WEIGHT** 12785 **LENGTH** 41' 6" **380MB**

## FIFTH WHEEL WEIGHTS & MEASUREMENTS

MODEL	SHIPPING WEIGHT	CARRYING CAPACITY	HITCH	LENGTH*	WIDTH	HEIGHT	FRESH WATER	WASTE WATER	GRAY WATER	LPG	AWNING
325RL	11055	1945	1910	36' 8"	8'	12' 7"	66	44	78	60	16'
340FL	10785	2215	2220	37' 7"	8'	12' 7"	66	34	68	60	19'
342RD	11257	1743	2065	38' 4"	8'	12' 7"	66	44	78	60	18'
358BP	11650	2570	2225	39' 9"	8'	12' 7"	66	44	78	60	19'/11'
367BH	12130	2230	2365	39' 9"	8'	12' 7"	66	78	78	60	16'/11'
380MB	12785	2715	2385	41' 6"	8'	12' 7"	66	44	78	60	20'

\*Length is defined as the distance from the centerline to the hitch pin/coupler to rear bumper of the trailer. SEE DISCLAIMER ON BACK PAGE





SUPER-LITE FIFTH WHEELS

## AFFORDABLE LUXURY FEATURES

- ✓ STAMPED STEEL ARCHED ROOF RAFTERS
- ✓ 8 CU. FT. REFRIGERATOR
- ✓ SOLID SURFACE COUNTERTOPS
- ✓ KITCHEN ISLAND W/DUAL PULL-OUT TRASH CANS
- ✓ 40" LED HDTV
- ✓ 12V DVD/CD/AM/FM/MP3 PLAYER WITH BLUETOOTH
- ✓ 50 AMP SERVICE/PREPARED FOR SECOND AIR CONDITIONER
- ✓ ELECTRIC AWNING
- ✓ ROAD ARMOR SUSPENSION
- ✓ HEATED PASS-THRU STORAGE
- ✓ HITCH ASSIST MIRROR W/2 LED LIGHTS
- ✓ AUTO LEVELING
- ✓ FRICTION HINGE ENTRY DOOR W/SHADE
- ✓ RAISED PANEL CABINET DOORS



# FLOOR PLANS



**WEIGHT** 7255 **LENGTH** 30' 4" **268SRL**

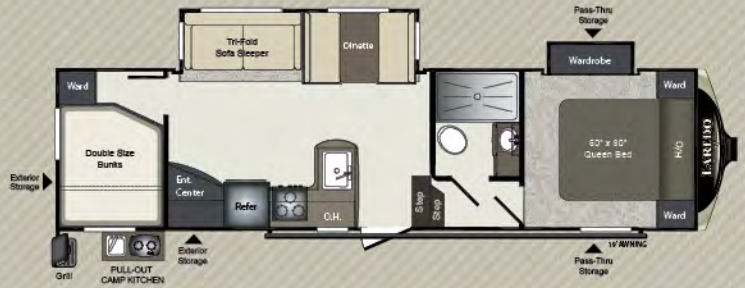

**WEIGHT** 8028 **LENGTH** 33' **285SBH**



**WEIGHT** 8445 **LENGTH** 33' 6" **290SRL**

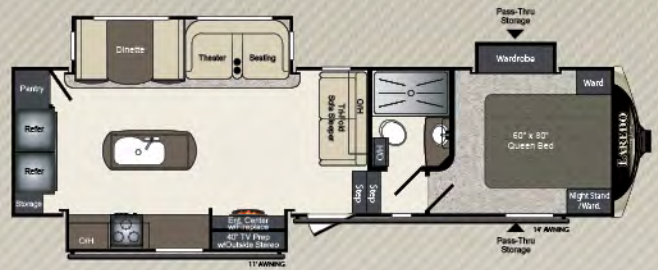

**WEIGHT** 8615 **LENGTH** 33' 6" **291SMK**



**WEIGHT** 9205 **LENGTH** 34' 2" **296SBH**

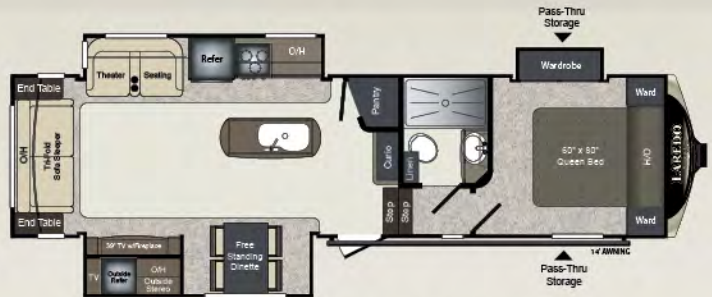

**WEIGHT** 8855 **LENGTH** 34' 6" **298SRL**

## FIFTH WHEEL WEIGHTS & MEASUREMENTS

MODEL	SHIPPING WEIGHT	CARRYING CAPACITY	HITCH	LENGTH*	WIDTH	HEIGHT	FRESH WATER	WASTE WATER	GRAY WATER	LPG	AWNING
268SRL	7255	2745	1385	30' 4"	8'	12' 4"	43	30	60	60	18'
285SBH	8028	1972	1465	33'	8'	12' 4"	43	30	60	60	19'
290SRL	8445	2055	1725	33' 6"	8'	12' 3"	43	30	60	60	13'/11'
291SMK	8615	1885	1675	33' 6"	8'	12' 3"	43	30	60	60	14'/11'
296SBH	9205	1395	1820	34' 2"	8'	12' 3"	43	30	60	60	16'
298SRL	8855	1286	1390	34' 6"	8'	12' 3"	43	30	60	60	14'

\*Length is defined as the distance from the centerline to the hitch pin/coupler to rear bumper of the trailer. SEE DISCLAIMER ON BACK PAGE





## SUPER-LITE TRAVEL TRAILER

# AFFORDABLE LUXURY FEATURES

- ✓ RESIDENTIAL FAUCET W/PULLOUT SPRAYER
- ✓ SOLID SURFACE COUNTERTOPS
- ✓ RADIUS CEILING
- ✓ 40" LED HDTV
- ✓ KING SIZE BED (SELECT MODELS)
- ✓ 50" WIDE, 6' 7" TALL SHOWER
- ✓ 50 AMP SERVICE/PREPARED FOR SECOND AIR CONDITIONER
- ✓ POWER ADJUSTABLE AWNING
- ✓ GRILL 'N CHILL OUTSIDE KITCHEN (SELECT MODELS)
- ✓ FIBERGLASS FRONT CAP W/ROCK GUARD PAINT PROTECTION
- ✓ TRAVEL TRAILER AUTO LEVELING (MOST MODELS)
- ✓ FRICTION HINGE ENTRY DOOR W/SHADE
- ✓ ALUMINUM WHEELS
- ✓ ALUMINUM ENTRY STEPS



# FLOOR PLANS



**WEIGHT** 6090 **LENGTH** 26' 11" **225MK**



**WEIGHT** TBD **LENGTH** 29' 11" **250BH**



**WEIGHT** 6885 **LENGTH** 32' 5" **280RB**

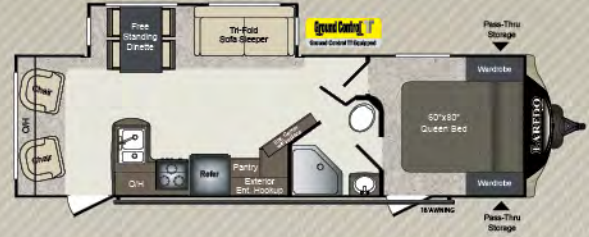

**WEIGHT** 6715 **LENGTH** 32' 10" **288RL**

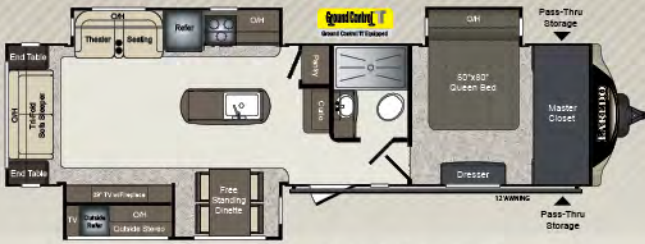

**WEIGHT** 8288 **LENGTH** 37' **330RL**



**WEIGHT** 8585 **LENGTH** 38' **332BH**

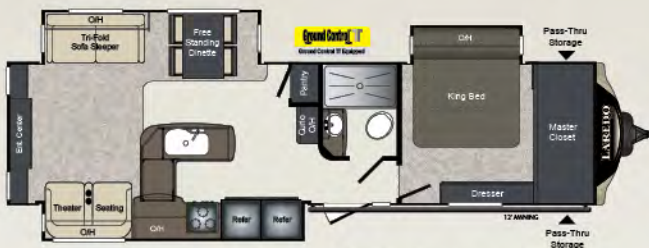

**WEIGHT** 8602 **LENGTH** 37' 1" **334RE**

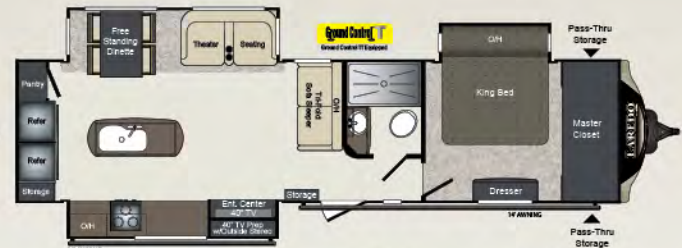

**WEIGHT** 8528 **LENGTH** 37' 11" **335MK**

## TRAVEL TRAILER WEIGHTS & MEASUREMENTS

MODEL	SHIPPING WEIGHT	CARRYING CAPACITY	HITCH	LENGTH*	WIDTH	HEIGHT	FRESH WATER	WASTE WATER	GRAY WATER	LPG	AWNING
225MK	6090	1910	745	26' 11"	8'	11' 1"	43	30	60	60	18'
250BH	TBD	TBD	TBD	29' 11"	TBD	TBD	TBD	TBD	TBD	TBD	TBD
280RB	6885	1915	795	32' 5"	8'	11' 1"	43	30	60	60	19'
288RL	6715	2085	860	32' 10"	8'	11' 1"	43	30	60	60	18'
330RL	8288	1587	1075	37'	8'	11' 1"	43	30	60	60	12'
332BH	8585	1375	1165	38'	8'	11' 1"	43	30	60	60	8'/11'
334RE	8602	1398	1245	37' 1"	8'	11' 1"	43	30	60	60	11'
335MK	8528	1472	1210	37' 11"	8'	11' 1"	43	30	60	60	14'/11'

\*Length is defined as the distance from the centerline to the hitch pin/coupler to rear bumper of the trailer. SEE DISCLAIMER ON BACK PAGE



# MID-PROFILE FIFTH WHEELS



## STANDARDS AND OPTIONS

EXTERIOR FEATURES
Aerodynamic painted front cap
Fully enclosed underbelly
Heated, enclosed holding tanks & gate valves
Oversized lighted and heated pass-thru storage
Roto-cast storage for wet or greasy items
Exterior shower with hot & cold water
Exterior marine grade speakers
Rear ladder
Hybrid aluminum entry step
Electric front jacks w/adjustable snap pins
Hitch assist mirror & 2 LED lights w/Max Turn Technology
Outside 110V outlet & TV connection
Water works utility center
Battery disconnect
Solar panel prep
Backup camera prep
Electric slide out system w/manual override
Adjustable extended hitch pin
EZ lube axles
12" electric brakes
INTERIOR FEATURES
Dinette w/storage below
6' 3" slide room height
Ventilating windows on slide out end walls
Residential grade carpet
Stain resistant fabrics
Pleated shades
Designer window treatments
Solid wood steps to upper deck
Raised panel Mortise & Tenon cabinet doors
Friction hinge entry door with built-in shade
KITCHEN
Residential-size overhead cabinets
Sink covers
60/40 deep-bowl stainless steel sink
High-rise faucet with pull-out sprayer
Linoleum floor with cold crack warranty
Ball bearing full extension drawer guides
BATHROOM FEATURES
Oversized shower (select models)
Foot pedal flush porcelain toilet
Medicine cabinet
Skylight over shower
Power roof vent

BEDROOM FEATURES
King bed (N/A 340FL, 38H)
Designer matching headboard
Wardrobe storage
Reading lights
32" bedroom TV (most models)
Washer/dryer prep (most models)
APPLIANCES AND UTILITIES
12V AM/FM/CD/DVD home theater system with bluetooth
18 Cubic foot refrigerator
Microwave with carousel
Range hood and light
15,000 BTU ducted air conditioner
High output range with auto igniter
2-30lb LP bottles with auto changeover
35,000 BTU high-output furnace with auto ignition
Water heater bypass kit
Systems monitor panel
Cable & satellite connections
Easy care alumina-read folding triple entry step
SAFETY FEATURES
Break away switch
Tinted safety glass windows
GFI receptacles
Carbon monoxide detector
Smoke alarm
Propane gas leak detector
Fire extinguisher
BLACK LABEL PACKAGE
Automatic electric leveling system
Road armor suspension system
Hybrid aluminum entry step
Solid surface countertops
LIFE SIZE PACKAGE
48"-50" residential showers
50 amp service
Wired and braced for 2nd air conditioner
18 cubic foot refrigerator
OPTIONS
2nd 13.5K BTU air conditioner
Free standing dinette and chairs
Dual pane windows

# SUPER-LITE



## STANDARDS

EXTERIOR FEATURES
Aerodynamic painted front cap
Fully enclosed underbelly
Heated, enclosed holding tanks & gate valves
Oversized lighted and heated pass-thru storage
Exterior shower w/hot & cold water
Exterior marine grade speakers
Rear ladder
Hybrid aluminum entry step
Electric front jacks w/adjustable snap pins
Hitch assist mirror & 2 LED lights w/ Max Turn Technology
Outside 110V outlet & TV connection
Water works utility center
Electric awning with LED lights
Battery disconnect
Solar panel prep
Backup camera prep
Electric slide out system w/manual override
Adjustable extended hitch pin
EZ lube axles
10" electric brakes
INTERIOR FEATURES
Dinette w/storage below
Ventilating windows on slide out end walls
Residential grade carpet and padding
Stain resistant fabrics
Pleated shades
Designer window treatments
Raised panel mortise & tenon cabinet doors
Solid wood steps to upper deck
Friction hinge entry door with built-in shade
KITCHEN
Residential-size overhead cabinets
Sink covers
60/40 deep bowl stainless steel sink
High-rise faucet with pull-out sprayer
Linoleum floor with cold crack warranty
Ball bearing full extension drawer guides
BATHROOM FEATURES
Oversized 50"x30" showers
Foot pedal flush porcelain toilet
Medicine cabinet
Skylight over bath
Power roof vent

**BUILT**  
FOR THE LONG HAUL



INNOVATION THAT STARTS  
WITH A SOLID FOUNDATION

WWW.KEYSTONERV.COM Keystone RV Company



# FIFTH WHEELS

## AND OPTIONS

BEDROOM FEATURES
60" x 80" Innerspring mattress (most models)
Wardrobe storage
TV hook-up
Reading lights
APPLIANCES AND UTILITIES
12V AM/FM/CD/DVD home theater system with bluetooth
8 cubic foot refrigerator
Microwave with carousel
Range hood and light
15,000 BTU ducted air conditioner
High output range with auto igniter
2-30 lb. LP bottles w/auto changeover
35,000 BTU high-output furnace w/auto ignition
Water heater bypass kit
Systems monitor panel
Cable & satellite connections
SAFETY FEATURES
Break away switch
Tinted safety glass windows
GFI receptacles
Carbon monoxide detector
Smoke detector
Propane gas leak detector
Fire extinguisher
BLACK LABEL PACKAGE
Automatic electric leveling system
Road Armor suspension system
Hybrid aluminum entry step
Solid surface countertops
LIFE SIZE PACKAGE
50" residential showers
50 amp service
Wired and braced for 2nd air conditioner
8 cubic refrigerator
OPTIONS
2nd 13.5K BTU air conditioner
Free standing dinette and chairs
Dual pane windows

# SUPER-LITE TRAVEL TRAILERS



## STANDARDS AND OPTIONS

EXTERIOR FEATURES
Aerodynamic painted front cap
Fully enclosed underbelly
Heated, enclosed holding tanks & gate valves
Oversized lighted pass-thru storage
Exterior shower w/hot & cold water
Exterior marine grade speakers
Rear ladder
Hybrid aluminum entry step
Front cap with rock guard protection and dual battery support
Outside 110V outlet & TV connection
Water works utility center
Battery disconnect
Auto leveling jacks
Solar panel prep
Backup camera prep
Electric slide out system w/manual override
EZ lube axles
10" electric brakes
INTERIOR FEATURES
Dinette w/storage below
Ventilating windows on slide out end walls
Residential grade carpet and padding
Stain resistant fabrics
Pleated fabric shades
Designer window treatments
Raised panel mortise & tenon cabinet doors
Friction hinge entry door with built-in shade
Tri-fold sofa
KITCHEN
Residential-size overhead cabinets
Sink covers
Ball bearing full extension drawer guides
Single basin sink
High-rise faucet with pull-out sprayer
Linoleum floor with cold crack warranty
BATHROOM FEATURES
Oversized 50"x30" showers (most models)
Large radius shower
Foot pedal flush porcelain toilet
Medicine cabinet
Skylight over shower
Power roof vent

BEDROOM FEATURES
Designer matching headboard
Wardrobe storage
Reading lights
60" x 80" innerspring mattress (most models)
Recessed headboard with outlet
TV hook-up
APPLIANCES AND UTILITIES
12V AM/FM/CD/DVD home theater system with bluetooth
Microwave with carousel
Range hood and light
15,000 BTU ducted air conditioner
High output range with auto igniter
2-30 lb. LP bottles w/auto changeover
8 cubic foot refrigerator
LED Awning Lights
LED Ceiling Lights
High-Arch pull down kitchen faucet
40" LED TV
60" x 80" residential queen mattress
50 Amp Service
Aluminum wheels
Radial tires
Arched ceiling
15" tires
SAFETY FEATURES
Break away switch
Tinted safety glass windows
GFI receptacles
Carbon monoxide detector
Smoke detector
Propane gas leak detector
Fire extinguisher
BLACK LABEL PACKAGE
Automatic electric leveling system
Road Armor suspension system
Hybrid aluminum entry step
Electric stabilizer jacks (225, 250)
Solid surface countertops
LIFE SIZE PACKAGE
50" residential showers
50 Amp Service
Wired and braced for 2nd air conditioner
Power tongue Jack
8 cubic refrigerator
OPTIONS
2nd 13.5K BTU air conditioner
Free standing dinette
Dual pane windows



MADURO DECOR AVAILABLE ON ALL MODELS



# LAREDO

by Keystone



## PURCHASING YOUR RV LOCALLY

It's up to you where you purchase your new Laredo, but may we suggest your local dealer? Not only does it help your local economy and provide jobs, but it will also give you an opportunity to develop a service relationship with someone that will come to know you and your coach. Congratulations on finding the best built, best equipped, best value in the industry, and happy travels!



Product information is as accurate as possible at the date of publication of this brochure. Features, floor plans, and specifications are subject to change without notice. Please also consult Keystone's web site at [keystonerv.com](http://keystonerv.com) for more current product information and specifications. Tow Vehicle Disclaimer. CAUTION: Owners of Keystone recreational vehicles are solely responsible for the selection and proper use of tow vehicles. All customers should consult with a motor vehicle manufacturer or their dealer concerning the purchase and use of suitable tow vehicles for Keystone products. Keystone disclaims any liability or damages suffered as a result of the selection, operation, use or misuse of a tow vehicle. KEYSTONE'S LIMITED WARRANTY DOES NOT COVER DAMAGE TO THE RECREATIONAL VEHICLE OR THE TOW VEHICLE AS A RESULT OF THE SELECTION, OPERATION, USE OR MISUSE OF THE TOW VEHICLE.

\*Length is defined as the distance from the centerline of the hitch pin/coupler to rear bumper of the trailer. 12/2017



2642 Hackberry Drive | PO Box 2000  
Goshen, IN 46527-2000  
(574) 535-2100



[WWW.KEYSTONERV.COM/LAREDO](http://WWW.KEYSTONERV.COM/LAREDO)

VISIT OUR WEBSITE TO VIEW INTERIOR PHOTOS, 360 VIRTUAL TOURS AND MUCH MORE.

YOUR LOCAL DEALER IS:



DECEMBER 2017