

HEATING, VENTS, AND AIR CONDITIONING: FEATURES

- One 13.5M BTU and One 11.0M BTU Air Conditioner with Ducted Air and Wall Digital Thermostat
- Electronic Ignition Furnace 35M BTU
- Electronic Dash AC/Heat Climate Control System
- Above Floor Ducted Heating System
- Kitchen Powered Attic Fan with Wall Control of Automatic Dome and Fan Power
- Bath Powered Attic Fan with Wall Control of Automatic Dome and Fan Power
- Satin Nickel Finish Metal Air Return Grill for Furnace

OPTIONS

- Dual 13.5M BTU Air Conditioner, Requires 50 Amp Service
- Dual 13.5M BTU Air Conditioner with Heat Pumps, Requires 50 Amp Service
- 12V Heater in Wet Bay

WINDOWS, DOORS, AND AWNINGS: FEATURES

- Radius Flush Mount Dual Pane Safety Glass Dark Tinted Slider Windows
- Front Entry Door with Clear Glass, Removable Screen, and Anti-Skid Steps
- Exterior Entry Door Grab Handle
- Two Interior Grab Handles, One Floor to Dash and One on Door Jam
- Polyweave Vinyl Patio Awning
- Topper Slide-Out Awnings Living Area and Bedroom
- Tinted Skylight in Bathroom with Protecta Glaze

- Eclipse Automatic Polyweave Patio Awning
- Polyweave Vinyl Front Door Awning
- Window Awnings Living Area Slide-out House Windows (N/A: 34PBD)
- Sidewall Window Awning Bedroom

SAFETY: FEATURES

- Fire Extinguisher
- Deadbolt Lock on Entrance Door
- 120V GFI Protected Circuit, Kitchen, Bath, & Exterior
- LP Gas Detector
- Smoke Detector
- Carbon Monoxide Detector
- Pilot and Co-Pilot Three-Point Seat Belts
- Third Brake Safety Light
- Egress Window's

Due to the large variety of options and floorplan arrangements available to our customers, actual weights for each unit can differ significantly. Holiday Rambler provides a weight sticker on each unit we produce which includes that unit's tank capacities and approximate weight. Consult your local Holiday Rambler dealer for unit availability and further information.

The information printed in this brochure reflects product design, fabrication, and component parts at the date of printing. The manufacturer reserves the right, at any time, to make changes in product design or material or component specifications as its sole option, without notice. This includes the substitution of components of a different brand or trade name, which will result in comparable performance. All information printed in this brochure is subject to change after the date of printing. Some features shown or mentioned in this brochure are optional and may only be available in selected floorplans. Photographs may show props or decorations that are not standard equipment on Holiday Rambler models. Holiday Rambler, the HR logo and its design, are registered trademarks. All other products and company names are trademarks and/or registered trademarks of their respective holders.

While the color of the motorhome's exterior and the interior fabrics depicted in this sales brochure are fair and reasonable depictions, the colors depicted may not be an exact match of the actual colors because of the variances in photo-processing and variances caused by inserting the photographs within the sales brochure. Due to product improvements, changes during the model year and/or transcription errors that may occur, information represented within this brochure may not be accurate at the time of your purchase. If certain information is significant to your purchasing decision, please confirm the information with your dealer prior to submitting your order.

The actual overall length of the recreational vehicle may differ from that indicated in the brochure due to variances in the manufacturing process and/or installed components. The actual length may be greater or less than that indicated.

Component part and appliance manufacturers issue limited warranties covering those portions of the recreational vehicle not covered by the Limited Warranties issued by Monaco Coach Corporation. To learn which specific component parts and appliances are excluded from the Limited Warranties issued by Monaco Coach Corporation, please contact your selling dealership or Monaco Coach Corporation directly, or review the warranty packet inside the recreational vehicle.

Weights	34PBD	34PDD
Gross Vehicle Weight Rating (Lbs.)	22,000	22,000
Gross Combined Weight Rating (Lbs.)*	26,000	26,000
Gross Axle Weight Rating (Front) (Lbs.)	8,000	8,000
Gross Axle Weight Rating (Rear) (Lbs.)	14,500	14,500

Measurements

Wheelbase	192"	192"
Overall Length	34' 6"	36' 6"
Overall Height with A/C, Ford	TBD	TBD
Interior Height	7' 0"	7' 0"
Interior Width	94.5"	94.5"
Exterior Width	100.5"	100.5"

Tank Capacity**

Water Heater (Gal.)	10	10
Gray Tank (Gal.)	60	60
Black Tank (Gal.)	39	39
Fresh Tank (Gal.)	75	75
LP Tank (Gal.)*	16	16

* Actual filled LP capacity is 80% of listing due to safety shut-off required on tank.



606 Nelson's Parkway Wakarusa, IN 46573

www.holidayrambler.com
(800) 245-4778

MONACO COACH CORPORATION

Monaco is traded on the New York Stock Exchange under the listing MNC.
© 2005, Monaco Coach Corporation 11/05 NPN:BROHVAC Litho in USA.



20 VACATIONER® DIESEL 06

HR
HOLIDAY RAMBLER®
This is Living



BRUSHED NICKEL



CANYON MOSAIC—FEATURING FABRICS BY LIZ CLAIBORNE



SPANISH MOSS



BLACKWOOD MANOR II—FEATURING FABRICS BY LIZ CLAIBORNE



NEW VINTAGE OAK CHAMPAGNE SELECT NEWPORT CHERRY

FLOORPLANS

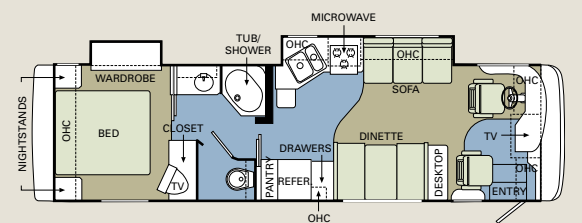

34PBD

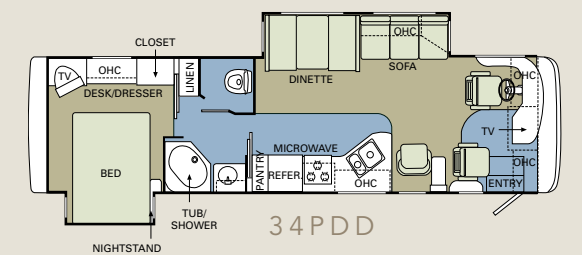

34PDD

- A. BEDSPREAD
B. SOFA
C. CORIAN®
D. ACCENT
E. CARPET

CARPET | TILE

BODY CONSTRUCTION: FEATURES		OPTIONS
<ul style="list-style-type: none"> Alumaframe® Superstructure Steel Cage Cockpit Construction Peaked One Piece Fiberglass Roof with Fiberglass Insulation Smooth Gel Coat Fiberglass Exterior Walls New Front and Rear Molded Fiberglass Caps Rear Cap with Integrated Camera One-Piece Generator Access Door Rear Engine Doors Fiberglass Engine Cover One Piece Front Windshield 84" Interior Height Aluminum Framed Floor on Steel Trusses Laminated Structurwood Flooring 	<ul style="list-style-type: none"> Electric Flush Floor Step Well Cover Interior Paneling with 3/4" Insulation Foam Insulated Floor Framing with Underbelly Power Heated Remote Exterior Front Mounted Mirrors Fog Lights Low profile sealed LED marker lights Pass-through Storage Bays Under Slide-outs One-Piece Polyethylene Storage Compartment Deluxe Full Body Paint with Vinyl Graphics Rear Ladder Interior Rubber Entry Step Exterior Double Entry Steps Undercoating 	<ul style="list-style-type: none"> Front Cap Protective Mask Exterior Chrome Front Mount Mirrors with Heat and Remote
FORD CHASSIS/ENGINE/SUSPENSION: FEATURES		
<ul style="list-style-type: none"> Roadmaster RSR Rail Chassis Cummins ISB-AD 300 HP Low Torque Engine with Allison 1000 MH 5 Speed World Transmission Push button Shift Pad on 1000MH Transmission Engine Displacement: 5.9L/359 cu. In. Torque: 600 lbs/ft. Max. Net at 1,600 RPM 75 Gallon Fuel Tank 	<ul style="list-style-type: none"> 156 Amp Alternator Rear Axle Ratio: 4.78:1 Radial Tires: 255/70R/22.5 Stainless Steel Wheel Simulators Leaf Spring Suspension Four Gas Shock Absorbers Hydraulic Anti-Lock Braking System Pre-wire for Supplemental Braking System 	<ul style="list-style-type: none"> Air Cleaner Restriction Indicator Fuel/Water Separator Remote Transmission Fill Fully Automatic Hydraulic Leveling System 4,000Lb. Hitch Receiver with Dual Connector 4-Pin or 7-Pin
COCKPIT: FEATURES		OPTIONS
<ul style="list-style-type: none"> Fiberglass Automotive Dash with Grey Diamond Brush Instrumentation Panel CD Player/Radio with DVD Player, Sirius Ready Compatibility, Weather Band, Remote, and Six Speakers Power Sunvisors Pilot and Co-pilot front overhead with raised panel cabinet doors Front cab over TV's secured with steel framing Rear Vision System with Audio and Adjustable Camera Intermittent Windshield Wipers 6-Quart Tank for Windshield Fluid Tilt/Telescopic Steering Wheel Cruise Control Power Steering Electric Automotive Horn 	<ul style="list-style-type: none"> Molded pilot side console, with Two Tier Cup Holder and Control Pad for Transmission Shifter Molded co-pilot side console, with Two Tier Cup Holder Map pocket on pilot side console Vinyl Covered Molded Center Console with Drawer and Tip-tray Storage New Style Soft Touch Vinyl Pilot & Co-Pilot Recliner Seats (N/A with Blackwood Manor II and Canyon Mosaic, Décor's by Liz Claiborne) New Style Distressed Optima Leather Pilot & Co-Pilot Seats (Blackwood Manor II and Canyon Mosaic, Décor's by Liz Claiborne Only) Six- Way Power Pilot Seat Seat belt Warning Light on Dash Carpeted Driver and Passenger Floor Mats 	<ul style="list-style-type: none"> Six-Way Power Co-Pilot Sea Optima Leather Pilot and Co-Pilot Seats (N/A with Blackwood Manor II and Canyon Mosaic, Décor's by Liz Claiborne) 3-Camera Rear Vision System with Audio and Adjustable Center Camera CB Radio Prep
APPLIANCES AND ACCESSORIES: FEATURES		OPTIONS
<ul style="list-style-type: none"> Large Double-Door Refrigerator with Icemaker 8 cuft High-Output Three-Burner Cook Top Removable Solid Surface Range Covers Convection Microwave with Touch Control and Under Mounted Range hood 24" Flat Screen Stereo Color TV with Remote Control in Living Area 20" Flat Screen Color TV with Remote Control in Bedroom TV Antenna 	<ul style="list-style-type: none"> DVD and Video Control Box with Booster and RF Modulator. Exterior Hook-ups for DSS Dish and Cable Interior Cable TV Hook-Up and Telephone Jacks Digital Satellite System Prep Wiring for DVD Player Hook-up to Both TV Locations Exterior Gas Line Hook-up Prep for LP Accessories 	<ul style="list-style-type: none"> Large Double-Door Refrigerator with Icemaker 10 cuft Large Four-Door Refrigerator with Icemaker (N/A with Pantry) High Output Three-Burner Range with Oven Home Theater Surround Sound System added to In-dash Stereo with DVD Player Exterior Entertainment Center, CD Player Radio with Two Speakers
FURNITURE: FEATURES		OPTIONS
<ul style="list-style-type: none"> Queen Bed with Nightstand(s) Party Table behind Co-Pilot Seat (N/A: 34PBD) Arched Back Wood Booth Dinette with Side Sliding Table Top Forward Facing Seat Belts at Booth Dinette Location. (N/A: 34PDD) Fabric Jackknife Sofa with Two pillows Fabric Swivel Glider Barrel Chair (N/A: 34PBD) 	<ul style="list-style-type: none"> Fabric Hide-A-Bed Sofa with Air Mattress, and Two Pillows (N/A with Booth Dinette 34PDD) Optima Leather Swivel Recliner Chair IPO Fabric Swivel Glider Barrel Chair (N/A: 34PBD) Two Optima Leather Swivel Recliner Chairs with Center Table IPO Booth Dinette (N/A: 34PDD) 	<ul style="list-style-type: none"> Optima Leather Euro Recliner Chair with Heat, Massage and Ottoman IPO Fabric Swivel Glider Barrel Chair (N/A: 34PBD) Two Optima Leather Euro Recliner Chairs with Heat, Massage, Ottoman, and Center Table IPO Booth Dinette (N/A: 34PDD) Bedroom Desk (N/A: 34PBD) Free-Standing Dinette with Two Freestanding Chairs, and Two Folding Chairs

INTERIOR: FEATURES		OPTIONS
<ul style="list-style-type: none"> New Vintage Oak Cabinetry Upper Raised Panel Hardwood Cabinet Doors with Flat Panel Doors on all Lower Cabinet and Bedroom Wardrobe Doors Hardwood Cabinet End Panels in Living Area Black ABS Refrigerator Insert Wallpaper Border Inside Private Bath Mini-Struts on Top Hinged Overhead Storage Doors and Positive Catches on all Other Doors Heavy Duty Ball Bearing Drawer Guides Wood Cabinet Drawer Boxes Satin Nickel Cabinetry Hardware and Bath Accessories Solid Surface Radius Profile Kitchen Countertop with Under Mounted Plexus-stone Sink with Two Sink Covers Toe Kicks on Kitchen and Bath Base Cabinets Kitchen Countertop End Splash (N/A: 34PDD) Laminate Bathroom Countertop with ABS Decorative Backsplash, and Laminate Perm-Edge Dinette Countertops Laminated with Wood Edge All Others Countertops Hardwood, Except Kitchen, Dinette, & Bath Lav Kitchen Overhead Cabinets with Adjustable Shelf Kitchen Pantry Next to Refrigerator with Roll-out Storage in Upper Cabinet and Three Drawers below (N/A with Four Door Refrigerator Option) 	<ul style="list-style-type: none"> Smoked Mirrors behind Stove Area Linoleum Flooring Kitchen, Bath, and Entry Way Textured Style Nylon Carpeting with Pad in Living Area and Bedroom Soft Touch Padded Vinyl Ceiling Wood Slide-out Fascia with Vinyl Inserts Living Area; Beveled Edge Mirror with Beveled V-Grooves, Wainscoting Accent under Mirror (N/A: 34PBD) Bath Door with Accent Trim on Hallway Side Wood Trim on Bath Door Accent Mirror on Rear Bedroom Wall with Wainscoting and Chair Rail Accent Under Mirror (N/A: 34PBD) Bedsread with Two Decorative Pillows Decorative Fabric Headboard Blackout Day/Night Pleated Shades in Living Area and in Bedroom Mini Blinds in Kitchen (N/A: 34PBD) Soil Repellant on Fabric, Teflon Fabric Protection 	<ul style="list-style-type: none"> Decors: Brushed Nickel, Mesa Pine, Spanish Moss, Blackwood Manor II — Liz Claiborne, Canyon Mosaic — Liz Claiborne Wood Choices: Newport Cherry, Champagne Select
ELECTRICAL SYSTEMS AND LIGHTS: FEATURES		OPTIONS
<ul style="list-style-type: none"> 30 Amp 120V Distribution Panel and Power Cord 55 Amp Electronic 12V Power Converter Onan 5.5 kW Diesel Generator Two 6V House Batteries Two 12V Heavy Duty Chassis Batteries Battery Disconnect Switch at Front Door 12V & 110V Outlet in Cockpit Area Porch Light and Exterior Step Light on Same Switch Exterior Power Entry Step, with Light Interior Step Well Entry Step Lights Water Pump Switch in Service Bay Area and Convenience Center Lights in Outside Storage Compartments 110V Receptacles In Outside Storage Compartment 	<ul style="list-style-type: none"> Under Hood Utility Light Receptacle and Phone Jack in Dinette Area Directional Map Lights Pilot and Co-Pilot Seats Redesigned Convenience Center In Hallway Fluorescent Ceiling Lights Living Area and Bath Satin Nickel Decorative Lighting: Living Room Wall Light at Sofa Location, Dinette Ceiling Light, Bedroom Cosmetic, 34PDD, and Bath Vanity Light Satin Nickel Swing Arm Light at Barrel Chair Location (N/A: 34PBD) 12V Incandescent Clear Lens Single Pancake Lights with His and Hers Switches above Bed Wardrobe Closet Lights 	<ul style="list-style-type: none"> Energy Management System with 50 AMP Service 50 Amp 120V Distribution Panel and Cord 140 Watt Inverter
PLUMBING AND LP SYSTEMS: FEATURES		OPTIONS
<ul style="list-style-type: none"> Kitchen Composite Under-Mounted Sink with Single Lever Satin Nickel Faucet with Pull-Out Sprayer Separate Satin Nickel Finish Faucet for Filtered Water Bath Lav Faucet Single Handle Satin Finish Demand Water System and Water Pump 10 Gallon LP Gas/Electric Water Heater with Electronic Ignition, DSI Winterization Valving System Water Heater By-Pass Valve Toilet with Sprayer No-Fuss Flush Holding Tank Rinsing System 	<ul style="list-style-type: none"> Insulated Systems Compartment with Easy Access to Hook-Up Shower Inside Wet Bay with Hot/Cold Water Soap Dispenser inside Utility Bay Pressurized Water Fill Contained Storage Area for Sewer Hose One-Piece Fiberglass Shower Shower Diverter, Hose and Head Satin Finish with Satin Slide Bar for Shower Head with Soap Dish Satin Nickel Shower Door Frame with Clear Glass 	<ul style="list-style-type: none"> Bath Tub Option IPO Shower