

# 2025 ESTEEM XL

## *Diesel Super Class C Motorhome*

30M

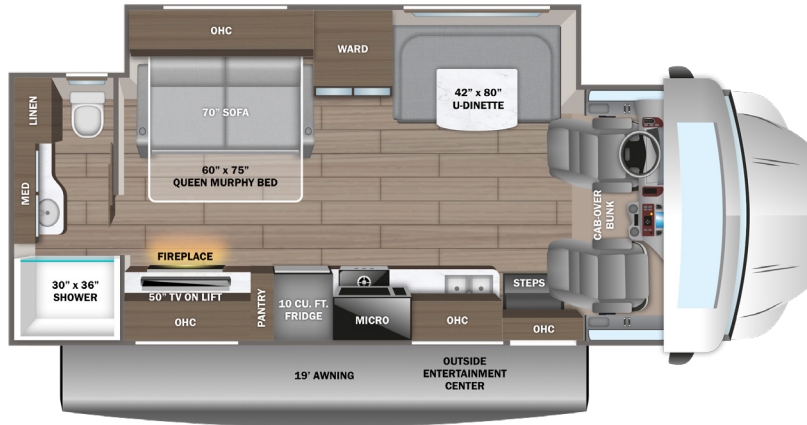

32U

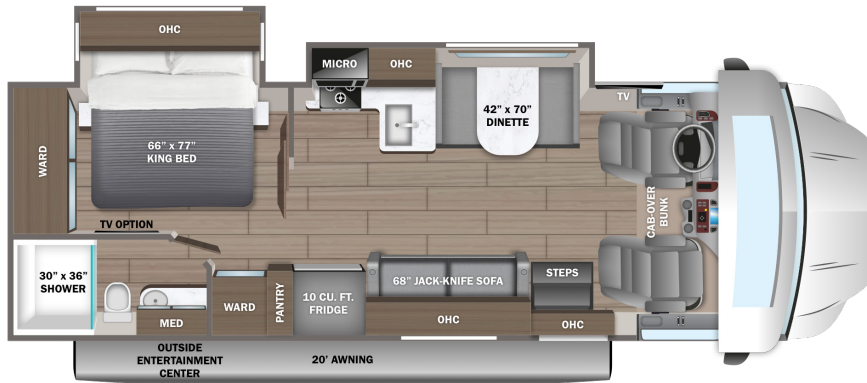

33F

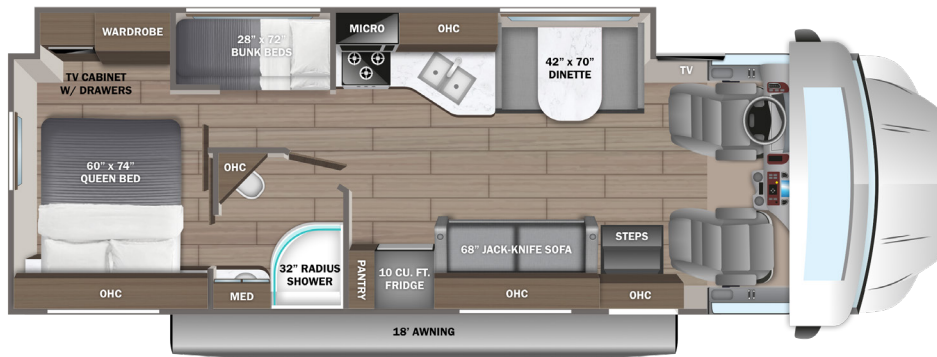

### EXTERIOR



Standard Partial Paint

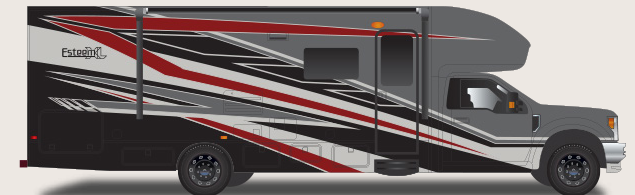

Harvest Night Full-Body Paint



Night Shade Full-Body Paint



Summer Equinox Full-Body Paint



Winter Sky Full-Body Paint

# ESTEEM XL

# Standards & Options

## CUSTOMER VALUE PACKAGE

E-Z Drive™ Elite: Computer-balanced driveshaft, heavy-duty rear stabilizer bar and standard front stabilizer bar  
One-piece, seamless fiberglass front cap  
Automotive-bonded panoramic window in front cap with power shade  
Automatic hydraulic leveling jacks  
Frameless windows  
Electric patio awning with LED lights  
6,000W generator with auto-gen start  
2,000W inverter  
15,000 BTU A/C with heat pump  
200W solar panel with dual controller and second house battery  
Firefly Multiplex system - wall-mounted touchscreen and mobile app for total coach control  
LED HD Smart TV in living area

## STANDARD CHASSIS EQUIPMENT

Ford® F550 4X4 chassis (30M, 32U)  
Ford® F600 4X4 chassis (33F)  
GVWR - 19,500 lb. (30M, 32U); 22,000 lb. (33F)  
GCWR - 31,500 lb. (30M, 32U); 34,000 lb. (33F)  
6.7L Power Stroke V8 Turbo diesel engine with block heater  
- 330 HP at 2,200 RPM and 950 ft. lb. torque at 1,800 RPM  
10-speed automatic transmission  
332-amp alternator  
G-rated tires- 225/70R19.5 (30M, 32U)  
All-terrain tires - 245/70R19.5 (33F)  
Steel wheels with matte black liners  
Hellwig® helper springs (30M, 32U)  
12,000 lb. rear hitch receiver  
7-pin plug  
Ford® AdvanceTrac® with RSC® (roll stability control) and trailer sway control  
Integrated trailer brake controller  
Dual chassis batteries (750 CCA 78 AH)  
Dual fuel tanks (26.5 gal. and 40 gal.)  
2 in. rear lift

## STANDARD EXTERIOR EQUIPMENT

TuffShell™ vacuum-bond laminated roof, floor and sidewalls  
Bead-foam insulation (R-24 max roof, R-9 max floor, R-5 max walls)  
One-piece, seamless, fiberglass roof  
Fiberglass exterior walls with partial paint and vinyl graphics  
Entrance door with industry's largest travel-view window  
Electric-powered entrance step with integrated house battery compartment  
Slideout awning(s)  
Exterior LED HD Smart TV with (2) high-output, marine-grade exterior speakers  
Lockable storage compartments with slam latches  
Third brake light  
Roof ladder  
Prep for satellite dish  
Cable TV hookup with RG-6 coax

Winegard 2.0 Wi-Fi/4G antenna  
(2) 6V AGM house batteries  
Transfer switch with reverse polarity protection  
50-amp electrical service  
Detachable power cord  
16.5 gal. propane tank (56 lb.)  
LP quick-connect hookup  
Heated holding tanks (12V pads)  
Exterior utility center  
Winterization drain system  
Black tank flush  
Outside shower  
12V demand water pump  
Water filtration system

## STANDARD COCKPIT EQUIPMENT

Replace with - Ford® SYNC® 4 infotainment center with Apple® CarPlay™ and Android Auto™  
Audible lane departure warning  
Pre-Collision Assist® with automatic emergency braking (AEB)  
SOS Post Crash Alert System™  
Driver and passenger airbags  
Safety Canopy® system with roll-fold side-curtain airbags  
Remote keyless entry and perimeter anti-theft alarm  
SecuriLock® anti-theft ignition  
Quad dual-beam halogen headlights  
Rainlamp wiper activated headlights  
Remote start  
Adjustable gas/brake pedals  
Cruise control  
Power windows and door locks  
Auxiliary start switch  
8-way power driver seat  
Tilt steering wheel  
Privacy curtain for cab area

## STANDARD INTERIOR EQUIPMENT

Custom-molded ABS surround in cab-over area  
Overhead bunk with 750 lb. capacity and safety net  
84 in. interior ceiling height with padded vinyl ceiling  
High-intensity recessed LED ceiling lights  
LED-lit fascia  
Hardwood cabinet doors and drawer fronts  
Deluxe hidden cabinet hinges  
Ball-bearing drawer guides  
Blackout night roller shades  
30,000 BTU auto-ignition furnace  
10 gal. gas/electric water heater  
JBL® audio system  
Entegra-exclusive, easy-operation legless dinette table (32U,33F)  
U-shaped dinette (30M)  
2-point lap safety belts in all designated seating locations  
Car seat tethers (select floorplans)

10 cu. ft. 12V refrigerator  
Furrion® all-in-one cooktop and oven  
Residential-size microwave  
Recessed stainless steel kitchen sink with sink covers  
Solid-surface kitchen countertops  
Decorative kitchen backsplash  
Pop-up charging station in kitchen with 120V outlets and USB ports  
Walk-around, king-size bed with bedspread and nightstands (32U)  
Queen-size power Murphy Bed (30M)  
Queen-size bed with bedspread and nightstands (33F)  
Bunks with industry-exclusive 300 lb. capacity each (33F)  
USB port and wireless charging in nightstands  
Large wardrobes  
Shower with decorative surround, glass door, skylight and light  
Wall-mounted tablet holder in each bunk (33F)  
Recessed stainless steel bathroom sink  
Porcelain toilet with foot flush  
Powered roof vent in bathroom with wall switch  
Smoke alarm  
Carbon monoxide detector  
Fire extinguisher

## OPTIONS

Power theater seating  
LED HD Smart TV in bedroom (32U, 33F)  
15 cu. ft. 12V refrigerator (32U, 33F)  
Dual A/C units (15,000 and 13,500 BTU) with power management system  
Aluminum rims  
Folding windshield sun shade



## NO ONE OFFERS A BETTER WARRANTY

At Entegra Coach, we build our RVs to handle every adventure, then back them with our industry-leading 2+3 limited warranty. Our 2-year limited warranty has you covered for 2 camping seasons. That's 730 days. In addition, our 3-year structural limited warranty has you covered for 3 camping seasons or 1,095 days. You won't find a better limited warranty in the business, because the only strings we attach are those that deliver the ultimate in reliability. For a copy of our 2-year limited + 3-year structural limited warranty with complete terms and conditions, please contact your local Entegra Coach dealer.

Floorplan	GVWR (lbs.)	GCWR (lbs.)	Wheel Base	Overall Length	Exterior Height w/ A/C & Satellite	Exterior Width	Interior Height	Fresh Water Capacity (gal.)	Grey Waste Water Capacity (gal.)	Black Waste Water Capacity (gal.)
30M	19,500	31,500	212"	31' 4"	12' 6"	100"	84"	53	31	31
32U	19,500	31,500	227"	33' 5"	12' 6"	101"	84"	42.5	31	31
33F	22,000	34,000	248"	34' 11"	12' 6"	100"	84"	53	32	32

It is important for your safety and enjoyment that you are aware of the weights and tow ratings of the RV you select. Consult a competent advisor for questions or advice. Whether you are new to RVing or a veteran, get a feel for the performance of your RV before heading out on the roadways. When you tow a vehicle with your RV, you must drive differently than when you drive a single vehicle. Practice hooking up, driving, backing up and braking in a safe environment or seek out professional instruction. Jayco affixes a weight label to each RV which lists weight information for that vehicle. Refer to that label to verify the vehicle will meet your requirements. Gross Vehicle Weight Rating (GVWR): The maximum permissible weight of the motorhome, including the Unloaded Vehicle Weight (UVW) plus passengers, personal items, all cargo, fluids, options and dealer-installed accessories. The GVWR is equal to or greater than the sum of the UVW and the Cargo Carrying Capacity. Gross Combined Weight Rating (GCWR): The maximum allowable combined weight of the motorhome used as a tow vehicle and the attached towed vehicle.



**ENTEGRA**  
COACH®

Part of Jayco Family of Companies

Entegra Coach, Inc., P.O. Box 460, Middlebury, IN 46540, [www.entegracoach.com](http://www.entegracoach.com). See dealer for further information and prices. All information in this brochure is the latest available at the time of publication approval. Entegra Coach reserves the right to make changes and to discontinue models without notice or obligation. Photos in this brochure may show optional equipment and props for photography purposes. RVs built for sale in Canada may differ to conform to Canadian codes. ©2025 Entegra Coach, Inc. Printed in U.S.A. 2032942



[entegracoach.com/esteem-xl](http://entegracoach.com/esteem-xl)

LEGACY ISN'T LEFT,  
IT'S LIVED.