

The **FAST GET-AWAY**  
*that's built for a lifetime of slowing down.*



JAY SERIES SPORT

JAY SERIES

BAJA



**Jayco**<sup>®</sup>

Generations of family fun.

JAY SERIES SPORT

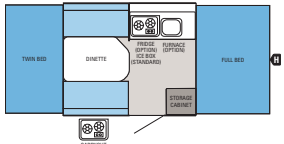

JAY SERIES SPORT | 8 Sleeps: 5-6

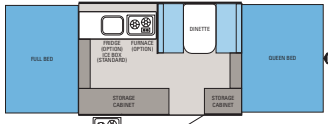

JAY SERIES SPORT | 10 Sleeps: 5-6

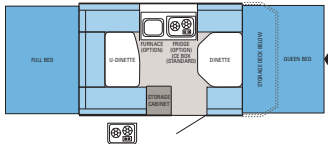

JAY SERIES SPORT | 10FD Sleeps: 6-7

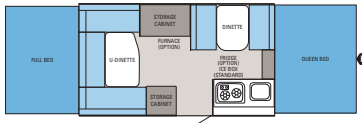

JAY SERIES SPORT | 12 Sleeps: 7-8

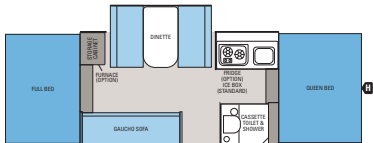

JAY SERIES SPORT | 12BS Sleeps: 6-7

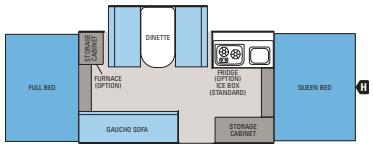

JAY SERIES SPORT | 12SC Sleeps: 6-7

JAY SERIES

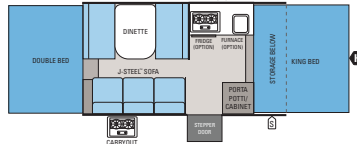

JAY SERIES | 1006 Sleeps: 6-7

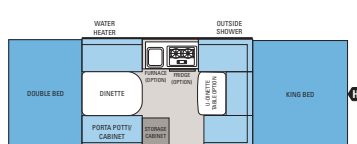

JAY SERIES | 1007 Sleeps: 6-8

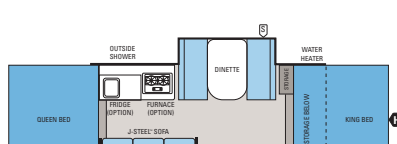

JAY SERIES | 1206 Sleeps: 6-7

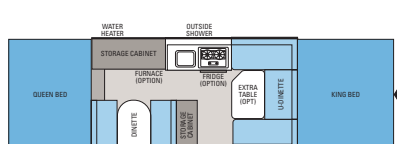

JAY SERIES | 1207 Sleeps: 6-7

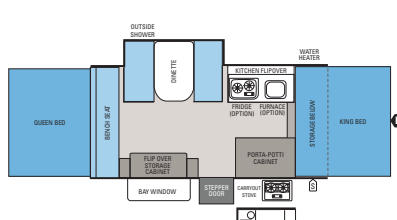

JAY SERIES | 1208 Sleeps: 5-6

BAJA

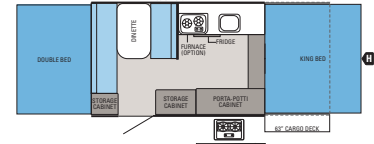

BAJA | 10G Sleeps: 5-6

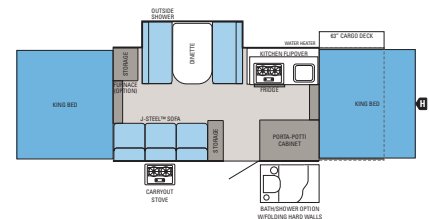

BAJA | 12E Sleeps: 6-8

INTERIOR DÉCOR

JAY SERIES SPORT

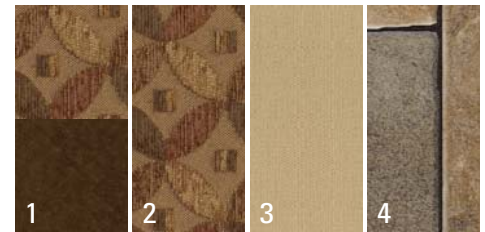

JAY SERIES AND BAJA

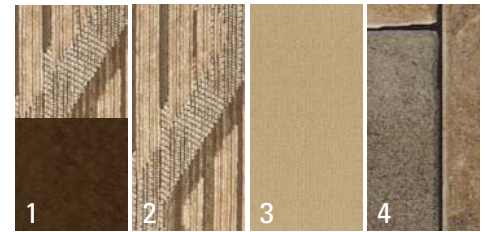

- 1 Dinette
- 2 Accent
- 3 Drapery
- 4 Flooring

SPECIFICATIONS

	FLOORPLAN	EXT. LENGTH	CAMPSITE LENGTH	EXT. WIDTH	TRAVEL HEIGHT	UNLOADED VEHICLE WEIGHT (LBS.)	DRY HITCH WEIGHT (LBS.)	GROSS VEHICLE WEIGHT RATING (LBS.)	CARGO CARRYING CAPACITY (LBS.)	FRESH WATER CAPACITY (GAL.)	GRAY WASTEWATER CAPACITY (GAL.)	TOILET/BLACK WASTEWATER CAPACITY (GAL.)
JAY SERIES SPORT	8	11' 7"	16' 2"	85"	56"	1,210	190	1,995	785	10	N/A	N/A
	10	13' 6"	19' 6"	85"	57"	1,390	160	2,250	860	10	N/A	N/A
	10FD	16' 7"	20' 11"	85"	57"	1,540	175	2,350	810	10	N/A	N/A
	12	15' 6"	21' 6"	85"	56"	1,525	205	2,350	825	10	N/A	N/A
	12BS	15' 6"	21' 6"	85"	59"	1,980	245	2,700	720	10	N/A	5
	12SC	15' 6"	21' 6"	85"	58"	1,825	240	2,550	722	10	N/A	N/A
JAY SERIES	1006	16' 2"	20' 10"	85"	60"	2,036	224	2,950	914	17	0	0
	1007	14' 2"	20' 10"	85"	59"	1,820	165	2,550	730	17	0	0
	1206	18' 2"	23' 4"	85"	61"	2,455	275	3,450	995	17	11*	5*
	1207	16' 2"	23' 4"	85"	60"	2,025	175	2,950	925	17	0	0
	1208	18' 2"	23' 4"	85"	60"	2,525	303	3,490	965	17	11*	5*
BAJA	10G	20' 6"	24' 2"	85"	69"	2,520	300	4,550	2,030	30.5	11*	5*
	12E	22' 6"	27' 6"	85"	69"	2,895	370	4,850	1,955	30.5	11*	5*

\*With optional bath/shower. Note: The weights of certain options and/or option packages are not included in the UUV listed in the specification charts.

**Unloaded Vehicle Weight (UUV):** Sometimes referred to as "Dry Weight," UUV means the typical weight of this trailer as built at the factory. The UUV, as used in product literature and other promotional materials, does not include cargo, fresh water, propane, options or dealer-installed accessories.

**Gross Vehicle Weight Rating (GVWR):** GVWR means the maximum permissible weight of the trailer, including the UUV plus passengers, personal items, all cargo, fluids, options, and dealer-installed accessories. The GVWR is equal to or greater than the sum of the UUV and the CCC.

**Cargo Carrying Capacity (CCC):** CCC means the maximum weight of all passengers, personal items, food, fresh water, propane, tools, other cargo and dealer-installed accessories that can be carried by the trailer. CCC is equal to or less than GVWR minus UUV. The addition of options will decrease the CCC.

**Hitch Weight (HW):** The hitch weight, as used in product literature and other promotional materials, does not include cargo, fresh water, propane, gas, options or dealer-installed accessories. The addition of these types of items will either add to or subtract from the stated hitch weight.

It is important for your safety and enjoyment that your tow vehicle be adequately sized and equipped to tow and handle the GVWR of the RV you select. Review weights and rating of your tow vehicle and consult a competent advisor for questions or advice. Whether you are new to RVing or a veteran, get a feel for the performance of your tow vehicle before heading out on the roadways. When you performance of your tow vehicle before heading out on the roadways. When you tow an RV, you must drive differently than when you drive a single vehicle. Practice hooking up, driving, backing up and braking in a safe environment or seek out professional instruction. Jayco affixes a weight label to each RV which lists weight information for that vehicle. See specifications chart above.



## JAY SERIES SPORT

### STANDARD EXTERIOR EQUIPMENT

- Heavy-duty, corrosion-resistant A-frame construction
- Floor constructed of one-piece Structurwood and wrapped with Poly Flex underbelly material
- Scratch-resistant, embossed aluminum exterior finish
- Mildew-resistant aluminum ceiling
- Domed, seamless fiberglass roof
- Lifter post covers integrated into tent
- DuraTek water-repellent sectionalized tent with 1,050-lb. rated beds
- One-piece construction entrance door with self-storing screen door and access when roof is lowered
- Heavy-duty entrance door securement latches
- Leaf spring suspension system
- 12V electrical system with 110V converter
- 20-lb. propane gas bottle
- 30-amp power cord
- 120V G.F.C.I. protected exterior receptacle
- Prep wiring for battery
- Bumper-welded steel construction
- Leveling tongue jack

### STANDARD INTERIOR EQUIPMENT

- Ball bearing drawer guides, 75-lb. capacity with full-drawer extension
- Acrylic sink and faucet
- Appliances, pre-plumbed for propane
- 35-lb. ice box
- Booth dinette with carry-out table
- Coordinated furniture, designed and made by Jayco
- Tinted vinyl windows with fine-mesh screening
- Window drapes and 4" ceiling valances
- Wall-to-wall Diamondflor vinyl flooring
- Auxiliary 12V jack and privacy curtains for bunk ends
- Cassette toilet and shower (12BS)

### CUSTOMER VALUE PACKAGE (MANDATORY)

- 14" x 14" roof vent
- E-Z Lube axles
- Crank-down rear stabilizer jacks with sand pads
- Stainless-steel, carry-out stove with wind deflectors
- 10-gal. fresh water system with 12V demand pump
- Non-sliding, 4" deep cushions for dinette with reversible EZ-Clean vinyl backs

### OPTIONS

- Customer Value Package
- Self-storing awning made by Jayco
- Electric brakes
- Spare tire with carrier and cover
- Prep for roof A/C
- 16,000-BTU furnace with auto ignition
- 2-cu. ft. 3-way gas/electric refrigerator
- Deluxe Plumbing Package
- Heated bed mats

## JAY SERIES

### STANDARD EXTERIOR EQUIPMENT

- Heavy-duty, corrosion-resistant A-frame construction
- Floor constructed of one-piece Structurwood and wrapped with Poly Flex underbelly material
- Scratch-resistant, embossed aluminum exterior finish
- Mildew-resistant aluminum ceiling
- Domed, seamless fiberglass roof
- 14" x 14" roof vent
- Prep for A/C accommodating all roof-mounted A/Cs
- Roof prepped for bike carrier
- Jayco's original, fully enclosed lifter system with lifter post covers integrated into tent (same design used since 1968)
- Power roof lift with hand-held remote key fob
- DuraTek water-repellent sectionalized tent with 1,050-lb. rated beds
- Permanently attached bed support poles
- Diamond plate on front and rear walls
- One-piece construction entrance door with self-storing screen door and access when roof is lowered
- Stepper door
- Radial tires
- E-Z Lube axles with leaf spring suspension system
- Spare tire and tire carrier with vinyl tire cover
- Stainless-steel, carry-out stove with wind deflectors
- Outside shower
- 12V electrical system with 110V converter
- 30-amp power cord
- Prep wiring for battery
- Bumper-welded steel construction
- Crank-down stabilizer jacks with sand pads
- Leveling tongue jack

### STANDARD INTERIOR EQUIPMENT

- Real-wood drawers with ball bearing drawer guides, 75-lb. capacity and full-drawer extension
- Acrylic sink and faucet
- 6-gal. water heater
- 17-gal. fresh water system with 12V demand pump
- Water heater bypass system
- Appliances, pre-plumbed for propane
- Booth dinette with carry-out table
- Non-sliding, 4" deep cushions for dinette with reversible EZ-clean vinyl backs
- Coordinated furniture, designed and made by Jayco
- J-Steel sofa (select models)
- SoftShade window shades and valances
- Tinted vinyl windows with fine-mesh screening
- Porta-potti storage cabinet (select models)
- Wall-to-wall Diamondflor vinyl flooring
- Auxiliary 12V jack and privacy curtains for bunk ends

### CUSTOMER VALUE PACKAGE (MANDATORY)

- Self-storing awning made by Jayco
- 2-cu. ft. 3-way gas/electric refrigerator (110V/12V/propane)
- Water purification system
- Bunk-end fan lights (2)

### OPTIONS

- Customer Value Package
- Deluxe screen room
- Electric brakes (standard on select models)
- Hydraulic surge brakes
- Outside grill
- Multi-Media stereo with outside speakers
- 16,000-BTU furnace with auto ignition
- 2nd table with pedestal leg (select models)
- Bath/shower (select models)
- Heated bed mats
- Powered roof vent

## BAJA

### STANDARD EXTERIOR EQUIPMENT

- Heavy-duty, corrosion-resistant A-frame construction
- Floor constructed of one-piece Structurwood and wrapped with Poly Flex underbelly material
- Scratch-resistant, embossed aluminum exterior finish
- Mildew-resistant aluminum ceiling
- Domed, seamless fiberglass roof
- 14" x 14" roof vent
- Prep for A/C accommodating all roof-mounted A/Cs
- Roof prepped for bike carrier
- Jayco's original, fully enclosed lifter system with lifter post covers integrated into tent (same design used since 1968)
- Power roof lift with hand-held remote key fob
- DuraTek water-repellent sectionalized tent with 1,050-lb. rated beds
- Permanently attached bed support poles
- Diamond plate on front and rear walls
- One-piece construction entrance door with self-storing screen door and access when roof is lowered
- 15" off-road Dunlop Mud Rover radial tires
- Electric brakes
- E-Z Lube axles with leaf spring suspension system
- Spare tire and tire carrier with vinyl tire cover
- Utility deck, rated for 1,500 pounds, with ramps/deck railing (dual use) with quick-connect deck attachment system
- Self-storing awning made by Jayco
- Stainless-steel, carry-out stove with wind deflectors
- Outside shower
- Double 20-lb. propane gas bottles with vinyl cover
- 12V electrical system with 110V converter
- 30-amp power cord
- Prep wiring for battery
- Bumper-welded steel construction with 4" tubular steel rear bumper
- Crank-down stabilizer jacks with sand pads
- Leveling tongue jack

### STANDARD INTERIOR EQUIPMENT

- Raised-panel cabinet doors
- Real-wood drawers with ball bearing drawer guides, 75-lb. capacity and full-drawer extension
- Acrylic sink and faucet
- 6-gal. water heater
- 30-gal. fresh water system with 12V demand pump
- Water heater bypass system
- Appliances, pre-plumbed for propane
- 2 cu. ft. 3-way gas/electric refrigerator (110V/12V/propane)
- Booth dinette with carry-out table
- Non-sliding, 4" deep cushions for dinette with reversible EZ-clean vinyl backs
- Coordinated furniture, designed and made by Jayco
- J-Steel sofa (select models)
- SoftShade window shades and valances
- Tinted vinyl windows with fine-mesh screening
- Porta-potti storage cabinet (select models)
- Wall-to-wall Diamondflor vinyl flooring
- Bunk-end fan lights (2)
- Auxiliary 12V jack and privacy curtains for bunk ends

### CUSTOMER VALUE PACKAGE (MANDATORY)

- Awning
- Solar prep
- Polished aluminum rims
- Multi-Media stereo with outside speakers
- Battery gauge
- Water purification system

### OPTIONS

- Customer Value Package
- Deluxe screen room
- Front storage box
- Outside grill
- 16,000-BTU furnace with auto ignition
- Bath/shower
- Heated bed mats
- Powered roof vent



# 2-YEAR WARRANTY

# 1-YEAR ROADSIDE ASSISTANCE



**HITCH  
to  
BUMPER**  
LIMITED WARRANTY\*

## Peace of mind comes standard.

Nobody offers a better warranty than Jayco. With our exclusive 2-year Co-Pilot Limited Warranty, the only strings we attach are those that deliver the ultimate in reliability. At Jayco, your peace of mind is our priority, and that's the Jayco difference.

**Coach-Net**<sup>®</sup>  
RV Technical & Roadside Assistance

Travel worry-free with Jayco's Customer First Roadside Assistance program, yours at no cost during your first year of ownership. This program is offered through Coach-Net, the largest RV emergency road service in the country, and gives you immediate access to dependable roadside assistance and support services with a simple phone call.

\*For a copy of our 2-year limited warranty with full terms and conditions, please contact your local Jayco dealer or visit Jayco.com.



## The Jayco dealer network is four decades strong with the support of more than 300 dealerships.

From making recommendations to servicing products, we consider our loyal dealers the glue in our family bond. Establishing a solid relationship with your local Jayco dealer is a key component in the enjoyment of your new Jayco. By purchasing from a local dealer, you will have a convenient location for sales, parts and service support. We hope you consider them a part of your camping family.

Jayco, Inc., P.O. Box 460, Middlebury, IN 46540, [www.jayco.com](http://www.jayco.com) RVIA

See dealer for further information and prices. All information in this brochure is the latest available at the time of publication approval. Jayco reserves the right to make changes and to discontinue models without notice or obligation. Photos in this brochure may show optional equipment and props for photography purposes. RVs built for sale in Canada may differ to conform to Canadian codes. ©2013 Jayco, Inc. 2014 Camping Trailers.cdr JM 10-13 Printed in U.S.A.

## eCO advantage™

Jayco's long-term commitment to protecting the environment.



Scan this QR code with your smartphone to watch a video about our efforts and the impact we're making on our planet.

[jayco.com/ecoadvantage](http://jayco.com/ecoadvantage)

Follow us on