

ELITE, GRAND TOURING AND EXPRESS TRAVEL TRAILERS

Passport

ULTRA LITE

by Keystone



GO ANYWHERE



Passport

ULTRALITE
by Keystone

With customer demand for lightweight fuel efficient travel trailers at an all time high, the Passport from Keystone is sure to be the pick of families who want to maximize fuel efficiency, but still maintain all the conveniences of a well appointed, feature packed RV. Sure, towability led you to the Passport, but when you need a travel trailer for those fun weekends or the extended cross country excursion you realize Passport has a full array of features and conveniences built into every model! You know you have arrived at the pinnacle of lite weights when you roll in with a Passport.



PAGES 3-7

EXPRESS SUPER LITE



The Express Super Lite looks small, but packs a big punch when it comes to living space. Go Anywhere and explore.



PAGES 8-12

GRAND TOURING



With size and features of a full size camper, the Passport Grand Touring is still made for today's SUV's and half ton vehicles.



PAGES 13-17

ELITE



Taking camping to the next level, Passport Elite has created the ultimate in lightweight luxury!





199ML SHOWN IN RATTAN DECOR

Passport
ULTRA LITE
by Keystone

★ ★ ★ ★ ★
**EXPRESS
SUPER LITE**



What looks small but packs a big punch when it comes to living space? The Passport Express Super Lite! Whether it's the feel of sleeping in the open air with our expandable models or the need for a trailer that can be towed by most small SUV's, the Passport Express Super Lite is the Passport way of making camping easy.

EXPRESS SUPER LITE



195RB SHOWN IN BAYSIDE DECOR



238ML SHOWN IN RATTAN DECOR

MURPHY BED

STANDARD IN THE 195RB AND 238ML



STEP 1



STEP 2



STEP 3



STEP 4

SIMILAR TO A SWISS ARMY KNIFE, THE PASSPORT MURPHY BED IS AN INNOVATIVE WAY TO HAVE BOTH A BED AND SOFA IN A SPACE SAVING DESIGN. NOW AVAILABLE IN THE PASSPORT EXPRESS 195RB AND 238ML.

EXPRESS SUPER LITE



LIGHTED PASS-THRU STORAGE



FOOT FLUSH TOILET



EASY OPEN LP TANK COVER



HEAVY DUTY DRAWER GUIDES

EXPRESS STANDARDS & OPTIONS

CHASSIS

Engineered specifically for each floor plan

Fully welded outriggers

Cambered for added structural support

Extra support cross members

Electric slide out system

CONSTRUCTION

Welded aluminum framed sidewalls

Laminated gel-coated filon exterior walls

High density block foam insulation in sidewalls (R-7 insulation)

Seamless laminated aluminum framed floor 2" thick

One piece breathable Darco protective wrap

R-11 high density block floor insulation

Stamped galvanized 5" thick crowned rafters

One piece seamless Alpha Superflex TPO roof

R-11 ceiling rolled fiberglass insulation

EXTERIOR FEATURES

Insulated lockable radius baggage doors with hold backs

Insulated radius entrance door with screen door

Double entry steps at main door

Heavy duty front mechanical jack

4 scissor style stabilizer jacks

2-20lb. Propane bottles with flip top cover

Dual battery rack over A-frame

Rain gutters with extended downspouts

Lighted exterior pass thru storage compartment

Patio entrance light

Exterior shower w/ hot & cold

Front diamond plate

EZ lube axles

Exterior speakers

Exterior light at dump valves

Electric awning

INTERIOR FEATURES

Residential style furniture with high grade fabric

13,500 BTU A/C

Forced air furnace

6 gallon gas/electric DSI water heater (17.8 gal/hr)

Water system winterization ready

Residential durable Beauflor® linoleum

12 volt DVD/CD/AM/FM stereo, aux input, bluetooth and quality sound speakers

LED flat screen HD TV

2 tone wood accents

Residential interior doors

KITCHEN

Extra large double door dometic refrigerator

Oversized 60/40 residential sink with sink covers

Metal high-rise faucet

Microwave with carousel

3-burner high output range

Range hood

Raised panel hardwood cabinet doors

Coordinated wall paper border

Gas Oven

BATHROOM

Solid wood custom built medicine cabinet with mirror

Tub surround with built-in shelves

Radius shower curtain

Pedestal foot flush toilet

12 volt power exhaust fan

BEDROOM (MAIN)

Oversized wardrobes

Nighttime reading lights

60" x 74" Queen bed

Under bed storage

Power outlet at bed side

SAFETY PACKAGE

4 wheel electric brakes

Break-away switch

Heavy duty safety chains with clasp

Tinted safety glass windows

Multiple emergency egress windows

GFI recepticals

Carbon monoxide detector

Smoke alarm

Fire extinguisher

Propane gas leak detector

Dead-bolt lock on entrance doors

Manual override on slide system

Spare tire kit

OPTIONS

15,000 BTU A/C

Aluminum Wheels

EXPRESS SUPER LITE



DEEP SINK WITH HIGH-RISE FAUCET AND SINK COVERS



EXTERIOR SHOWER



ADJUSTABLE AWNING



BLACK TANK FLUSH

ALL NEW EXPANDABLES NOW AVAILABLE!



Passport expandables compact design comes with travel-friendly lengths and lightweight floorplans that make this travel trailer towable by many smaller vehicles*.

*CHECK WITH YOUR VEHICLE MANUFACTURER FOR TOWING SPECIFICATIONS

EXPRESS SUPER LITE

The Passport Express Expandable Series has been specifically engineered to maximize sleeping capacity while keeping both weight and overall length of the trailer in mind. Without sacrificing the look, comfort and amenities found in the regular Passport Express, the expandables also offer the latest in hybrid technology.



ROTO-VISE SYSTEM clamps tighter than the competition for a better seal with less effort.



Our tent system makes setting up and tearing down your hybrid a breeze. You no longer have to worry about awkward support bars or the tent canvas not being properly sealed to the tent door.

AVAILABLE IN 145EXP, 171EXP, 177EXP AND 217EXP FLOOR PLANS



145EXP

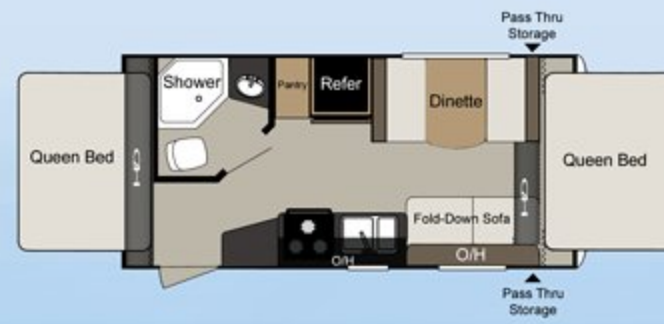

171EXP



177EXP



217EXP

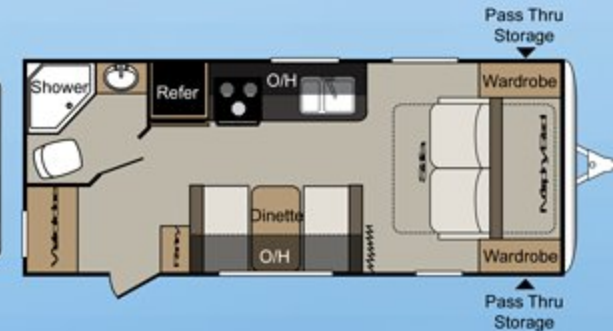

195RB

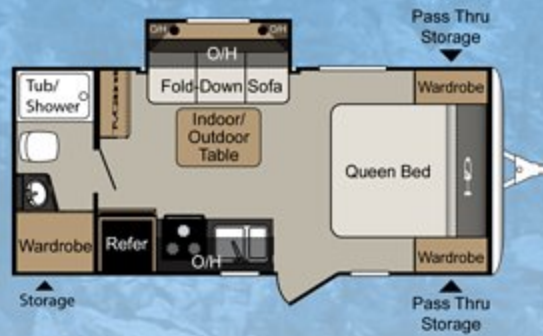

199ML

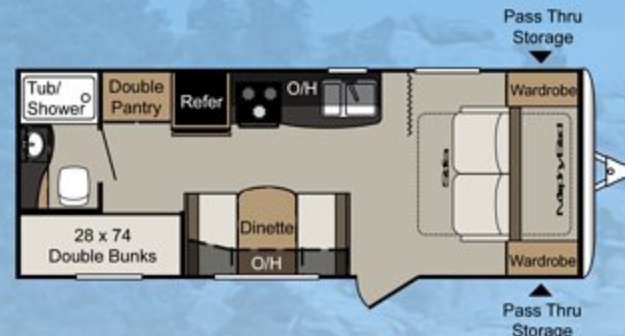

238ML

EXPRESS FLOOR PLANS

MODEL	SHIPPING WEIGHT	CARRYING CAPACITY	HITCH	LENGTH	HEIGHT	FRESH WATER	WASTE WATER	GRAY WATER	LPG	AWNING
145EXP	TBD	TBD	TBD	TBD	TBD	TBD	TBD	TBD	40	TBD
171EXP	TBD	TBD	TBD	20' 2"	10' 1"	43	38	38	40	TBD
177EXP	TBD	TBD	TBD	TBD	TBD	TBD	TBD	TBD	40	10'
217EXP	TBD	TBD	TBD	TBD	TBD	TBD	TBD	TBD	40	TBD
195RB	3677	1523	350	23' 4"	10' 1"	30	30	30	40	15'
199ML	3571	1629	335	21' 9"	10' 1"	30	30	30	40	10'
238ML	3753	1647	495	24' 11"	10' 2"	30	30	30	40	15'

★ ★ ★ ★ ★

GRAND TOURING



One word describes the Passport Grand Touring. Amazing! The Passport Grand Touring didn't get the memo that it was suppose to act like the other lite weights. With size and features of a full size camper, this Passport is still made for today's SUV's and half ton vehicles. So go ahead live large and go lite, and get more with a Passport Grand Touring.



3320BH SHOWN IN BAYSIDE DECOR

GRAND TOURING

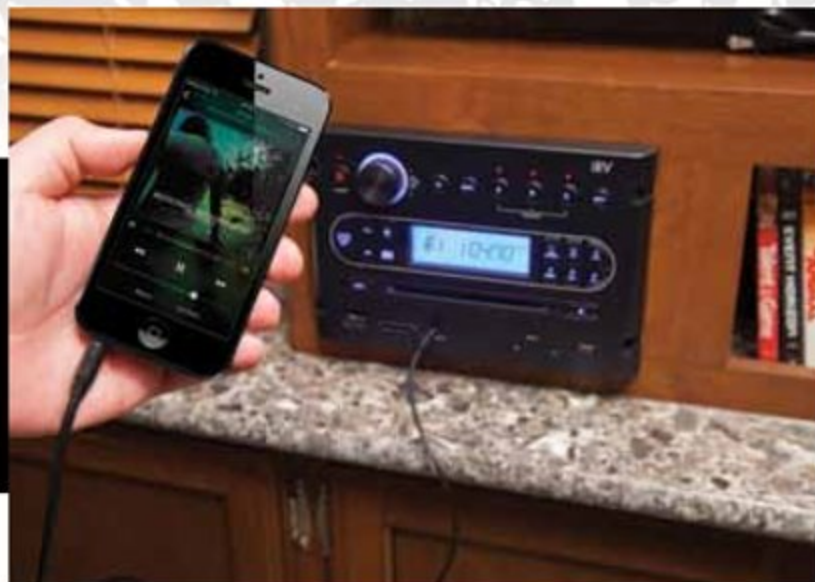

ENTERTAINMENT CENTER WITH DVD PLAYER, AM/FM RADIO, MP3, AUX PORT AND BLUETOOTH



GAS/ELECTRIC DSI WATER HEATER FOR LONGER HOT SHOWERS



LARGE BUNKHOUSES OFFER PLENTY OF SPACE FOR THE KIDS TO SLEEP AND PLAY GAMES



Passport

ULTRA LITE
by Keystone



2890RL SHOWN IN BAYSIDE DECOR



EXTERIOR LIGHTS ALLOW EASY ACCESS
TO THE TERMINATION VALVE



OUTSIDE KITCHEN
(AVAILABLE ON 2400BH, 2250RB*, 2770RB*, 2920BH, 3220BH, 3320BH)



LOAD EQUALIZATION AXLES (GT AND ELITE)



FOLDING ENTRY ASSIST HANDLE (GT AND ELITE)



ENT. CENTER WITH LED TV AND POCKET DOORS



BUMPER MOUNT GRILL (ON SELECT FLOOR PLANS)



CHASSIS

Engineered specifically for each floor plan
 Tube style bumper w/ sewer hose storage
 Fully welded outriggers
 Cambered for added structural support
 Extra support cross members
 Electric slide out system
 Enclosed and sealed heated underbelly

CONSTRUCTION

Welded aluminum framed sidewalls
 Seamless laminated gel-coated filon exterior walls
 High density block foam insulation in sidewalls (R-7 insulation)
 Laminated aluminum framed floor 2" thick
 One piece breathable Darco protective wrap
 R-11 high density block floor insulation
 Stamped galvanized 5" thick crowned rafters
 One piece seamless Alpha Superflex TPO roof
 R-11 ceiling rolled fiberglass insulation

EXTERIOR FEATURES

Insulated lockable radius baggage doors with hold backs
 Insulated radius entrance door with screen door
 Triple entry steps at main door
 Heavy duty front mechanical jack
 4 scissor style stabilizer jacks
 2-20lb. Propane bottles with flip top cover
 Dual battery rack over A-frame
 Rain gutters with extended downspouts
 Electric adjustable awning
 Lighted exterior pass thru storage compartment
 Portable outside grill (Select models. Not all outdoor kitchen models)
 Patio entrance light
 Exterior shower w/ hot & cold
 Fold away exterior grab handle (main door)
 Front diamond plate
 Load Equalization (spread axle design)
 EZ lube axles
 Exterior speakers
 Exterior light at dump valves

INTERIOR FEATURES

Residential style furniture with high grade fabric
 Convenience center with slide, lights, awning, water system controls, and 110V receptacle
 13,500 BTU A/C
 Forced air furnace
 Ducted in floor heating
 6 gallon gas/electric DSI water heater (17.8 gal/hr)
 Water system winterization ready
 Residential durable Beauflor® linoleum
 Digital TV system
 12 volt DVD/CD/AM/FM stereo, aux input, bluetooth and quality sound speakers
 LED flat screen HD TV
 2 tone wood accents
 Residential light fixtures in slide room
 King u-shaped dinette
 Residential interior doors
 Upgraded residential window treatments and valences
 Residential style entertainment center with integrated pocket doors

KITCHEN

Extra large double door dometic refrigerator
 Oversized 60/40 residential sink with sink covers
 Metal high-rise faucet
 Microwave with carousel
 3-burner high output range
 Range hood
 Residential raised panel hardwood cabinet doors
 Coordinated wall paper border
 Gas Oven

BATHROOM

Solid wood custom built medicine cabinet with mirror
 Tub surround with built-in shelves
 Radius shower curtain
 Pedestal foot flush toilet
 Skylight over tub (most floorplans)
 12 volt power exhaust fan

BEDROOM (MAIN)

60"x80" Queen size mattress with quilted bedspread
 Oversized wardrobes
 Nighttime reading lights
 Under bed storage
 Power outlet at bed side

SAFETY PACKAGE

4 wheel electric brakes
 Break-away switch
 Heavy duty safety chains with clasp
 Tinted safety glass windows
 Multiple emergency egress windows
 GFI recepticals
 Carbon monoxide detector
 Smoke alarm
 Fire extinguisher
 Propane gas leak detector
 Dead-bolt lock on entrance doors
 Manual override on slide system
 Spare tire kit

OPTIONS

15,000 BTU A/C
 Aluminum Wheels



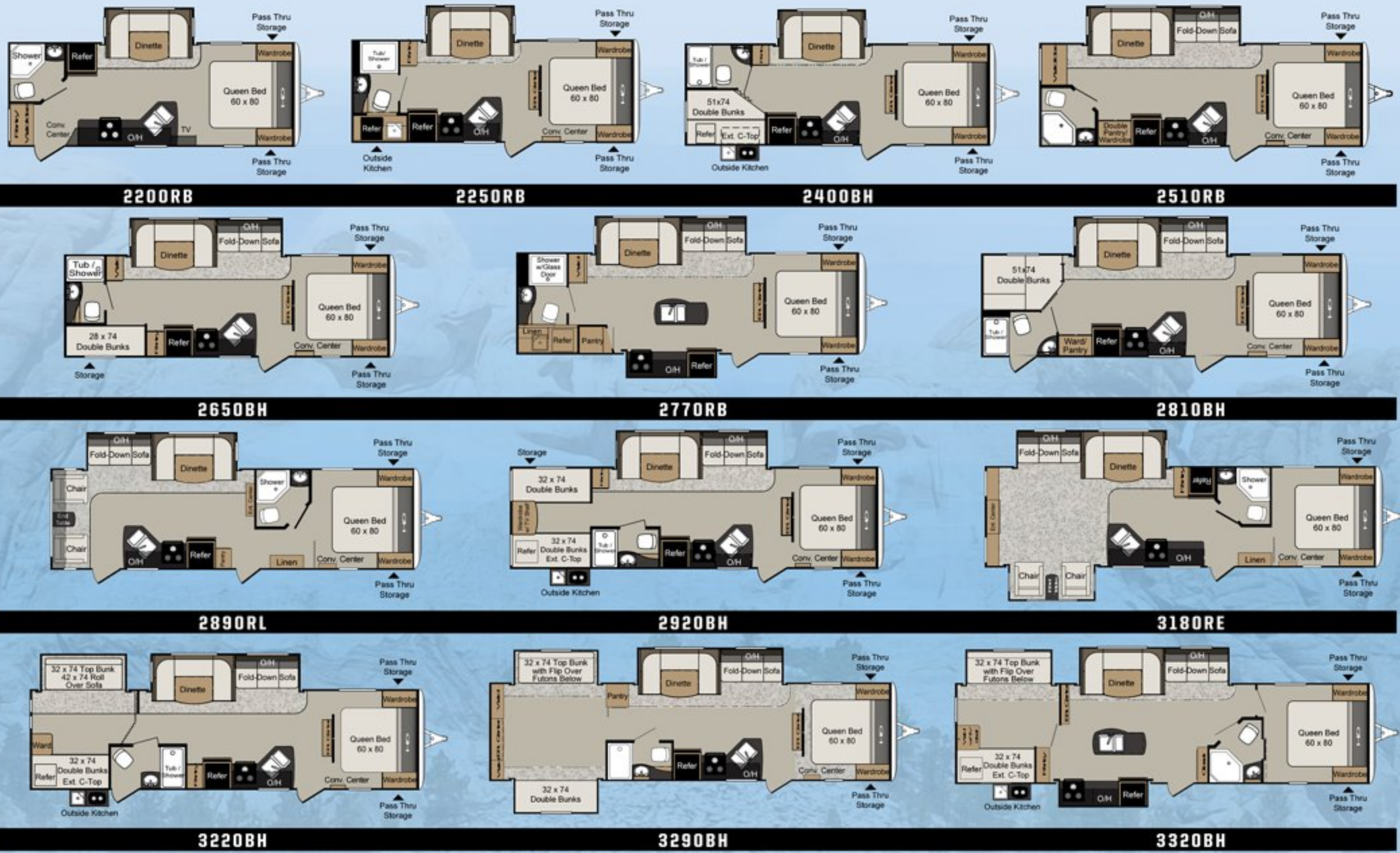

GRAND TOURING FLOOR PLANS

MODEL	SHIPPING WEIGHT	CARRYING CAPACITY	HITCH	LENGTH	HEIGHT	FRESH WATER	WASTE WATER	GRAY WATER	LPG	AWNING
2200RB	4303	2197	420	25' 10"	10' 7"	30	30	30	40	15'
2250RB	4578	1922	490	26' 4"	10' 7"	30	30	30	40	15'
2400BH	4730	2070	515	27' 10"	10' 7"	30	30	30	40	19'
2510RB	4812	2188	495	28' 10"	10' 7"	30	30	30	40	19'
2650BH	4828	2372	540	29' 4"	10' 7"	30	30	30	40	19'
2770RB	5525	1875	645	30' 9"	10' 9"	30	30	60	40	20'
2810BH	5145	2055	565	31' 10"	10' 9"	30	30	30	40	19'
2890RL	5470	1730	615	32' 9"	10' 9"	30	30	60	40	19'
2920BH	5384	1816	625	32' 10"	10' 9"	30	30	30	40	15'
3180RE	5827	1673	720	34' 11"	10' 9"	30	30	30	40	15'
3220BH	5959	1541	600	35' 5"	10' 9"	30	30	30	40	15' & 10'
3290BH	6308	1692	825	36' 8"	10' 11"	30	30	30	40	15'
3320BH	6562	1438	690	36' 10"	10' 11"	30	30	60	40	19'



31RE SHOWN IN RATTAN DECOR

Passport
ULTRA LITE
by Keystone

★ ★ ★ ★ ★
ELITE



Taking camping to the next level, Passport has created the ultimate in lightweight luxury! Once inside, you will see why the wide open spaces, all the amenities and high end finishes make this ultra-lite travel trailer Elite indeed.



**ENTERTAINMENT CENTER TO ENJOY
WITH THE WHOLE FAMILY**



**DEEP BASIN STAINLESS STEEL SINK
WITH PULL OUT SPRAYER**



**60" X 80" TRI-FOLD QUEEN SIZE
HIDE-A-BED**

PASSPORT ELITE TOP FEATURES

Sure, towability led you to the Passport, but when you need a travel trailer for those fun weekends or the extended cross country excursion you realize Passport has a full array of features and conveniences built into every model! Passport has features and construction quality that you can depend on.



23RB SHOWN IN BAYSIDE DECOR

ELITE



ADJUSTABLE PANTRY SHELVING
(SELECT FLOOR PLANS)

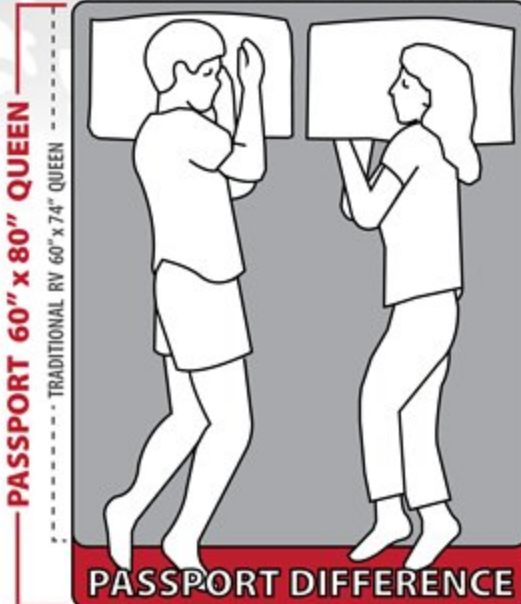

60" X 80" QUEEN SIZE BED
(ALL GT AND ELITE EXCEPT 23RB & 32FB)



RESIDENTIAL STYLE
FAUX WOOD BLINDS



FRAMELESS TINTED WINDOWS



HEAVY DUTY DRAWER GUIDES

Passport

ULTRA LITE
by Keystone



31RE SHOWN IN RATTAN DECOR



LOAD EQUALIZATION AXLES (GT AND ELITE)



FOLDING ENTRY ASSIST HANDLE (GT AND ELITE)



NEO ANGLE SHOWER (23RB, 30RL, 31RE)



OPTIONAL FREE STANDING DINETTE (N/A 23RB)

CHASSIS

Engineered specifically for each floor plan

Tube style bumper w/ sewer hose storage

Fully welded outriggers

Cambered for added structural support

Extra support cross members

Electric slide out system

Enclosed and sealed heated underbelly

CONSTRUCTION

Welded aluminum framed sidewalls

Seamless laminated gel-coated filon exterior walls

High density block foam insulation in sidewalls (R-7 insulation)

Laminated aluminum framed floor 2" thick

One piece breathable Darco protective wrap

R-11 high density block floor insulation

Stamped galvanized 5" thick crowned rafters

Alpha Superflex TPO one piece seamless rubber roof

R-11 ceiling rolled fiberglass insulation

EXTERIOR FEATURES

Insulated lockable radius baggage doors with hold backs

Insulated radius entrance door with screen door

Triple entry steps at main door

Heavy duty front mechanical jack

4 scissor style stabilizer jacks

2-20lb. Propane bottles with flip top cover

Dual battery rack over A-frame

Rain gutters with extended downspouts

Electric adjustable awning

Lighted exterior pass thru storage compartment

Portable outside grill (most models)

Patio entrance light

Exterior shower w/ hot & cold

Fold away exterior grab handle (main door)

Front diamond plate

Load Equalization (spread axle design)

EZ lube axles

Exterior speakers

Exterior light at dump valves

15" aluminum wheels

Frameless windows

15" radial tires

Upgraded graphics package

INTERIOR FEATURES

Residential style furniture with high grade fabric

Convenience center with slide, lights, awning, water system controls, and 110V receptacle

13,500 BTU A/C

Forced air furnace

Ducted in floor heating

6 gallon gas/electric DSI water heater (17.8 gal/hr)

Water system winterization ready

Residential durable Beauflor® linoleum

Digital TV system

12 volt DVD/CD/AM/FM stereo, aux input, bluetooth and quality sound speakers

LED flat screen HD TV

2 tone wood accents

Residential light fixtures in slide room

Radius walls

Residential interior doors

Upgraded furniture (hide-a-bed)

High-end window treatments with crown molding (wood valence leather accent)

Residential style entertainment center with integrated pocket doors

Wood mini blinds

Vaulted ceiling

KITCHEN

Extra large double door dometic refrigerator

Metal high-rise faucet

Microwave with carousel

3-burner high output range

Range hood

Residential hardwood cabinet doors

Coordinated wall paper border

Gas Oven

Solid surface countertop

Stainless steel sink

Pendant lighting above kitchen countertops

BATHROOM

Solid wood custom built medicine cabinet with mirror

Tub surround with built-in shelves

Radius shower curtain

Pedestal foot flush toilet

Skylight over tub (most floorplans)

12 volt power exhaust fan

BEDROOM (MAIN)

60"x80" Queen size mattress with quilted bedspread

Oversized wardrobes

Nighttime reading lights

Under bed storage

Throw pillows

Power outlet at bedside

SAFETY PACKAGE

4 wheel electric brakes

Break-away switch

Heavy duty safety chains with clasp

Tinted safety glass windows

Multiple emergency egress windows

GFI recepticals

Carbon monoxide detector

Smoke alarm

Fire extinguisher

Propane gas leak detector

Dead-bolt lock on entrance doors

Manual override on slide system

Spare tire kit

OPTIONS

15,000 BTU A/C

Free-standing dinette and chairs (excludes 23RB)





**OPTIONAL
FREE-STANDING
DINETTE AND CHAIRS
(N/A 23RB)**

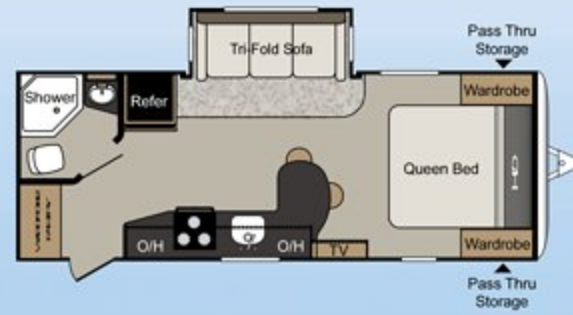

23RB



29BH



30RL



31RE



32FB

ELITE FLOOR PLANS

MODEL	SHIPPING WEIGHT	CARRYING CAPACITY	HITCH	LENGTH	HEIGHT	FRESH WATER	WASTE WATER	GRAY WATER	LPG	AWNING
23RB	4608	2192	530	25' 11"	10' 9"	30	30	30	40	15'
29BH	5955	1845	745	33' 8"	10' 8"	30	30	60	40	19'
30RL	6119	1681	665	33' 8"	10' 8"	30	30	60	40	19'
31RE	6216	1784	690	34' 8"	10' 9"	30	30	30	40	12'
32FB	6320	1880	885	35' 4"	10' 9"	30	30	30	40	19'

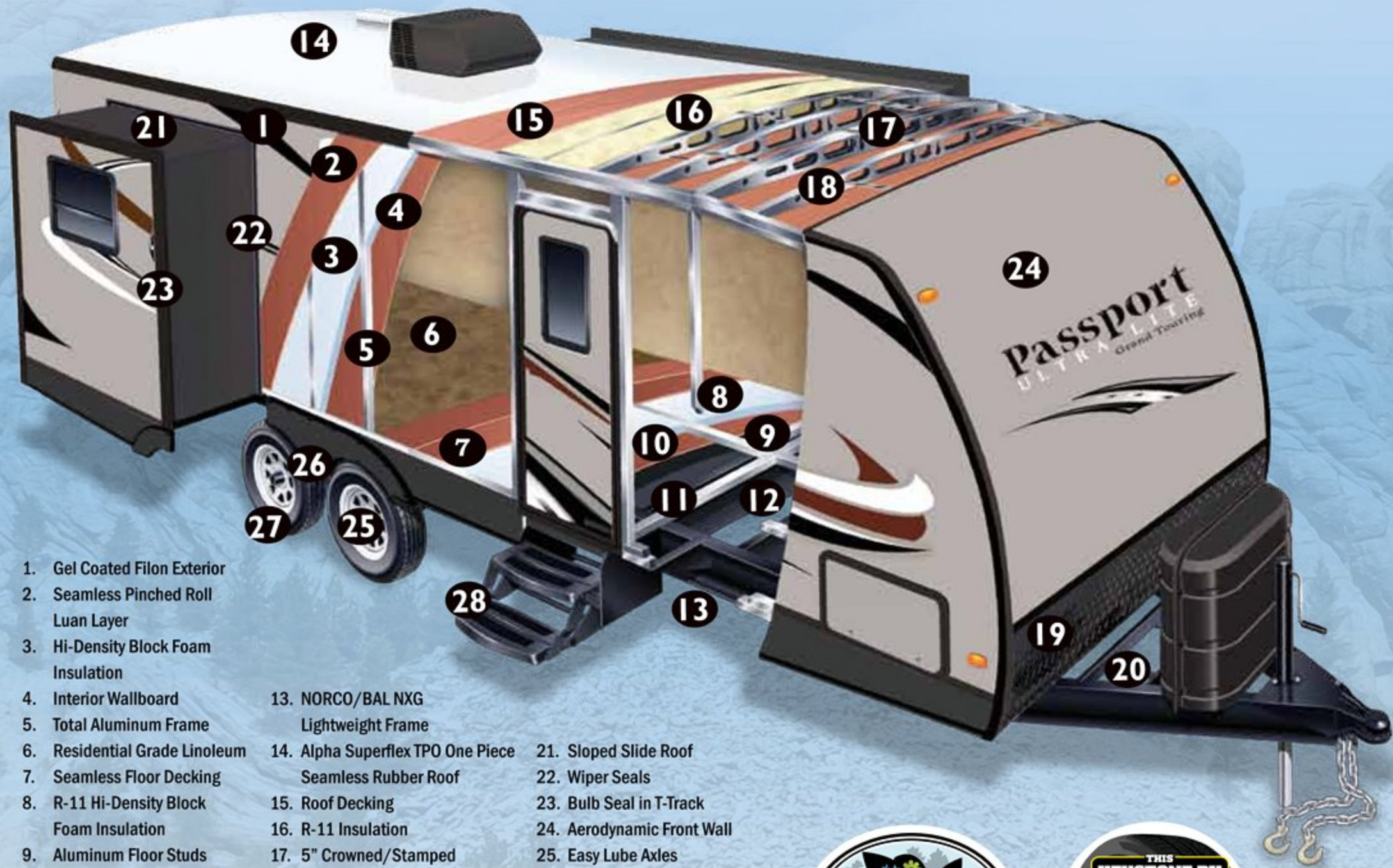

- | | | |
|---|---|--|
| 1. Gel Coated Filon Exterior | 13. NORCO/BAL NXG
Lightweight Frame | 21. Sloped Slide Roof |
| 2. Seamless Pinched Roll
Luan Layer | 14. Alpha Superflex TPO One Piece
Seamless Rubber Roof | 22. Wiper Seals |
| 3. Hi-Density Block Foam
Insulation | 15. Roof Decking | 23. Bulb Seal in T-Track |
| 4. Interior Wallboard | 16. R-11 Insulation | 24. Aerodynamic Front Wall |
| 5. Total Aluminum Frame | 17. 5" Crowned/Stamped
Roof Trusses | 25. Easy Lube Axles |
| 6. Residential Grade Linoleum | 18. Hurricane Straps | 26. Load Equalization Axles
(GT and Elite only) |
| 7. Seamless Floor Decking | 19. Diamond Plate | 27. Radial Tires |
| 8. R-11 Hi-Density Block
Foam Insulation | 20. Dual Battery Tray | 28. Radius Entry Steps |
| 9. Aluminum Floor Studs | | |
| 10. Bottom layer floor decking | | |
| 11. Moisture Barrier Wrap | | |
| 12. Enclosed Underbelly
(GT & Elite) | | |



GRANITE DECOR



BAYSIDE DECOR



RATTAN DECOR



STAY IN TOUCH



Passport is always just a touch away. You'll find 360 virtual tours, location of your nearest dealer, photos, videos and all of the latest information about Passport on our easy to navigate website. Everything you need can be accessed anytime, day or night, from home or on the road. You can also find us on the Keystone RV facebook.

www.keystonerv.com/Passport



KEYSTONE RV RECOMMENDS BUYING LOCALLY

It's up to you where you purchase your new Passport, but may we suggest your local dealer? Not only does it help your local economy and provide jobs, but it will also give you an opportunity to develop a service relationship with someone that will come to know you and your coach. Congratulations on finding the best built, best equipped, best value in the industry, and happy travels!

Passport

ULTRA LITE
by Keystone



YOUR LOCAL DEALER:

SEPTEMBER 2014

Product information is as accurate as possible at the date of publication of this brochure. Features, floor plans, and specifications are subject to change without notice. Please also consult Keystone's web site at keystonerv.com for more current product information and specifications. Tow Vehicle Disclaimer. CAUTION: Owners of Keystone recreational vehicles are solely responsible for the selection and proper use of tow vehicles. All customers should consult with a motor vehicle manufacturer or their dealer concerning the purchase and use of suitable tow vehicles for Keystone products. Keystone disclaims any liability or damages suffered as a result of the selection, operation, use or misuse of a tow vehicle. KEYSTONE'S LIMITED WARRANTY DOES NOT COVER DAMAGE TO THE RECREATIONAL VEHICLE OR THE TOW VEHICLE AS A RESULT OF THE SELECTION, OPERATION, USE OR MISUSE OF THE TOW VEHICLE.



Go RVing
Life's A Trip



2642 Hackberry Drive | PO Box 2000
Goshen, IN 46527-2000
(574) 535-2100

