



FOREST RIVER  
**WILDWOOD**  
**FSX**

2024



# LE TRAVEL TRAILERS

**164RBLE**  
LENGTH: 20' 1"  
UVW: 2,819 LBS



**174BHLE**  
LENGTH: 20' 1"  
UVW: 2,899 LBS



OVERSIZED DOOR FOR STORAGE ACCESS

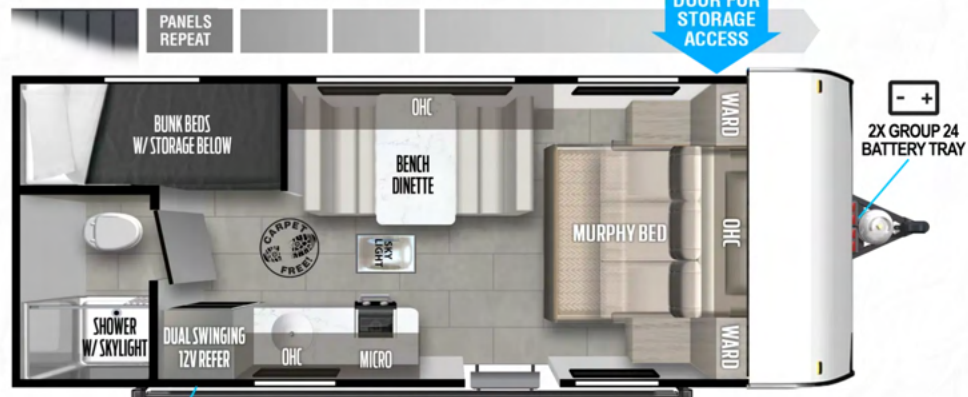

**177BH** 12' AWNING  
LENGTH: 22' 0"  
UVW: 3,319 LBS

FULL PASS THRU STORAGE

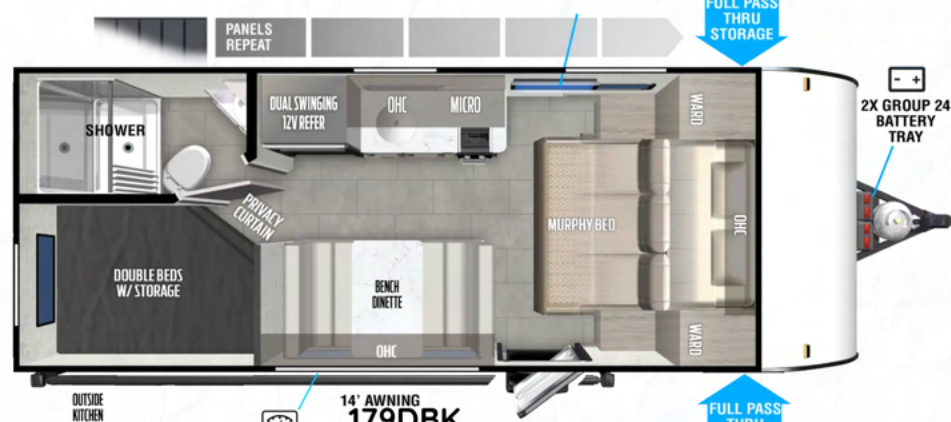

14' AWNING  
**179DBK**  
LENGTH: 22' 6"  
UVW: 3,829 LBS

FULL PASS THRU STORAGE

# TRAVEL TRAILERS

REMOVABLE UNDERBELLY PANELS



14' AWNING  
**178BHSK**  
LENGTH: 22' 11"  
UVW: 4,119 LBS

FULL PASS THRU STORAGE

OVERSIZED DOOR FOR STORAGE ACCESS



12' AWNING  
**167RBK**  
LENGTH: 21' 2"  
UVW: 3,651 LBS

OVERSIZED DOOR FOR STORAGE ACCESS

HIGH CAPACITY AXLE

HIGH CAPACITY









# TOY HAULERS + VERSATILE CARGO

**175RTK**  
LENGTH: 21'9"  
UVW: 4,413 LBS

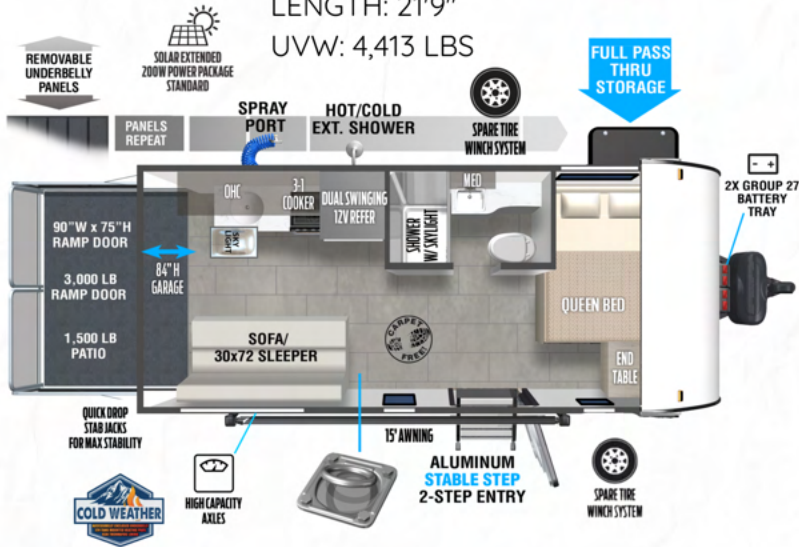

**210RTK**  
LENGTH: 28'8"  
UVW: 5,798 LBS

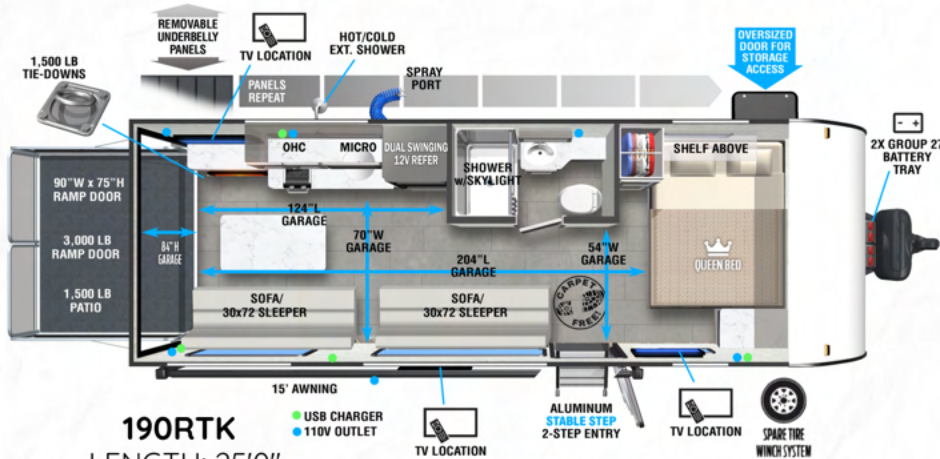
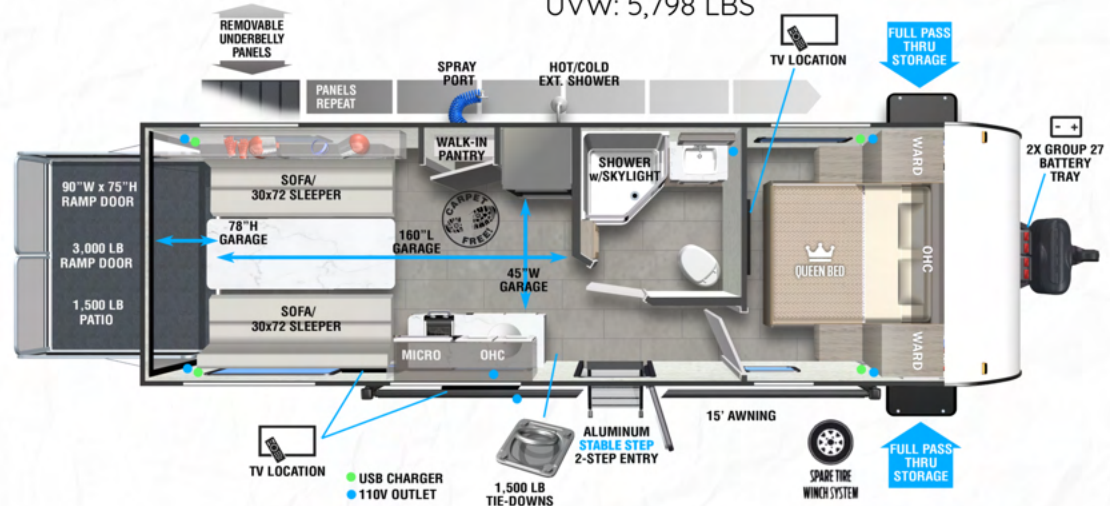

**190RTK**  
LENGTH: 25'0"  
UVW: 4,988 LBS

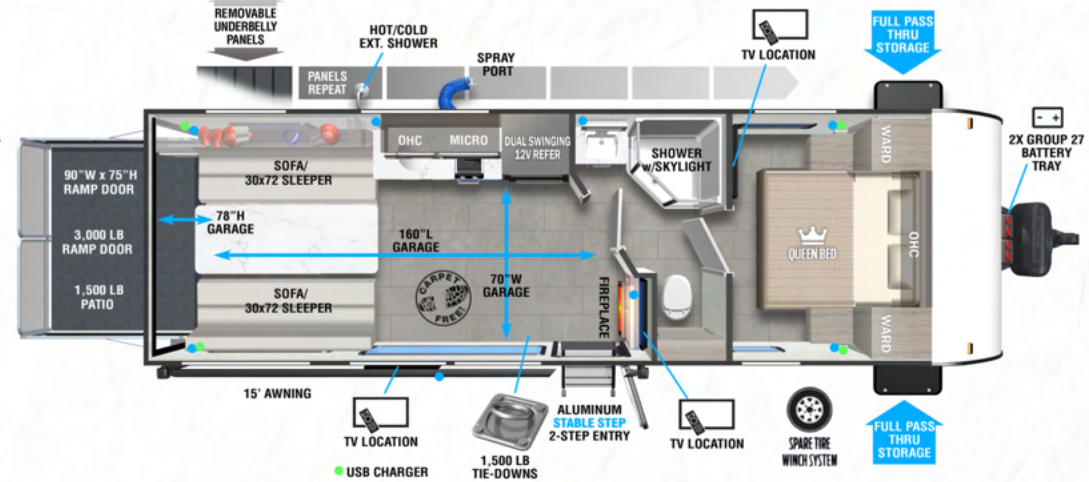

**260RTK**  
LENGTH: 28'8"  
UVW: 5,805 LBS

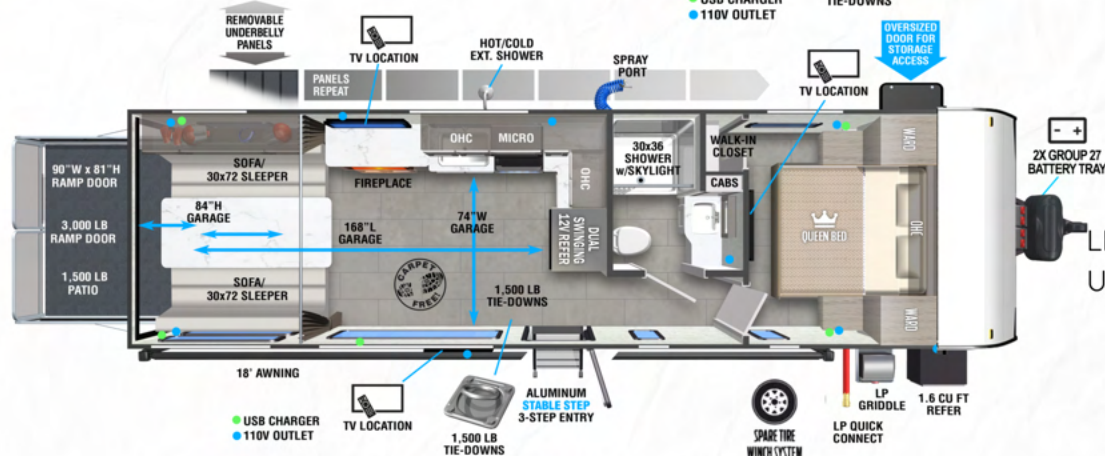

**270RTK**  
LENGTH: 32'3"  
UVW: 6,318 LBS

AVAILABLE ON MOST MODELS





# TOY HAULERS + VERSATILE CARGO

**290RTK**  
 LENGTH: 36'6"  
 UVW: 7,2743 LBS

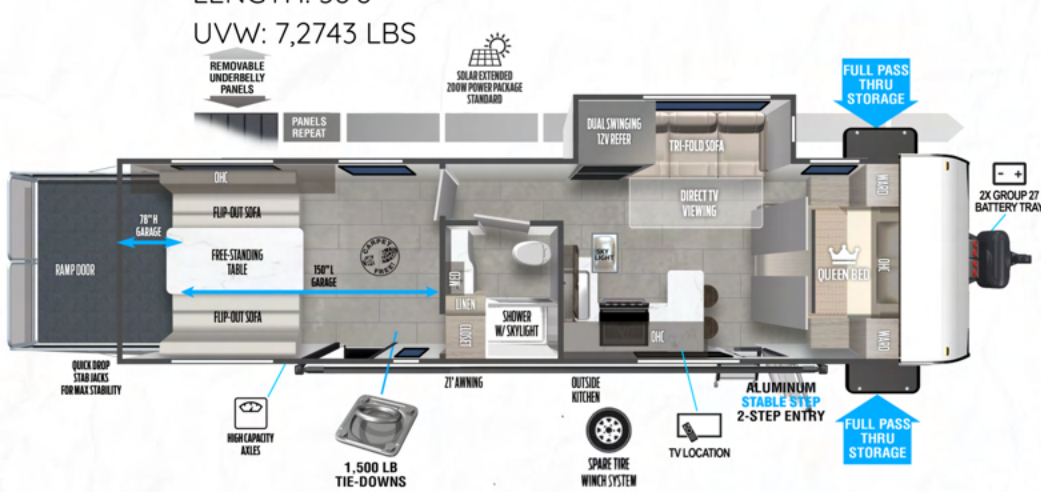

**262VC**  
 LENGTH: 30'6"  
 UVW: 7,633 LBS

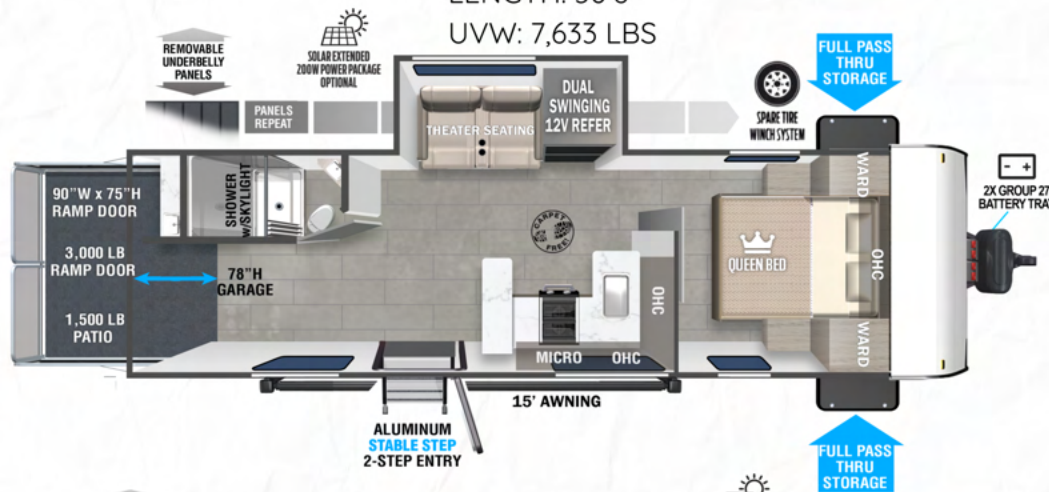

**245VC**  
 LENGTH: 27'5"  
 UVW: 6,208 LBS

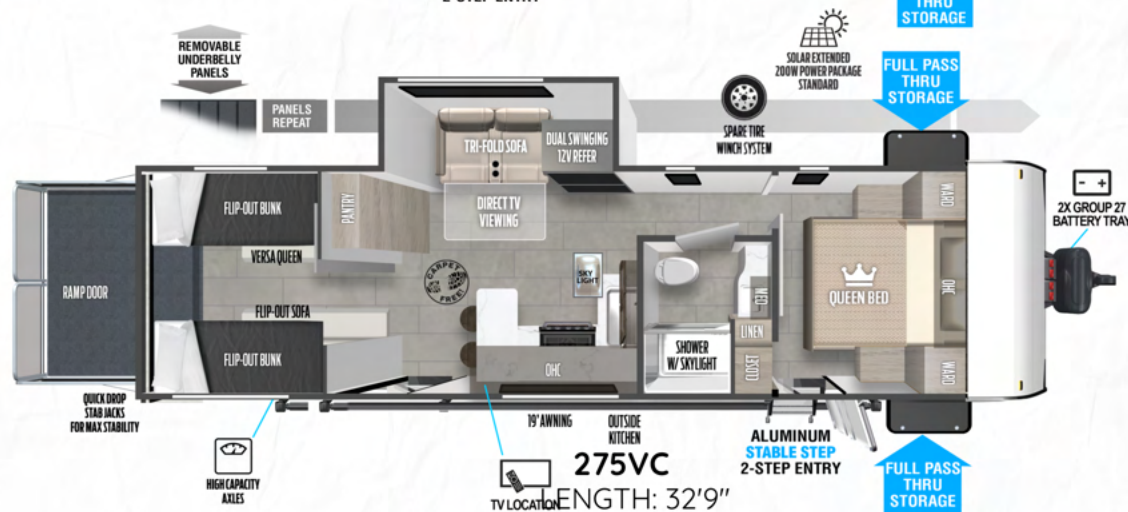

**275VC**  
 LENGTH: 32'9"  
 UVW: 7,008 LBS



**30VCVIEW**  
 LENGTH: 36'6"  
 UVW: 8,585 LBS







For the most recent specs, pictures,  
and 360 tours visit  
**forestriverinc.com/wildwood-fsx**  
or  
Scan QR Code below



### Your Wildwood Dealer



@wildwoodrvs



@WildwoodRV

24/7 EMERGENCY  
ROADSIDE ASSISTANCE  
WITH VEHICLE PURCHASE

TOWING  
JUMP STARTS  
TIRE CHANGES  
FLUID DELIVERY  
LOCKOUT  
SERVICE

WINCH-OUT  
MOBILE MECHANIC  
TECHNICAL  
SUPPORT  
DEALER LOCATOR  
SERVICES

**SPECIALIZED  
DISPATCH SERVICES**

\*VALID FOR 1 YEAR FROM DATE OF PURCHASE

CUSTOMER SATISFACTION

**FOREST RIVER**  
RECOMMENDS YOU TO

**BUY LOCAL**

PREFERENTIAL SERVICE

PRODUCT INFORMATION

www.ForestRiverBuyLocal.com

**FREE MEMBERSHIP**  
to Forest River Owners' Group

www.forestriverfrog.com

**FOREST RIVER**

A Berkshire Hathaway company.

Learn More  
Scan this barcode using  
a QR Reader on your  
smart phone to learn  
more about Forest River.

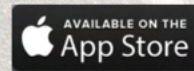

Download the Forest River mobile app or visit our dynamic online manual to enhance your ownership experience. These interactive options provide incredible ease and insight into use, maintenance and enjoyment of your Forest River product. From "How-To" videos, pictures and illustrations of various components, systems and features, to fully searchable content and downloadable PDFs for individual component owner's manuals, answers are always just a click away

**PRE-DELIVERY INSPECTION FACILITY**

75,000 square feet of quality assurance. The bare essential for a premium product. This state-of-the-art facility gives immediate daily feedback to production for quality assurance in every unit built.

UVW (Unloaded Vehicle Weight)\* is the typical weight of the unit as manufactured at the factory. It includes all weight at the unit's axle(s) and tongue or pin and LP Gas. The UVW does not include cargo, fresh potable water, additional optional equipment or dealer installed accessories. \*Estimated Average based on standard build optional equipment. CCC (Cargo Carrying Capacity) is the amount of weight available for fresh potable water, cargo, additional optional equipment and accessories. CCC is equal to GVWR minus UVW. Available CCC should accommodate fresh potable water (8.3 lbs per gallon). Before filling the fresh water tank, empty the black and gray tanks to provide for more cargo capacity. Estimated average based on standard build optional equipment. See back page for additional specification definitions. GVWR (Gross Vehicle Weight Rating) - is the maximum permissible weight of the unit when fully loaded. It includes all weights, inclusive of all fluids, cargo, optional equipment and accessories. For safety and product performance do NOT exceed the GVWR. GAWR (Gross Axle Weight Rating) is the maximum permissible weight, including cargo, fluids, optional equipment and accessories that can be safely supported by a combination of all axles. Each Forest River RV is weighed at the manufacturing facility prior to shipping. A label identifying the unloaded vehicle weight of the actual uAll information contained in this brochure is believed to be accurate at the time of publication. However, during the model year, it may be necessary to make revisions and Forest River, Inc., reserves the right to make all such changes without notice, including prices, colors, materials, equipment and specifications as well as the addition of new models and the discontinuance of models shown in this brochure. Therefore, please consult with your Forest River dealer and confirm the existence of any materials, design or specifications that are material to your purchase decision. © 2023 Ozark, a Division of Forest River, Inc., a Berkshire Hathaway company. All Rights Reserved