



Seneca



Serial #: 1UJNJCBU4P1HM4096
 Model: 37M SENECA MHC
 VIN#: 4UZADVFC1PCUM3527
 Model Year: 2023 Dealer Name: KRENEK RV SUPERCENTER
 6542 RYNO ROAD
 COLOMA, MI 49038
 USA

Manufacturer's Suggested Retail Price \$347,116.00

TOTAL AMOUNT DOES NOT INCLUDE STATE AND LOCAL TAXES OR LICENSE FEES. THE PRICE SHOWN ABOVE MAY OR MAY NOT BE REPRESENTATIVE OF THE ACTUAL SELLING PRICE OF SIMILAR RECREATIONAL VEHICLES IN YOUR AREA.

Standard Equipment

THE FOLLOWING ITEMS ARE STANDARD ON THIS MODEL AT NO EXTRA CHARGE

STANDARD EXTERIOR EQUIPMENT

- Freightliner® S2RV chassis
- GVWR- 29,000 lb.
- GCWR- 41,000 lb.
- Cummins® ISB 6.7L 360 HP diesel engine with 800 ft.-lb. torque
- Allison® 3000 MH automatic transmission
- 185 amp alternator
- G-rated highway tires- 275/80R22.5
- Alcoa® aluminum wheels
- Engine exhaust brake
- 12,000 lb. rear hitch receiver
- 7-pin plug
- Dual 12V chassis batteries
- 100 gal. fuel tank
- 10 gal. DEF tank
- StrongholdVBL™ roof, floor and sidewalls
- Bead-foam insulation (R-24 max roof, R-9 max floor and R-8 max walls)
- One-piece, seamless, crowned fiberglass roof
- Premium Sikkens full-body paint
- Automatic hydraulic leveling jacks
- Entrance door with industry's largest travel-view window
- Electric-powered entrance step
- Slideout awning(s)
- Exterior entertainment center with outside speakers and LED HD Smart TV mounted on swivel bracket
- Winegard® In-motion satellite dish
- Carpeted, full pass-through storage compartments with lockable slam-latch doors
- 24.5 gal. propane tank (83 lb.)
- LP quick-connect hookup
- Thetford® Sani-Con Turbo macerator system
- Exterior utility center
- Winterization drain system
- Black tank flush
- Outside shower
- 12V demand water pump
- Onan® 8,000W Quiet Diesel generator and auto-gen start
- Transfer switch with reverse polarity protection
- (4) 6V AGM (220Ah) house batteries on slideout tray
- 200W solar panel with dual controller
- Third brake light

STANDARD INTERIOR EQUIPMENT

- Deluxe heated, remote-controlled, side-view mirrors
- 6-way power driver and passenger seats
- Power windows and door locks
- Tilt steering wheel
- A/C and cruise control
- Auxiliary start switch
- Custom-molded ABS surround in cab-over area
- Overhead bunk with 750 lb. capacity
- JAYCOMMAND™ powered by Firefly
- 84 in. interior ceiling height with padded vinyl ceiling
- Day/night roller shades in living area
- High-intensity, recessed LED ceiling lights
- Vinyl plank flooring
- Raised-panel hardwood cabinetry throughout
- Deluxe hidden cabinet hinges
- Ball-bearing drawer guides
- Jayco-exclusive, easy-operation legless dinette table
- 2-point lap safety belts in all designated seating locations
- 30,000 BTU auto-ignition furnace
- 10 gal. gas/electric water heater
- Electric fireplace
- LED HD Smart TV in living area
- Cable TV hookup with RG-6 coax and video selector switch
- Winegard 2.0 Wi-Fi/4G antenna
- Wood-framed kitchen window with spice cabinets
- 2-burner induction cooktop
- LED-lit, solid-surface kitchen countertops with recessed stainless steel sink and sink covers
- Water filtration system
- Shower with decorative surround, glass door, skylight and light
- Porcelain toilet with foot flush
- Recessed stainless-steel bathroom sink
- Powered roof vent in bathroom with wall switch
- Walk-around, king-size bed with power head lift, bedspread and nightstands
- USB port and wireless charging in nightstands
- Under-bed storage
- LED HD Smart TV in bedroom
- Large wardrobes
- Bunks with industry-exclusive 300 lb. capacity each (37L)
- Wall-mounted tablet holder in each bunk (37L)
- Smoke alarm
- Carbon monoxide detector

CUSTOMER VALUE PACKAGE

- JRIDE® PREMIUM: Computer-balanced driveshaft, rear air suspension, heavy-duty rear stabilizer bar, full air brakes, SACHS shocks
- One-piece, seamless, fiberglass front and rear caps
- Automotive-bonded, panoramic window in front cap with power shade
- Dual-pane, tinted, safety-glass windows
- (2) 15,000 BTU A/C units with heat pump on main A/C
- Electric patio awning with LED lights
- 2,000W pure sine wave inverter
- Power cord reel with 50 amp service
- Sony® infotainment center with Apple® CarPlay and Android Auto™
- Backup and side-view cameras
- Residential refrigerator
- Convection microwave oven

Optional Equipment

OPTIONAL EQUIPMENT INSTALLED ON THIS VEHICLE BY MANUFACTURER

Base price	337,800.00
Carbon	n/c
Marten Paint Package	30.00
USA Standards	n/c
23 FR S2RV 31000 279" 360 PA15	n/c
Customer Value Package	6,750.00
Residential Refrigerator	n/c
No Washer/Dryer	n/c
8K Generator	n/c
Trav'ler Direct TV	
Satellite Network	1,343.00
Slideout Tray w/Electric Cooler in Basement	1,193.00
Booth Dinette	n/c
Power Theater Seating	
Sofa	n/c

UNIT TOTAL **347,116.00**

DEALER INSTALLED OPTIONS

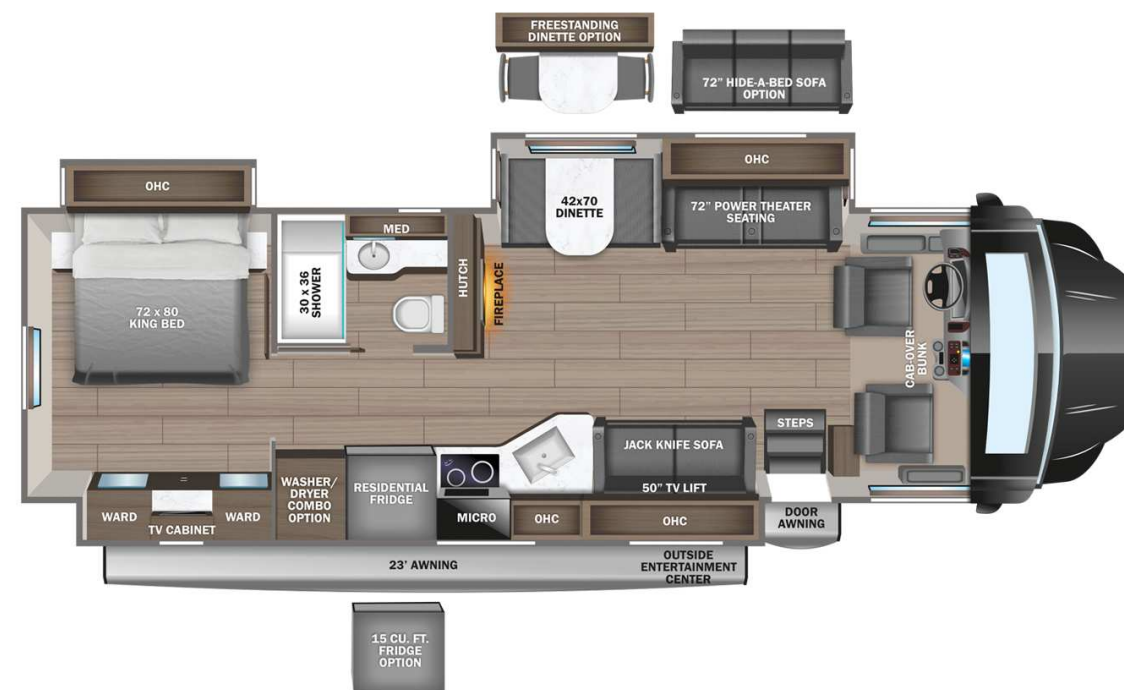

DIMENSIONS

Exterior height:.....160.00"
 Exterior width:.....101.00"

CAPACITIES

Fresh water tank (gals.):...72.00
 Gray water tank (gals.):...81.00
 Black water/toilet tank (gals.):.....50.00
 Propane (lbs.):.....83
 Propane (gals.):.....19
 Water heater (gals.):.....0.00

TIRES

Tire size (front):.....275/80R22.5G
 Tire size (mid):.....
 Tire size (rear):.....275/80R22.5G

Some dimensions may be rounded and may vary from the actual dimensions
 Weights may be estimated calculations and may vary from the actual weight - refer to the vehicle weight labels for actual weights
 Floorplans, features and specifications are subject to change without notice.

