

CONSTRUCTION

Greyhawk and Granite Ridge are designed and built to give you years of totally enjoyable, fully satisfying adventures. Each coach is built around a sturdy tubular steel skeleton, fortified with our exclusive Tuff-Shell™ vacuum-bond laminated roof, walls and floor. All backed by a unique 2+3 Warranty®: full bumper-to-bumper protection for 24 months plus a 36 month structural guarantee. Transferable for two full years. So with Jayco, you can enjoy dependability and protection wherever you go.

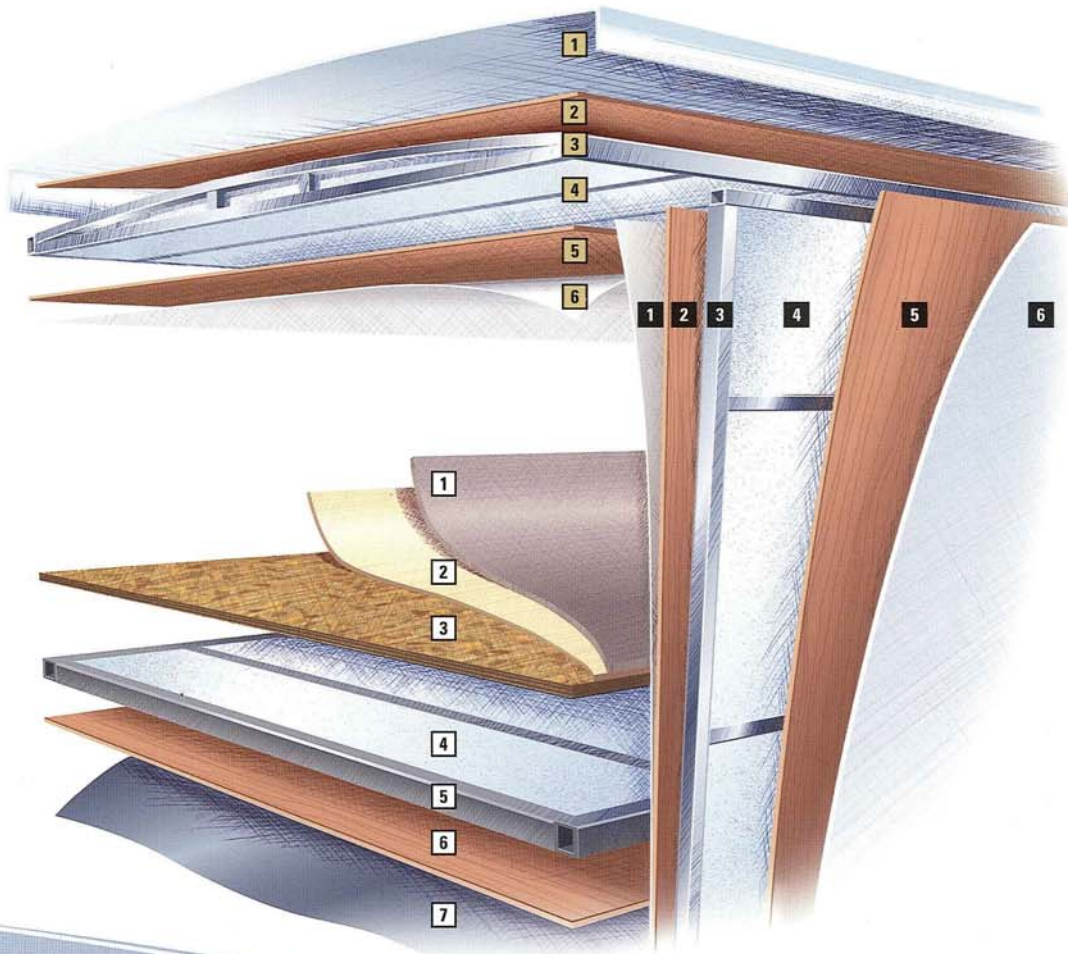

FLOOR

- 1 Residential-Quality Carpet
- 2 1/2" Foam Pad
- 3 3/8" Structurwood
- 4 Bead Foam Insulation
- 5 1 1/2" Tubular Steel Floor Frame
- 6 1/4" Luaun
- 7 Waterproof Underbelly

WALLS

- 1 Vinyl Decorative Wall Covering
- 2 1/8" Luaun
- 3 1" Tubular Aluminum Wall Frame
- 4 Bead Foam Insulation
- 5 1/8" Luaun
- 6 Filon Plus Exterior Sidewall

ROOF

- 1 One-Piece Seamless TPO Roof
- 2 1/8" Luaun
- 3 Aluminum Roof Frame
- 4 Tapered Bead Foam Insulation
- 5 1/8" Luaun
- 6 Ozite Sound-Deadening Fabric Ceiling

2003 GREYHAWK™ Floorplans

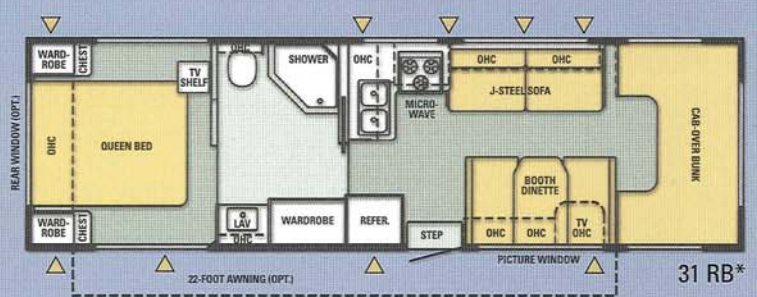
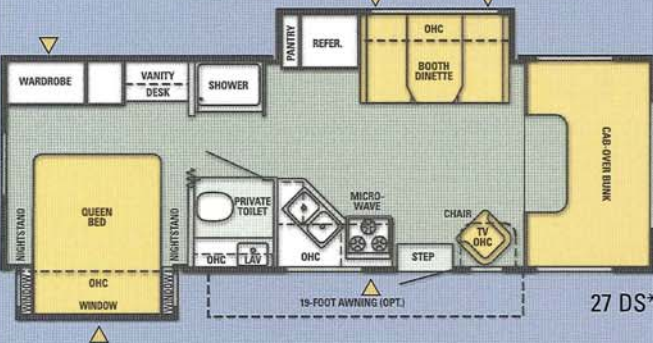
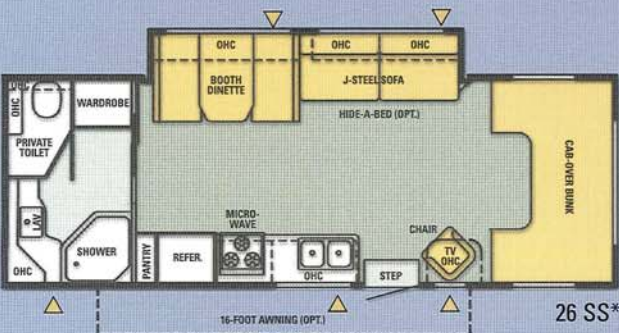
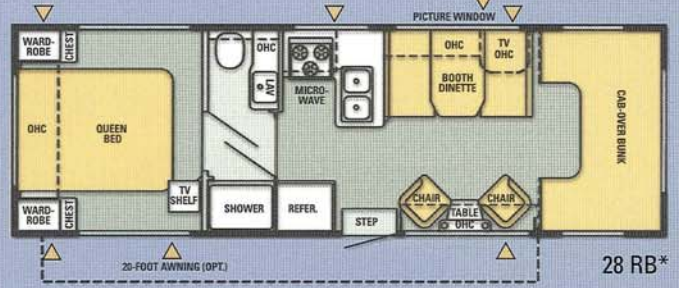
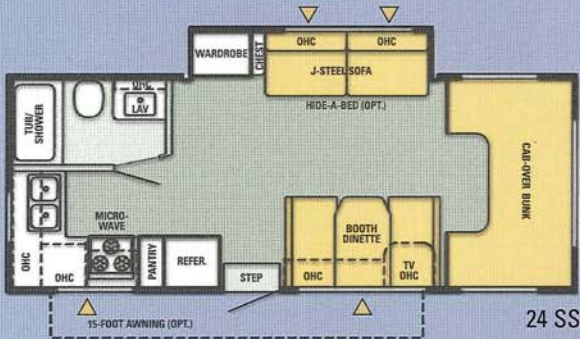
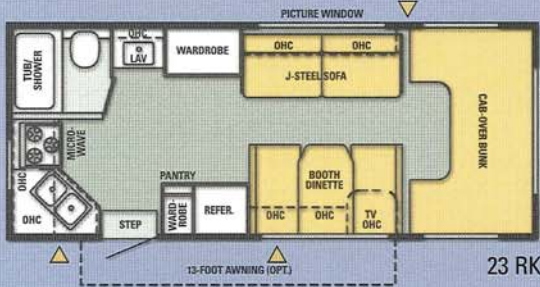

2003 GRANITE RIDGE™ Floorplans



Shown: Granite Ridge with Pine Forest full body paint option. Also available in Mountain Berry.



Floorplan Options

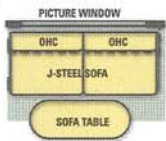

J-Steel Sofa with Table Option (A)

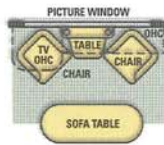

Chairs with Table Option (B)



J-Steel Sofa Option (C)



Entertainment Center and Slide-Out Bed Option (D)

Greyhawk	
Models	Options
23 RK	B
24 SS	B
27 DS	A
28 GS	A
28 RB	A, B and C
30 GS	B, C and D
31 RB	B

Granite Ridge	
Models	Options
2700 DS	A
3000 GS	B, C and D
3200 SL	B



LINOLEUM



CARPET



HARDWOOD

North Ridge Maple



Fairfield Oak

▲ Outside Storage Compartment

* Full Basement Models

2003 GREYHAWK™ & GRANITE RIDGE™

Standard and Optional Features

CHASSIS FEATURES	Greyhawk	Granite Ridge
Automatic Transmission with Overdrive	S	S
Factory Air Conditioning and Cruise Control	S	S
Power Anti-Lock Brakes and Power Steering	S	S
Window and Door Locks	S	S
Tilt Steering Wheel	S	S
Rubber Body Mounts	S	S
Dome Light	S	S
Deluxe Non-Remote Control Side-View Mirrors	S	N/A
Deluxe Remote Control Side-View Mirrors	0	S
Hellwig® Helper Springs (Opt. on 23 RK, 24 SS, 28 RB)	S	S

CAB FEATURES	Greyhawk	Granite Ridge
Six-Way Power Driver's Seat	N/A	0
Ultraleather™ Driver and Passenger Seat with Six-Way Power Driver's Seat	N/A	0
Deluxe AM/FM Stereo with CD	S	S
Deluxe AM/FM Stereo with Cassette	0	0
Premium Stereo with CD and Cassette (Ford Only)	0	0
Recliner Seats with Full Front/Back Adjustment	S	S
Lap and Shoulder Safety Belts	S	S
Padded Fabric Head Liner	S	S
Auxiliary Start Switch	S	S
Deluxe Cab Floor Mats	N/A	S
Woodgrain Dash Kit	0	S
Front Cab-Over Window	0	0
Exterior Cab Privacy Shield	0	0
Rear Vision Video System*	0	S

HEAT, POWER, WATER FEATURES	Greyhawk	Granite Ridge
6-Gal. Gas/Electric Auto-Ignition Water Heater	S	S
City Water Hookup	S	S
Water Heater Bypass Kit	S	S
Shurflo™ Demand Water Pump	S	S
Auto-Ignition Furnace with Wall Thermostat	S	S
63-Lb. Chassis-Mount LP Gas Tank	S	S
Carbon Monoxide Detector	S	S
Fire Extinguisher	S	S
LP Leak Detector	S	S
Ducted/Radiant-Heated Holding Tanks (N/A 23 RK and 24 SS)	S	S
Heated Holding Tanks (23 RK, 24 SS Only)	0	N/A
Holding Tank Sprayer*	0	0
13,500 BTU Roof Air Conditioning (23 RK, 24 SS Only)	S	N/A
13,500 BTU Ducted Central Air (15,000 BTU on 31' and 32' Models) (N/A 23 RK and 24 SS)	S	S
Attic Fan	0	0
28' Power Cord	S	S
4000 Watt Onan® Generator	0	0
Generator Prep	S	S
Deluxe 110V to 12V Converter	S	S
400 Watt Inverter*	0	0
Conveniently Located Water Pump Switches	S	S
In-Floor Ducted Heating (N/A 23 RK and 24 SS)	S	S
Interior Command Center®	S	S

LIVING ROOM FEATURES	Greyhawk	Granite Ridge
Fairfield Oak Cabinetry Throughout	S	S
North Ridge Maple Cabinetry Throughout	0	0
Roomy Overhead Cabinets	S	S
Front Entertainment Center with 20" TV (23 RK, 24 SS Only)	0	N/A
Front Entertainment Center with 27" TV (Std. on 3200 SL) (N/A 23 RK, 24 SS)	0	0
VCR	0	0
DVD Player	0	0
Overhead TV Cabinet (N/A with Front Entertainment Center)	S	S
13" TV with Remote and Swivel Base	0	0
J-Steel™ Sofa with Drawer Storage (Most Models, See Floorplans)	S/O	S/O
J-Steel™ Sofa with Hide-A-Bed (24 SS and 26 SS Only)	0	N/A
Padded Wings Behind Cab	S	S
Crank-Up TV Antenna with Signal Booster	S	S
Satellite Prep	S	S
Satellite Dish with Digital* Elevation Sensor (N/A 3100 SS and 3200 SL)	0	0
Pleated Shades	S	N/A
Day/Night Shades	0	S
Fabric-Covered Lambrequin Valances	S	S
Deep Pile Carpeting with Thick Padding	S	S
Labeled Light Switch Center	S	S
12V High Intensity Lighting Package	S	N/A
Fluorescent and Halogen Lighting Package	N/A	S
Cable TV Hook-Up	S	S
Decor Package (Includes Clock, Framed Decorative Prints and Decorative Pillows)	0	0
Ozite® Ceiling Liner Throughout	S	S
Hardwood Trim Package (Slide-Out Models Only)	0	0

KITCHEN FEATURES	Greyhawk	Granite Ridge
Recessed Sink and Stove	S	S
Water Purification System	S	S
Battery Switch	S	S
Single-Lever Chrome Faucet	S	N/A
Single-Lever Chrome Faucet with Sprayer	N/A	S
Cutting Boards (2)	S	S
Three-Burner Range with Oven	S	S
Bi-Fold Range Cover	S	S
Flush-Mount Double-Door Refrigerator	S	S
Refrigerator with Ice Maker	N/A	0
Mini Blind in Galley	S	S
Divided Silverware Drawer	S	S
Microwave Oven with Carousel	S	S
Deep Pile Carpeting with Thick Padding	S	N/A
Linoleum Floor in Kitchen	0	N/A
Hardwood Floor in Kitchen	N/A	S
Coffee Maker	0	S
Self-Edge Countertop	S	N/A
Wood-Edge Countertop	N/A	S
Plexiglass Splash Guard	S	S

* New for 2003

S = Standard 0 = Optional N/A = Not Available

BATHROOM FEATURES	Greyhawk	Granite Ridge
Shower or Tub/Shower (See Floorplans)	S	S
Shower Curtain	S	N/A
Pleated Shower Door	O	S
Power Vent	S	S
Linoleum Floor in Bathroom	S	S
Wood Medicine Cabinet with Mirrors	S	S
Foot-Pedal Stool	N/A	S
Bath Skylight with Light (Most Models)	S	S
Recessed Towel Rods in Bathroom Door (Most Models)	S	S
Removable Clothes Rod in Tub (Most Models)	S	S
Toothbrush Holder, Soap Holder	N/A	S

BEDROOM FEATURES	Greyhawk	Granite Ridge
Queen Bed with Pillow Top Mattress (Most Models)	S	S
Twin Beds with Innerspring Mattress (Most Models)	O	N/A
Bed Struts for Easy Lift-Up Beds, Finished Storage Underneath	S	S
Pleated Shades	S	N/A
Day/Night Shades	O	S
Jalousie Windows	S	S
Recessed TV Shelf (Most Models, See Floorplans)	S	S
Deluxe Bedspread	S	S
Large Bedroom Wardrobes with Homestyle Handles (Most Models, See Floorplans)	S	S
Halogen Reading Lights	S	S
Two Pillow Shams (Queen Bed)	N/A	S
Convenience Package (Rechargeable Flashlight, Wet-Dry Vacuum, AM/FM Radio in Bedroom)	O	O

EXTERIOR FEATURES	Greyhawk	Granite Ridge
Filon Plus Sidewalls* (including Entrance and Baggage Doors)	S	S
Full Body Paint (Pine Forest, Mountain Berry)	N/A	O

EXTERIOR FEATURES (Cont.)	Greyhawk	Granite Ridge
Utility Center (Full Basement Models)	S	S
Dead-Bolt Lock on Entrance Door	S	S
Roof Ladder	S	S
Lockable Exterior Storage Compartments with Door Pulls	S	S
Pass-Through Storage Compartment with Light(s) (Most Models)	S	S
Class A Motorhome-Style Baggage Doors	N/A	S
White Radius-Cornered Windows	S	S
Radius-Cornered Entrance Door	S	S
Patio Light	S	S
110V Exterior Receptacle	S	S
Dump-Valve Access Door on Full Basement Models	S	S
Entry Assist Handle	S	S
Fiberglass Running Boards	S	S
Steel Powder-Coated Rear Bumper	S	S
TPO Roof	S	S
Patio Awning	O	O
12V Awning with Remote	O	O
Electric Double Entrance Step	O	S
Wheel Covers	S	N/A
Wheel Liners	O	S
Spare Tire, Carrier and Cover (23 RK, 24 SS)	S	N/A
Spare Tire with Crank-Down Mechanism (Full Basement Models)	S	S
Towing Hitch and Wiring	S	S
Tinted Safety Glass Windows	S	S
Outside Shower (Full Basement Models)	S	S
Outside Shower (23 RK, 24 SS)	O	N/A
Exterior Entertainment Center	O	O
Slide-Out Battery Tray	S	S
Rear Cornercaps	N/A	S
Rear Window (Most Models)	O	O
Portable BBQ Grill with Carrying Case	O	O
Third Brake Light	S	S

2003 GREYHAWK™ & GRANITE RIDGE™ Specifications

Models	Exterior Length	Exterior Height w/opt. AC	Gross Vehicle Weight Rating (Lbs.)	Chassis and Engine Size	Wheelbase	Furnace, Auto-Ignition (BTUs)	Fresh Water Capacity (Gal.)	Gray Tank Capacity (Gal.)	Toilet/Waste Tank Capacity (Gal.)
Greyhawk									
23 RK	23' 3"	130"	12,300	Chevrolet 6.0L/V8	159"	25,000	31	39	35
24 SS	25' 1"	130"	12,300	Chevrolet 6.0L/V8	181"	25,000	38	39	35
26 SS	27' 2"	136"	14,050	Ford 6.8L/V10	176"	31,000	38	40	36
27 DS	27' 11"	136"	14,050	Ford 6.8L/V10	182"	31,000	38	40	36
28 GS	28' 8"	136"	14,050	Ford 6.8L/V10	185"	31,000	38	40	36
28 RB	28' 7"	136"	14,050	Ford 6.8L/V10	185"	31,000	38	40	36
30 GS	30' 6"	136"	14,050	Ford 6.8L/V10	212"	31,000	38	40	36
31 RB	31' 1"	136"	14,050	Ford 6.8L/V10	218"	31,000	38	40	36
Granite Ridge									
2700 DS	27' 11"	136"	14,050	Ford 6.8L/V10	182"	31,000	38	40	36
3000 GS	30' 6"	136"	14,050	Ford 6.8L/V10	212"	31,000	38	40	36
3100 SS	31' 1"	136"	14,050	Ford 6.8L/V10	218"	31,000	38	40	36
3200 SL	32' 7"	136"	14,050	Ford 6.8L/V10	218"	31,000	38	40	36