



Seismic



Serial #: 1UJCGSCV8T18N0095
Model: 413 SEISMIC FW

Model Year: 2026 Dealer Name: PETE'S RV CENTER
417 JOHN FITCH BLVD.
S. WINDSOR, CT 06074
USA

Standard Equipment

THE FOLLOWING ITEMS ARE STANDARD ON THIS MODEL

- STANDARD EXTERIOR EQUIPMENT**
- 102 in. wide body structural steel I-beam construction
 - NPS – Powered by Yamaha 6,000 watt generator with built in pure sine inverter, gas/C.A.R.B certified
 - 6-point hydraulic auto-leveling system
 - Battery disconnect switch
 - Climate Shield™ zero-degree tested weather protection:
 - *35,000 BTU output furnace
 - *Double layer fiberglass batt insulation in ceiling and floor
 - *Double sided radiant barrier insulation (roof and floor)
 - *Fully enclosed and heated underbelly (ducted)
 - Custom automotive-grade vinyl exterior graphics package
 - Detachable shore power cord
 - Digital TV antenna
 - Dual 30 lb. propane bottles with auto regulator
 - Exterior marine-grade speakers
 - Folding roof ladder
 - Fully enclosed, LED-lighted universal docking center:
 - *Black tank flush, winterization and sanitation
 - *Quick-connect outside shower
 - *Satellite prep
 - HELIX Cooling System™ (industry exclusive):
 - *Directional and closeable A/C vents
 - *Jayco-exclusive insulated dual duct design
 - *Three exterior-mounted 13,500 BTU soft-start, high-efficiency, ducted A/Cs (living room and bedroom)
 - JaySMART™ (Safety Markers And Reverse Travel) LED lighting (patented)
 - LED exterior lighting package
 - LP quick-connect
 - Magnum Truss™ Roof System (strongest tested roof in the industry) with Alpha roof membrane system with limited lifetime warranty
 - Painted fiberglass front cap with clear coat and built-in specialty LED lighting
 - Pass-through storage with Slam-latch™ baggage doors
 - Stronghold VBL™ aluminum framed and vacuum bond laminated gel coated fiberglass exterior walls and slide room end walls
 - Under-mounted spare tire
 - Water heater bypass
- RAMP AND CARGO EQUIPMENT**
- 30 gal. fuel tank with timer
 - Garage D-rings mounted to steel frame
 - HappiJao® electric-lift queen beds/convertible sofas with folding armrests and cup holders
 - LED high-intensity ramp lights
 - Ram air vents and power roof vent
 - Ramp patio kit with exterior steps
 - Rear electric patio awning
 - Rear ramp door and patio with anti-slip, non-skid flooring
 - Three seasons removable garage wall/doors
 - Tuff-ply, rubberized garage floor liner

- STANDARD INTERIOR EQUIPMENT**
- Olympic King bed (8K & 8N)
 - 12V charging station
 - 5/8 in. tongue-and-groove joined plywood main floor decking and 3/8 in. tongue-and-groove plywood in the roof
 - Bathroom skylight
 - Carbon monoxide and LP detector
 - Central command center with built-in tank monitoring
 - Custom interior design (Dune Gray)
 - Gas-strutted under-bed storage
 - Handcrafted and glazed doors, drawers and trim
 - Hardwood safety handrail on hallway steps
 - Heavy-duty, 75 lb., full-extension, steel ball-bearing drawer guides
 - Inverter pre-wire
 - LED fireplace with electric space heater (select models)
 - LED interior lighting throughout
 - No in floor heat registers throughout the coach
 - Porcelain foot flush toilet
 - Residential "Do it all" sink with pull-out kitchen faucet, glass rinse and vegetable rinse
 - Residential finished dove tail jointed drawers throughout
 - Residential NuVo H2O whole coach water treatment system with water softening and triple cartridge filters
 - Residential quilted bedspread
 - Residential vinyl flooring (made in the USA)
 - Solid hardwood cabinet doors
 - Stain protected fabric on all furniture
 - SuperSofa or theatre seats with heat, massage and LED lighting (select models)
 - Vinyl flooring in slideouts (no carpet)
 - Washer/dryer prep
- CUSTOMER VALUE PACKAGE (MANDATORY)**
- On-demand tankless hot water heater
 - 17 cu. ft. 12V refrigerator
 - 2nd electric awning w/ RGB LED lights & remote control
 - 30" Space saver microwave
 - 4K Smart LED HDTV with fully digital HDMI® output
 - 50-amp service
 - Touch screen Bluetooth® stereo with 4 speakers
 - Bathroom power vent
 - Custom black, machined aluminum rims
 - Electric awning with RGB LED lights and remote control
 - Hidden hinges and magnet door catches on cabinet doors
 - Keyed-Alike™ lock system
 - MORryde® strut-assisted fold-away entrance steps (main entrance)
 - Night roller-shades
 - Residential 21" oven with three burners
 - Overlander 2 Solar Package: 30-amp solar controller with (2) roof-mounted 200W solar panels and a 1800W inverter
- 5 STAR HANDLING PACKAGE (MANDATORY)**
- 17.5 in. 16 ply "H" rated tires
 - Dexter® Axles with ABS and Tow Assist - includes Nev-R-Adjust® brakes and E-Z Lube® hubs
 - Rota-flex king pin
 - Wet bolt fasteners, bronze bushings and 4,000 lb. leaf springs
 - MorRyde CRE 3000 Suspension System

Optional Equipment

OPTIONAL EQUIPMENT INSTALLED ON THIS VEHICLE BY MANUFACTURER

Base price	128,993.00
GRAPHICS	n/c
USA STANDARDS	n/c
CUSTOMER VALUE PACKAGE	7,500.00
FIVE STAR HANDLING PACKAGE	5,993.00
TINTED SAFETY GLASS	n/c
WINDOWS	n/c
NO SLIDEOUT AWNING	n/c

UNIT TOTAL 142,486.00

DEALER INSTALLED OPTIONS

Manufacturer's Suggested Retail Price \$142,486.00

TOTAL AMOUNT DOES NOT INCLUDE STATE AND LOCAL TAXES OR LICENSE FEES. THE PRICE SHOWN ABOVE MAY OR MAY NOT BE REPRESENTATIVE OF THE ACTUAL SELLING PRICE OF SIMILAR RECREATIONAL VEHICLES IN YOUR AREA

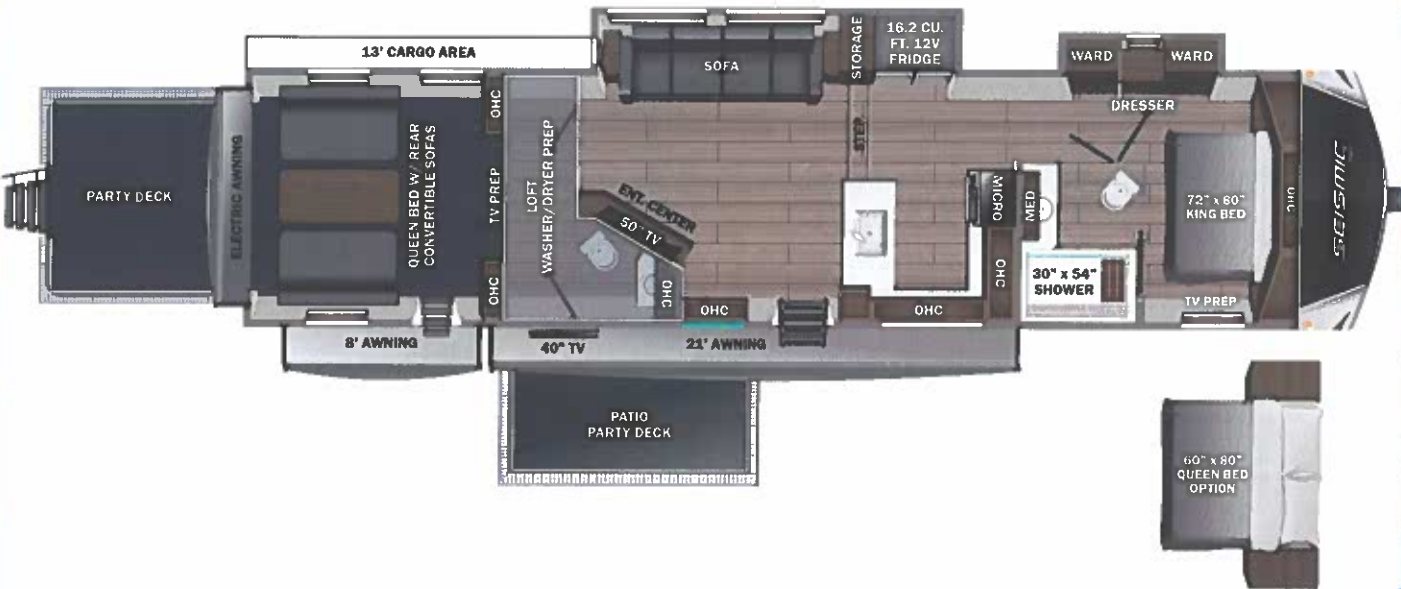

UVW 16205 lbs
Sleeps
Length 47' 0.25"

DIMENSIONS

Exterior height:.....159.00"
Exterior width:.....102.00"
WEIGHTS
GVWR:.....20800
GAWR (front):.....7000
GAWR (rear):.....7000
Approx. Gross Cargo Carrying Capacity(GCCC):.....4595

CAPACITIES

Fresh water tank (gals.):...106.10
Gray water tank (gals.):....87.00
Black water/toilet tank (gals):.....87.00
Propane (lbs.):.....60
Propane (gals.):.....14
Water heater (gals.):.....0.25

SEATING & SLEEPING

TIRES

Tire size (front):.....
Tire size (mid):.....
Tire size (rear):.....
Tire size (spare):.....

Some dimensions may be rounded and may vary from the actual dimensions
Weights may be estimated calculations and may vary from the actual weight - refer to the vehicle weight labels for actual weights
Floorplans, features and specifications are subject to change without notice.

