



Odyssey



Serial #: 1JSLECBR9T1EV8099
Model: 29V ODYSSEY MHC
VIN#: 1FDXE4FN1TDD27963
Model Year: 2026 Dealer Name: KEYSTONE RV CENTER

15799 S YOUNG RD
GREENCASTLE, PA 17225
USA

Standard Equipment

THE FOLLOWING ITEMS ARE STANDARD ON THIS MODEL

STANDARD EXTERIOR EQUIPMENT
Ford® E-450 chassis
GVWR - 14,500 lb.
CWR - 22,000 lb.
3.0L V-8 325 HP engine with 450 ft.-lb. torque
6-speed TorqShift® series transmission with overdrive
10-amp alternator
Catalytic converter theft deterrent
14-rated highway tires- LT225/75R16
Tire pressure monitoring system (TPMS)
Power anti-lock brakes with power steering
5,500 lb. hitch with 750 lb. tongue capacity and 2-in. plug
2V chassis battery
5 gal. fuel tank
UniShell™ vacuum-bond laminated roof, floor and walls
Dead-foam insulation (R-24 max roof, R-9 max floor, R-5 max walls)
One-piece, seamless, fiberglass roof
Aluminum running boards
Fiberglass exterior walls with vinyl graphics
Leveling jack prep
Entrance door with industry's largest travel-view window
Electric-powered entrance step with integrated battery compartment
Slideout cover awnings
Pass-through storage compartment with lighted models
Exterior LED HD Smart TV with (2) JBL® 100W output, marine-grade exterior speakers
Hood brake light
Roof ladder (24B, 25R, 26M, 27U, 29V, 31F)
Prep for satellite dish
Cable TV hookup with RG-6 coax
Inegard 2.0 Wi-Fi/4G antenna
3,000W generator
Solar prep
3,000W inverter
2V house battery
Transfer switch with reverse polarity protection
60-amp electrical service
2.2 gal. propane tank (41 lb.)
P quick-connect hookup
Exterior utility center
Winterization drain system
Outside shower
2V demand water pump
Water filtration system

CUSTOMER VALUE PACKAGE
-Z Drive™: Computer-balanced driveshaft, standard front and rear stabilizer bars, Hellwig® helper springs, rubber isolation body mounts
One-piece, seamless fiberglass front cap
Automotive-bonded panoramic window in front cap
1 power shade
Frameless windows
Sealed holding tanks (12V pads)
Electric patio awning with LED lights
Black tank flush
Only® infotainment center with tilt/swivel, Apple® Play and Android Auto™
Backup and side-view cameras
LED HD Smart TV in living area

STANDARD INTERIOR EQUIPMENT
- Swivel driver and passenger seats
- Remote-controlled, side-view mirrors
- Tilt steering wheel
- Cruise control
- Hill start assist
- Electronic stability control
- Traction control
- Automatic emergency braking (AEB)
- Securilock® anti-theft ignition
- Auxiliary start switch
- Power windows and door locks
- Driver and passenger airbags
- Privacy curtain for cab area
- Remote keyless cab entry
- Custom-molded ABS surround in cab-over area
- Overhead bunk with 750 lb. capacity and safety net
- 84 in. ceiling height
- High-intensity recessed LED lights
- LED-lit slideout fascia
- Hardwood cabinet doors and drawer fronts
- Ball-bearing drawer guides
- Interior entrance door grab handle
- Interior command center
- Pleated blackout shades
- 15,000 BTU ducted A/C
- 30,000 BTU auto-ignition furnace
- Electric fireplace (26M, 30Z)
- 6 gal. gas/electric DSI auto-ignition water heater
- Entegra-exclusive, easy-operation legless dinette table
- 2-point lap safety belts in all designated seating locations
- JBL® audio system
- 10.6 cu. ft. refrigerator
- All-in-one cooktop and oven
- Residential-size microwave
- LED-lit kitchen countertops
- Recessed stainless steel kitchen sink with cutting board sink cover
- Decorative kitchen backsplash
- Pop-up charging station with 120V outlet and USB plugs
- Queen-size bed with bedspread (24B, 25R, 29V, 30Z, 31F)
- King size bed with bedspread (27U)
- Queen-size power Murphy bed (26M)
- USB port and wireless charging in nightstands (27U, 29V, 30Z, 31F)
- USB port in cabinet over bed (24B, 25R, 26M)
- Under-bed storage (select models)
- Bedroom TV prep
- Large wardrobes
- Bunks with industry-exclusive, 300 lb. capacity each (31F)
- Wall-mounted tablet holder in each bunk (31F)
- Shower with decorative surround, glass door, skylight and light
- Recessed stainless steel bathroom sink
- Porcelain toilet with foot flush
- Powered roof vent in bathroom with wall switch
- Smoke alarm
- Carbon monoxide detector
- Fire extinguisher

Optional Equipment

OPTIONAL EQUIPMENT INSTALLED ON THIS VEHICLE BY MANUFACTURER

Base price	172,043.00
FARMHOUSE DECOR	593.00
OXFORD FULL PAINT	14,993.00
USA STANDARDS	n/c
26 FORD E45 14500 158"	
7.3L TD307	n/c
CUSTOMER VALUE PACKAGE	6,000.00
NO BEDROOM TV	n/c
DUAL 13.5K ACS	1,193.00
HYDRAULIC AUTO LEVELING JACKS	3,893.00
200W ROOF MOUNTED SOLAR PANEL W/2ND HOUSE BATTERY	893.00
STANDARD HOUSE BATTERY	n/c
FOLDING WINDSHIELD SUN SHADE	488.00
THEATER SEATING SOFA	743.00

UNIT TOTAL 200,839.00

DEALER INSTALLED OPTIONS

Manufacturer's Suggested Retail Price

\$200,839.00

TOTAL AMOUNT DOES NOT INCLUDE STATE AND LOCAL TAXES OR LICENSE FEES. THE PRICE SHOWN ABOVE MAY OR MAY NOT BE REPRESENTATIVE OF THE ACTUAL SELLING PRICE OF SIMILAR RECREATIONAL VEHICLES IN YOUR AREA.

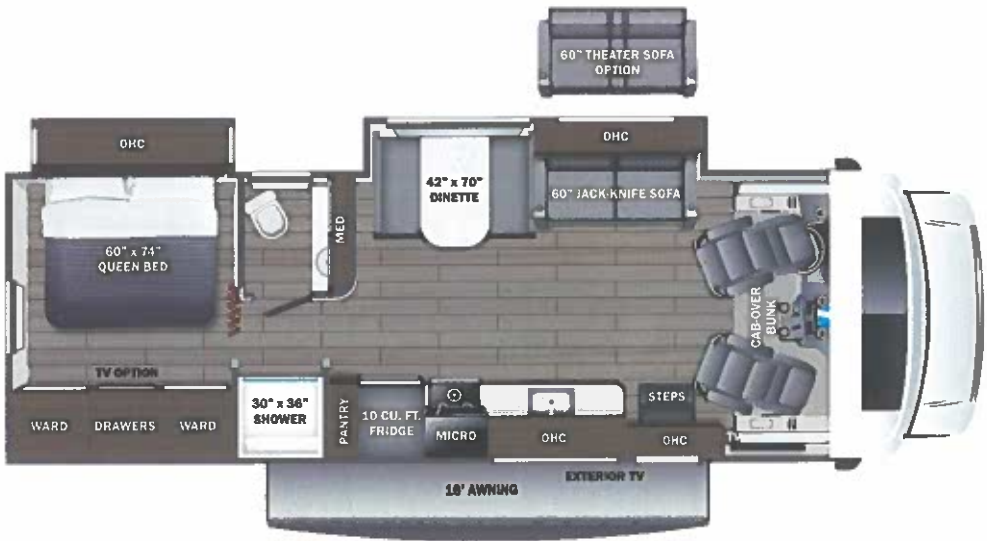

DIMENSIONS

Exterior height:.....140.00"
Exterior width:.....100.00"

Tire size (front):.....LT225/75R16E
Tire size (mid):.....
Tire size (rear):.....LT225/75R16E

CAPACITIES

Fresh water tank (gals.):...47.00
Gray water tank (gals.):...41.00
Black water/toilet tank (gals.):.....32.00
Propane (lbs.):.....41
Propane (gals.):.....9
Water heater (gals.):.....6.00

Some dimensions may be rounded and may vary from the actual dimensions
Weights may be estimated calculations and may vary from the actual weight - refer to the vehicle weight labels for actual weights
Floorplans, features and specifications are subject to change without notice.

