

93335

93335



## Jay Flight SLX



Serial #: 1UJBC0AK7T1Y70147  
Model: 172DB JAY FLIGHT SLX TT

Model Year: 2026 Dealer Name: KEYSTONE RV CENTER  
15799 S YOUNG RD  
GREENCASTLE, PA 17225  
USA

Manufacturer's Suggested Retail Price \$24,893.00

TOTAL AMOUNT DOES NOT INCLUDE STATE AND LOCAL TAXES OR LICENSE FEES. THE PRICE SHOWN ABOVE MAY OR MAY NOT BE REPRESENTATIVE OF THE ACTUAL SELLING PRICE OF SIMILAR RECREATIONAL VEHICLES IN YOUR AREA.

### Standard Equipment

THE FOLLOWING ITEMS ARE STANDARD ON THIS MODEL

#### STANDARD EXTERIOR EQUIPMENT

- 30-amp service
- 8K BTU wall mount A/C (single axle models)
- 13.5K BTU Roof A/C (double axle models)
- Axles with electric, self-adjusting brakes and easy-lube hubs
- Exterior cable TV hookup
- Fully-integrated A-frame
- Galvanized-steel, impact resistant wheel wells
- Large exterior downspouts
- LP quick connect (outside grill prep) [N/A on Sport Edition]
- Magnum Truss™ Roof System
- Nitrogen filled radial tires
- PVC roofing membrane (limited lifetime warranty)

#### CUSTOMER VALUE PACKAGE - SPORT EDITION

- 12V Refrigerator
- 19K BTU furnace
- 2-burner stovetop
- Bathroom vent
- Detachable power cord
- Entry door with window and shade prep
- G20 dark tinted privacy windows
- LED interior and exterior lights
- Microwave oven
- Stabilizer jacks
- Window shades
- Power awning
- Front tongue jack
- Rear bumper
- 20 lb. LP bottle
- On-demand tankless water heater

#### STANDARD INTERIOR EQUIPMENT

- 300 lb. rated single bunk beds
- 600 lb. rated double bunk beds
- Digital TV antenna
- Heavy-duty, 75 lb., full-extension, steel ball-bearing drawer guides
- High rise kitchen faucet
- Marine-grade toilet with foot flush
- Plywood bed platforms
- Queen mattress
- Residential-style hidden cabinet door hinges
- Residential-style kitchen countertops
- Shower curtain with curved shower track (select models)
- Solid hardwood cabinet doors with screwed stile construction and hidden hinges
- Vinyl flooring throughout

### Optional Equipment

OPTIONAL EQUIPMENT INSTALLED ON THIS VEHICLE BY MANUFACTURER

Base price	19,643.00
USA STANDARDS	n/c
CUSTOMER VALUE PACKAGE	
SPORT EDITION	5,250.00
8,000 BTU WALL MOUNT AC	n/c

UNIT TOTAL 24,893.00

DEALER INSTALLED OPTIONS

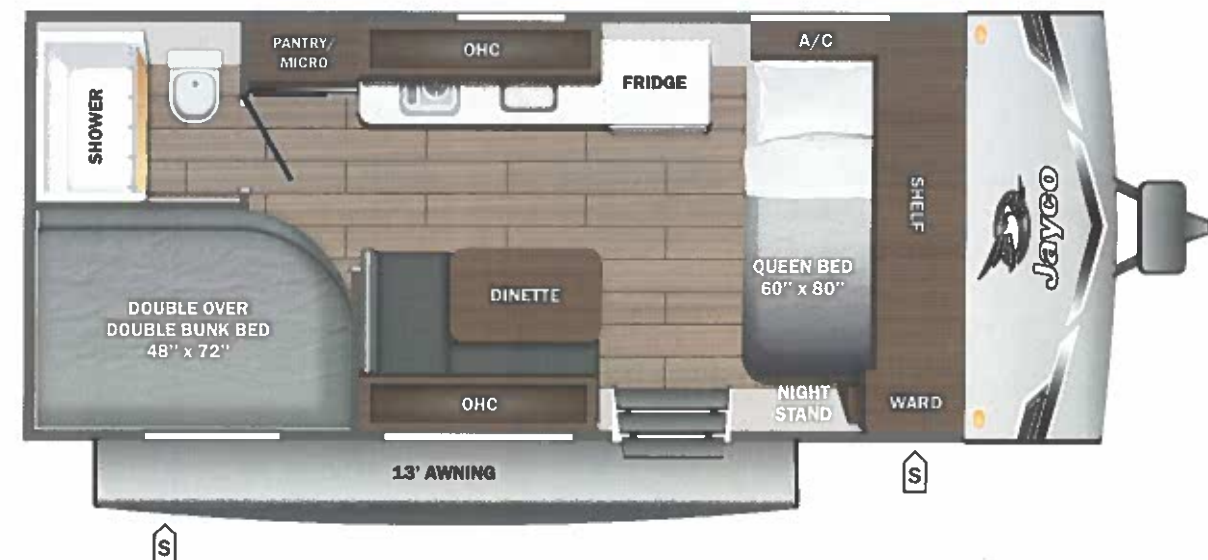

**UVW**  
3255 lbs

**Sleeps**

**Length**  
22' 5"

#### DIMENSIONS

Exterior height:.....123.00"

Exterior width:.....96.00"

#### WEIGHTS

GVWR:.....3995

GAWR (front):.....3700

GAWR (rear):.....0

Approx. Gross Cargo Carrying Capacity(GCCC):.....740

#### TIRES

Tire size (front):.....ST205/75R14D

Tire size (mid):.....

Tire size (rear):.....

Tire size (spare):.....

#### CAPACITIES

Fresh water tank (gals.):...30.00

Gray water tank (gals.):...39.00

Black water/toilet tank (gals.):...39.00

Propane (lbs.):.....20

Propane (gals.):.....4

Water heater (gals.):.....0.25

#### SEATING & SLEEPING

\*\*\*Some dimensions may be rounded and may vary from the actual dimensions\*\*\*

\*\*\*Weights may be estimated calculations and may vary from the actual weight

- refer to the vehicle weight labels for actual weights\*\*\*

Floorplans, features and specifications are subject to change without notice.

**2+3**  
YEAR | YEAR  
LIMITED | STRUCTURAL  
WARRANTY