

81545



# Jay Feather SL



Serial #: 1UJBB0BP0T13C0071  
Model: 26BHSL JAY FEATHER SL TT

Model Year: 2026 Dealer Name: KEYSTONE RV CENTER  
15799 S YOUNG RD  
GREENCASTLE, PA 17225  
USA

## Standard Equipment

## Optional Equipment

THE FOLLOWING ITEMS ARE STANDARD ON THIS MODEL

OPTIONAL EQUIPMENT INSTALLED ON THIS VEHICLE BY MANUFACTURER

### STANDARD EXTERIOR EQUIPMENT

- 30-amp service
- Axles with electric, self-adjusting brakes and easy-lube hubs
- 120V power outlet
- Fully-integrated A-frame
- Galvanized-steel, impact-resistant wheel wells
- Large exterior downspouts
- Magnum Truss™ roof system
- Nitrogen-filled radial tires
- PVC roofing membrane (limited lifetime warranty)
- Slide topper prepped

### STANDARD INTERIOR EQUIPMENT

- High-rise kitchen faucet
- Residential-style kitchen countertops
- Queen mattress
- Plywood bed platforms
- 300 lb. rated single bunk beds / 600 lb. rated double bunk beds
- Wood-trimmed mirror in bathroom
- Marine-grade toilet with foot flush
- Vinyl flooring throughout
- Solid hardwood cabinet doors with screwed-stile construction and hidden hinges
- Digital TV antenna
- Heavy-duty, 75 lb. full-extension steel ball-bearing drawer guides

### CUSTOMER VALUE PACKAGE

- 11 Cu Ft 12V Refrigerator
- 13.5K BTU Roof A/C
- Roof mount solar prep
- Automotive-style Aluminum Rims
- Rear back-up camera prep
- Bathroom Skylight
- Detachable power cord
- Plywood dinette bases
- Electric vent in bathroom
- Electric Fireplace Prep
- Entry door with window and shade prep
- G20 Dark-tinted privacy windows
- Hidden cabinet hinges
- Keyed-Alike™ lock system
- Large folding entry door grab handle
- LED interior and exterior lights
- 20 lb. LP bottle with auto regulator & fill gauge
- Microwave oven
- MORryde Step Above® Entry Steps
- On-demand tankless water heater
- Power awning w/LED Lights
- Range Hood
- Rear 2" Receiver Prep
- Stabilizer jacks
- Shower surround
- Under-mount spare tire
- Vacuum-bonded sidewalls with interior and exterior Azdel® composite panels
- Pleated window shades
- Inverter pre-wire outlets
- Power tongue jack
- Keyed-Alike™ lock system

Base price	37,343.00
USA STANDARDS	n/c
CUSTOMER VALUE PACKAGE	5,625.00
SOLAR POWER PACKAGE PREP	n/c
15,000 BTU AC	300.00
NO 2ND AC	n/c
30 AMP SERVICE	n/c
JACK KINFE SOFA	n/c

UNIT TOTAL 43,268.00

DEALER INSTALLED OPTIONS

Manufacturer's Suggested Retail Price \$43,268.00

TOTAL AMOUNT DOES NOT INCLUDE STATE AND LOCAL TAXES OR LICENSE FEES. THE PRICE SHOWN ABOVE MAY OR MAY NOT BE REPRESENTATIVE OF THE ACTUAL SELLING PRICE OF SIMILAR RECREATIONAL VEHICLES IN YOUR AREA.

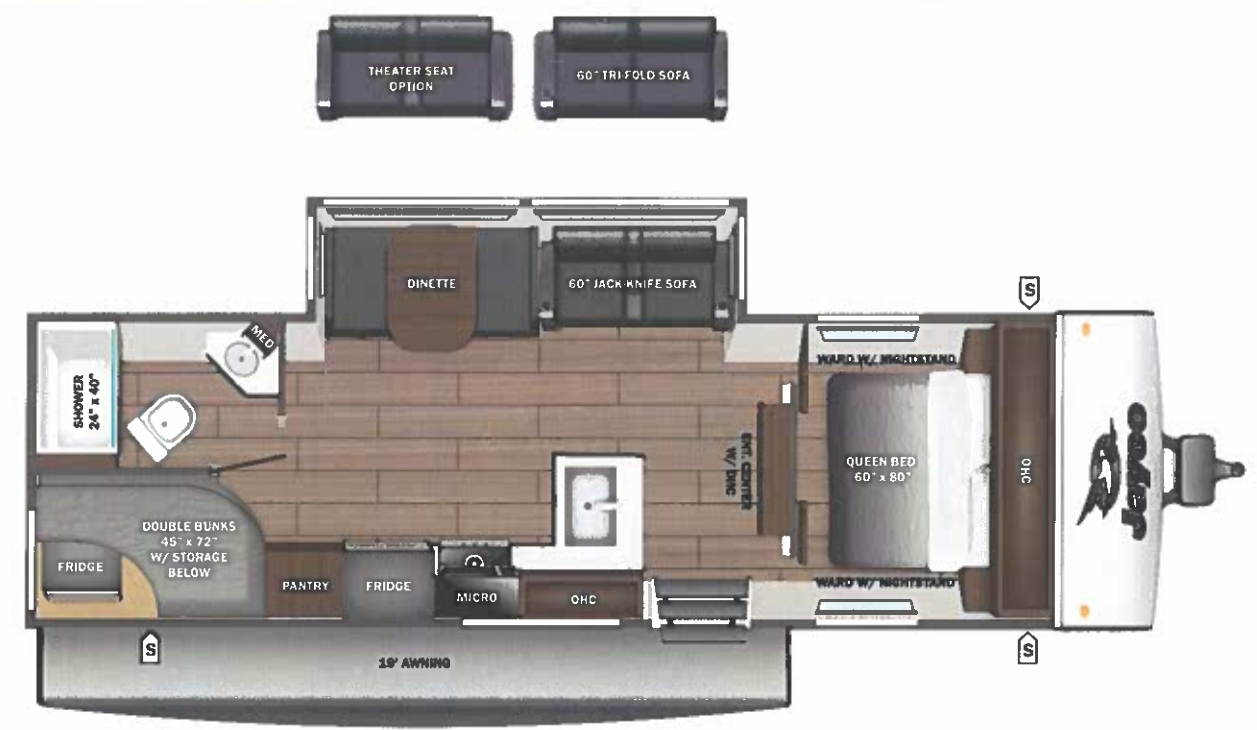

 **UVW**  
5785 lbs

 **Sleeps**

 **Length**  
30' 5.44"

### DIMENSIONS

Exterior height:.....128.75"  
Exterior width:.....96.00"

### WEIGHTS

GVWR:.....7200  
GAWR (front):.....3500  
GAWR (rear):.....3500

Approx. Gross Cargo Carrying Capacity(GCCC):.....1415

### TIRES

Tire size (front):.....ST205/75R14D  
Tire size (mid):.....  
Tire size (rear):.....ST205/75R14D  
Tire size (spare):.....ST205/75R14D

### CAPACITIES

Fresh water tank (gals.):...55.00  
Gray water tank (gals.):...38.00  
Black water/toilet tank (gals.):.....38.00  
Propane (lbs.):.....40  
Propane (gals.):.....9  
Water heater (gals.):.....0.25

### SEATING & SLEEPING

\*\*\*Some dimensions may be rounded and may vary from the acutal dimensions\*\*\*  
\*\*\*Weights may be estimated calculations and may vary from the actual weight  
- refer to the vehicle weight labels for actual weights\*\*\*  
Floorplans, features and specifications are subject to change without notice.

