

82380



Jay Flight SLX



Serial #: 1UJBC0BT4T16J0148
Model: 295TBS JAY FLIGHT SLX TT

Model Year: 2026 Dealer Name: KEYSTONE RV CENTER
15799 S YOUNG RD
GREENCASTLE, PA 17225
USA

Standard Equipment

THE FOLLOWING ITEMS ARE STANDARD ON THIS MODEL

- STANDARD EXTERIOR EQUIPMENT**
- 30-amp service
 - 8K BTU wall mount A/C (single axle models)
 - 13.5K BTU Roof A/C (double axle models)
 - Axles with electric, self-adjusting brakes and easy-lube hubs
 - Exterior cable TV hookup
 - Fully-integrated A-frame
 - Galvanized-steel, impact resistant wheel wells
 - Large exterior downspouts
 - LP quick connect (outside grill prep) (N/A on Sport Edition)
 - Magnum Truss™ Roof System
 - Nitrogen filled radial tires
 - PVC roofing membrane (limited lifetime warranty)

- CUSTOMER VALUE PACKAGE**
- 8 cu. ft. 12V refrigerator
 - AM/FM/Bluetooth® stereo (N/A on single axles)
 - Backup camera prep
 - Bathroom skylight
 - Bathroom vent
 - Detachable power cord
 - Entry door with window and shade prep
 - Fitted bed sheet
 - G20 dark tinted privacy windows
 - Keyed-Alike™ entry and baggage doors
 - Large folding entry door grab handle
 - LED interior and exterior light
 - Microwave oven
 - On-demand tankless water heater
 - Power awning with LED lights
 - Range hood
 - MORryde Step Above® entry steps
 - Spare tire with cover
 - Stabilizer jacks
 - Tub/shower surround
 - Window shades

- STANDARD INTERIOR EQUIPMENT**
- 300 lb. rated single bunk beds
 - 600 lb. rated double bunk beds
 - Digital TV antenna
 - Heavy-duty, 75 lb., full-extension, steel ball-bearing drawer guides
 - High rise kitchen faucet
 - Marine-grade toilet with foot flush
 - Plywood bed platforms
 - Queen mattress
 - Residential-style hidden cabinet door hinges
 - Residential-style kitchen countertops
 - Shower curtain with curved shower track (select models)
 - Solid hardwood cabinet doors with screwed stile construction and hidden hinges
 - Vinyl flooring throughout

Optional Equipment

OPTIONAL EQUIPMENT INSTALLED ON THIS VEHICLE BY MANUFACTURER

Base price	39,368.00
USA STANDARDS	n/c
CUSTOMER VALUE PACKAGE	5,250.00
NO ELITE PACKAGE	n/c
15,000 BTU ROOF MOUNTED AC	300.00
NO 2ND AC	n/c
NO 3RD AC	n/c
50 AMP SERVICE	443.00
BLACK SPOKE RIMS	n/c
JACK KNIFE SOFA	n/c

UNIT TOTAL 45,361.00

DEALER INSTALLED OPTIONS

Manufacturer's Suggested Retail Price \$45,361.00

TOTAL AMOUNT DOES NOT INCLUDE STATE AND LOCAL TAXES OR LICENSE FEES. THE PRICE SHOWN ABOVE MAY OR MAY NOT BE REPRESENTATIVE OF THE ACTUAL SELLING PRICE OF SIMILAR RECREATIONAL VEHICLES IN YOUR AREA.

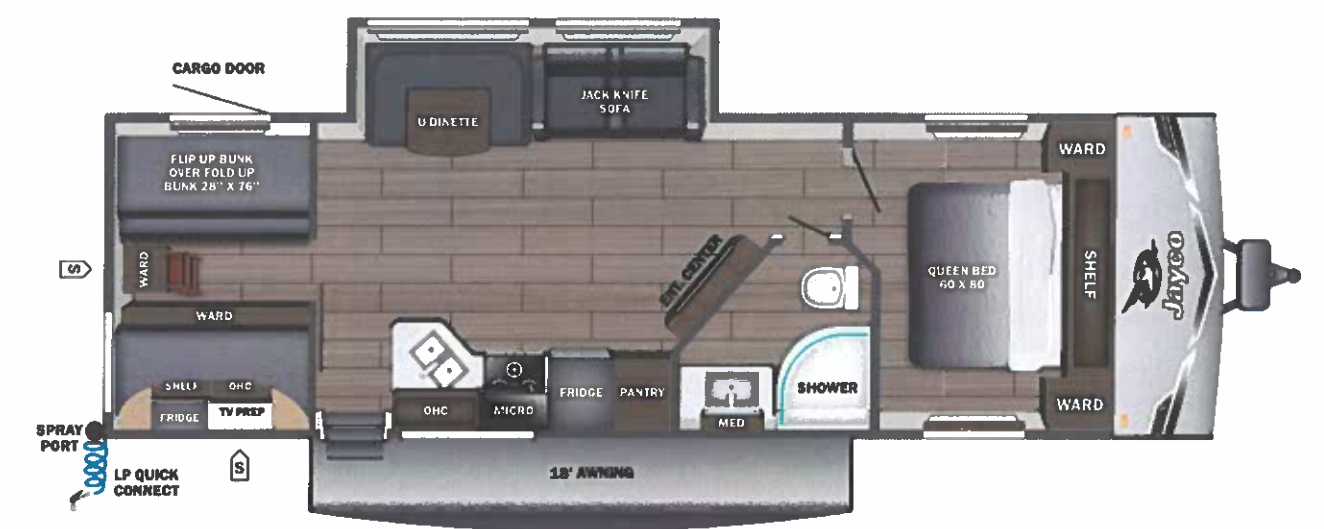

**UVW**
7190 lbs

**Sleeps**

**Length**
36' 9.75"

DIMENSIONS	CAPACITIES
Exterior height:.....132.13"	Fresh water tank (gals.):...52.00
Exterior width:.....96.00"	Gray water tank (gals.):....39.00
WEIGHTS	Black water/toilet tank (gals.):.....39.00
GVWR:.....9200	Propane (lbs.):.....40
GAWR (front):.....4400	Propane (gals.):.....9
GAWR (rear):.....4400	Water heater (gals.):.....0.25
Approx. Gross Cargo Carrying Capacity (GCCC):.....2010	SEATING & SLEEPING
TIRES	
Tire size (front):.....ST225/75R15E	
Tire size (mid):.....	
Tire size (rear):.....ST225/75R15E	
Tire size (spare):.....ST225/75R15E	

Some dimensions may be rounded and may vary from the actual dimensions
Weights may be estimated calculations and may vary from the actual weight - refer to the vehicle weight labels for actual weights
Floorplans, features and specifications are subject to change without notice.

