



Pinnacle



Serial #: 1UJCF0BT0T1RV0103  
Model: 32RLTS PINNACLE FW

Model Year: 2026 Dealer Name: PETE'S RV CENTER  
417 JOHN FITCH BLVD.  
S. WINDSOR, CT 06074  
USA

Standard Equipment

THE FOLLOWING ITEMS ARE STANDARD ON THIS MODEL

**STANDARD EXTERIOR EQUIPMENT**

- 102 in. widebody construction
- 12 in. structural steel I-beam with 8 or 10 in. monster beam steel drop frame
- 120V heat blankets on all tanks plus 12V heat tape on fresh water line
- 3,000 lb. tow hitch with 4-way pin
- Battery disconnect
- Built in sewer hose carrier
- Climate Shield™ zero-degree tested weather protection:
- 40,000 BTU output furnace
- Double layer fiberglass batt insulation (roof and floor)
- Fully enclosed and heated underbelly (ducted)
- 2 in. block foam and reflective foil
- Digital TV antenna
- Exterior marine-grade speakers with Bluetooth® controller
- Frameless dark tinted safety-glass windows
- Fully enclosed, universal docking center:
- Black tank flush
- Independent satellite wiring
- Quick-connect outside shower
- Selectable water connections
- Whole coach cable hookups
- Winterization and sanitation hookups
- Inverter pre-wire to select outlets
- JayPort outside griddle prep (standard on all floorplans without a standard outside kitchen)
- JaySMART™ (Safety Markers And Reverse Travel) LED lighting (patented)
- Magnum Truss™ XL6™ Roof System with Alpha roof membrane system
- Painted fiberglass front and rear cap with clear coat
- Pass-through storage with Slam-latch™ baggage doors
- Skirt metal enclosed drop frame
- Stronghold VBL™ aluminum framed and vacuum bond laminated walls
- Under-mounted spare tire

**LUXURY PACKAGE (MANDATORY)**

- 2nd electric patio awning (multi-colored with remote control)
- 40 in. 4K outside Smart LED TV
- 32 in. 4K Smart LED bedroom TV
- 6-point hydraulic auto-leveling system
- Central vacuum system with dust port
- Day/night roller shades in living room
- Frameless dark tinted safety-glass windows
- GE 21 cu. ft. residential refrigerator with 1800W inverter
- GE Profile Series 30 in. residential convection microwave with built in air fryer
- GE Profile Series residential 24 in. range (3.7 cu. ft. with 9100 BTU high output burner)
- High gloss gel coated sidewalls
- LED fireplace with electric space heater
- MORryde® StepAbove™ entrance steps with strut assist
- Oversized multi-battery compartment (room for 4-6 batteries)
- Powered 50-amp cord reel
- Residential, solid-surface kitchen and bathroom countertops
- Residential walk-in shower with teak seat
- Solid hardwood cabinet doors, stiles, and fascia - handpainted with 90 poly sheen
- Residential "Do it all" sink
- Washer/dryer prep
- Pull out "Roll Top" dinette with two free standing chairs and two folding chairs
- JAYCOMMAND™ Smart RV System

**STANDARD INTERIOR EQUIPMENT**

- 12V charging station
- 5/8 in. tongue-and-groove joined plywood floor and 3/8 in. plywood roof decking
- Built-in laundry hamper in wardrobe (select models)
- Cedar-lined front wardrobe closet
- Ceiling fan (select models)
- CPAP prepped bedroom
- Flip-up countertop extension/bar top (select models)
- Flip-up hidden storage in bedroom chest of drawers (select models)
- Flip-up tabletop storage next to tri-fold sofa (select models)
- Handcrafted hardwood doors, stiles, drawers and trim - hand painted with 90 poly sheen
- Hidden hinges, magnet latches and soft close cabinet doors and drawers
- Integrated under-mount sink and lever faucet in main bathroom
- LED accent lighting above slideouts
- LED backlit custom framed mirror and medicine cabinet (most models)
- No in floor heat ducts throughout coach
- Pantry with adjustable shelves include 120V outlet (most models)
- Porcelain toilet with foot flush
- Residential "Do it all" sink with pull-out kitchen faucet, glass rinse, and vegetable rinse
- Residential dove tail jointed drawers throughout
- Residential NuVo H2O whole coach water treatment system with water softening and triple cartridge filters
- Residential quilted bedspread and pillows
- "Shoe garage" in hallway step (select models)
- Soft close, heavy-duty, 75 lb. full extension, steel ball-bearing drawer guides
- Solid hardwood slide fascia
- Stain protected fabric on all furniture
- Toe kick nightlights in bedroom, bathroom and kitchen
- Tri-fold hide-a-bed sofa with sleep surface (select models)
- Vinyl flooring (made in the USA) throughout including slide rooms

**CUSTOMER VALUE PACKAGE (MANDATORY)**

- 15,000 BTU "Whisper Quiet" A/C (bedroom)
- 15,000 BTU "Whisper Quiet" A/C with heat pump (main)
- On-demand tankless hot water heater
- 4K SMART LED HDTV with fully digital HDMI® output and two additional HDMI® cables
- Backup, main entrance door and side observation security camera prep (includes a power switch in the bedroom to use the optional monitor for security)
- Custom, black, machined aluminum rims
- Electric patio awning (multi-colored with remote control)
- Hidden hinges, magnet latches, and soft close cabinet doors
- JBL® home entertainment system with sound bar and wireless subwoofer
- Keyed-Alike™ lock system (single key for all doors/locks)
- MORryde Safe-T-Rail grab handle
- Residential king (72 in. x 80 in.) mattress with under-bed storage
- Rooftop and ground solar prep
- Wireless remote control system (includes Bluetooth® wireless interior controls) with dimmer switches
- (3) 40 lb. LP propane bottles with auto regulator
- Overlander 2 Solar Package: 30-amp controller, (1) 1800W inverter and (2) 200W solar panels
- Free standing ottoman w/ hinged top

**5 STAR HANDLING PACKAGE (MANDATORY)**

- 17.5 in. 16 ply "H" rated tires w/ SpartanLync TPMS
- Dexter® Axles with ABS and Tow Assist - includes Nev-R-Adjust® brakes and E-Z Lube® hubs
- MORryde® LRE-4000™ rubberized suspension
- MORryde® rubber pin box
- Wet bolt fasteners, bronze bushings and 4,000 lb. leaf springs

Optional Equipment

OPTIONAL EQUIPMENT INSTALLED ON THIS VEHICLE BY MANUFACTURER

Base price	125,493.00
GRAPHICS	n/c
USA STANDARDS	n/c
CUSTOMER VALUE PACKAGE	4,500.00
PINNACLE LUXURY PACKAGE	12,450.00
FIVE STAR HANDLING PACKAGE	5,993.00
ROOF VENT	n/c
21 CU. FT. RESIDENTIAL REFRIGERATOR WITH INVERTER	n/c
GENERATOR LP PREP	743.00
BACKUP, SIDE AND ENTRY DOOR OBSERVATION CAMERA PREP	n/c
TINTED SAFETY GLASS	n/c
WINDOWS	n/c
NO AWNING	n/c
STANDARD AXLE W/DRUM BRAKES	n/c
KING BED	n/c

UNIT TOTAL 149,179.00

DEALER INSTALLED OPTIONS

Manufacturer's Suggested Retail Price

\$149,179.00

TOTAL AMOUNT DOES NOT INCLUDE STATE AND LOCAL TAXES OR LICENSE FEES. THE PRICE SHOWN ABOVE MAY OR MAY NOT BE REPRESENTATIVE OF THE ACTUAL SELLING PRICE OF SIMILAR RECREATIONAL VEHICLES IN YOUR AREA.

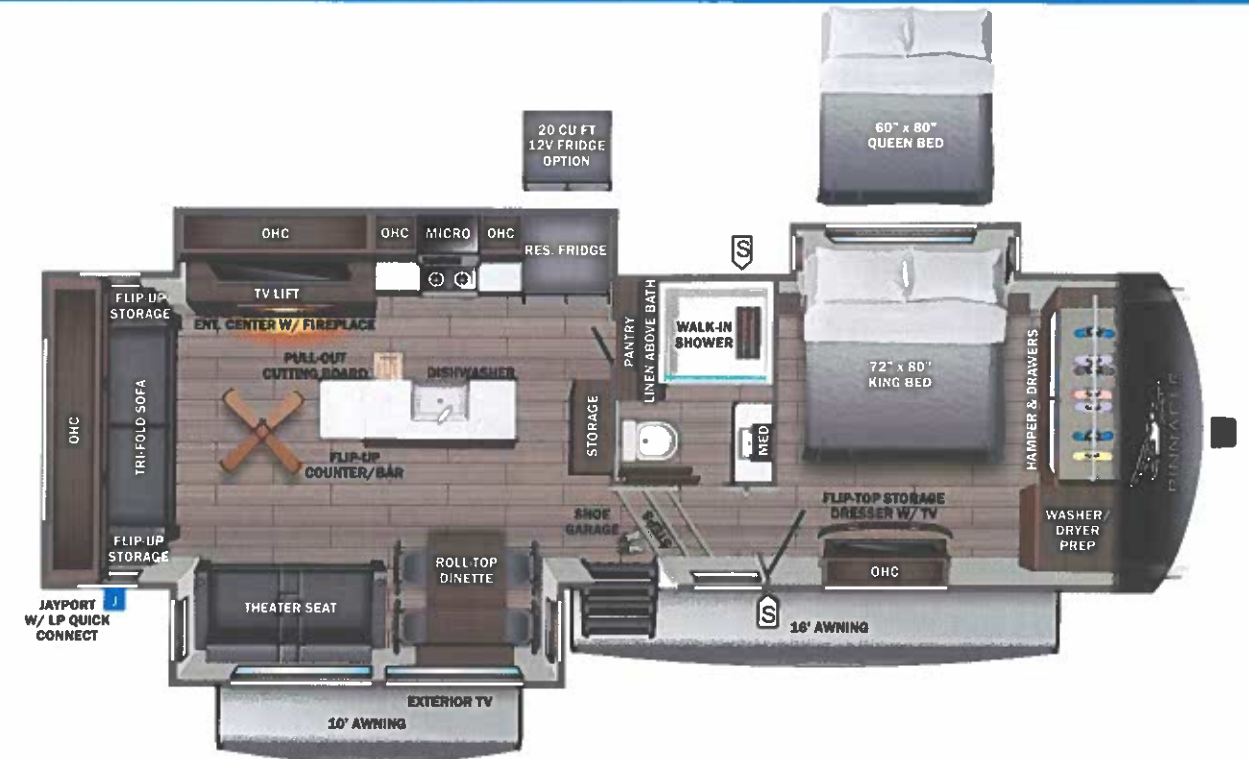

UVW  
13882 lbs



Sleeps



Length  
36' 0"

DIMENSIONS

Exterior height:.....159.50"

Exterior width:.....102.00"

WEIGHTS

GVWR:.....16600

GAWR (front):.....7000

GAWR (rear):.....7000

Approx. Gross Cargo Carrying Capacity(GCCC):.....2718

TIRES

Tire size (front):.....

Tire size (mid):.....

Tire size (rear):.....

Tire size (spare):.....

CAPACITIES

Fresh water tank (gals.):...75.00

Gray water tank (gals.):....87.00

Black water/toilet tank (gals):.....50.00

Propane (lbs.):.....120

Propane (gals.):.....28

Water heater (gals.):.....0.25

SEATING & SLEEPING

\*\*\*Some dimensions may be rounded and may vary from the actual dimensions\*\*\*

\*\*\*Weights may be estimated calculations and may vary from the actual weight

- refer to the vehicle weight labels for actual weights\*\*\*

Floorplans, features and specifications are subject to change without notice.

**2+3**  
YEAR | YEAR  
LIMITED STRUCTURAL  
WARRANTY