



# Jay Flight SLX



Serial #: 1UJBC0BS0T16R0054  
Model: 287BHS JAY FLIGHT SLX TT

Model Year: 2026 Dealer Name: KEYSTONE RV CENTER  
15799 S YOUNG RD  
GREENCASTLE, PA 17225  
USA

## Standard Equipment

THE FOLLOWING ITEMS ARE STANDARD ON THIS MODEL

- STANDARD EXTERIOR EQUIPMENT**
- 30-amp service
  - 8,000 BTU wall mount A/C (single axle models)
  - 13,500 BTU Roof A/C (double axle models)
  - Axles with electric, self-adjusting brakes and easy-lube hubs
  - Exterior cable TV hookup
  - Fully-integrated A-frame
  - Galvanized-steel, impact resistant wheel wells
  - Large exterior downspouts
  - LP quick connect (outside grill prep) [N/A on Sport Edition]
  - Magnum Truss™ Roof System
  - Nitrogen filled radial tires
  - PVC roofing membrane (limited lifetime warranty)
- CUSTOMER VALUE PACKAGE (MANDATORY)**
- 8 cu. ft. 12V refrigerator
  - AM/FM/Bluetooth® stereo
  - Backup camera prep
  - Bathroom skylight
  - Bathroom vent
  - Detachable power cord
  - Entry door with window and shade prep
  - Fitted bed sheet
  - G20 dark tinted privacy windows
  - Keyed-Alike™ entry and baggage doors
  - Large folding entry door grab handle
  - LED interior and exterior light
  - Marine grade exterior stereo speakers
  - Microwave oven
  - On-demand tankless water heater
  - Power awning with LED lights
  - Range hood
  - MoRryde Step Above® entry steps
  - Spare tire with cover
  - Stabilizer jacks
  - Tub/shower surround
  - Window shades

- STANDARD INTERIOR EQUIPMENT**
- 300 lb. rated single bunk beds
  - 600 lb. rated double bunk beds
  - Digital TV antenna
  - Heavy-duty, 75 lb., full-extension, steel ball-bearing drawer guides
  - High rise kitchen faucet
  - Marine-grade toilet with foot flush
  - Plywood bed platforms
  - Queen mattress
  - Residential-style hidden cabinet door hinges
  - Residential-style kitchen countertops
  - Shower curtain with curved shower track (select models)
  - Solid hardwood cabinet doors with screwed stile construction and hidden hinges
  - Vinyl flooring throughout

## Optional Equipment

OPTIONAL EQUIPMENT INSTALLED ON THIS VEHICLE BY MANUFACTURER

Base price	35,618.00
USA STANDARDS	n/c
CUSTOMER VALUE PACKAGE	5,250.00
OVERLANDER SOLAR PACKAGE	443.00
NO ELITE PACKAGE	n/c
15,000 BTU ROOF MOUNTED AC	300.00
NO 2ND AC	n/c
30 AMP SERVICE	n/c
BLACK SPOKE RIMS	n/c
JACK KNIFE SOFA	n/c

UNIT TOTAL 41,611.00

DEALER INSTALLED OPTIONS

**Manufacturer's Suggested Retail Price \$41,611.00**

TOTAL AMOUNT DOES NOT INCLUDE STATE AND LOCAL TAXES OR LICENSE FEES. THE PRICE SHOWN ABOVE MAY OR MAY NOT BE REPRESENTATIVE OF THE ACTUAL SELLING PRICE OF SIMILAR RECREATIONAL VEHICLES IN YOUR AREA.

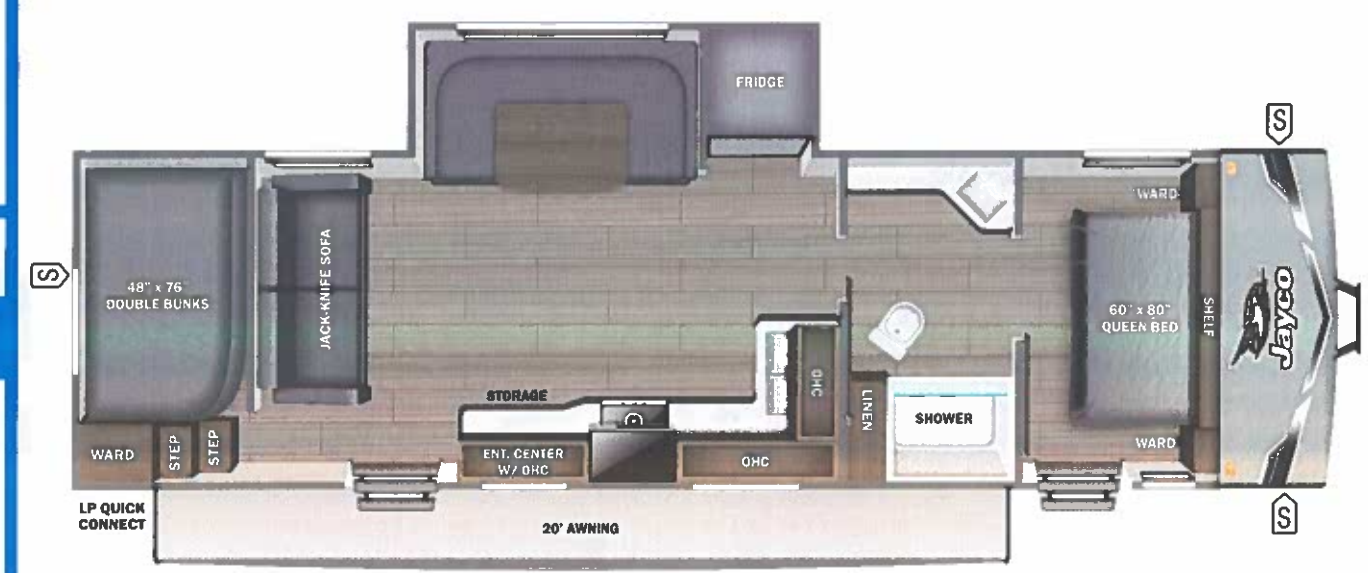

**UVW**  
6376 lbs

**Sleeps**  
6

**Length**  
34' 3.75"

DIMENSIONS		CAPACITIES	
Exterior height:	132.88"	Fresh water tank (gals.):	52.00
Exterior width:	96.00"	Gray water tank (gals.):	39.00
WEIGHTS		Black water/toilet tank (gals.):	39.00
GVWR:	7950	Propane (lbs.):	40
GAWR (front):	3500	Propane (gals.):	9
GAWR (rear):	3500	Water heater (gals.):	0.25
Approx. Gross Cargo Carrying Capacity (GCCC):	1574	SEATING & SLEEPING	
TIRES			
Tire size (front):	ST205/75R14D		
Tire size (mid):			
Tire size (rear):	ST205/75R14D		
Tire size (spare):	ST205/75R14D		

\*\*\*Some dimensions may be rounded and may vary from the actual dimensions\*\*\*  
\*\*\*Weights may be estimated calculations and may vary from the actual weight - refer to the vehicle weight labels for actual weights\*\*\*  
Floorplans, features and specifications are subject to change without notice.

