

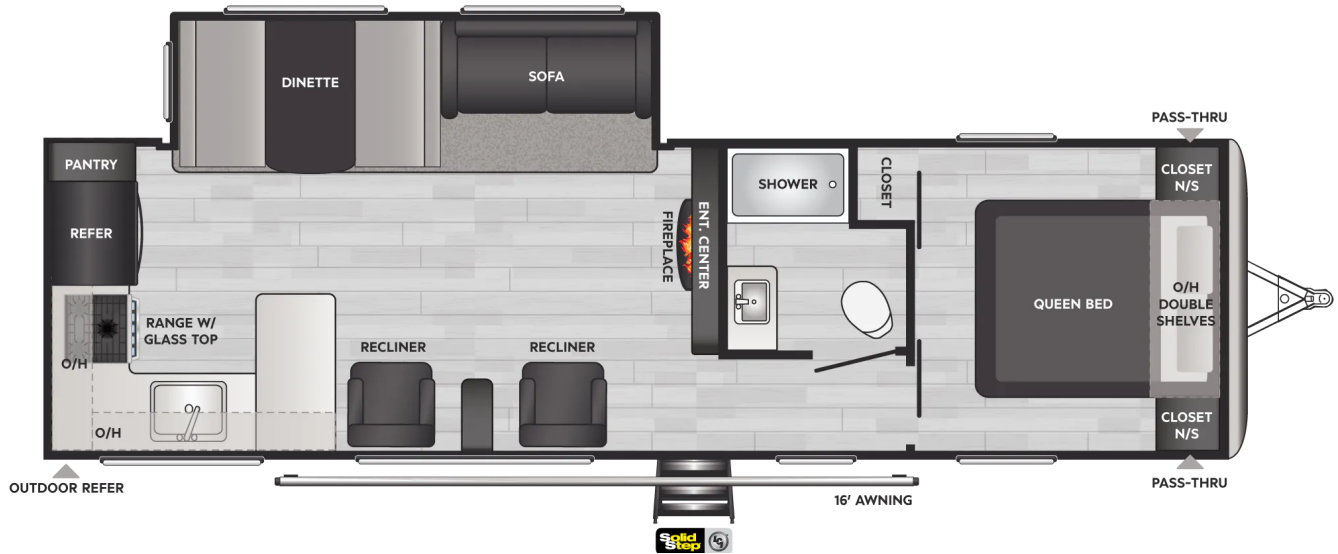

SPRINGDALE

Comfort Travel Trailers



293RK

Rear kitchen, huge countertop, amazing living area

EAST

MSRP:
\$37,800*

Base price. Does not include freight, title, tax, options or dealer fees.

SPECIFICATIONS

RV Type

Travel Trailer

MSRP

\$37,800

Shipping Weight

6,948 lb.

Carrying Capacity

1,852 lb.

Hitch

830 lb.

Length

33 ft 4 in

Height

10 ft 11 in

Tire-Size

ST225/75R15E

Fresh Water

52 gal

Gray Water

69 gal

Waste Water

30 gal

Sleeping Capacity

5

Number of Propane Tanks

2

LPG

40 lb.

Refrigerator Size

11 cu ft

STANDARDS & OPTIONS

EXTERIOR

- Ⓢ Floorplan specific i-beam frame w/ full width outriggers
- Ⓢ Power tongue jack
- Ⓢ Maximum 16" O.C. wood sidewall construction
- Ⓢ Smooth front metal
- Ⓢ Safety glass functional windows in slideouts
- Ⓢ Fully walkable roof w/ seamless one-piece TPO roof membrane
- Ⓢ Rack and pinion slide mechanism
- Ⓢ One-piece polypropylene, heated and enclosed underbelly
- Ⓢ Dexter® E-Z Lube® axles
- Ⓢ E-Rated tires
- Ⓢ Power stab jacks
- Ⓢ Friction hinge entry door
- Ⓢ LCI® SolidStep®
- Ⓢ Pass-through storage compartment
- Ⓢ Back-up camera/observation prep
- Ⓢ 50 AMP service w/wire and brace for 2nd A/C
- Ⓢ Exterior shower/water port
- Ⓢ Power awning w/ LED light strip
- Ⓢ Solar Prep

INTERIOR

- Ⓢ 2"x3" floor joists, 12" on center
- Ⓢ Pleated night shades
- Ⓢ Designer upholstered window valances
- Ⓢ 6'10" vaulted ceiling
- Ⓢ Electric fireplace w/ high and low output settings
- Ⓢ Laundry chute

KEYSTONE EXCLUSIVES

- Ⓢ 3-year limited structural warranty
- Ⓢ 1-year limited base warranty
- Ⓢ Color-coded unified wiring standard
- Ⓢ 4G LTE and Wi-Fi prep
- Ⓢ Tuf-Lok™ thermoplastic duct joiners
- Ⓢ In-floor heating ducts

- Tru-fit™ slide construction

KITCHEN FEATURES

- Pantry
- Pressed kitchen countertops
- Single basin undermount sink w/ stainless steel drying rack
- High-rise spring pull out kitchen faucet
- Booth dinette
- Do-More free-standing table

APPLIANCES & UTILITIES

- (2) 20 lb. LP tanks
- 13.5K BTU ducted A/C
- 15K BTU ducted A/C
- 2nd A/C (requires 50-AMP service)
- 30K BTU furnace
- 6 gal. gas/electric DSI water heater
- LED TV
- AM/FM/MP3/Bluetooth® Stereo
- 11 cu. ft. 12V Everchill refrigerator
- .9 cu. ft. microwave
- 3-burner gas stove and 17" oven w/ glass cover and low profile range hood
- LED lighting
- Central monitor panel

BEDROOM FEATURES

- 60" X 74" queen bed
- Bedside outlets
- Master bedroom TV hook-up
- Walk-in closet
- Double shelves w/ dual wardrobe

BATHROOM FEATURES

- Formica® bathroom countertop
- Shower w/ surround
- Durable foot-flush toilet
- Medicine cabinet w/ mirror

SAFETY

- Ⓢ Breakaway switch
- Ⓢ GFI receptacles
- Ⓢ Carbon monoxide detector
- Ⓢ Smoke detector
- Ⓢ Fire extinguisher

SOLARFLEX™

- Ⓢ SolarFlex™ 200