

Bison



TRAIL HAND





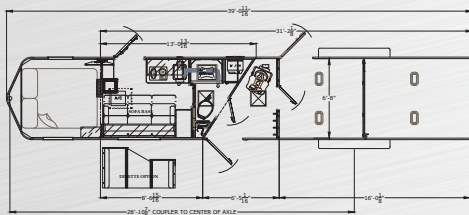

TH70816 (TRAIL HAND)

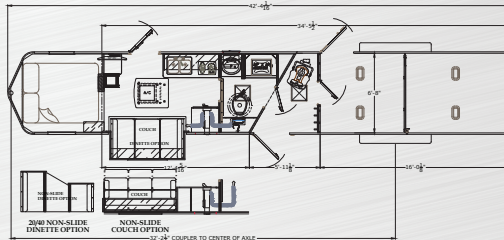

TH71116 (TRAIL HAND)

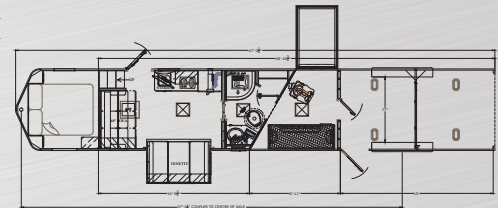

TH81515B.S (TRAIL HAND)

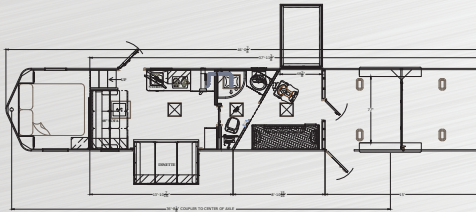

TH81315B.S (TRAIL HAND)

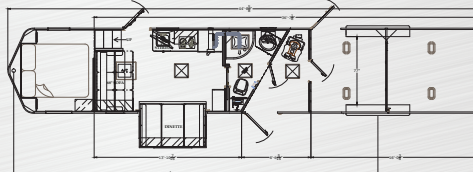

TH81516B.S (TRAIL HAND)



TH81715.S (TRAIL HAND)

## STANDARD FEATURES:

- 235/85R16 LRG Tires With Black Aluminum Wheels Upgrade
- 30 Amp Service W/ Detachable 30 Amp Power Chord
- 3-Way Switch For Horse Area
- 7000# Axles
- Bridle Hooks
- Cooktop, Drop In W/ Range Hood
- Exterior Water Spigot
- Exterior White
- Faucets - Residential
- Kitchen Sink - Stainless Steel
- Led Exterior Lights
- Led Lighting Throughout
- LP Tanks (2) W/ Dual Regulator
- Manual Jack - Single Speed
- Microwave
- Mini-Blinds With Valances
- One Battery, Grp 24 W/ Shut-Off
- Rear Load Light (1)
- Refrigerator 6 Cf (3 Cf On 6' & 8' Lq)
- Rubber Matting In Mid-Tack & Stock Area
- Saddle Tree In Mid- Tack
- Shirt Closet(s)
- Shower W/ Shower Curtain
- Solar Ready
- Spare Tire And Rim
- Speakers Int & Ext
- Step (At Entrance Door)
- Toilet - Plastic
- TV/Radio Antenna
- Water Heater Gas DSI (6 Gallon)

## 8W- ADDITIONAL STANDARDS

- 215/75R17.5 LRH Tires W/ Black Alum Wheels
- 2nd Batteries, Grp 24 W/ Shut-Off

- 40" TV Entertainment Center - Living Room (17' Lq)
- 8000# Axles
- Furnace 18,000 BTU
- Jack - Manual 2 Speed
- Kitchen Sink - Stainless Steel With Cover(s)
- Shower - Radius

## UPGRADE OPTIONS:

- 215/75R17.5 LRH Tires W/ Black Alum Wheels (Standard 8W)
- 2nd Batteries, Grp 24 W/ Shut-Off (Standard 8W)
- 4500W Generator With Fuel Tank
- 8 CF Refrigerator (Ilo 6 C.F.) Not Available On All Options
- 8000# Axles (Standard On 8W))
- A/C 13,500 Or 15,000 Btu, Ducted Lq Only
- Awning, Powered W/Led Light Strip
- Axle Lift 2"
- Brite Nose
- Bunk Privacy Curtain
- Cable Inlet
- Cook Top - Recessed
- Countertop Extension ( Not Available On All Floor Plans)
- Exterior BBQ Quick Disconnect
- Exterior Color Option
- Extruded Aluminum - Full Length
- Fantastic Fan In Bathroom (Ilo Std)
- Fireplace 34" (Available On 17 Model Only)

- Free-Standing Table
- Furnace, 18,000 BTU (Standard On 8W)
- Hat Rack
- Hay Rack Or Hay Pod With Lined & Insulated Ceiling
- Heat Tape On Tanks
- Jack - Hydraulic , Single Or Double
- Lined & Insulated Ceiling
- Load Light Pkg (4 Total)
- Mattress Queen W/ Bedding/Pillows
- Microwave - Convection
- Oven W/3 Burner Stove Top ( Not Available On All Models)
- Ramp - Rear Load
- Slide Out (Standard On Some Options)
- Solar -190W roof panel w/ control panel.
- Spray Port W/Quick Disconnect Hose
- Step @ Escape Door
- Stereo Bluetooth W/Interior & Exterior Speakers
- Theater Style Seating Ipo Sofa
- Toilet - Ceramic
- Tpms Tire Minder
- TV 32" Lcd W/ Locking Swing Arm
- TV Entertainment Center, 32" TV-Bedroom ( 17' Floorplan Only)
- Wtr Htr Gas/Ele Dsi - 6 Gl (Ilo Gas Dsi)

04/2025



## Bison Trailers, LLC

1002 N. Old St. Rd 15, Milford, IN 46542

Sales@Bisontrailer.com www.Bisontrailer.com

