

# LAKOTA

## INFINITY



## PREMIUM TRAILERS WITHOUT THE PREMIUM PRICE.

The Infinity Series features many of the premium amenities and options traditionally shown on high-end brands, while maintaining a more cost effective price-point.

Learn more at [LakotaTrailers.com/Infinity](http://LakotaTrailers.com/Infinity).



# IN8X18CE

Smoked Red Oak Wood  
Elegance Chocolate Furniture  
With Reptile Accent





## IN8X13SR

Rustic Maple Wood  
Elegance Chocolate Furniture  
With Valapraiso Stone Accent





# HORSE FLOOR PLANS

All specifications contained herein are based on the latest product information at the time of printing. Lakota reserves the right to make changes in colors, materials, equipment, and specifications at any time, without notice, and assumes no responsibility for any errors in this publication.

**IN8X9DR**

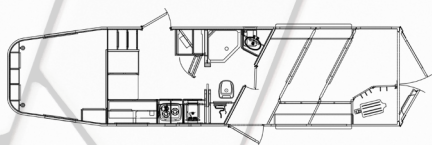

**IN8X9SR**



**IN8X9 (6' Slide)**

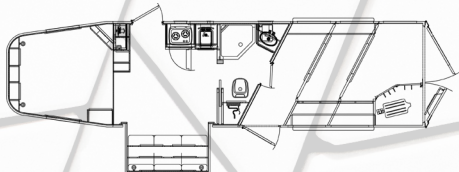

**IN8X11RK**

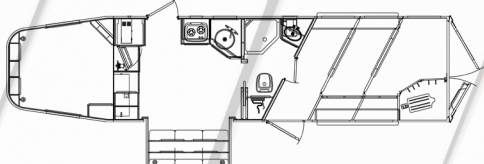

**IN8X11SR**

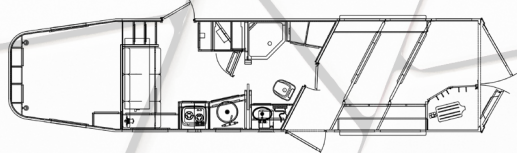

**IN8X13RK**

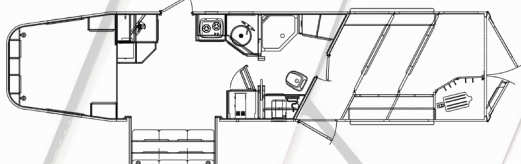

**IN8X13SR**

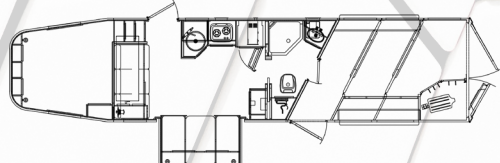

**IN8X14CE**

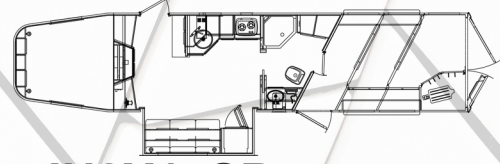

**IN8X14SR**

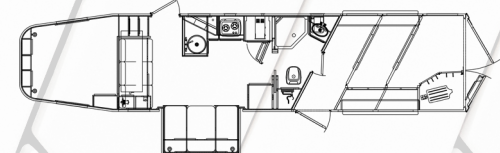

**IN8X15BB**

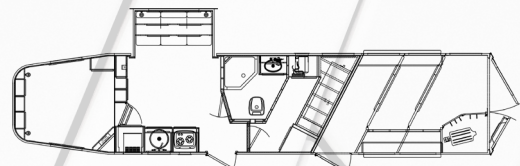

**IN8X15RKB**



**IN8X15SR**

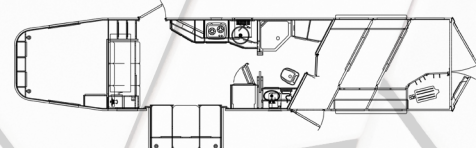

**IN8X15SRB (9' Slide)**

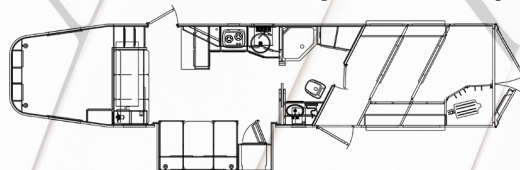

**IN8X16BB**

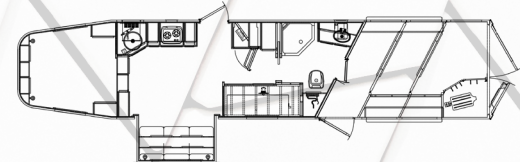

**IN8X17**

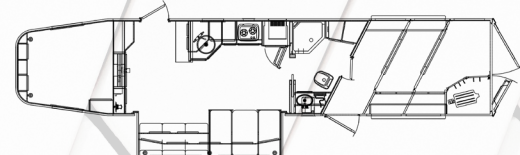

**IN8X17SRB**

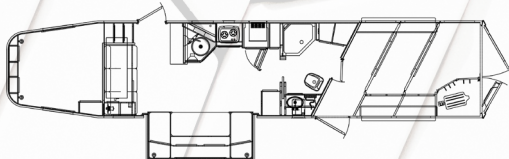

**IN8X18CE**

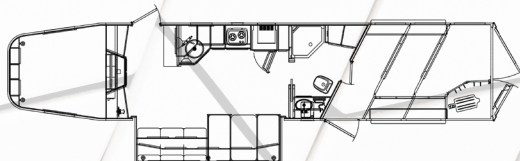

**IN8X18BBSRB**

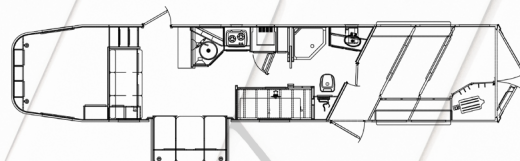





**360°**  
Tour



## HORSE STANDARDS

- 8' 2" Tall
- 8' Wide
- All Aluminum Framing
- Load Light
- Saddle Tree
- Gate Springs
- Rubber Stall Matting
- LED Lights in Horse Area
- 48" Wall Lining Kick Plate
- LED Exterior & Interior Lights
- Plant Made Drop Down Windows
- Swinging Blanket Bars
- Two-Way Pop Up Vents (One Per Horse)
- Ramp with Dutch Doors (Straight Load)
- One Piece Aluminum Roof with Drip Rail
- 60/40 Rear Doors (Slant Load) [Opt. 50/50]
- Insulated Aluminum Walls & Ceiling in Horse Area
- Aluminum Pads Stall Dividers with Slam Latches
- Single Leg Electric/Hydraulic Jack
- Power Awning with Weather Shield & LED Strip
- Exterior Package
- Side Mount Load Lights
- Lighted Grab Handle
- Step at Escape Door
- Ducted A/C
- Polished Nose

- Horse Area Package Includes: RS Escape Door, Bottom Stall Divider, & Saddle Boss IPO Standard

## HORSE OPTIONS

- Dual Electric/Hydraulic Jack
- Rear Ramp
- Dream Dinette
- Aluminum Wheels
- Drop Butt Windows
- Bridle Bar Additional
- Brush Tray Additional
- Extruded Slat Exterior
- Wire Blanket Bar
- Step at Rear Tack
- 3-Way Light Switch
- Additional Tail Lights
- Additional Clearance Lights
- Angled Flow Through Dividers
- Exterior Color (White, Matte Silver, Matte Black, & Matte Gray)
- Full Front Riser Wall Cover (Enclosed Front End)
- Goodyear Tires with Aluminum Rims

## LIVING QUARTER STANDARDS

- Microwave
- TV Antenna
- Wainscoting
- Soft Touch Walls and/or Ceiling
- Refrigerator
- Bath Lavatory
- Skylight in Bath
- Black Appliances
- Interior Package includes: Pass-Through Door, Dual Batteries, & Rain Sensor

- Tile Backsplash in Kitchen & Bathroom
- 4G Wi-Fi
- Entertainment Package Includes: TV, AM/FM Player, 2 Interior Speakers, & 2 Exterior Speakers
- Sconce LED Lighting
- Mattress & Bedspread
- Night Shades with Valances
- 2 Burner Range with Hood
- 6 Gallon Gas/Electric Water Heater
- Puck LED Lighting in Ceiling
- 3/4" Tongue & Groove Floor
- R7 Spun Fiberglass Insulation
- Jack Knife Sofa (VBP)
- Fresh Water Tank (VBP)
- Stainless Steel Black Kitchen Sink
- Solid Hardwood Doors & Cabinets
- Neo Shower with Glass Door
- 16,000 BTU Furnace, 13,500 A/C (15' & Up 34,000 Furnace, 15,000 A/C)
- 39 Gallon Each Grey & Black Water Tanks
- Wood Counter Top Edging with Buttons

## LIVING QUARTER OPTIONS

- Oven (VBP)
- Recessed Cooktop
- Rustic Maple or Smoked Red Oak Interior
- Automatic Satellite

## OTHER POPULAR OPTIONS

- Flush Floor Slideout (6', 9', or 12' depending on floorplan)

# INFINITY



# LIVESTOCK FLOOR PLANS

**INL8X13SR**

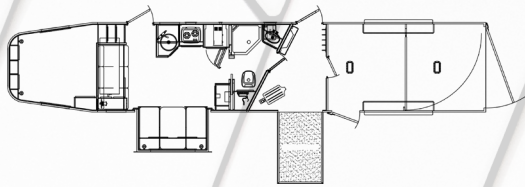

**INL8X15BB**

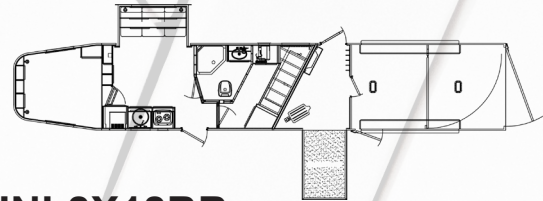

**INL8X14SR**

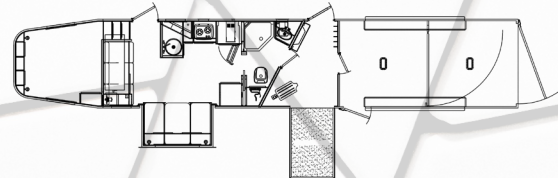

**INL8X18BB**

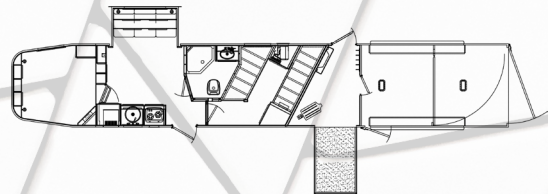

**INL8X15SRB**

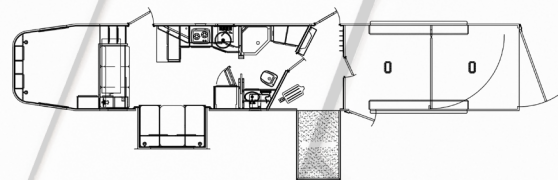

**INL8X18CE**

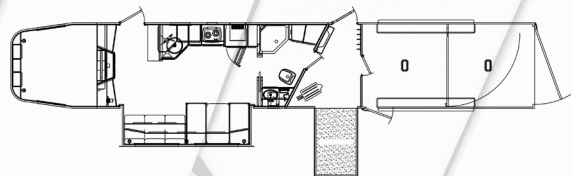

All specifications contained herein are based on the latest product information at the time of printing. Lakota reserves the right to make changes in colors, materials, equipment, and specifications at any time, without notice, and assumes no responsibility for any errors in this publication.

## EXTERIOR





## LIVESTOCK TRAILER STANDARDS

- 8'2" Tall
- 8' Wide
- All-Aluminum Framing
- Load Light Rear
- Mid Tack
- Saddle Tree
- LED Lights in Livestock Area
- LED Exterior and Interior Lights
- Extruded Slat in Livestock Area
- Rubber Mats on Floor
- Rubber Covered Inner Fender
- Single Leg Electric/Hydraulic Jack
- One Piece Rear Gate
- Zero Degree Axles
- Two-Way Pop Up Vents
- One Piece Aluminum Roof with Drip Rail
- Power Awning with Weather Shield & LED Strip
- Lighted Grab Handle
- Ducted A/C
- Polished Nose

## LIVESTOCK TRAILER OPTIONS

- Rear Ramp
- Aluminum Wheels
- 3rd Lower Air Gap
- Horse Dividers

- Bridle Bar Additional
- Brush Tray Additional
- Swing Out Saddle Rack for Mid Tack
- Dual Electric/Hydraulic Jack
- Wire Blanket Bar
- Interior Tie Rails
- Exterior Tie Rails
- Additional Clearance Lights
- Exterior Color (White, Matte Black, Matte Gray, Matte Silver)
- Full Front Riser Wall Cover (Enclosed Front End)
- 50/50 Rear Livestock Doors
- 1/2 Slide Rear Gate
- 50/50 Rear Horse Doors
- Plexiglass
- Rear Ramp (VBP)
- Dream Dinette
- Aluminum Kick Plate & Rubber on Walls
- Goodyear Tires with Aluminum Rims

## LIVING QUARTER STANDARDS

- Microwave
- TV Antenna
- Soft Touch Walls and/or Ceiling
- Refrigerator
- Bath Lavatory
- Skylight in Bath
- Glass Shower Door
- Sconce LED Lighting
- Mattress & Bedspread
- Water Tank Drain Valve
- Queen Mattress
- Night shades with Valances
- 2 Burner Range with Hood
- INTERIOR PACKAGE INCLUDES:  
Pass-Through Door, Dual Batteries, and Rain Sensor

- ENTERTAINMENT PACKAGE INCLUDES:  
TV, AM/FM Player, 2 Interior Speakers, and 2 Exterior Speakers
- Tile Backsplash in Kitchen & Bathroom
- 6 Gallon Gas/Electric Water Heater
- Puck LED Lighting in Ceiling
- 3/4" Tongue & Groove Floor
- Wood Grain Linoleum Floors
- R7 Spun Fiberglass Insulation
- Jack Knife Sofa (Varies by Product)
- Fresh Water Tank, Sizes Vary by Model
- Stainless Steel Black Kitchen Sink with Black Retractable Faucet
- Solid Hardwood Doors and Cabinet Faces
- Angle Shower with Glass Door
- Neo Shower with Glass Door
- 16K BTU Furnace, 13.5K BTU A/C (15' & Up 34K BTU Furnace, 15K BTU A/C)
- 39 Gallon Each Grey and Black Water Tanks
- 4G Wi-Fi
- Bone Shower

## LIVING QUARTER OPTIONS

- Oven (Varies by Print)
- Rustic Maple or Smoked Red Oak Interior
- Recessed Cook Top
- Automatic Satellite

## OTHER POPULAR OPTIONS

- Flush Floor Slideout
- Hay Rack
- Hay Pod
- LP Generator



For more information please  
contact your local dealer

[www.LakotaTrailers.com](http://www.LakotaTrailers.com)