

LAKOTA

BIGHORN



LUXURY. COMFORT. STYLE.

LakotaTrailers.com/Bighorn

BI8X17CE2S
St. Louis Alder Wood
Elegance Clay Furniture



B18X17

Smoked Hickory Wood
Stout Latte Furniture



BI8X19TBB

Handwiped Windswept Wood
Elegance Chocolate Furniture



FEATURES



HORSE AREA



Exterior Colors



Matte Gray



Matte Black



White



Matte Silver



360°
Tour



FLOOR PLANS

BI8X13SR

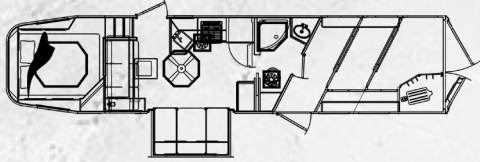

BI8X14SR

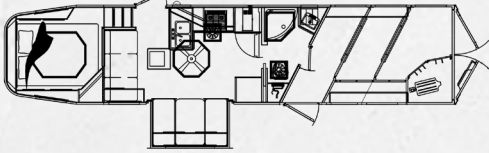

BI8X14CE



BI8X15DSRK

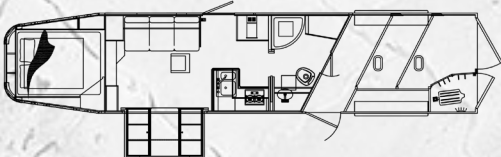

BI8X15FKP

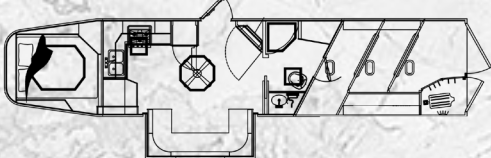

BI8X16SR

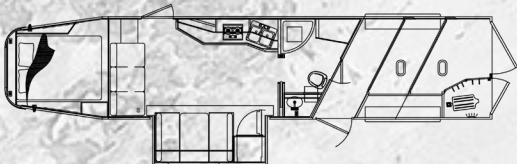

BI8X16SRB

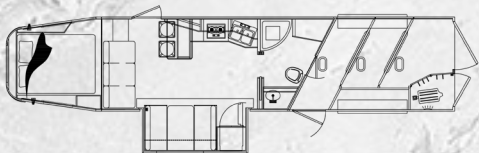

BI8X17FE

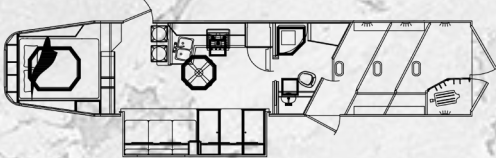

BI8X17SRB

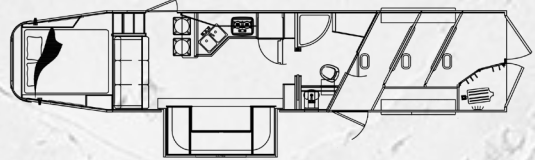

BI8X17BSRB

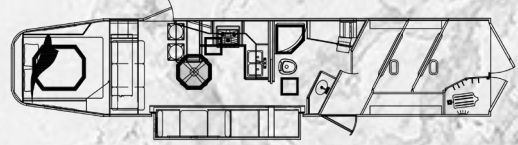

BI8X17CE2S



BI8X18CE



BI8X19SROK



BI8X19T2SI

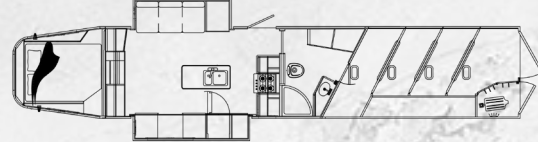

BI8X192S



BI8X23T2S

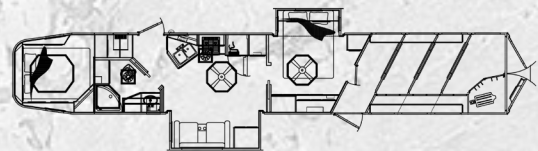

All specifications contained herein are based on the latest product information at the time of printing. Lakota reserves the right to make changes in colors, materials, equipment, and specifications at any time, without notice, and assumes no responsibility for any errors in this publication.

BIGHORN STANDARDS

INTERIOR

- Sink Covers
- 4G WI-FI
- LED Lighting
- Toe Kick Lights
- Crown Molding
- Sky Lights in Bath
- Day/Night Shades
- Hardwood Valances
- Dream Dinette (VBP)
- Sconce LED Lighting
- Complete Bedding Set
- 20K - 35K BTU Furnace
- Wood Edge Countertops
- Hidden Hinges on Cabinets
- Solid Wood Slide-Out Fascia
- Soft Touch Walls and Ceiling
- Solid Raised Panel Pocket Door w/ Mirror
- Stainless Steel Convection Microwave
- Towel Ring and Toilet Paper Holder
- Raised Panel Square Cabinet Doors
- 32x32 Radius Shower
- Insulated Floor in Living Quarters
- 15K BTU A/C (VBP)
- Smoked Hickory, Handwiped Windswept, or St. Louis Alder Hardwood Cabinets & Wainscoting
- 3 Burner Recessed Cook Top w/ Oven

- 2nd Tray Ceiling With Ceiling Fan
- 10 Gal Gas/Elec. Water Heater
- Satellite Radio
- Master Control Panel
- TV (x2 TV for 13'+ Models)
- Refrigerator with Raised Panel Door (Size Dependent on Model)

STRUCTURE

- 8'2" Tall
- Structural 4" I-Beam
- 1.5" x 2" Closed Tube Uprights in Wall Structure
- 4" Closed Tube Bracing in Nose Structure
- Full Length Extrusion Welded to Frame of Trailer

EXTERIOR

- Stainless Steel Nose Wrap
- Tapered Nose Configuration
- Marine Stereo
- Bauer Latch on Escape Door
- Step at Escape Door
- Side Load Lights
- Two Sets of LED Tail lights
- Plant Made Living Quarters Door with Retractable Screen Door
- Windows on Slide-Out End (Where Applicable)
- Power Awning with Weathershield + LED Light Strip
- Dual Electric/Hydraulic Jacks
- Aluminum Enclosed Battery Box
- Spare Tire and Wheel
- Dual 12v Deep Cycle Batteries
- Flush Wall Slide-Out (VBP)
- New Vixen Floor (No Wood)

- Frameless LQ Windows

HORSE AREA

- Pass Through Door to Horse Area
- Bottom Stall Divider on First Divider
- Escape Door with Drop Down Window and Face Guard
- 2 Brush Trays on Rear Tack Door
- Saddle Boss Saddle Tiers (1Per Horse)
- 30" x 26" Sliding Butt Windows
- Swinging Blanket Bars
- 3 Way Switch for Horse Area Lights in Bath
- Angled Flow Through Dividers

POPULAR BIGHORN OPTIONS

- Integrated Hay Pod
- Hay Rack
- Hay Pod with Platform
- Rear Ramp
- Rear Side Tack
- Outside Kitchen
- 10K Torsion Axles
- Reverse Load (VBP)
- Rear Side Load (VBP)
- Swing-Out Saddle Rack
- Variety of Onan Generators
- Automatic Satellite Systems
- Different Slide-Out Sizes (VBP)
- Fully Enclosed Gooseneck Cover
- Premier Package (44" x 104" Stalls)
- 8K Torsion Axles (Standard on Some Models)
- Drop Down Butt Windows
- Aluminum Wheels
- Matte Exterior Color (White, Black, Charcoal, Silver)



For more information please
contact your local dealer

www.LakotaTrailers.com