

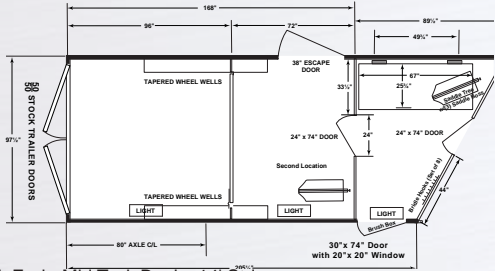

Merhow Longhorn 8' Wide Stock Combo's Living Quarters

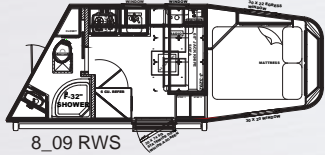

8w - Back End - Mid Tack Bunks 14' Std



8_09 RWS

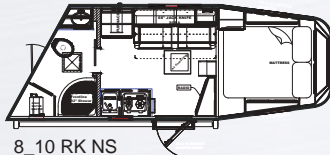

8_10 RK NS

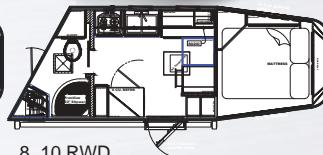

8_10 RWD

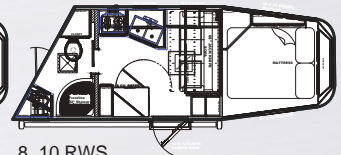

8_10 RWS

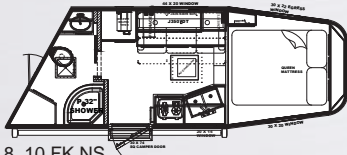

8_10 FK NS

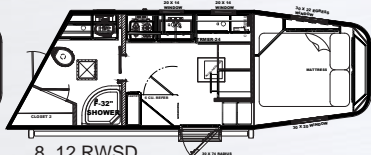

8_12 RWSD

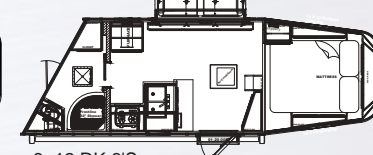

8_12 RK 6'S

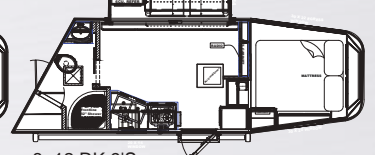

8_12 RK 9'S

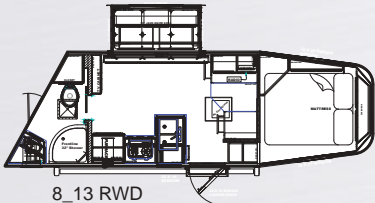

8_13 RWD

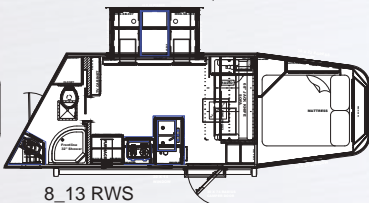

8_13 RWS

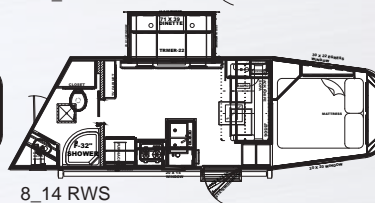

8_14 RWS

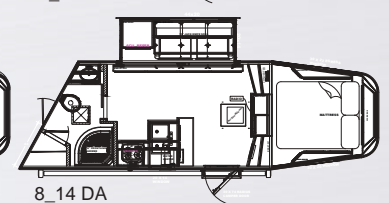

8_14 DA

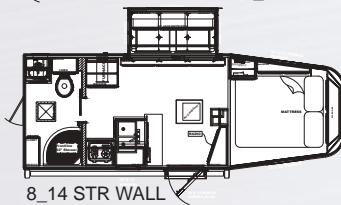

8_14 STR WALL

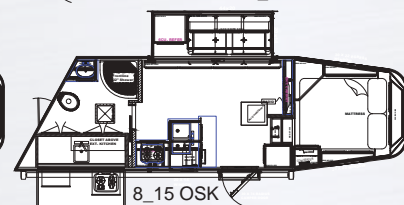

8_15 OSK

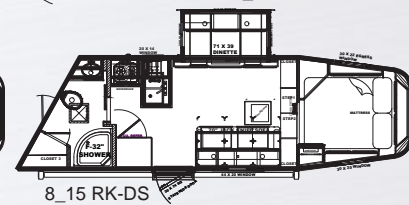

8_15 RK-DS

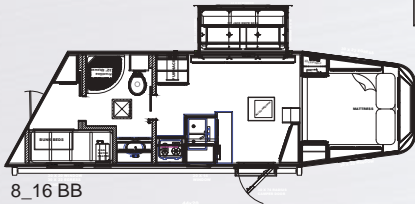

8_16 BB

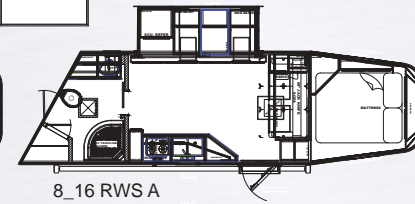

8_16 RWS A

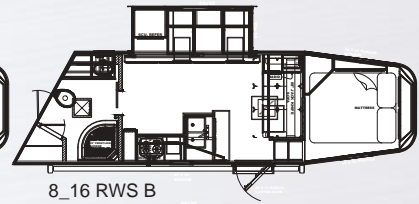

8_16 RWS B

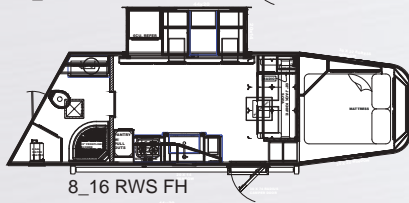

8_16 RWS FH

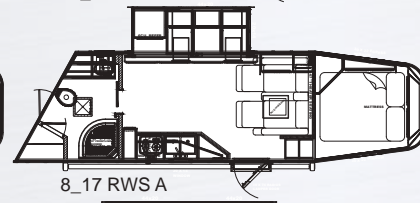

8_17 RWS A

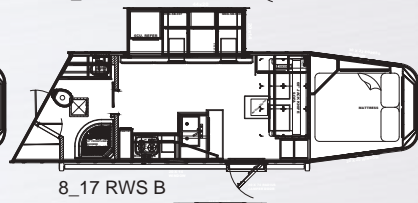

8_17 RWS B

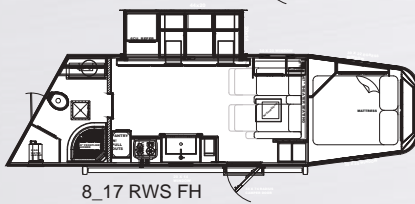

8_17 RWS FH

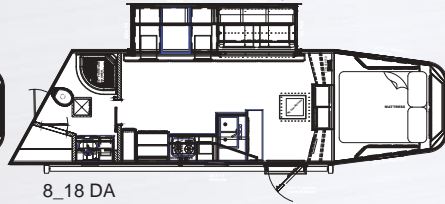

8_18 DA

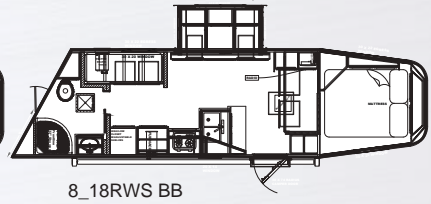

8_18RWS BB

TRAILER STANDARD FEATURES

- Aluminum sidewall posts, top rail, rear hoop, bottom rail.
- 50/50 Rear doors with cam bars and door hold-backs.
- (1) 12V Light in the mid-tack, with switch.
- Unit is estimated at 8' wide and 7'-6" tall.
- Cut gate in stock area. Set at 6' behind the mid-tack wall, unless otherwise stated in the special notes.
- (1) Aluminum brush box installed in mid-tack.
- 4" Cross members commonly on 12" centers.
- 12 volt lighting in all slide-outs. (models with slide-outs).
- Extruded aluminum floor below LQ and stock area.
- Mid-tack is insulated and lined with ply-felt.
- All slide-out models are equipped with flush-floor slides.
- One piece seamless aluminum roof.
- Tapered inside wheel wells, rubber lined.
- Models with 6' slide-out contain (2) end windows, (1) Picture window and a slide-out awning.
- White, .040 exterior aluminum skin. (Optional color upgrades)
- Mid-tack ceiling is line and insulated with white aluminum.
- Extruded aluminum sides in stock area. (Optional full slat)
- Interior tie tail on road side between air gaps.
- Models with 9' slide-out contain (1) end window, (1) Picture windows and a slide-out awning.
- 14' Stock area.
- Aluminum battery tray with plastic battery boxes.
- Divider wall between the mid-tack and the stock area.
- 0° Dexter EZ-Lube torsion axles.
- Models with 12' slide-out contain (2) end windows, (2) Picture windows and a slide-out awning.
- Pie shaped mid-tack with 3' short wall.
- Electric brakes on all wheels.
- Square corner entry door with window and without a screen into the mid-tack from the outside.
- Steel wheels standard with aluminum wheel options.
- 12V Exterior patio light and under goose-neck light.
- Spare steel wheel and tire standard.
- LED license plate light.
- Flip up camper step standard at camper door.
- Drive on trailer tire changing assistant.
- LED clearance lights (16) high and (8) low.
- 30" Wide escape door with cam bar.
- (6) Exterior horse ties (3) one each side that are evenly spaced.
- (1) Set of LED stop/tail lights.
- Walk-thru door between the LQ and the mid-tack.
- (1) 12V load light over rear doors.
- 7 Way bargeman cord for trailer lights.
- Walk-thru door between the mid-tack and the stock area.
- (1) Saddle rack and saddle rack location. (in mid-tack)
- Aluminum hook to hold trailer light cord to road side gusset area.
- Radius corner camper door with screen to the LQ from outside.
- (3) Saddle Boss and (3) blanket bars.
- Break-away emergency brakes switch.
- Camper door equipped with friction hinge ILO door hold back.
- Two air gaps, set up for plexi-glass in stock area.
- Gooseneck coupler set up for a 2 5/16" ball and safety chains.
- (1) set of 8 heavy duty bridal hooks. (Installed in mid-tack)
- Rubber mats in stock area and mid tack.
- 2 Year Living quarters warranty.
- Single hydraulic jack. (dual leg optional)
- Rubber bumpers under both rear doors.
- 8 Year structural warranty.
- Solid wood cabinets.
- Ball bearing drawer slides with bulldog on each drawer.
- Monitor panel for black, gray and fresh tank levels.
- Solid wood flat panel cabinet doors.

INTERIOR STANDARD FEATURES

- Single seating models standard with a sofa only and dual seating models standard with one sofa and one dinette.
- 3 cube or 6 cube refrigerator. (Based on floor plan.) with flat panel front.
- European style cabinet door hinges.
- 2 burner, recessed cook-top with glass top.
- Crown molding in the main LQ, Kitchen and front bunk.
- Sconce lights at the head side of the bed.
- 19,000 BTU, LP furnace.
- Laminate counter-tops on with wood edges.
- 12 Volt LED ceiling lights in the bunk, main LQ, and bathroom.
- 13,500 or 15,000 BTU air conditioner. (Based on floor plan.)
- Picture frame style window rings.
- 12V light on bottom side of the overhead cabinet @ seating area.
- Ducted air conditioning with digital thermostat.
- Decorative panel ceiling. Soft-touch optional.
- 12V light on bottom side of the kitchen overhead cabinet.
- 6 Gallon direct spark ignition water heater.
- Soft-touch walls with exception of slide-out.
- White fiberglass one piece shower.
- Single 12V deep cycle battery with battery cut-off switch.
- Soft-touch door panel on camper & walk-thru door to mid-tack.
- Opaque glass shower door.

- Dual 20# LP tanks with regulator and switch over valve.
- Fabric wrapped valance with solid wood ends.
- Sky-dome above the shower.
- Under belly fresh water tank. (38 gallons)
- Pleated, night only shades on all windows.
- Towel bar and toilet paper holder in bathroom.
- Gray water waste tank. (35 gallons)
- 4" Tall back-splash at the kitchen counter.
- Stainless steel sink for kitchen (Double bowl only)
- Black water waste tank. (35 gallons)
- Overhead cabinet above the seating area. (based on floor-plan).
- Silver colored acrylic kitchen sink (single bowl only)
- Smoke/CO/LP detectors.
- Carpeted front bunk and step tops.
- Stainless steel bathroom sink. (based on floor-plan).
- Fire extinguisher.
- Linoleum floor in main LQ and bathroom.
- 12V manual crank vent in bathroom.
- Outside water spigot.
- Solid wood refrigerator front. (6 Cube refrigerators & larger)
- 12V USB charger near kitchen area.
- Sewer hose and holder under the front bunk.
- All slide-out models standard with flush floor slide.
- AM/FM/CD/DVD radio with inside speakers.
- Low point drains for hot and cold water lines.
- (1) 120V exterior outlet near the camper door.
- TV antenna with booster.
- Water heater by-pass valve
- Satellite inlet connection for use with portable satellite.
- 120V outlet near kitchen and bathroom vanities.
- 12 Volt water pump with on demand system.
- TV Prep locations per floor plan. (include 120V & coax for TV antenna)
- 3 way switch for bunk reading lights.
- 30 amp, 120 volt power distribution center.
- 12V lighted grab handle beside camper door.
- Deluxe queen innerspring mattress in front bunk. (60"X74")
- Removable shoreline cord.
- Drawers below the seating area. (When possible)
- Built in microwave.
- 120V to 12V power converter.
- Drawers in the kitchen. (When possible)
- 3rd Party certification. (TR Arnold)

MODEL	OA LENGTH	AXLE SIZE & TIRES	SEATING
8009 RWS	39'-15/16"	Tandem 7K, 16" LRE	70" SOFA
8010 RWS	40'-15/16"	Tandem 7K, 16" LRE	68" SOFA
8010 RK-NS	40'-15/16"	Tandem 7K, 16" LRE	68" SOFA
8010 FK-NS	40'-15/16"	Tandem 7K, 16" LRE	70" SOFA
8012 RWSD	41'-15/16"	Tandem 7K, 16" LRE	68" SOFA & 1/2 DINETTE
8012 RK-6S	41'-15/16"	Tandem 7K, 16" LRE	70" SOFA
8012 RK-9S	41'-15/16"	Tandem 7K, 16" LRE	70" SOFA
8013 RWS	42'-15/16"	Tandem 7K, 16" LRE	66" SOFA & 71" DINETTE
8014 Straight Wall	43'-15/16"	Tandem 7K, 16" LRE	70" SOFA
8014 DA	43'-15/16"	Tandem 7K, 16" LRE	70" SOFA
8014 RWS	43'-15/16"	Tandem 7K, 16" LRE	66" SOFA & 71" DINETTE
8015 RK-DS	44'-15/16"	Tandem 7K, 16" LRE	70" SOFA & 71" DINETTE
8015 OSK	44'-15/16"	Tandem 7K, 16" LRG	70" SOFA
8016 RWS - Angled	45'-15/16"	Tandem 8K, 16" LRG	66" SOFA & 71" DINETTE
8016 RWS - Bar	45'-15/16"	Tandem 8K, 16" LRG	66" SOFA & 71" DINETTE
8016 BB	45'-15/16"	Tandem 8K, 16" LRG	70" SOFA
8017 RWTS Angled	46'-15/16"	Tandem 8K, 16" LRG	64" THEATER SEATING & 71" SOFA
8017 RWTS Bar	46'-15/16"	Tandem 8K, 16" LRG	64" THEATER SEATING & 71" SOFA
8018 DA	47'-15/16"	Tandem 8K, 16" LRG	64" SOFA & 71" DINETTE
8018 RWS-BB	47'-15/16"	Tandem 8K, 16" LRG	66" SOFA & 71" DINETTE
8016 RWS-Angled Farmhouse	45'-15/16"	Tandem 8K, 16" LRG	66" SOFA & 71" DINETTE
8017 RWTS-Angled Farmhouse	46'-15/16"	Tandem 8K, 16" LRG	64" THEATER SEATING & 71" SOFA

Although we do our best to ensure all standards are accurate, it is possible that there may be errors or standards may be altered due to how a specific trailer is quoted. Merhow does accept responsibility for errors or alterations due to a specific unit.



Office - 269.483.0010
Fax - 269.483.0030
www.merhow.com

REV 10/14/2024

DEALER