

#9313



Jay Flight SLX



Serial #: 1UJBC0BT3T16J0254
Model: 295TBS JAY FLIGHT SLX TT

Model Year: 2026 Dealer Name: JIM'S TRAILER SALES, INC
11920 AVON BELDEN ROAD
GRAFTON, OH 44044
USA

Manufacturer's Suggested Retail Price \$46,704.00

TOTAL AMOUNT DOES NOT INCLUDE STATE AND LOCAL TAXES OR LICENSE FEES. THE PRICE SHOWN ABOVE MAY OR MAY NOT BE REPRESENTATIVE OF THE ACTUAL SELLING PRICE OF SIMILAR RECREATIONAL VEHICLES IN YOUR AREA.

Standard Equipment

THE FOLLOWING ITEMS ARE STANDARD ON THIS MODEL

- STANDARD EXTERIOR EQUIPMENT
- 30-amp service
 - 8K BTU wall mount A/C (single axle models)
 - 13.5K BTU Roof A/C (double axle models)
 - Axles with electric, self-adjusting brakes and easy-lube hubs
 - Exterior cable TV hookup
 - Fully-integrated A-frame
 - Galvanized-steel, impact resistant wheel wells
 - Large exterior downspouts
 - LP quick connect (outside grill prep) [N/A on Sport Edition]
 - Magnum Truss™ Roof System
 - Nitrogen filled radial tires
 - PVC roofing membrane (limited lifetime warranty)

- CUSTOMER VALUE PACKAGE
- 8 cu. ft. 12V refrigerator
 - AM/FM/Bluetooth® stereo (N/A on single axles)
 - Backup camera prep
 - Bathroom skylight
 - Bathroom vent
 - Detachable power cord
 - Entry door with window and shade prep
 - Fitted bed sheet
 - G20 dark tinted privacy windows
 - Keyed-Alike™ entry and baggage doors
 - Large folding entry door grab handle
 - LED interior and exterior light
 - Microwave oven
 - On-demand tankless water heater
 - Power awning with LED lights
 - Range hood
 - MORryde Step Above® entry steps
 - Spare tire with cover
 - Stabilizer jacks
 - Tub/shower surround
 - Window shades

- STANDARD INTERIOR EQUIPMENT
- 300 lb. rated single bunk beds
 - 600 lb. rated double bunk beds
 - Digital TV antenna
 - Heavy-duty, 75 lb., full-extension, steel ball-bearing drawer guides
 - High rise kitchen faucet
 - Marine-grade toilet with foot flush
 - Plywood bed platforms
 - Queen mattress
 - Residential-style hidden cabinet door hinges
 - Residential-style kitchen countertops
 - Shower curtain with curved shower track (select models)
 - Solid hardwood cabinet doors with screwed stile construction and hidden hinges
 - Vinyl flooring throughout

Optional Equipment

OPTIONAL EQUIPMENT INSTALLED ON THIS VEHICLE BY MANUFACTURER

Base price	39,368.00
USA STANDARDS	n/c
CUSTOMER VALUE PACKAGE	5,250.00
NO ELITE PACKAGE	n/c
15,000 BTU ROOF MOUNTED AC	300.00
NO 2ND AC	n/c
NO 3RD AC	n/c
30 AMP SERVICE	n/c
BLACK SPOKE RIMS	n/c
OUTSIDE GRIDDLE	443.00
THEATER SEATING SOFA	1,343.00

UNIT TOTAL 46,704.00

DEALER INSTALLED OPTIONS

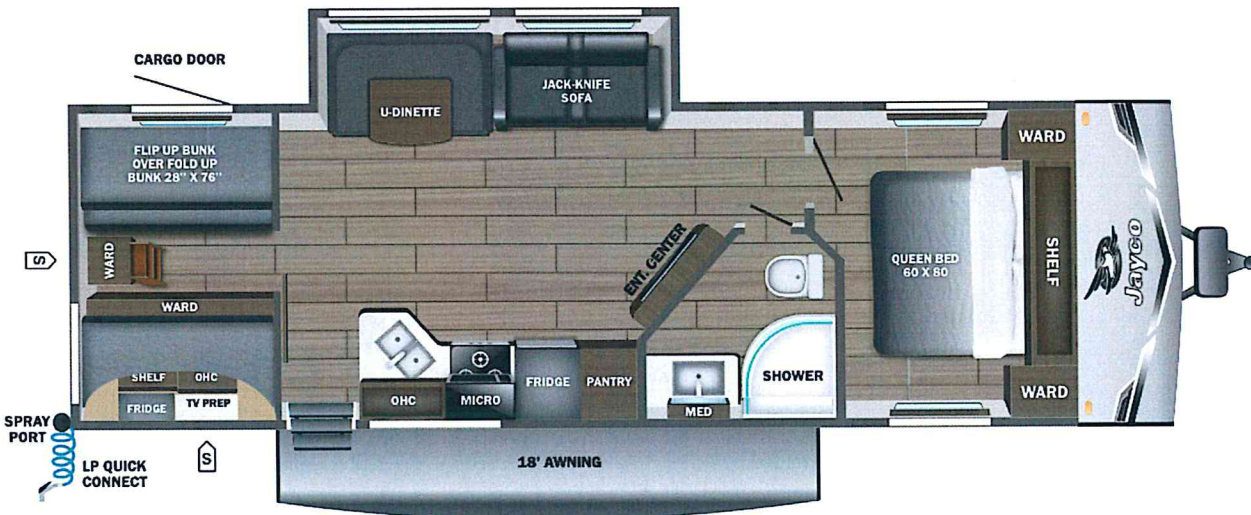

UVW 7317 lbs **Sleeps** **Length** 36' 9.75"

DIMENSIONS

Exterior height:.....132.13"
Exterior width:.....96.00"

WEIGHTS

GVWR:.....9200
GAWR (front):.....4400
GAWR (rear):.....4400
Approx. Gross Cargo Carrying Capacity (GCCC):.....1883

TIRES

Tire size (front):.....ST225/75R15E
Tire size (mid):.....
Tire size (rear):.....ST225/75R15E
Tire size (spare):.....ST225/75R15E

CAPACITIES

Fresh water tank (gals.):...52.00
Gray water tank (gals.):....39.00
Black water/toilet tank (gals.):.....39.00
Propane (lbs.):.....40
Propane (gals.):.....9
Water heater (gals.):.....0.25

SEATING & SLEEPING

Some dimensions may be rounded and may vary from the actual dimensions
Weights may be estimated calculations and may vary from the actual weight - refer to the vehicle weight labels for actual weights
Floorplans, features and specifications are subject to change without notice.

