

#9295



Alante



Serial #: 1UJMJABPXT1AS4080  
Model: 29S ALANTE MHA  
VIN#: 1F65F5DN4S0A03867  
Model Year: 2026 Dealer Name: JIM'S TRAILER SALES, INC  
11920 AVON BELDEN ROAD  
GRAFTON, OH 44044  
USA

Manufacturer's Suggested Retail Price \$207,520.00

TOTAL AMOUNT DOES NOT INCLUDE STATE AND LOCAL TAXES OR LICENSE FEES. THE PRICE SHOWN ABOVE MAY OR MAY NOT BE REPRESENTATIVE OF THE ACTUAL SELLING PRICE OF SIMILAR RECREATIONAL VEHICLES IN YOUR AREA.

Standard Equipment

Optional Equipment

THE FOLLOWING ITEMS ARE STANDARD ON THIS MODEL

OPTIONAL EQUIPMENT INSTALLED ON THIS VEHICLE BY MANUFACTURER

- STANDARD EXTERIOR EQUIPMENT**
- Ford® F53 chassis
  - GVWR- 18,000 lb.
  - GCWR- 23,000 lb.
  - 7.3L V-8 335 HP engine with 468 ft.-lb. torque
  - 6-speed automatic TorqShift® transmission with overdrive and tow haul mode
  - 210-amp alternator
  - Catalytic converter theft deterrent
  - G-rated highway tires-245/70R19.5
  - Front and rear disc, 4-wheel anti-lock brakes
  - 5,000 lb. rear hitch receiver with dual connector and 7-pin plug
  - 12V chassis battery
  - 80 gal. fuel tank
  - 120 in. panoramic windshield
  - StrongholdVBL™ roof, floor and sidewalls
  - Bead-foam insulation (R-24 max roof, R-9 max floor, R-8 max walls)
  - One-piece, seamless, fiberglass front cap
  - Fiberglass exterior walls with vinyl graphics
  - Automatic hydraulic leveling jacks
  - Frameless windows
  - Entrance door with industry's largest travel-view window
  - Electric-powered entrance steps
  - Lockable, pass-through storage compartments with metal slam latches
  - LED headlights
  - Third brake light
  - Roof ladder
  - Prep for satellite dish
  - Cable TV hookup with RG-6 coax and video selector switch
  - Winegard 2.0 Wi-fi/4G antenna
  - 4,000W generator
  - 200W solar panel with dual controller and second house battery
  - (2) 12V house batteries
  - Transfer switch with reverse polarity protection
  - 30-amp electrical service
  - Detachable power cord
  - 16.5 gal. propane tank (56 lb.)
  - LP quick-connect hookup
  - Heated holding tanks (12V pads)
  - Exterior utility center
  - Winterization drain system
  - Black tank flush
  - Outside shower
  - 12V demand water pump
  - Water filtration system
- CUSTOMER VALUE PACKAGE**
- JRide®: Computer-balanced driveshaft, Bilstein® steering stabilizer, jounce bumpers, heavy-duty front and rear stabilizer bars, SACHS shocks
  - One-piece, seamless, crowned fiberglass roof
  - Exterior entertainment center with JBL® outside speakers and LED HD Smart TV mounted on swivel bracket
  - Electric patio awning with LED lights
  - Slideout awning(s)
  - 1,200W inverter
  - Sony® infotainment center with Apple CarPlay® and Android Auto™
  - Backup and side-view cameras
  - Removable driver/passenger cockpit table
  - LED HD Smart TV in living area
  - Blackout night roller shades

- STANDARD INTERIOR EQUIPMENT**
- Swivel driver and passenger seats
  - 6-way power driver seat
  - Soft-touch, vinyl-wrapped automotive dash
  - Tilt steering wheel
  - Cruise control
  - Hill start assist
  - Electronic stability control
  - Traction control
  - Auxiliary start
  - Power front privacy shade with manual side privacy shades
  - 84 in. interior ceiling height
  - High-intensity recessed LED ceiling lights
  - LED-lit fascia
  - Hardwood cabinet doors and drawer fronts
  - Ball-bearing drawer guides
  - Jayco-exclusive, easy-operation legless dinette table
  - 2-point lap safety belts in all designated seating locations
  - Car seat tethers (select floorplans)
  - JBL® audio system
  - Dual 13,500 A/C units with power management system
  - 30,000 BTU auto-ignition ducted furnace
  - 6 gal. gas/electric DSI auto-ignition water heater
  - 10 cu. ft. 12V refrigerator
  - All-in-one cooktop and oven
  - Residential-size microwave
  - Large stainless steel kitchen sink with cover
  - LED-lit pressed countertops
  - Flip-up countertop extension (select models)
  - Decorative kitchen backsplash
  - Pop-up charging station in kitchen with 120V outlets and USB ports
  - Walk-around, queen-size bed with bedspread and nightstands (king size in 27A)
  - USB port and wireless charging in nightstands
  - Under-bed storage (select models)
  - Large wardrobes
  - Bunks with industry-exclusive 300 lb. capacity each (29F)
  - Shower with decorative surround, glass door, skylight and light
  - Stainless steel bathroom sink
  - Porcelain toilet with foot flush
  - Powered roof vent in bathroom with wall switch
  - Smoke alarm
  - Carbon monoxide detector
  - Fire extinguisher

Base price	192,968.00
FARMHOUSE DECOR	593.00
USA STANDARDS	n/c
CUSTOMER VALUE PACKAGE	9,923.00
NO BEDROOM TV	n/c
STANDARD HOUSE BATTERY	n/c
THEATER SEATING SOFA	743.00
FRONT OVERHEAD BUNK	3,293.00

UNIT TOTAL 207,520.00

DEALER INSTALLED OPTIONS

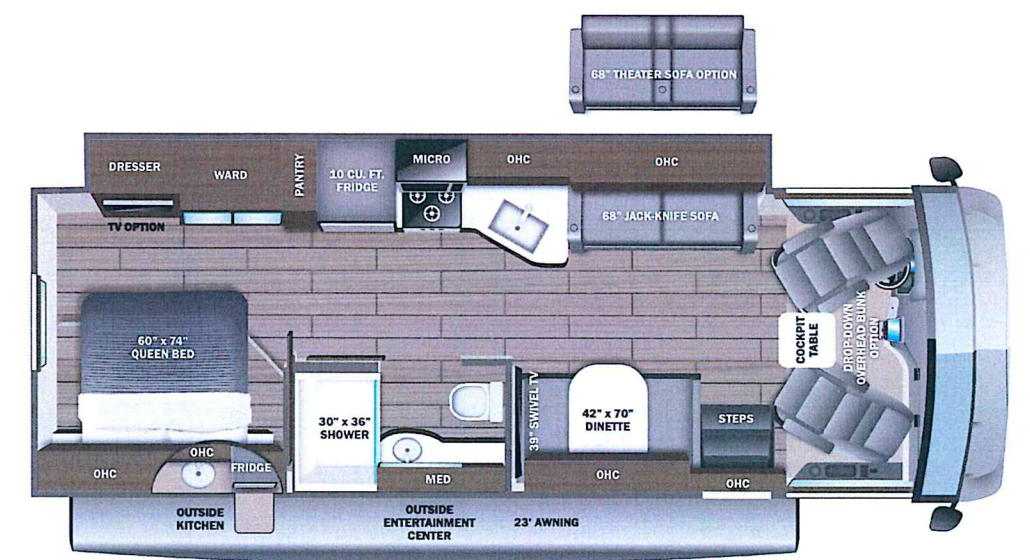

DIMENSIONS

Exterior height:.....149.00"  
Exterior width:.....101.00"

CAPACITIES

Fresh water tank (gals.):...72.00  
Gray water tank (gals.):....49.00  
Black water/toilet tank (gals.):.....50.00  
Propane (lbs.):.....56  
Propane (gals.):.....13  
Water heater (gals.):.....6.00

TIRES

Tire size (front):.....245/70R19.5G  
Tire size (mid):.....  
Tire size (rear):.....245/70R19.5G

\*\*\*Some dimensions may be rounded and may vary from the actual dimensions\*\*\*  
\*\*\*Weights may be estimated calculations and may vary from the actual weight  
- refer to the vehicle weight labels for actual weights\*\*\*  
Floorplans, features and specifications are subject to change without notice.

