



Jay Feather



Serial #: 1UJBB0BL9T1J10263  
Model: 21MML JAY FEATHER TT

Model Year: 2026 Dealer Name: JIM'S TRAILER SALES, INC  
11920 AVON BELDEN ROAD  
GRAFTON, OH 44044  
USA

Standard Equipment

Optional Equipment

THE FOLLOWING ITEMS ARE STANDARD ON THIS MODEL

OPTIONAL EQUIPMENT INSTALLED ON THIS VEHICLE  
BY MANUFACTURER

STANDARD EXTERIOR EQUIPMENT

- 1.5 in. fresh water drain valve
- 2 in. Stronghold VBL™ floor with 2 lb. density foam
- Aerodynamic, rounded front profile with aluminum framing
- American-made Norco® Z-frame with integrated A-frame
- Battery quick-disconnect
- Dark-tinted safety-glass windows
- Exterior TV 120V receptacle and cable hook-ups
- Front diamond plating
- Galvanized steel and impact-resistant wheel wells
- Magnum Truss™ roof system
- Outdoor camp kitchen with galvanized steel bases (select models)
- PVC roofing membrane (limited lifetime warranty)
- Swing-out entry door assist handle

CUSTOMER VALUE PACKAGE

- Radial tires with self-adjusting electric brakes
- 13.5K BTU roof-mounted Quiet Series A/C
- Vacuum bonded sidewalls with interior & exterior Azdel®
- 20 lb. LP gas bottles with auto-regulator, ABS cover, & fill gauge
- 55 gal. fresh water tank
- Automotive-style aluminum rims
- Black tank flush
- Detachable power cord
- Inverter pre-wire outlets
- Max-length power awning with LED light
- On-demand 60K BTU water heater
- Power tongue jack
- Rear 2 in. receiver prep
- Residential cabinetry with large doors and drawers
- Rock Solid Stabilizer System (N/A with Premier Pkg)
- Rear back-up camera prep
- Under-mount spare tire
- Hidden cabinet hinges
- Roller shades with radiant barrier backer
- Electric fireplace (N/A 23RK, 21MBH, 21MML, 23MBD, 25BH)
- Slide topper prepped

STANDARD INTERIOR EQUIPMENT

- 4 in. high-density dinette cushions with vinyl backing
- 4 in. soft-touch bunk mats (select models)
- 60 x 80 in. residential queen beds (60 x 76 in. in Murphy bed models)
- 75 lb. full extension drawer guides
- Decorative kitchen backsplash
- Bathroom skylight
- Directional and closeable A/C vents
- Gas-strutted under bed storage (most models)
- Handcrafted, hardwood door/drawer fronts
- High output auto-ignition LP gas furnace
- LED lighting throughout
- Plywood dinette, bed, bunk and shower/tub bases
- Powered roof vent in bathroom
- Seamless countertops throughout
- Residential vinyl flooring throughout
- Screwed and glued cabinet stiles
- USB charging ports (multiple locations throughout)
- Interior speakers

JAY SPORT PACKAGE

- 11 cu. ft. 12V fridge
- App monitored TPMS (compatible with most Apple Car Play & Android Auto)
- Climate Shield (zero to 100 degree tested weather insulation package)
- Front slam-latch baggage doors
- Invision kitchen appliance package
- Solid fold-down step with aluminum tread on main entry door step
- LED smart TV
- Modern graphics package
- Porcelain foot-flush toilet
- Overlander 1 solar package: (1) 200W solar panel and 30-amp digital controller
- Stainless steel double basin kitchen sink
- Keyed-Alike™ lock system
- Rear exterior ladder
- Dark tinted privacy windows

Base price	41,978.00
USA STANDARDS	n/c
CUSTOMER VALUE PACKAGE	6,000.00
JAY SPORT PACKAGE	3,750.00
NO PREMIER PACKAGE	n/c
OVERLANDER I SOLAR PACKAGE	n/c
NO JAYCOMMAND CONTROL SYSTEM	n/c
13,500 BTU AC	n/c
NO DUAL MAXXAIR VENT FAN	n/c
20# LP GAS BOTTLES	n/c
NO FRONT CAP	n/c
TAMARACK TIRES	n/c
2" REAR RECEIVER	188.00
FURNITURE CUP HOLDER	
TABLES-1 PAIR	113.00

UNIT TOTAL 52,029.00

DEALER INSTALLED OPTIONS

Manufacturer's Suggested Retail Price

\$52,029.00

TOTAL AMOUNT DOES NOT INCLUDE STATE AND LOCAL TAXES OR LICENSE FEES. THE PRICE SHOWN ABOVE MAY OR MAY NOT BE REPRESENTATIVE OF THE ACTUAL SELLING PRICE OF SIMILAR RECREATIONAL VEHICLES IN YOUR AREA.

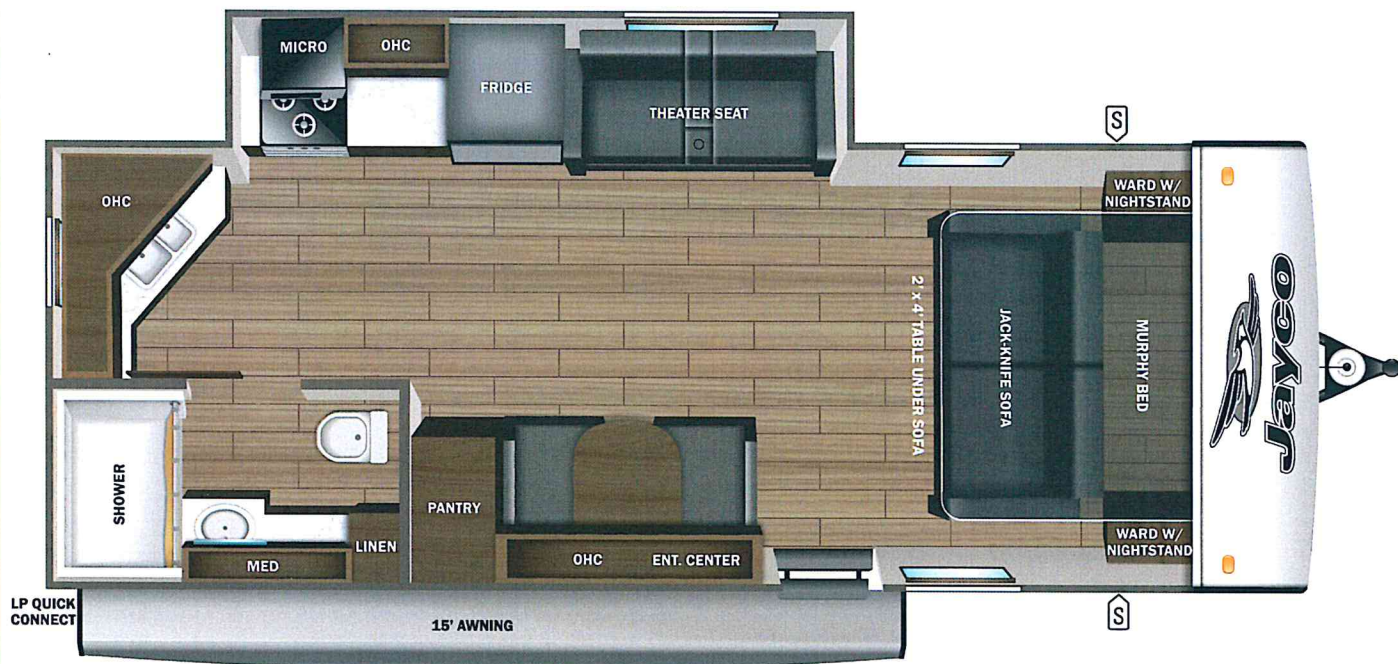

UVW  
5192 lbs



Sleeps



Length  
25' 5.06"

DIMENSIONS

Exterior height:.....127.25"  
Exterior width:.....95.50"

WEIGHTS

GVWR:.....6500  
GAWR (front):.....3500  
GAWR (rear):.....3500  
Approx. Gross Cargo Carrying Capacity (GCCC):.....1308

TIRES

Tire size (front):.....ST205/75R14D  
Tire size (mid):.....  
Tire size (rear):.....ST205/75R14D  
Tire size (spare):.....ST205/75R14D

CAPACITIES

Fresh water tank (gals.):...55.00  
Gray water tank (gals.):...30.50  
Black water/toilet tank (gals.):.....30.50  
Propane (lbs.):.....40  
Propane (gals.):.....9  
Water heater (gals.):.....0.25

SEATING & SLEEPING

\*\*\*Some dimensions may be rounded and may vary from the actual dimensions\*\*\*  
\*\*\*Weights may be estimated calculations and may vary from the actual weight - refer to the vehicle weight labels for actual weights\*\*\*  
Floorplans, features and specifications are subject to change without notice.

