

#8961



Jay Flight



Serial #: 1UJBCSBP2S1780098
 Model: 265TH JAY FLIGHT TT

Model Year: 2025 Dealer Name: JIM'S TRAILER SALES, INC
 11920 AVON BELDEN ROAD
 GRAFTON, OH 44044
 USA

Manufacturer's Suggested Retail Price \$42,803.00

TOTAL AMOUNT DOES NOT INCLUDE STATE AND LOCAL TAXES OR LICENSE FEES. THE PRICE SHOWN ABOVE MAY OR MAY NOT BE REPRESENTATIVE OF THE ACTUAL SELLING PRICE OF SIMILAR RECREATIONAL VEHICLES IN YOUR AREA.

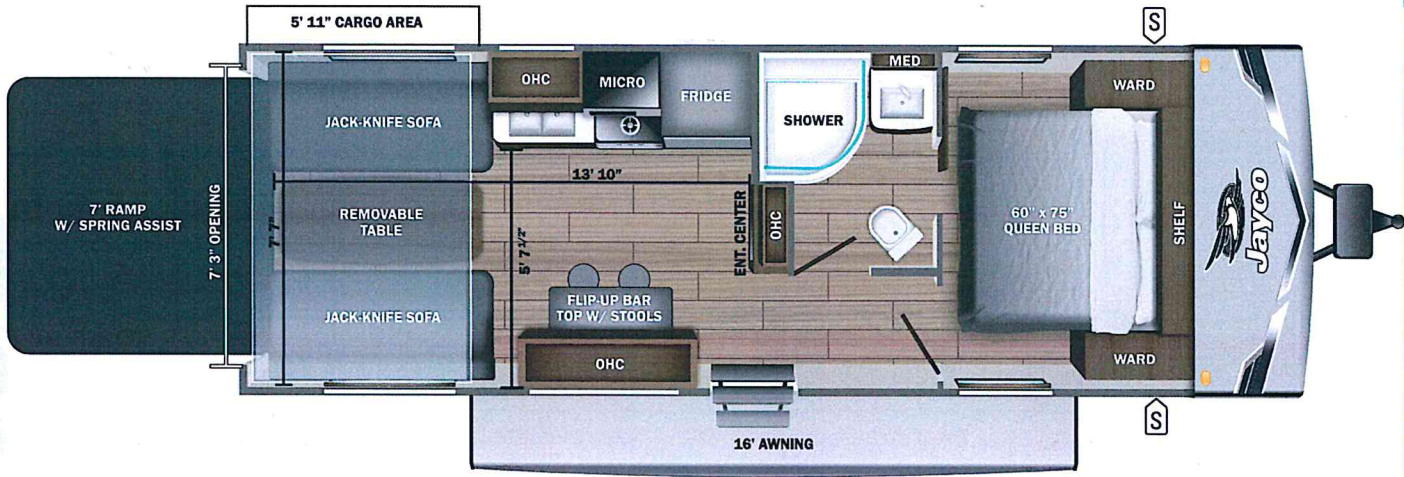

Standard Equipment

Optional Equipment

THE FOLLOWING ITEMS ARE STANDARD ON THIS MODEL AT NO EXTRA CHARGE

OPTIONAL EQUIPMENT INSTALLED ON THIS VEHICLE BY MANUFACTURER

- STANDARD EXTERIOR EQUIPMENT**
- 20 lb. LP bottles with cover (2)
 - 30-amp service
 - 5/8 in. tongue-and-groove plywood floor decking
 - Axles with electric, self-adjusting brakes and easy-lube hubs
 - Enclosed and heated underbelly
 - Exterior TV mount and bracket
 - Front diamond plate
 - Fully integrated A-frame
 - Galvanized steel, impact-resistant wheel wells
 - I-Class™ cambered structural steel I-beams
 - Large exterior downspouts
 - LP quick connect (outside gas grill prep)
 - Magnum Truss™ Roof system with plywood decking
 - PVC roofing membrane (limited lifetime warranty)

- STANDARD INTERIOR EQUIPMENT**
- 11 cu. ft. 12V refrigerator
 - 300 lb. rated bunk beds (select models)
 - 4 in. thick bunk mats (select models)
 - 600 lb. rated bunk beds (double bunks)
 - 81 in. ceiling height
 - Heavy-duty, 75 lb., full-extension, steel ball-bearing drawer guides
 - J-Steel™ jack-knife sofa with armrest and cup holders (most models)
 - Main bed struts
 - Plywood bed platforms
 - Privacy curtains in bunk areas (select models)
 - Queen mattress
 - Residential-style hidden cabinet door hinges
 - Residential-style kitchen countertops
 - Shower curtain with curved shower track (select models)
 - Shower/tub surround
 - Solid hardwood cabinet doors
 - USB charging station
 - Vented bunk windows (select models)
 - Vinyl flooring throughout (including slide floors)
 - Window shades
 - Wooden bedroom doors (select models)

Base price	36,765.00
USA STANDARDS	n/c
CUSTOMER VALUE PACKAGE	5,250.00
15,000 BTU AC	300.00
32" LED SMART TV	488.00
METAL SIDEWALL	n/c
BLACK SPOKE RIMS	n/c
20# LP GAS BOTTLES	n/c

- CUSTOMER VALUE PACKAGE (MANDATORY)**
- 13,500 BTU A/C
 - AM/FM/Bluetooth® stereo
 - Backup and side view camera prep
 - Bathroom medicine cabinet
 - Bathroom power vent
 - Bathroom skylight
 - Black tank flush
 - Detachable power cord
 - Fitted bed sheet
 - Friction hinge entry door with window and shade prep
 - G20 dark tinted privacy windows
 - Goodyear® Endurance® tires (made in the USA)
 - Inverter pre-wire
 - Keyed-Alike™ entry and baggage doors
 - Large main entry door grab handle
 - LED exterior and interior lights
 - Marine grade exterior speakers
 - Microwave oven
 - On-demand tankless water heater
 - One-piece front fiberglass exterior wall
 - Outside shower
 - Oven with 3-burner recessed cooktop with glass cover
 - Overlander 1 Solar Package: (1) 200W solar panel and 30-amp digital controller
 - Power awning with LED lights
 - Power tongue jack
 - Range hood
 - Rock-Solid Stabilizer System
 - Seamless kitchen countertops
 - Sink cover
 - Solid Step® entry steps (N/A 380DQS)
 - Spare tire with cover

UNIT TOTAL **42,803.00**

DEALER INSTALLED OPTIONS

UVW 5649 lbs **Sleeps** **Length** 30' 3.63"

DIMENSIONS

Exterior height:.....130.50"
 Exterior width:.....96.00"

WEIGHTS

GVWR:.....8500
 GAWR (front):.....4400
 GAWR (rear):.....4400
 Approx. Gross Cargo Carrying Capacity (GCCC):.....2851

CAPACITIES

Fresh water tank (gals.):...52.00
 Gray water tank (gals.):...39.00
 Black water/toilet tank (gals.):...39.00
 Propane (lbs.):.....40
 Propane (gals.):.....9
 Water heater (gals.):.....0.25

SEATING & SLEEPING

TIRES

Tire size (front):.....ST225/75R15E
 Tire size (mid):.....
 Tire size (rear):.....ST225/75R15E
 Tire size (spare):.....ST225/75R15E

Some dimensions may be rounded and may vary from the actual dimensions
 Weights may be estimated calculations and may vary from the actual weight - refer to the vehicle weight labels for actual weights
 Floorplans, features and specifications are subject to change without notice.

