

# SPORTSMEN<sup>®</sup>

TRAVEL TRAILERS & FIFTH WHEELS



## SPORTSMEN TRAVEL TRAILERS

Sportsmen travel trailers are designed for the active family, with floorplans that enhance every lifestyle. It's aggressively priced and value packed, and comes with a ton of standard features simply not found in other brands. Storage opportunities in every nook and cranny, a full appliance package, designer interiors, heated and enclosed underbelly and an aerodynamic front profile are just some of the many standards you'll find in every Sportsmen.

Sportsmen's interiors are laid out by folks who regularly camp, just like you, and we take pride in how well our living spaces and kitchens flow and feel. The 3301K (shown) boasts an island kitchen and optional solid surface countertops. It's also presented with an optional table (with leaf) and chairs. All Sportsmen offer storage galore, and you'll appreciate the generous counter space.

**S3301K** — Parchment décor



A skylight and large windows bring the outdoors in, and offer great views and cross ventilation.

Sportsmen's open concept interiors are designed to complement today's families. Our updated interiors and kid-friendly surfaces make for hassle-free vacations.



S330IK | Parchment décor



Bedrooms include a queen bed (king on some models), and side and overhead storage, and the 330IK even has a closet slide.

The 330IK offers a huge bathroom with 48" residential shower.

## SPORTSMEN FIFTH WHEELS

Like our travel trailers, Sportsmen fifth wheels are designed for everyone from first-timers to extended campers. Your pocketbook will appreciate our pricing, and your family will enjoy our standard features. Residential furniture and unique convertible sleeping areas are just some of the features you'll find in every Sportsmen.

S295RL | Harvest décor



All Sportsmen fifth wheels come with generous countertop space, double bowl sink and covers, high-rise faucet and substantial storage areas.

The 295RL (shown) includes an island kitchen, which makes for a nice layout.

S295RL | Harvest décor



The convertible sleeper sofa offers a comfortable seating and sleeping area.

The optional fireplace offers ambience and warmth on chilly nights.



Talk about comfort . . . Sportsmen fifth wheels offer high-end amenities with an affordable price. Five-inch dinette cushions and user-friendly dining surfaces make for enjoyable camping excursions.



Sportsmen bedrooms include queen (or king in some floorplans) beds, designer padded headboard, reversible quilted comforter, and side, overhead and below-bed storage.



Baths include built-in medicine cabinet with mirror, large shower, acrylic sink and storage. The 295RL is shown with a closet/drawers slide and radius shower with glass doors.

**Standards**

- 3/8" Fully Walk On Roof Decking
- 1 Piece Seamless Roof w/SuperFlex Roofing Material
- 3 Burner Cook Top
- 4" Bunk Mats (Where Available)
- 5 Cubic Foot Refrigerator
- 6 Gallon Gas DSI Water Heater
- 20 lb. Gas Bottles
- 30 Amp Service
- 13,500 BTU A/C
- Acrylic Sink
- AM/FM CD Player
- Awning w/Drip Rail & Spouts
- Built-In Medicine Cabinet w/Mirror in Bath
- Cable Hook Up
- Custom Wall Border
- Decorative Kitchen Backsplash
- Decorative Light Above Dinette in Slide-Out
- Decorative Pillows on Jiffy Sofa (Where Available)
- Diamond Plate Rock Guard on Front of Travel Trailers
- Enclosed Pin Box on Fifth Wheels
- Heated & Enclosed Underbelly
- Large Overhead Cabinets
- LED Interior Lighting

**Standard Run Package**

- 2 Exterior Speakers
- 2/4 Stabilizer Jacks
- 6 Cubic Foot Refrigerator
- (2) 30# Gas Bottles w/Cover
- AM/FM/CD/DVD Player w/Bluetooth
- Gas/Electric DSI Water Heater
- Large Assist Grab Handle
- Outside Shower (N/A w/Outside Kitchen)
- Oven
- Skylight Over Tub
- Windows at End of Slideout (Where Available)
- Winter Bypass Kit

- LED Light in Pass Thru Storage
- Linoleum From Front to Rear
- Microwave w/Turntable
- Mini Blinds
- Monitor Panel
- New Aerodynamic Front Profile
- Norco/BAL Huck Bolted Frame (E-Coated) & A-Frame (Epoxy Painted)
- Padded Headboard
- Patio Door Light
- Power Vent in Bath
- Queen Mattress
- Radial Tires
- Radius Entry Door
- Range Hood w/12V Light & Exhaust Fan
- Rear Bumper w/Sewer Hose Storage
- Reversible Quilted Comforter
- Roller Ball Bearing Drawer Guides
- Roof Vent in Main Bedroom
- Self-Adjust Electric Brakes
- Sink Cover
- Smooth Screwless Baggage Doors
- Solid Wood Framed Mortise & Tenon Glazed Cabinet Doors
- Tinted Windows
- Tub Surround
- TV Antenna w/Booster

**Touring Package**

- (Forced FWs)**
- Black Tank Flush
  - Multi-Directional Lighted Power Awning
  - Night Shades
  - Power Tongue Jack
  - Skylight in Kitchen
  - Spare Tire/Carrier/Cover
  - Stereo w/DVD Player

**Options**

- 8 Cubic Foot Refrigerator
- 32" LCD TV (Floorplan Dependent)
- 39" LCD TV (Floorplan Dependent)
- 15,000 BTU A/C Upgrade
- Bunk Ladder & Railing (Where Available)
- Closet Slide (S266BH, S285IK & S315BHK Only)
- Cotton Cloud Gel Foam Mattress Upgrade
- Deluxe Sleeper Sofa (forced on S335IK)
- Exterior Ladder
- Fiberglass on Fifth Wheels (Forced Option)
- Fireplace (Where Available)
- Flip Up Bike Rack/Tray
- Jiffy in Bunk Slide (S331BH ODS)
- Maxxair® Vent Fan (Bedroom or Living Room)
- Outside Grill
- Outside Kitchen (S266BH & S302BH Only)
- Power Tongue Jack
- Recliner – 1 or 2
- Solid Surface Countertops
- Table & Chairs w/Leaf (Where Available)
- Wired for 2nd A/C w/50 Amp Service



**Cocoa Décor**



**Harvest Décor**



**Parchment Décor**

# Travel Trailers

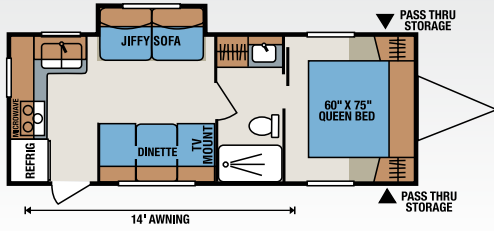

S241RKS

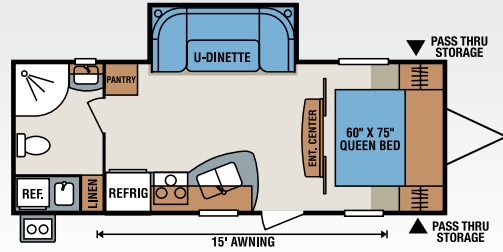

S246RBK

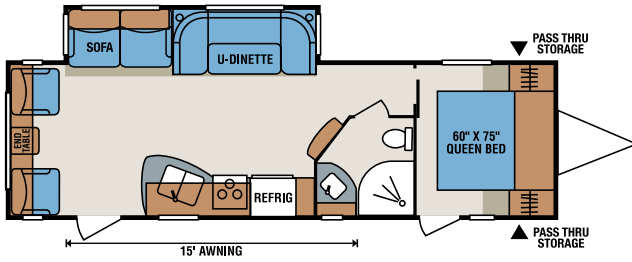

S290RL **NEW**

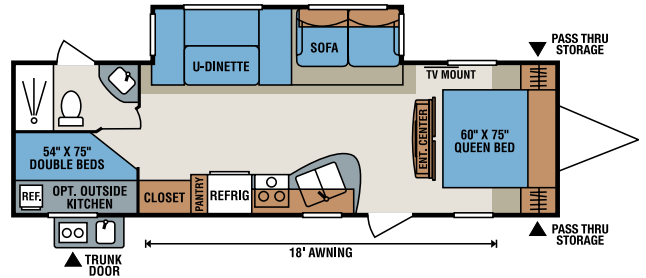

S302BH

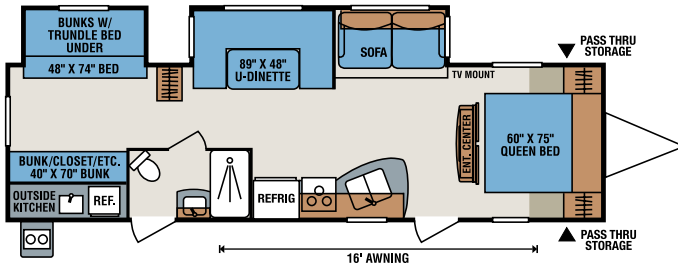

S322BHK

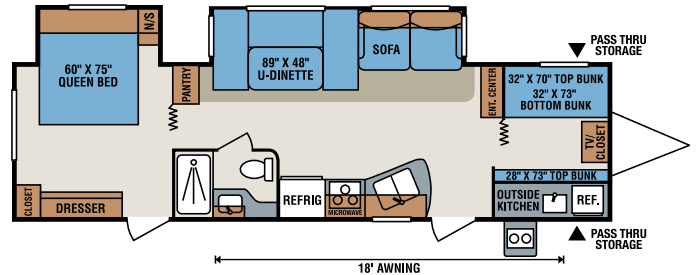

S330BHK

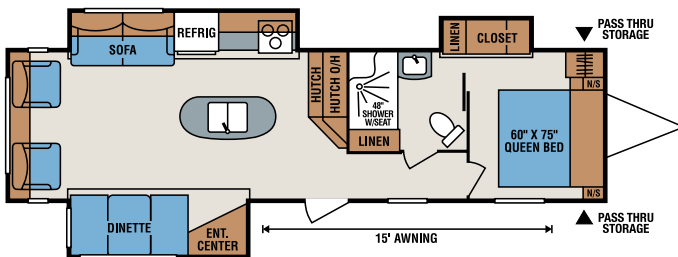

S330IK

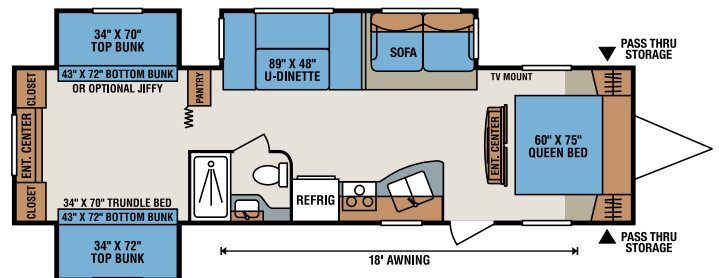

S331BH



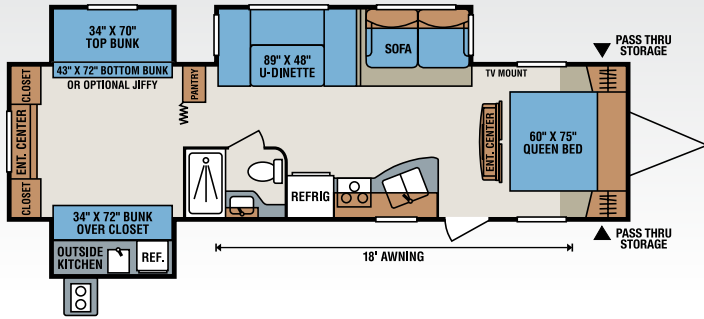

**S331BHK**

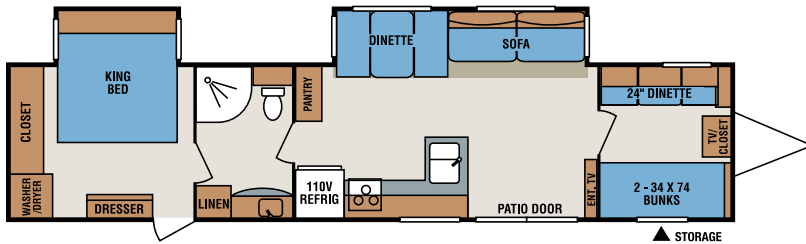

**S362BH**

**NEW**

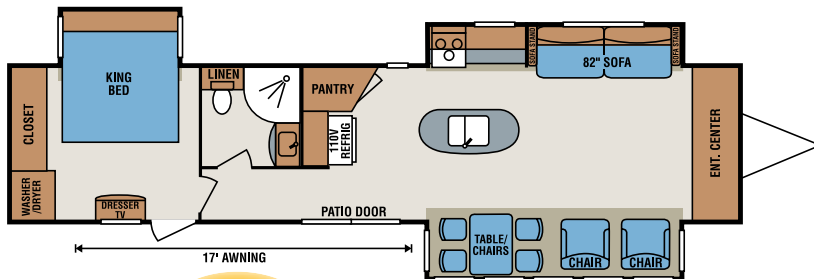

**S363FL**

**NEW**

**INTERIOR FEATURES**



Sportsmen offers creative and generous storage opportunities in every floorplan, like the S330IK (shown).

Travel Trailers	S241RKS	S246RBK	S290RL	S302BH	S322BHK	S330BHK	S330IK	S331BH	S331BHK	S362BH	S363FL
UVW (Unloaded Vehicle Weight)*	4,575	5,350	6,260	6,280	7,060	7,210	7,690	7,550	7,680	8,150	8,910
Dry Hitch Weight*	502	700	790	760	600	950	890	760	700	1,150	1,460
Dry Axle Weight*	4,073	4,650	5,470	5,520	6,460	6,260	6,800	6,790	6,980	7,000	7,450
NCC (Net Carrying Capacity)	1,425	1,650	1,740	1,720	1,740	1,590	1,110	1,250	1,120	2,310	1,550
GVWR	6,000	7,000	8,000	8,000	8,800	8,800	8,800	8,800	8,800	10,460	10,460
Interior Height	78"	78"	82"	82"	82"	82"	82"	82"	82"	82"	82"
Exterior Height w/ A/C	10' 1"	10' 8"	11' 3"	11' 4"	11' 2"	11' 1"	10' 11"	11' 4"	11' 4"	11' 4"	11' 4"
Exterior Width	96"	96"	96"	96"	96"	96"	96"	96"	96"	96"	96"
Exterior Length	26'	26' 9"	32' 3"	32' 6"	34' 5"	35' 2"	35' 6"	35' 6"	35' 6"	41' 2"	41' 2"
Refrigerator (cu. feet)	5	5	5	5	5	5	5	5	5	18	18
Water Heater Cap. (gal. G/E w/DSI)	6	6	6	6	6	6	6	6	6	6	6
Fresh Water Cap. (gal.)	38	38	38	38	40	38	40	38	38	38	38
Waste Water Cap. (gal.)	32	32	32	32	32	32	32	32	32	32	32
Gray Water Cap. (gal.)	32	32	32	32	32	47	32	32	32	32	64
LP Gas Cap. (lbs.)	40	40	40	40	40	40	40	40	40	40	40
Furnace BTUs (1,000s)	20	20	20	30	30	30	30	30	30	30	30
Tire Size	14"	14"	14"	15"	15"	15"	15"	15"	15"	15"	15"
Awning	14'	15'	15'	18'	16'	18'	15'	18'	18'	20'	17'

\*This weight reflects the rolling average unit weight for each model. Your trailer weight will vary according to optional equipment.

# Fifth Wheels

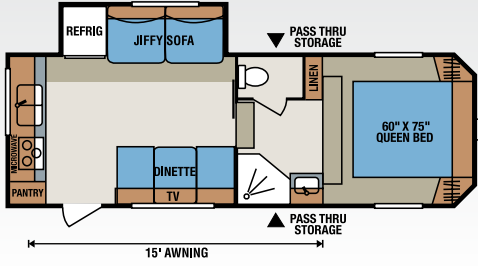

**S235RK**

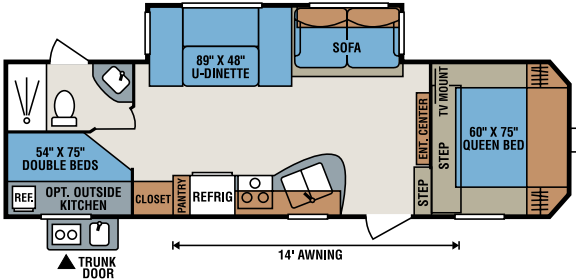

**S266BH**

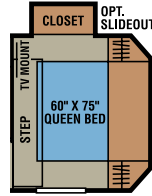

**S266BH**  
Closet Slideout  
Option

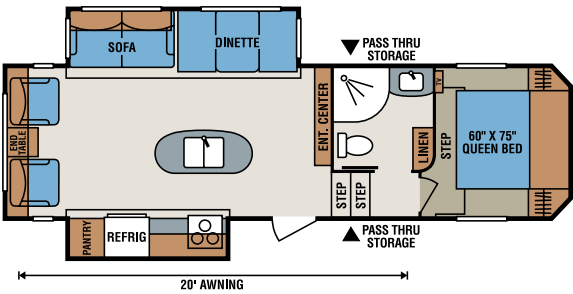

**S285IK**

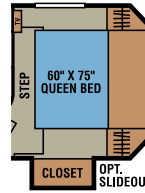

**S285IK**  
Closet Slideout  
Option

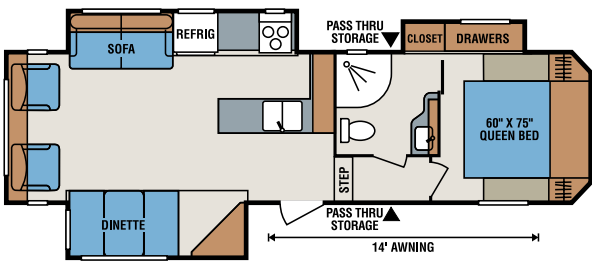

**S295RL**

**NEW**

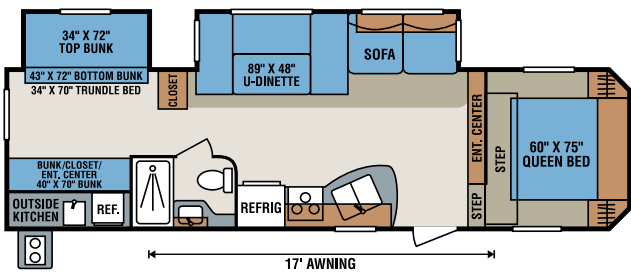

**S315BHK**

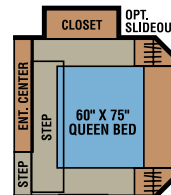

**S315BHK**  
Closet Slideout  
Option

# INTERIOR FEATURES

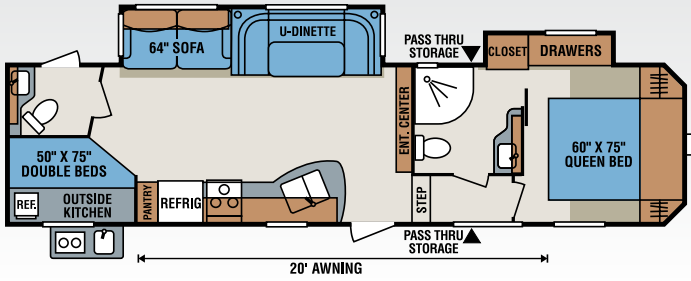

**S325BHK** **NEW**

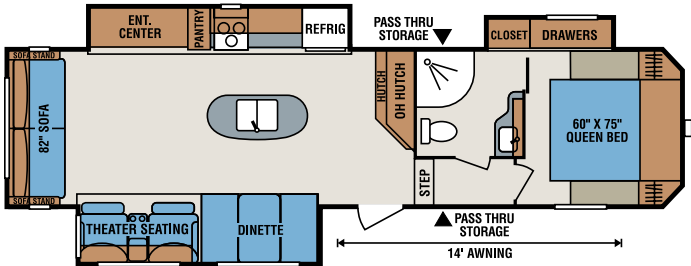

**S335IK** **NEW**

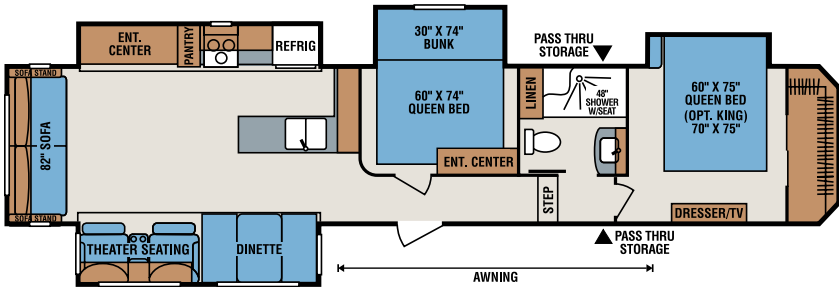

**S395BH** **NEW**



All Sportsmen floorplans offer an acrylic double-bowl sink with cover and high-rise faucet.



Sportsmen boasts 5-inch designer dinette cushions that are easy to clean, and include under-seat storage with side access door under every dinette.

Fifth Wheels	S235RK	S266BH	S285IK	S295RL	S315BHK	S325BHK	S335IK	S395BH
UVW (Unloaded Vehicle Weight)*	5,925	7,130	7,540	7,860	7,830	8,270	8,510	TBD
Dry Hitch Weight*	860	1,440	1,210	1,620	1,420	1,770	1,490	TBD
Dry Axle Weight*	5,065	5,690	6,330	6,240	6,410	6,500	7,020	TBD
NCC (Net Carrying Capacity)	1,075	1,670	1,260	1,340	1,370	1,730	1,890	TBD
GVWR	7,000	8,800	8,800	9,200	9,200	10,000	10,400	TBD
Interior Height	92"	92"	92"	92"	92"	92"	92"	TBD
Exterior Height w/ A/C	11' 8"	12' 4"	12' 7"	12' 5"	11' 11"	12' 5"	11' 5"	TBD
Exterior Width	96"	96"	96"	96"	96"	96"	96"	TBD
Exterior Length	25' 3"	30'	30' 9"	30' 5"	32' 3"	34' 11"	34' 11"	TBD
Refrigerator (cu. feet)	5	5	5	5	5	5	5	TBD
Water Heater Cap. (gal. G/E w/DSI)	6	6	6	6	6	6	6	TBD
Fresh Water Cap. (gal.)	38	40	38	38	38	38	38	TBD
Waste Water Cap. (gal.)	57	32	32	32	32	89	57	TBD
Gray Water Cap. (gal.)	89	32	32	32	32	57	57	TBD
LP Gas Cap. (lbs.)	40	40	40	40	40	40	40	TBD
Furnace BTUs (1,000s)	25	25	30	30	30	30	30	TBD
Tire Size	14"	15"	15"	15"	15"	15"	15"	TBD
Awning	15'	14'	20'	14'	17'	20'	14'	TBD

\*This weight reflects the rolling average unit weight for each model. Your trailer weight will vary according to optional equipment.



EXTERIOR FEATURES



The 302BH travel trailer boasts an outside pullout cook station with refrigerator, cooktop and sink.



Gutter extensions keep roof water from streaking.



The power tongue jack (TT shown) is included in the Touring Package or as a separate option.



Sportsmen fifth wheels offer tremendous exterior storage (295RL shown).



A large assist grab handle is included in the standard run package.



985 N 900 W • Shipshewana, IN 46565  
E-mail [kz@kz-rv.com](mailto:kz@kz-rv.com) • [www.kz-rv.com](http://www.kz-rv.com)

*Due to continual research and advances, manufacturer reserves the right to change specifications, design, price and equipment without notice, and assumes no responsibility for any error in this literature. Some items shown are not included as standard or optional equipment. ©2015KZ | 11/18/15 | 30M*