

Standards & Options

INTERIOR STANDARDS

KITCHEN & APPLIANCES

- Solid Cherry Hardwood Cabinetry
- Stiles Pre-Drilled & Screwed Together
- Residential Sized Storage Drawers w/ Solid Wood Bottoms
- Pots & Pans Storage
- Full-Extension Ball-Bearing Drawer Guides
- Residential Hidden Hinges
- EGS Steel Backed Cabinet Anchors
- Large Residential Pantry w/ Appliance Garage & 110v Outlet
- Corian® Countertops
- Corian® Sink & Stove Covers
- Corian® Backsplash w/ Shelf
- Stainless Steel Oversized Divided Sink
- High Rise Faucet w/Pull Out Sprayer
- Over-Island Lighting
- 12 cu. ft. Norcold S/S Refrigerator w/ Ice Maker
- 3-Burner Flush Mount Stainless Stove
- 22" Deluxe Stainless Baker's Oven
- 30" Stainless OTR Convection Microwave w/ Exhaust Fan

GENERAL INTERIOR

- Straight Roof Line
- LED Recessed Ceiling & Accent Lights
- Solid Hardwood Slide Fascia
- 7' Interior Slide Room Height
- 15,000 BTU WhisperQuiet A/C w/ Closed Zone Thermostat & Heat Pump (2nd A/C Std. in Bedroom)
- 40,000 BTU Furnace
- Shaw® Residential Carpet w/ Premium Pad
- Individually Hand-Laid Tile
- Central Vacuum

LIVING AREA

- Diamond Collection Furniture Package:
- Residential Sofa (Hide-a-Bed option)
- Residential Wall-Hugger Recliners
- Buffet -Style Adjustable Dinette w/ Leaf Extensions
- 2 Premium Dinette Chairs
- 2 Folding Dinette Chairs
- Day/Night Roller Shades
- Premium Entertainment Center w/ Hidden Desk
- LG® LED HDTV
- Jensen® All-in-one Entertainment Interface (CD/DVD/Bluetooth/AM/FM) w/ Surround
- Pre-wired for Winegard® Satellite Systems
- Ceiling Fan

BATHROOM

- One Piece Fiberglass Shower
- Niagara Waterfall Glass Shower Door
- Domed Skylight in Shower
- Porcelain Foot Flush Toilet
- Large Mirrored Medicine Cabinet
- Heat & A/C Duct in Bathroom
- Power Roof Vent
- Adjustable Handheld Shower Head

BEDROOM

- 660" x 80" iCool™ Gel Foam Mattress
- 110v Outlets on Both Sides of Bed
- LED HDTV
- Residential Dresser w/ Drawers
- Walk-In Closet with Shelving (8 ft. wide) & A/C Vent
- Night Roller Shades
- 2nd 15k BTU WhisperQuiet Air Conditioner w/ Closed Zone Thermostat & Heat Pump

EXTERIOR STANDARDS

CONSTRUCTION & CHASSIS

- Custom FIT Chassis
- Falcon 12"/10" I-Beam Drop Frame
- Roto-Flex Pin Box
- Falcon Hydraulic Slide Out System w/ Manual Override (Main Slides)
- Falcon 7,000 lb. Axles
- Equa-Flex Suspension System
- Correct Track™ Suspension Alignment System
- Falcon 6-Point Hydraulic Jacks w/Auto Leveling
- Falcon Aluminum 4-Step Entry
- Falcon 2" Receiver Hitch

SIDEWALLS

- 2" Laminated Wall
- Sanded Block Foam Insulation
- Double Welded Aluminum Frame
- Double Luan Backer
- T60 High-Gloss Gel Coat Fiberglass

FLOOR

- 5/8" Tongue & Groove Plywood
- 3" Aluminum Subfloor - 11" on Center
- 2 Layers of Batten Fiberglass Insulation
- 2 Layers of Flex Foil Insulation
- Darco Moisture Barrier
- Corrugated PVC Enclosure
- Fully Enclosed Underbelly w/Heated Tanks

ROOF

- One Piece Alpha Superflex Roof Material
- 5" Galvanized Stamped Steel Trusses
- Double Trusses at each A/C
- 3/8" Plywood Roof Decking
- 2 Layers of Batten Fiberglass Insulation
- 1 Layer of Flex Foil Insulation
- Fully Walk-able
- Arched for Water Runoff

GENERAL EXTERIOR

- Front & Rear Insulated Fiberglass Caps
- LED Pin Box Light
- Aerodynamic Profile

- Exterior Docking Station w/ All Hookups & Black Tank Flush
- Winterization Valve
- Slam Latch Baggage Doors
- Fully Finished, Heated & Insulated Pass-Through Storage
- 104 Gallon Fresh Tank
- (2) 45 Gallon Grey Tanks
- 45 Gallon Black Tank (2 on 39MB)
- Wastemaster Waste Mgmt. System
- Furnace-Heated Tank System
- 12 gal. Hot Water Heater
- Enclosed & Heated PEX Water Lines
- Seamless Residential Heat Ducts
- Radius Zoned A/C Ducting
- Kinro® Frameless Windows
- Carefree Adjustable Awning w/ LED Lights
- Progressive 90 Amp/12v DC Power Converter
- Energy Management System
- 50 Amp Detachable Power Cord
- Dual Battery Box
- 110v Exterior Receptacle
- Battery Disconnect Switch
- (4) G Range Tires (w/ Spare)
- 8 Lug Aluminum Rims
- 2" Self-Adjusting Drum Brakes
- (2) 30 lb. LP Tanks w/Auto Change Over
- R-42 Main Floor, R-28 Roof, R-21 Bath Deck, R-21 Front & Rear Caps, R-14 Slide Ends, R-9 Sidewall

OPTIONS

- Whirlpool 20 cu. ft. French Door
- Refrigerator w/Water & Ice
- 3 Burner Cooktop w/3 Drawers
- Fisher-Paykel Dishwasher
- 3rd 15,000 BTU A/C
- King Bed
- Hide-a-Bed Sofa
- Full Body Paint (Mandatory)
- Full Tile Flooring in Living Room
- 5100 BTU Fireplace
- 2-pc. Washer/Dryer
- MaxxFan - Kitchen
- MaxxFan - Bathroom
- Electric Induction Cooktop
- Theater Seating
- myRV™ Pad
- Dual Pane Windows (Mandatory)
- Trail-Air Tri-Glide Pin Box
- Water Filtration System
- 5.5 Onan LP Generator
- Generator Prep
- 40 lb. LP bottles
- Holding Tank Heating Pads
- Outside LP Grill Hookup
- Wireless Backup Camera
- Slide Awning Package
- 2nd Power Awning w/LED (select models)
- Uniguard Awning Upgrade(s)
- 32" Exterior TV (Mandatory)
- Goodyear "H" Tires
- 8000 lb. Axles
- Disc Brakes
- Slide-in-Slide (select models)
- Power Cord Reel - Electric



Floorplans & Specifications





31SL



38RL

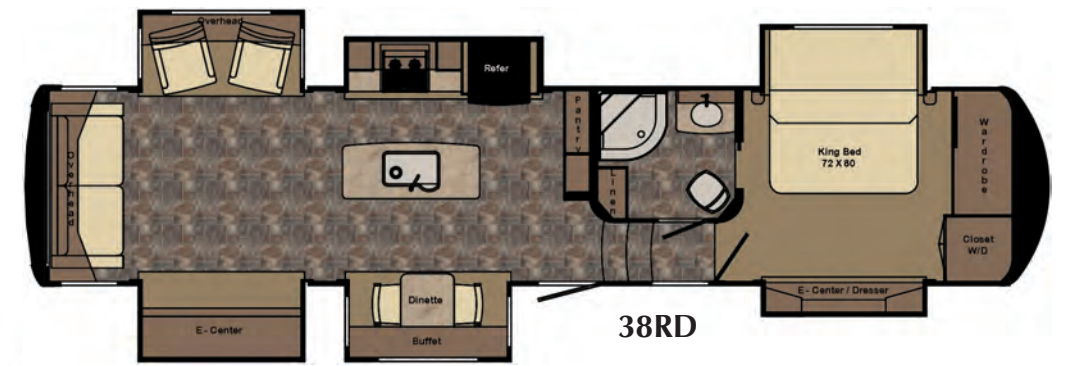

38RD

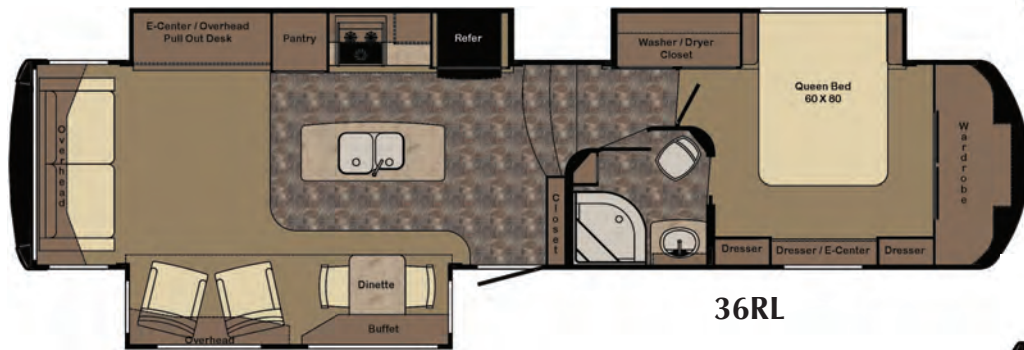

36RL



38GK



39FL



39MB

| REDWOOD | 31SL | 36RL | 38RL | 38GK | 38RD | 39FL | 39MB |
|----------------------|----------------|----------------|----------------|----------------|----------------|----------------|----------------|
| Ship Weight (lbs.) | 12,120 | 12,970 | 13,672 | 14,078 | 14,078 | 13,904 | 13,996 |
| GVWR (lbs.) | 16,500 | 16,500 | 16,500 | 16,500 | 16,500 | 16,500 | 16,500 |
| Carrying Cap. (lbs.) | 4,380 | 3,530 | 2,828 | 2,422 | 2,422 | 2,596 | 2,504 |
| Hitch Weight (lbs.) | 2,265 | 2,850 | 2,478 | 2,594 | 2,594 | 2,196 | 2,274 |
| Axle Weight (lbs.) | 9,855 | 10,390 | 11,194 | 11,484 | 11,484 | 11,708 | 11,722 |
| Ext. Length | 34' 9" | 38' 11" | 41' 5" | 41' 5" | 42' 2" | 41' 10" | 41' 8" |
| Ext. Height | 13' 3" | 13' 3" | 13' 3" | 13' 3" | 13' 3" | 13' 3" | 13' 3" |
| Fresh Water | 104 | 104 | 104 | 104 | 104 | 104 | 104 |
| Gray Water | 90 | 90 | 90 | 90 | 90 | 90 | 90 |
| Black Water | 45 | 45 | 45 | 45 | 45 | 45 | 90 |
| Tire Size | 235/85 R16 "G" | 235/85 R16 "G" | 235/85 R16 "G" | 235/85 R16 "G" | 235/85 R16 "G" | 235/85 R16 "G" | 235/85 R16 "G" |



39MB Pantry