

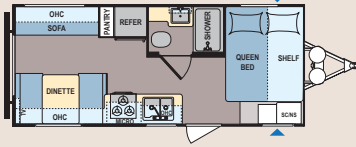

# Lantern Series

## Western Edition



192RDSWE

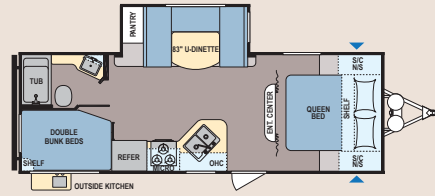

244BHSWE

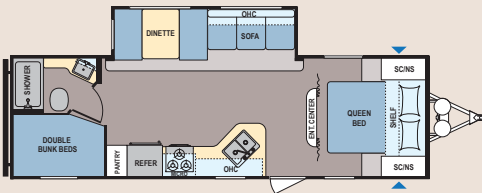

262BHSWE

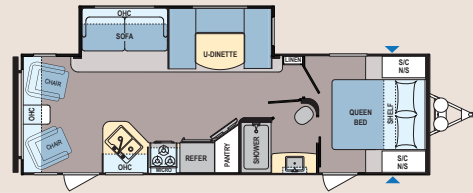

270RLSWE

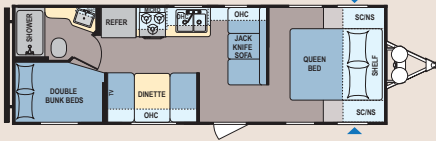

274BHSWE

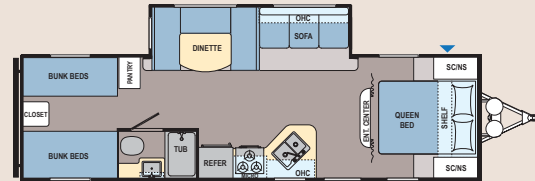

295QBSWE

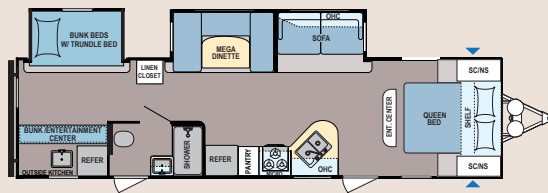

314BHSWE  
(Indiana Production)

## Conventional LT Travel Trailers

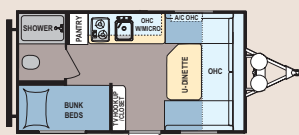

15BHSWE

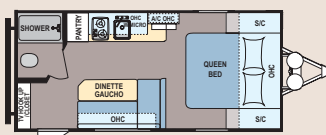

16FBSWE

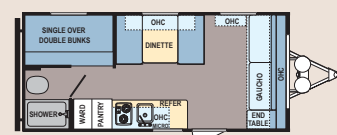

17BHSWE



## Specifications

	Average Shipping Weight*	Hitch Weight	Cargo Capacity	Length	Width	Height	Fresh Water Capacity**	Black Water Capacity	Gray Water Capacity	Furnace BTU
<b>Lantern</b>										
192RDSWE	3,923	472	3,677	22' 11"	8'	9' 11"	60	42	42	25,000
244BHSWE	TBD	TBD	TBD	TBD	TBD	TBD	TBD	TBD	TBD	TBD
262BHSWE	6,140	820	1,460	31' 9"	8'	11' 4"	60	42	42	30,000
270RLSWE	7,600	750	1,340	30' 8"	8'	11' 2"	60	42	42	30,000
274BHSWE	4,749	617	2,851	28' 7"	8'	10' 4"	60	42	42	25,000
295QBSWE	6,318	840	3,362	32' 8"	8'	11' 4"	60	42	42	30,000
314BHS	TBD	TBD	TBD	TBD	TBD	TBD	TBD	TBD	TBD	TBD
<b>Lantern LT</b>										
15BHSWE	2,883	346	917	18' 9"	8'	8' 9"	27	28	28	19,000
16FBSWE	3,204	352	596	21' 5"	8'	8' 11"	27	28	28	19,000
17FBSWE	3,202	508	648	21' 8"	8'	8' 8"	27	28	28	19,000

\*Our weights represent how most units are built, inclusive of many commonly-ordered options. \*\*Fresh water capacity includes water heater capacity

### Lantern Package

#### Exterior

- Awning
- Diamond Plate
- Tinted Safety Glass Windows
- Front and Rear Jacks
- Easy Lube Axles
- Radial Tires w/Silver Spoke Rims
- 30 AMP Power Cord
- 120V Exterior Outlet
- Exterior TV Connection on Entry Door Side
- 28" Entrance Door(s)
- Entry Handle(s)
- Porch Light with Interior Switch
- Folding Entry Steps (Double/Triple – FP Specific)
- Backers for Rear Ladder
- Smooth Finish Entry/Baggage Doors
- Large Storage Compartment

#### Interior

- Interior Power Command Center
- Wall Sconce Light in Slide Room (Slide units only)
- Full Extension Drawer Guides Throughout
- Hard Valances in Living Room and Master Bedroom
- Mini-Blind Shades Throughout
- Residential Grade Vinyl Flooring
- Dinette Storage Compartment with Side Access (FP Specific)

- Under Bed Storage
- Upgraded Rest Easy Mattress
- Bedroom TV Hook-Up
- Bedroom TV Location – Backers for TV Mount
- Everwear Luxury Furniture
- 2 Swivel Rockers (Model Specific)
- Glass Shower Door (FP Specific)
- Shower Curtain Rod (Tub Models)
- Power Bath Fan
- Foot Pedal Flush Toilet
- Medicine Cabinet w/Mirror
- Residential Galley Sink w/High Rise Faucet

#### Appliances

- Stereo AM/FM/CD/AUX/Bluetooth
- Cable/Satellite TV Hook-Up
- 6 Gallon Gas DSI Water Heater w/By-Pass Kit
- Solid State Converter w/Built in Battery Charger
- 13,500 BTU Air Conditioner
- 6 Cubic Foot Double Door Refer w/Black Insert
- 3 Burner Cooktop
- Dual 20# LP Bottles with ABS Cover
- Microwave
- Range Hood w/12V Light & Exhaust Fan

#### Options

- Coleman Lantern Package (Mandatory)
- Spare Tire & Carrier
- 15,000 BTU A/C IPO 13.5 (N/A 192)
- CSA Upfit & Seal
- Winterization (October thru April)

#### Yukon Package Option

- (Mandatory on 262BH, 270RL, 295QB, 314BH)
- Power Awning with LED Patio Light
- Exterior Speakers
- Enclosed and Insulated Fresh Water Tank
- Oven with 3 Burner Range

#### Adirondak Package Option

- Power Tongue Jack
- Aluminum Wheels
- Black Tank Flush
- Solid Surface Countertop (Kitchen)
- 5-Function Remote System
- Tub Surround
- Pleated Night Shades (Living Area Only)

### Lantern LT Package

#### Exterior

- Awning
- Diamond Plate
- Tinted Safety Glass Windows
- 28" Entrance Door Without Window
- Entry Handle
- Single Entry Step
- Porch Light w/Switch on Light
- Rear Jacks
- Easy Lube Axles
- Silver Spoke Rims
- Radial Tires
- Spare Tire
- Exterior Outlet
- 30 AMP Power Cord

#### Appliances

- 20# LP Bottle
- Solid State Converter w/Built-in Battery Charger
- 6 Gallon Gas Water Heater
- Water Heater By-Pass Kit
- 18,000 BTU Furnace
- 3.3 Cubic Foot Refrigerator
- Microwave
- 2 Burner Cooktop
- Range Hood w/12V Light & Exhaust Fan
- Stereo AM/FM/MP3/SC/AUX
- Interior Speakers

#### Interior

- Full Extension Drawer Guides Throughout
- Non Power Bath/Galley Fan
- Skylight in Bath
- Shower Curtain
- Foot Pedal Flush Toilet
- Hard Valance Living Area
- Mini-Blinds Throughout
- Residential Grade Vinyl Flooring

#### Options

- Coleman Lantern LT Package (Mandatory)
- 8,000 BTU Air Conditioner (Mandatory)
- CSA Upfit & Seal
- Winterization (October thru April)



**Dutchmen**

P.O. BOX 2000 • 2164 Caragana Court Goshen, Indiana 46526 • Sales: 574.537.0600 Fax: 574.533.0996

I.15 © Thor Industries, Inc.