

DURANGO

2500



Full Profile Fifth Wheels



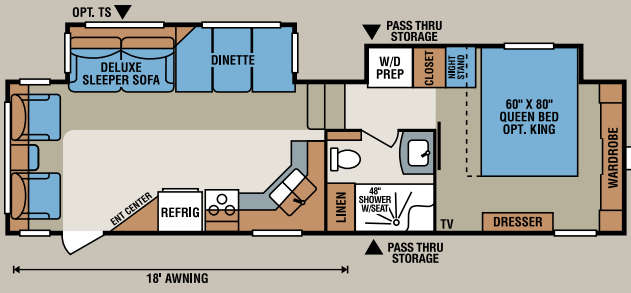

D301RLD UVW TBD • Dry Hitch Wt. TBD
NCC TBD • Length 33' 6"

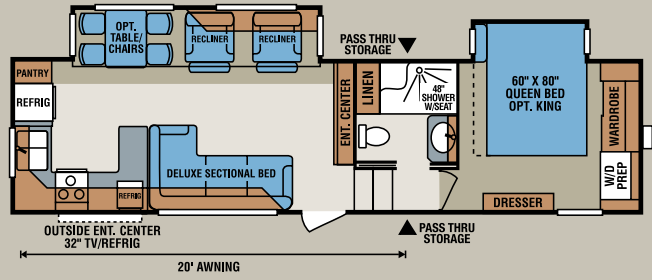

D315RKD UVW 9,910 • Dry Hitch Wt. 1,880
NCC 2,590 • Length 34' 6"

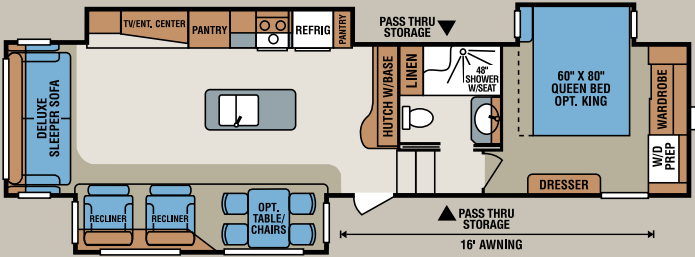

D325RLT UVW 10,480 • Dry Hitch Wt. 2,110
NCC 2,520 • Length 36' 8"

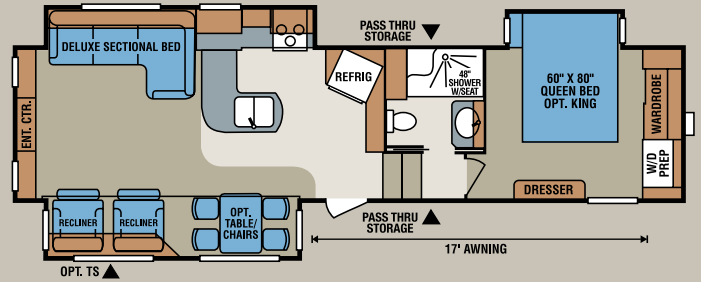

D336RET UVW 10,070 • Dry Hitch Wt. 1,830
NCC 2,430 • Length 35' 4"

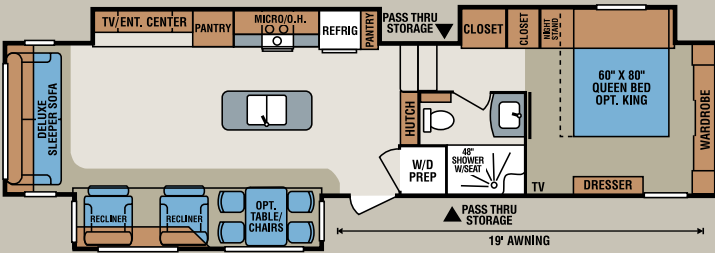

D341RLT UVW TBD • Dry Hitch Wt. TBD
NCC TBD • Length 38' 4"

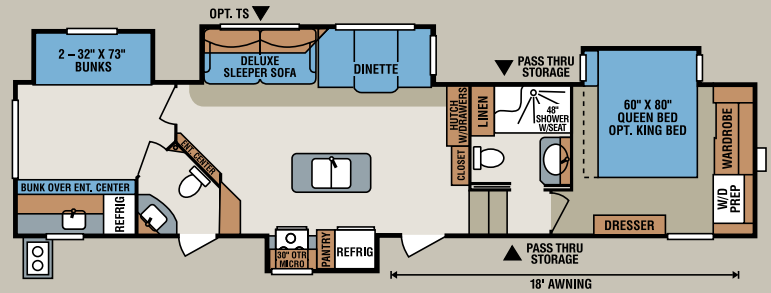

D346BHQ UVW TBD • Dry Hitch Wt. TBD
NCC TBD • Length 40' 8"

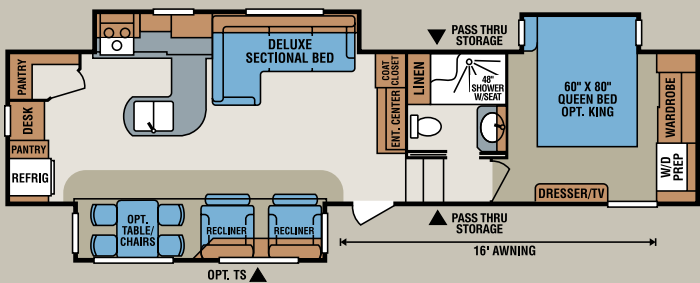

D348RKT UVW 10,790 • Dry Hitch Wt. 1,840
NCC 2,610 • Length 36' 10"

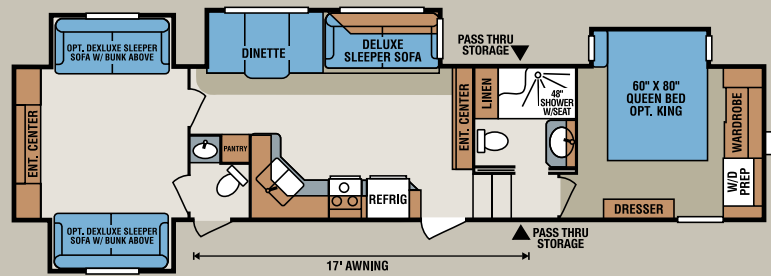

D349BHQ UVW TBD • Dry Hitch Wt. TBD
NCC TBD • Length 40' 8"

Construction Features

- 100% Aluminum frame sidewalls
- Steel powder coat I-beam w/drop-frame pass-through storage
- R-11 2" Block foam bonded sidewalls w/EGS metal backing strips to hold up all interior cabinets
- Lamilux® gelcoated high gloss colored fiberglass, front & rear
- One-piece ABS slide room bottoms, slide room floors
- Additional outside frame-to-wall floor insulation
- Walk-on Super Flex® TPO roof membrane
- 5/8" Tongue & groove screwed & glued plywood floor deck
- Fully vented attic system
- Completely heated water system
- Pex® in-floor heated waterlines & kitchen gray pipes (note: all waterlines & drains are located above all insulation)
- Heated low point drains
- Fully-enclosed & heated underbelly
- Radius front cap for maximum turning radius on short bed trucks
- Extra reinforced heavy duty front fiberglass cap
- ALL WEATHER INSULATION PACKAGE (upgrades roof, floor, end caps & tanks to R-38)
- Double insulated & heated holding tanks (R-38 above & below tanks)

Exterior Features

- Front Electric Jacks
- Dexter® axles w/auto adjusting brakes & height adjusting hangers
- 8-Lug heavy-duty aluminum rims w/16" E-range radial tires
- Equa-Flex® rubberized suspension
- 100% Exterior LED running lights & taillights (note: all running lights are on fiberglass walls, not in metal lower wrap)
- LED front docking light & sewer hookup light
- Dual function LED bug & floodlight by entry door
- Carefree® electric awning w/ directional LED light kit at end of awning w/interior reminder switch

- Propane bottles on same side of coach for easy access
- Painted front cap
- Frameless windows
- 50A services w/marine power cord
- 15,000 BTU ducted roof AC & prewire for optional 13,500 BTU bedroom AC
- 3" x 14" Foam core in-floor straight line heating system w/35,000 BTU furnace
- Heated water convenience center (includes black tank flush, power fresh tank water fill, winterizing system, outside shower & siphon for dry camping)
- Fully finished, heated & sealed basement storage compartment
- Heated & enclosed dump valves
- 12 GAL gas/electric/DSI hot water heater
- Swing-away assist grab handle
- Roof ladder
- No-slide rubberized basement flooring
- Dual lock slam latches on basement storage doors
- Outside speakers & prewire for exterior TV
- Rain gutter system all the way around roof line, including rear & additional gutters over slide rooms
- Battery disconnect
- Optional generator prep & optional Onan® 5500 LP generator
- Optional tailgate storage system w/bike rack
- Optional 4-point automatic leveling system
- Optional One Touch Remote for slides, awning, exterior lights & leveling jacks
- Optional frameless dual pane windows
- Optional Roto Flex® rubberized pin box

Living Room/Kitchen Features

- Solid surface kitchen countertops & flush-mounted sink covers
- Large residential stainless steel sinks
- Pullout high arching faucet
- Built-in silverware drawer

- Storage shelf under kitchen sink
- Heavy duty 80 LB drawer glides on every drawer
- Baltic Birch drawer boxes
- 8 CU FT refrigerator
- 22" High output oven w/broiler
- 22" Microwave
- Window in kitchen (most models)
- All-wood lumber core screwed cabinets w/hardwood doors
- 5" Stainless steel cabinet hardware
- Nightshades throughout
- 3/8" Re-bond carpet pad w/22 OZ residential carpet throughout
- Extra-large toggle light switches
- Faux vinyl ceiling
- Large ceiling crown molding
- All LED ceiling & cabinet lights w/ multiple on/off switches
- Deluxe residential style furniture
- 39" LED TV (most models)
- 12V entertainment system (DVD/ radio) w/Bluetooth
- 4 Living room speakers
- Satellite prewire (roof & ground)
- Adjustable pantry shelves (where applicable)
- All kitchen overhead cabinets have shelve & extra tall slide lips
- Wood-top booth dinette tables
- 5" High density foam cushions on all booth dinettes
- Dual pots & pans drawers in all booth dinette seats
- Ceiling fan
- Dual residential swivel rocker recliners
- Deluxe hide-a-bed sofa in living room
- Optional free-standing table w/leaf & 4 chairs
- Optional 12 CU FT side-by-side RV refrigerator or 18 CU FT 120V residential refrigerator & 1,000W inverter (where applicable)
- Optional Maxxair® fan w/wall controls (kitchen, living room, bath, bedroom)
- Optional U.S. made free-standing table w/leaf & 4 chairs
- Optional fireplace w/remote
- Optional central vacuum system

Bathroom/Bedroom Features

- One piece fiberglass shower stall w/built-in seat & glass doors (most models)
- Porcelain foot flush toilet
- All LED lights in bedroom & bathroom w/multiple large switches
- Power vent fans in all bathrooms w/power switch on wall
- Heavy-duty 80 LB drawer glides on all drawers
- Extra-large linen closet in every bathroom
- One level full height bedrooms
- Extra-large under-bed storage
- Luxurious bedspread & pillow shams
- Bedroom speakers
- Adjustable linen closet shelves, dual drawers & hanger area in all bedroom front closets (most models)
- Bedroom TV pre-wire
- Washer & dryer prep
- 60" x 80" Queen size bed, optional 70" x 80" king size bed

- Optional upgraded Cotton Cloud® memory foam mattress w/gel top
- Optional 32" HD flat panel bedroom TV
- Optional 13,500 BTU bedroom AC

Bonus Features

- 2-Year limited warranty (see flyer)
- K-Z RV has won the coveted DSI award 14 years
- K-Z's 42 years of building experience, coupled with its stable and dedicated Amish workforce and commitment to superb quality and low overhead, allow us to produce the lowest-priced luxury fifth wheels available

** Due to continual research and advances, manufacturer reserves the right to change specifications, design, price and equipment without notice, and assumes no responsibility for any error in this literature.*

**ALUMINUM
SUPER
STRUCTURE**
6 SIDED ALUMINUM FRAMING



Curry Décor



Earthen Décor

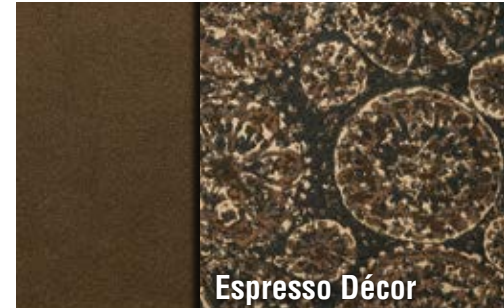

Espresso Décor

Total Aluminum Frame ... Plus Structure on ALL Durango Fifth Wheels! 100% 6-Sided Aluminum Framing – Tongue-&-Groove Plywood Roof & Floor Decking

- 2" x 2" Welded Aluminum Sidewalls
- 14" On-Center 2" x 3" Welded Aluminum Floor Joists
- 14" On-Center Welded Aluminum Roof Trusses
- Aluminum-Framed Bathroom Door Jams
- 5/8" Tongue & Groove Plywood Floor Decking
- 3/8" Roof Decking



Dealer Satisfaction Index: Ratings of manufacturers, by dealers, have consistently awarded K-Z top honors for excellence of design, reliability, overall quality and value, communications and dealer support.



Portions of this brochure were used with the expressed authority of Dexter Axle, but Dexter Axle is not responsible for the accuracy of the information contained herein.



Dealer:



Join our Family Forum at
www.kzfamilyforum.com

For more product details and in-depth information, visit us at www.kz-rv.com



985 N 900 W • Shipshewana, IN 46565
E-mail kz@kz-rv.com • www.kz-rv.com



Due to continual research and advances, manufacturer reserves the right to change specifications, design, price and equipment without notice, and assumes no responsibility for any error in this literature. Some items shown are not included as standard or optional equipment. ©2014KZ | 12/19/14 | 20M