

PALOMINO

BACKPACK EDITION



PURE MICHIGAN®

SS-1251





GOING UP?

It's easy with Palomino's New Motorized Camper Lift System featuring Rieco-Titan's Electric Roof Lift System with optional key fob control.



No more hand cranking!

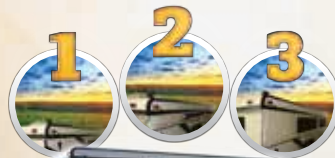

PALOMINO
BACKPACK EDITION

PALOMINO SOFT-SIDE BACKPACK EDITION

No matter the size of your truck, we have a soft-side truck camper perfect for you. Thanks to the Rieco Titan® electric lift you can easily set up your camper without hand-cranking the top up or down. And with the optional remote, it works with just a push of a button. Plus, our 55" one-piece door makes it that much easier to enter and exit the camper, compared to our competition's 46" or 47" door. The soft-side series comes in a pearl or grey laminated gel coat exterior.

HS-8801





PALOMINO HARD-SIDE TRUCK CAMPERS

Our lightweight, hard-side truck campers are packed with great features and keep a lighter payload, thanks to the fully aluminum welded frame. We've redesigned the interior to provide greater cabinet storage, and upgraded frameless windows. Our campers fit multiple truck sizes so check page 11 to find your favorite floorplan.



PALOMINO HARD SIDE MAX BACKPACK EDITION

Our Hard Side Max series is our premium product. With the insulated, frameless windows and heated basement, this camper is ready for four season livability. Our exclusive front cap windshield opens the expansive living space with light and creates an inviting atmosphere.



HS-2911





Introducing the Industry First Gel-Coat Fiberglass front cap with a fully integrated windshield. Palomino RV partnered with the leaders in O.E. Automotive Windshield Manufacturing Guardian Industries as well as Dow Chemicals to create this Palomino Exclusive Feature. This automotive style windshield not only looks great rolling down the road, but also creates an open inviting environment in the Palomino Hard Side Max Cabover Bunks while you enjoy great panoramic views.



Above: The Hard Side Max comes with our exclusive Landing Pad bumper, which gives you more room when entering and exiting. When using the awning, the Landing Pad remains shaded and comfortable.

PALOMINO HARD SIDE TRUCK CAMPER CONSTRUCTION

Palomino Hard side truck campers are aluminum framed with laminated construction to offer a light weight yet durable product at a price you can afford.



1 HI GLOSS GEL COAT FIBERGLASS EXTERIOR

2 HIGH DENSITY BLOCK FOAM INSULATION

3 ALPHA SUPER FLEX MEMBRANE ROOF

4 LUAN SUBSTRATE

5 DECORATIVE WALL BOARD

6 ALUMINUM FRAMING-FULLY WELDED SUPER STRUCTURE
(N/A ON HS-800)

7 4-SEASON HEATED INSULATED BASEMENT

PALOMINO

BACKPACK EDITION

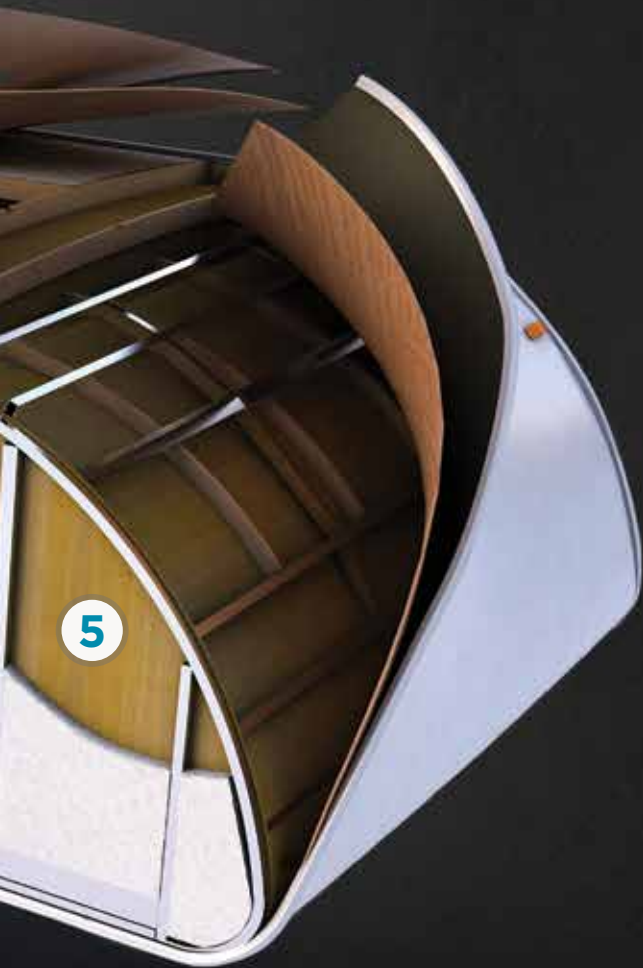

ELITE PACKAGE

(AVAILABLE ON 8801/2902/2910/2911 ONLY)

- SOLID SURFACE COUNTER TOPS
- BACK UP CAMERA
- MOTION DETECTION EXTERIOR PORCH LIGHT
- LINE X[®] PACKAGE
- REAR POWER AWNING WITH LED LIGHTS



LANDING PAD BUMPER

Palomino exclusive Landing Pad bumper for additional storage space



CHARGING PORT

Allows you to charge or maintain your on-board battery with ease from the exterior of your Palomino Camper.



BARRELED ROOF

Vacuum bonded radius roof with vaulted ceiling provides superior insulation and additional interior height

PALOMINO BACKPACK EDITION

SOFT SIDE SERIES

FLOORPLANS & SPECIFICATIONS

SS 550

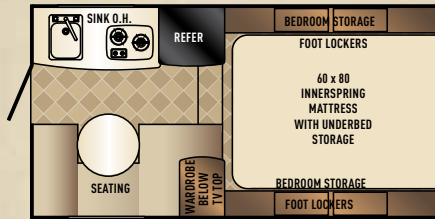

*DESIGNED FOR ANY 1/2 TON TRUCK

SS 600

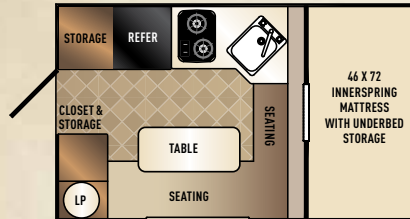

*DESIGNED FOR COMPACT TRUCKS

SS 800

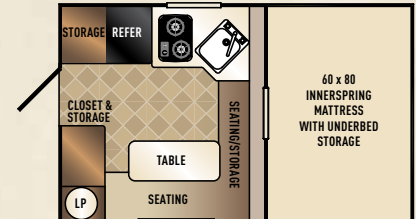

*DESIGNED FOR COMPACT TRUCKS

SS 1200

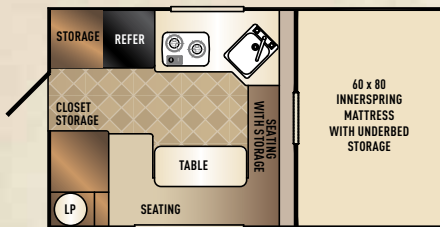

*DESIGNED FOR A FULL-SIZE TRUCK W/ 6'6" OR 8' BED

SS 1240

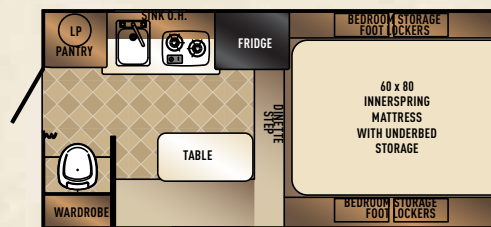

*DESIGNED FOR 1/2 TON TRUCK W/ 6'6" OR 8' BED

SS 1251

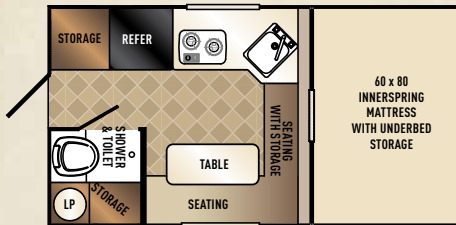

*DESIGNED FOR A 1/2 TON TRUCK W/ 6'6" BED

SS 1500

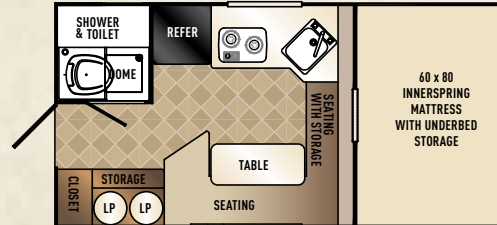

*DESIGNED FOR A FULL-SIZE TRUCK W/ 8' BED

WEIGHTS & MEASURES	SS 550	SS 600	SS 800	SS 1200	SS 1240	SS 1251	SS 1500
Total Exterior Length	13'5"	11' 0"	11' 4"	12' 10"	15'	13' 4"	14' 4"
Total Exterior Width	7'2"	6' 5"	7' 2"	7' 2"	7' 2"	7' 2"	7' 2"
Floor Length	7'	7' 4"	6' 9"	8' 0"	8' 6"	8' 6"	9' 6"
Wheel Well Width	48"	36"	44"	48"	48"	48"	48"
Height Closed with Vent	6'	6'	6'	6'	6'	6'	6'
Interior Open Height	6'9"	6'9"	6'9"	6'9"	6'9"	6'9"	6'9"
Dry Weight (lbs.)	1518 lbs.	1056 lbs.	1447 lbs.	1614 lbs.	1623 lbs.	1737 lbs.	1978 lbs.
Fresh Water Capacity (Gals.)	16	9	16	16	16	16	16
Black Water Capacity (Gals.)	N/A	N/A	N/A	N/A	7	7	7
LP Gas Capacity	20 lbs.	20 lbs.	20 lbs.	20 lbs.	20 lbs.	20 lbs.	2-20 lbs.
Cab over Bed Size	60 x 80	46 x 72	60 x 80	60 x 80	60 x 80	60 x 80	60 x 80
Dinette Bed Size	36 x 90	20 x 69	36 x 62	36 x 72	36 x 72	36 x 62	36 x 72
Center of Gravity **	22"	36"	29"	37"	30"	39"	45"

* PALOMINO STRONGLY RECOMMENDS YOU CHECK YOUR TRUCKS OWNERS MANUAL OR CONTACT THE MANUFACTURER FOR YOUR TRUCKS CAPABILITIES.

** THE CENTER OF GRAVITY MEASUREMENT IS AS BUILT. YOUR OPTIONS AND LOADING ON THE TRUCK MAY ADJUST THIS MEASUREMENT.

PALOMINO BACKPACK EDITION

HARD SIDE SERIES FLOORPLANS & SPECIFICATIONS

HARD SIDE

HS 800

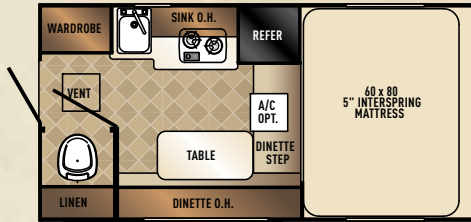

*DESIGNED FOR 1/2 TON TRUCK W/ 6'6" OR 8' BED

HARD SIDE MAX

HS 2902

EP

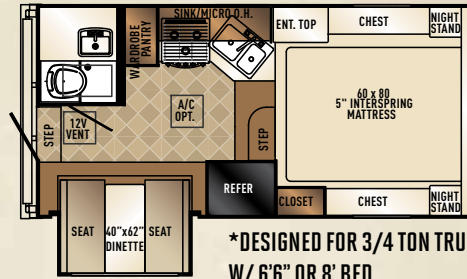

*DESIGNED FOR 3/4 TON TRUCK W/ 6'6" OR 8' BED

HS 6601

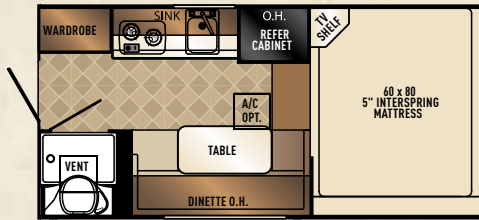

*DESIGNED FOR 1/2 TON TRUCK W/ 6'6" OR 8' BED

HS 2910

EP

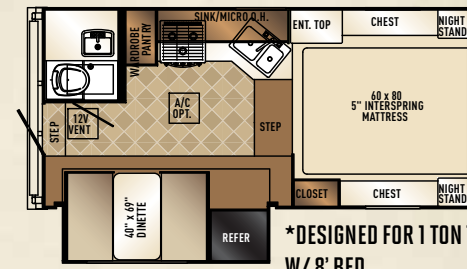

*DESIGNED FOR 1 TON TRUCK W/ 8' BED

HS 8801

EP

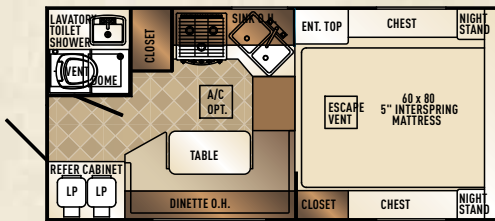

*DESIGNED FOR 3/4 TON TRUCK W/ 6'6" OR 8' BED

HS 2911

EP

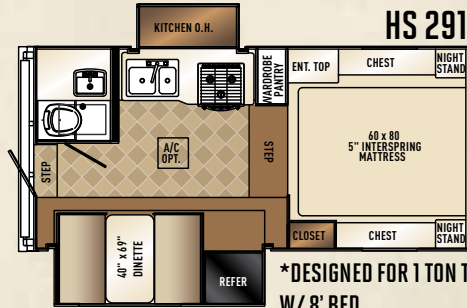

*DESIGNED FOR 1 TON TRUCK W/ 8' BED

HARD SIDE

HARD SIDE MAX

WEIGHTS & MEASURES	HS 800	HS 6601	HS 8801	HS 2902	HS 2910	HS 2911
Total Exterior Length (Including Ladder)	15'4"	15'4"	17'	17'	18'	18'
Total Exterior Width	7'	7'	7'10"	8'	8'	8'
Floor Length	9'	9'	9'	9'	10'	10'
Wheel Well Width	48"	48"	48"	48"	48"	48"
Exterior Height with Ladder	7'7"	8'2"	8'2"	9'	9'	9'
Interior Height	6'6"	6'11"	6'11"	6'8"	6'8"	6'8"
Dry Weight	1675 lbs.	1771 lbs.	2388 lbs.	2927 lbs.	3140 lbs.	3497 lbs.
Fresh Water Capacity (Gals)	31	31	31	45	45	45
Black Water Capacity (Gals)	4	6	7	20	20	20
Gray Water Capacity (Gals)	N/A	8	8	20	20	20
LP Gas Capacity	20 Lb.	20 Lb.	2-20 lbs.	1-30 lbs.	1-30 lbs.	1-30 lbs.
Cab over Bed Size	60 x 80	60 x 80	60 x 80	60 x 80	60 x 80	60 x 80
Dinette Bed Size	40 x 73	40 x 73	40 x 73	40 x 62	40 x 69	40 x 69
Center of Gravity**	38"	38"	42"	37"	46"	46"

*PALOMINO STRONGLY RECOMMENDS YOU CHECK YOUR TRUCKS OWNERS MANUAL OR CONTACT THE MANUFACTURER FOR YOUR TRUCKS CAPABILITIES.

** THE CENTER OF GRAVITY MEASUREMENT IS AS BUILT. YOUR OPTIONS AND LOADING ON THE TRUCK MAY ADJUST THIS MEASUREMENT.

EP ELITE PACKAGE AVAILABLE



PALOMINO BACKPACK EDITION STANDARDS & OPTIONS

STANDARD FEATURES

- LED Interior Lighting
- Vented Battery Box (2 Std. on Max Series)
- Battery Quick Disconnect
- Battery Charging Station
- Rieco Titan® Electric Roof Lift (Soft sides only)
- Ball Bearing Drawer Guides
- "Landing Pad" Integrated Bumper (Hard Side Max Only)
- Laminated Walkable Roof (Hard Side Only)
- Congoleum® Wood Grain Flooring
- Mortise and Tenon Walnut Hard Wood Cabinets
- Pocket Screw Lumber Core Cabinet Stiles
- 55" One-Piece Door (Soft Side Only)

COMMONLY ORDERED OPTIONS

- Air Conditioning
- Pearl or Grey Hi-Gloss Exterior Fiberglass
- Entry Step
- Microwave (Hard Sides Only)
- Side Awning w/LED Lights (Hard Sides Only)
- Rear Awning w/LED Lights (Hard Sides Only)
- Wireless Remote for Rieco Titan® Roof Lift (Soft sides only)
- Elite Pkg - Hard Sides only (8801/2902/2910/2911)

* See our website for a complete list of available options



Forest River, Inc. encourages our customers to purchase their Forest River products from a local dealership whenever possible for the following reasons:

- 1) Forest River, Inc. dealers are independently owned and operated businesses so priority service and scheduling is at their discretion and is often provided to customers that purchased their unit at that dealership.
- 2) Purchasing locally allows customers to establish meaningful relationships with a dealer, enhancing the RV experience through assistance with product questions, user tips or RV regulations for your state or country, and much more!
- 3) Canadian customers must meet requirements to bring an RV purchased out of the country to their home. These requirements may involve additional inspections and certifications, taxes and fees. Your local Canadian Dealer is a professional at meeting these requirements.
- 4) Scheduling timely warranty repairs and adjustments through a local dealership provides far greater flexibility and convenience to you, the customer!

It is the goal of Forest River, Inc. that all of our RV owners fully enjoy the RV experience and that customer satisfaction meets or exceeds their expectations!



PRE-DELIVERY INSPECTION FACILITY

20,000 square feet of quality assurance. The bare essentials for a premium product. This state-of-the-art facility gives immediate daily feedback to production for quality assurance in every unit built.



FREE MEMBERSHIP
to Forest River Owners' Group

www.forestriverfrog.com



BACKPACK EDITION TRUCK CAMPER DEALER



Learn More
Scan this barcode using a QR Reader on your smart phone to learn more about Forest River.



A Berkshire Hathaway company.



PALOMINO RV

1047 EAST M-86 | COLON, MI 49040

P: 269.432.3271 | F: 269.432.2516

www.palominorv.com