

*Shasta*  
EST. 1944

ADVENTURE AWAITS

REVERE

SHASTA - REVERE 5TH WHEEL & TRAILERS





REVERE

STYLE





REVERE

# LIVING



## YOU'LL FEEL AT HOME

There's room to stretch out and feel at home with 7' ceilings and deep slideouts. A full-wall entertainment center with space for a 32" TV. A standard AM/FM/CD/DVD stereo completes your entertainment center



## WITH REVERE, YOU'VE GOT STYLE.

Large windows, high ceilings, and storage everywhere. Revere was designed to have a residential feel, new this year is a lighted tray ceiling feature. Home-like cabinets have lots of space and drawers that glide open to fully extend. A residential style double-bowl sink makes clean up easy. Choose the optional free standing chairs and table, or our U-Dinette booth that converts to a bed that will sleep two adults comfortably.







## WHEN IT'S TIME TO KICK BACK.

Everyone deserves their own haven. Revere gives you the comforts of home, like a soft, quilted bedspread. Full length, mirrored shirt closets flanking the bed. An extra-large overhead cabinet with reading lights for your convenience. Easy-to-access under-bed storage. A cable TV hookup. When it's time to pamper, take a shower or a bath. And enjoy the roomy bathroom sink - with a vanity big enough for your favorite toiletries.





SHASTA REVERSE - TRAVEL TRAILER FLOORPLANS

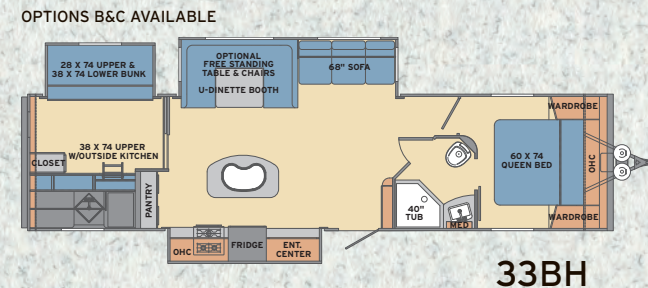
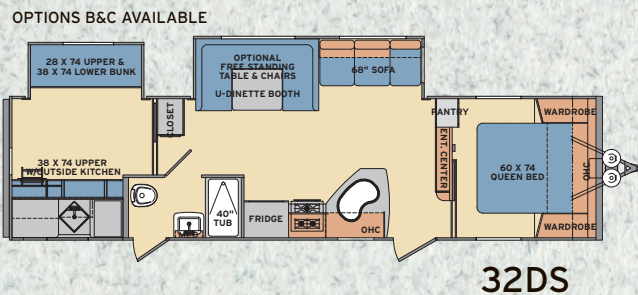
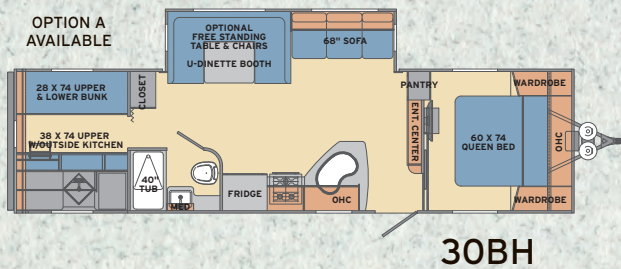
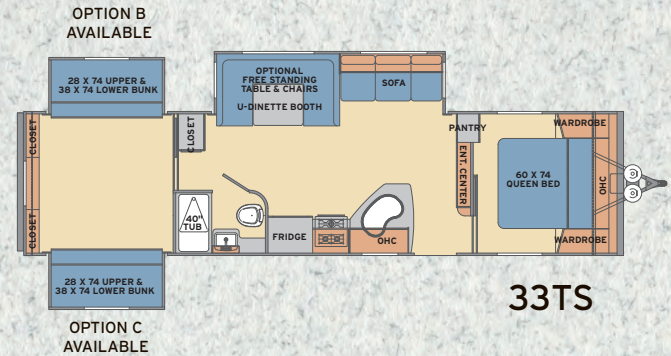
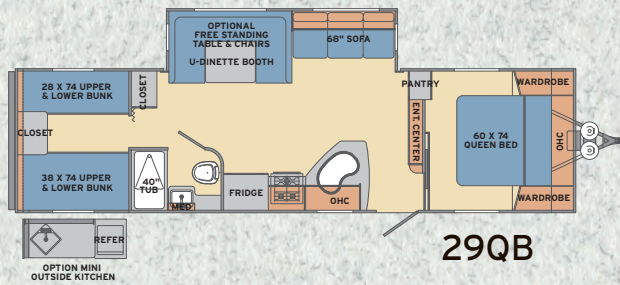
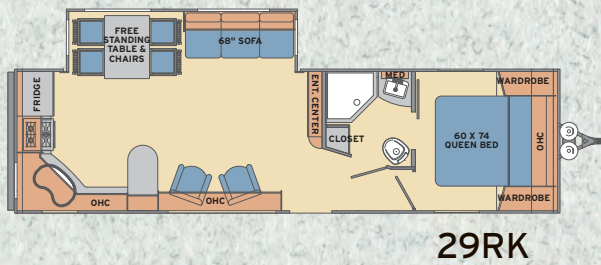
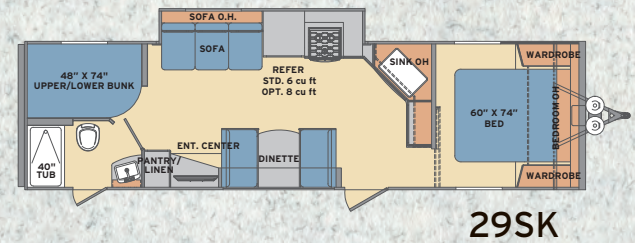
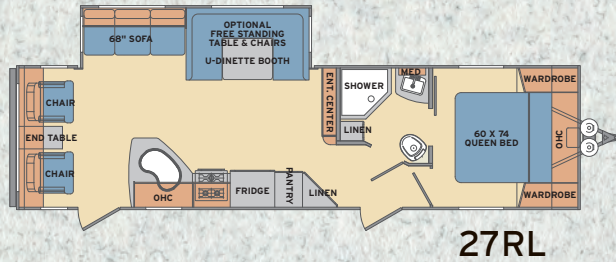
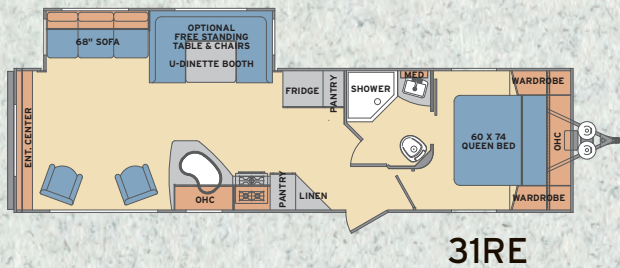
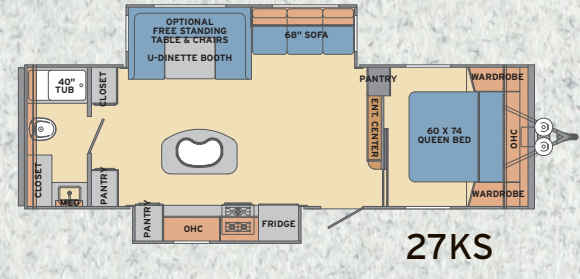
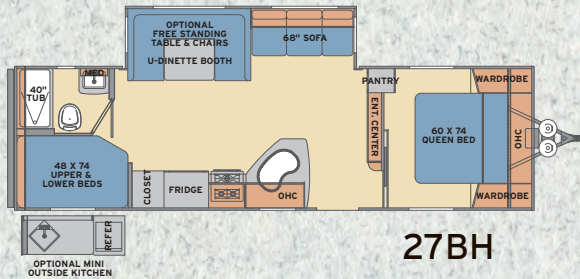
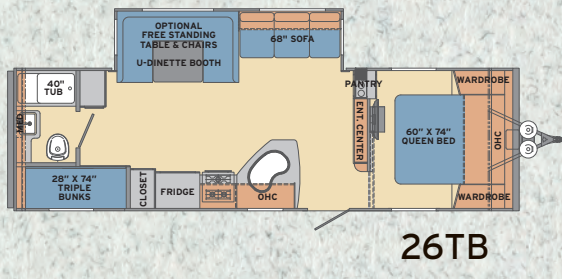



## FIFTH WHEEL FLOORPLAN

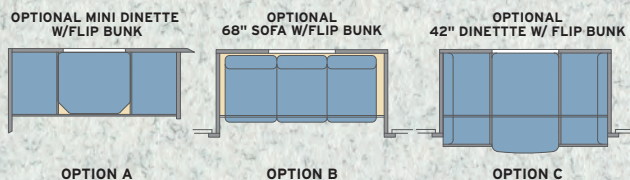
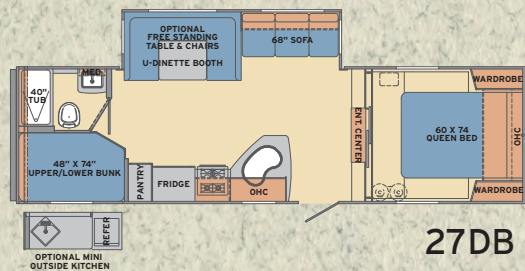

## STANDARDS

### Exterior

- Front Hitch Light
- Lighted Pass Thru Storage
- Insulated Baggage Doors
- Straight Axles with Electric Brakes with E-Z Lube
- Amber Patio Light with Inside Switch
- Radius Entry Door with Screen and Friction Hinge
- Molded Rain Gutter with Extra Long Spouts
- Black-Framed Radius Tinted Safety Glass Windows
- Dual LP Bottles with Quick Access Cover
- Diamond Plate Rock Guard
- LED Awning Light

### Power Systems

- 12V Demand Water Pump
- Systems Monitor Panel
- In-Floor Ducted Heat
- Auto-Ignition Furnace with Wall Thermostat
- Water Heater Bypass
- Water System Winterization Kit

### Interior

- 7' Interior Height
- 6' 1" Slide Heights
- 42" Deep Slides
- Pocket-Bored and Screwed Cabinets
- Residential Cabinet Doors Throughout
- Overhead Cabinet with Etched Glass Doors in Super Slides
- Box Valances in Living Area with Night Shades
- Residential Style Light Above Dinette
- Residential Looking Sofa
- Full Wall Entertainment Area
- Cable TV Hookup RG6 Coax Cable
- Beauflor Tile Flooring
- Solid Wood Drawer Fronts
- LED Lighting Throughout

## Kitchen

- 3-Burner Cooktop with High Output Burner & Piezo Lighter
- Range Hood with Light & Exhaust Fan
- Large Oven
- Residential Size Sink
- Full Extension Ball Bearing Drawer Guides
- Residential Tray Ceiling

## Bathroom

- Powered Roof Vent
- Marine Toilet with Foot Flush
- Medicine Cabinet with Mirror
- Large Sink

## Bedroom

- Under Bed Storage with Gas Struts
- Cable TV Hookup
- (2) Full-Length Mirrored Shirt Closets
- Residential Quilted Bed Spread
- Extra Large Overhead Cabinets

## Construction

- .024 Aluminum Exterior Skin
- R-7 Fiberglass Insulation in Sidewall, Floor and Roof
- 5/8" Tongue & Groove Plywood Floor Decking
- 2' By 3' Floor Joist
- Radius Wood Rafters
- Aerodynamic Radius Front Profile
- 16"-On-Center Wood Wall Studs
- Electric Flush Floor Slide Rooms
- Prepped For Rear Ladder
- One-Piece Rubber Roof with 12-Year Warranty
- Cambered Steel I-Beam Frame

## Safety Features

- CO2 Detector
- LP Leak Detector
- Fire Extinguisher & Smoke Alarm
- Break-Away Switch

## OPTIONS

### Exterior

- Spare Tire & Carrier
- High-Gloss Fiberglass Exterior
- Aluminum Wheels
- 30LB. LP Bottles in Place of Std. 20LB.
- Heated and Enclosed Underbelly
- Rear Ladder
- (4) Electric Stabilizer Jacks
- Power Tongue Jack
- Bike Rack
- RVQ Grill

### Interior

- Hide-A-Bed Sofa in Place of Jack-Knife Sofa
- Junior Dinette in Place of Lower Bunk (30BH)
- Booth Dinette in Place of Lower Bunk (32DS, 33BH, and 33TS))
- 32" LED Flat Screen TV
- Fireplace (Where Available)
- 8 CU. FT Double Door Refrigerator
- Freestanding Dinette
- Premium Pillow Top Mattress
- 15K BTU A/C in Place of 13.5K BTU A/C
- QAI Canadian Compliance

## Camping With Ease Package

- 6 Gal Gas/Electric DSI HW Heater
- ABS Tub Surround
- Skylight in Tub Shower
- Extra Large Grab Handle
- Wide-Track Axles
- Microwave Oven
- Night Shades in Living Area
- Skylight with Pleated Shade in Kitchen
- Electric Awning
- AM/FM/CD/DVD
- Outside Shower
- Two Exterior Speakers
- 6-CU.FT. Refrigerator
- (4) Stabilizer Jacks
- Electric Patio Awning
- Range with Oven
- 13.5 BTU Ducted A/C
- Radial Tires
- Coach Net Roadside Assistance





## THE SHASTA STORY - Leading Value in the RV Industry

In 1941, the first Shasta "house trailer" was built to be used as mobile military housing. Today, over 70 years later, Shasta remains an important player in the multi-billion-dollar RV industry. As one of the industry's longest producers of recreational vehicles, Shasta is proud of its longevity. We've earned our success in the best possible way - through experience ... more experience than any other R V company in the world. Shasta's respected name prevails in today's fast-moving RV industry because of experience, combined with a strong, service-oriented dealer network, a loyal, repeat customer base, and our outstanding association with our parent company, Forest River.

### REVERE TRAVEL TRAILERS

### FIFTH WHEEL

FLOOR PLAN	SHT 26TB	SHT 27BH	SHT 27KS	SHT 27RL	SHT29SK	SHT 29RK	SHT 29QB	SHT 30BH	SHT 31RE	SHT 32DS	SHT 33BH	SHT 33TS	27DB
Length Overall	30' 11"	31' 9"	30' 11"	33' 11"	32' 10"	34' 9"	33' 11"	33' 11"	33' 11"	35' 6"	36' 11"	35' 11"	29' 11"
Width	96"	96"	96"	96"	96"	96"	96"	96"	96"	96"	96"	96"	96"
Tire Size	ST225/75R15	ST225/75R15	ST225/75R15	ST225/75R15	ST225/75R15	ST225/75R15	ST225/75R15	ST225/75R15	ST225/75R15	ST225/75R15	ST225/75R15	ST225/75R15	ST225/75R15
Exterior Height w/ A/C	11' 5"	11' 5"	11' 5"	11' 5"	11' 5"	11' 5"	11' 5"	11' 5"	11' 5"	11' 7"	11' 7"	11' 7"	12' 4"
Main Slide Room Height	6'2"	6'2"	6'2"	6'2"	6'2"	6'2"	6'2"	6'2"	6'2"	6'2"	6'2"	6'2"	6'2"
Dry Weight (lbs.)	6,301	5,986	6,606	6,776	6,814	6,617	7,045	7,045	6,374	7,760	8,455	8,244	6,720
Hitch Weight (lbs.)	720	604	785	918	858	530	620	620	650	756	1,007	773	1,082
Fresh Water Tank Cap. (gal.)	50	50	50	50	50	50	50	50	50	50	50	50	50
Grey Water Tank Cap. (gal.)	45	45	45	45	45	45	45	45	45	45	45	45	45
Black Water Tank Cap. (gal.)	45	45	45	45	45	45	45	45	45	45	45	45	45
Awning	17'	18'	20'	17'	18'	18'	20'	20'	19"	17'	TBA	20'	14'
Furnace (BTU's)	30K	30K	30K	30K	30K	30K	30K	30K	30K	34K	34K	34K	30K
Water Heater Capacity (gal.)	6	6	6	6	6	6	6	6	6	6	6	6	6

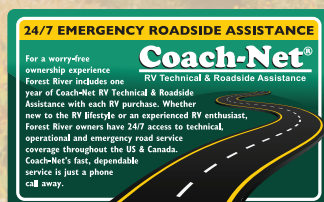

**Forest River, Inc. encourages our customers to purchase their Forest River products from a local dealership whenever possible for the following reasons:**

It is the goal of Forest River, Inc. that all of our RV owners fully enjoy the RV experience and that customer satisfaction meets or exceeds their expectations!

- 1) Forest River, Inc. dealers are independently owned and operated businesses so priority service and scheduling is at their discretion and is often provided to customers that purchased their unit at that dealership.
- 2) Purchasing locally allows customers to establish meaningful relationships with a dealer, enhancing the RV experience through assistance with product questions, user tips or RV regulations for your state or country, and much more!
- 3) Canadian customers must meet requirements to bring an RV purchased out of the country to their home. These requirements may involve additional inspections and certifications, taxes and fees. Your local Canadian Dealer is a professional at meeting these requirements.
- 4) Scheduling timely warranty repairs and adjustments through a local dealership provides far greater flexibility and convenience to you, the customer!



#### Learn More

Scan this barcode using a QR Reader on your smart phone to learn more about Forest River.



A Berkshire Hathaway company.

#### PRE-DELIVERY INSPECTION FACILITY

20,000 square feet of quality assurance. The bare essentials for a premium product. This state-of-the-art facility gives immediate daily feedback to production for quality assurance in every unit built.

All illustrations and specifications contained in this brochure are based on the latest product information at time of publication. Shasta Recreational Vehicles reserves the right to make changes in prices, colors, materials, equipment and specifications, and to discontinue models at any time without notice. Some equipment shown separately, or on products illustrated in this brochure, may be optional at extra cost. Check with your Shasta dealer for more information if you have specific questions. ©Copyright 2014 Shasta, a Division of Forest River Inc - All Rights Reserved.

#### YOUR SHASTA REVERE DEALER: