

# **INNSBRUCK**

BY GULF STREAM®



*Our New 277DLS  
with Double Bunks  
and two Entry  
Doors*

## **Where Experience and Innovation Come Together**



*You'll find sumptuous queen beds, generous storage spaces and restful privacy in our bedrooms. Model 295SBW shown.*



*The truly stunning Kitchen of the Model 295SBW*



*Our floor plans feature residential panel bedroom doors, well-equipped kitchens and advanced entertainment choices. Model 277DLS shown.*

# WHEN IT COMES TO SOLID CONSTRUCTION, NO ONE PUTS IT TOGETHER LIKE WE DO

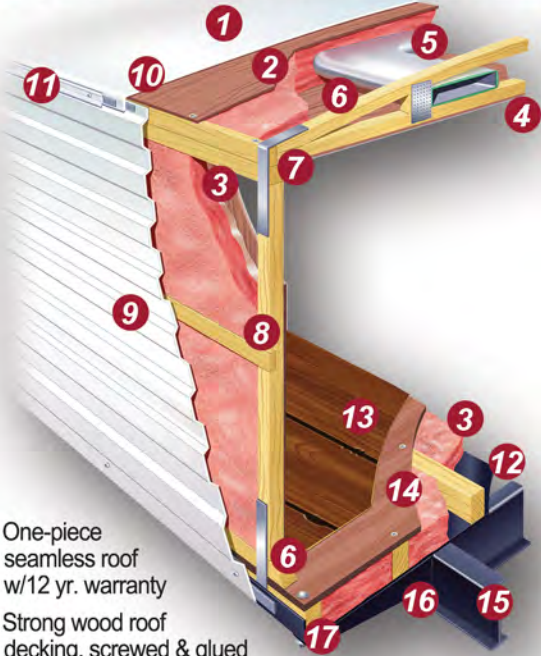

1. One-piece seamless roof w/12 yr. warranty
2. Strong wood roof decking, screwed & glued
3. Thick energy-saving blankets of hand-cut fiberglass insulation in ceiling, walls & floors; insulation bonded to walls to prevent settling
4. Reinforced truss-style roof construction
5. Air conditioning ducts in insulated ceiling space
6. Interior ceiling board
7. Galvanized steel straps to increase roof-to-sidewall & sidewall-to-floor strength
8. Sturdy wood sidewall 16" on center with dado cross braces for extra stiffness, set on floor & screwed in for maximum strength
9. Aluminum siding w/baked enamel finish
10. Butyl caulk for better seal, fewer streaks
11. Drip rail to direct rain runoff away from unit
12. Tough polymax underbelly overlaps sides & ends to protect against moisture & debris
13. Durable heavy-gauge vinyl floor covering
14. 5/8" floor decking screwed & glued to floor joists, 13" on center
15. Powder-Coated I-Beam Steel Frame
16. Full-width steel outriggers for superior strength and support
17. Heavy gauge radius lower metal

## SE SERIES

\*Specifications and decor features in SE Series Models vary. Check with your Dealer for more information.



**NEW!** 2nd Bedroom Options:  
4 Bunks or Queen Bed

## TRAVEL TRAILERS



Optional Outside Kitchen  
Optional 2nd Entry Door

# INNSBRUCK

BY GULF STREAM®

# LODGE SERIES

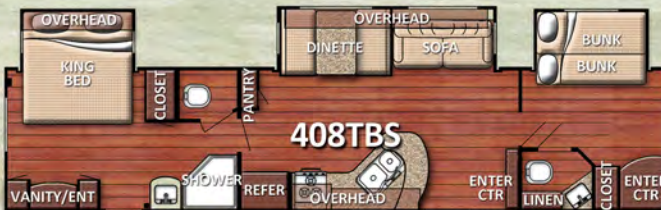

**LODGE SERIES**  
Your luxurious, affordable home-away from home.  
399DLS shown

## SPECIFICATIONS

*Specifications are approximate and subject to change. Check the sticker on your unit for actual weights.*

	Length	Width	Height w/AC	Furnace BTUs	Carrying Capacity	Hitch Weight	Dry Weight	Fresh Wtr. (gal)	Grey Tank (gal)	Black Tank (gal)
<b>SE SERIES</b>										
24RBL	26'11"	8'	10'9"	25K	3,312	890	4,098	54	37	37
275FBG	29'10"	8'	10'9"	25K	2,676	690	5,014	54	37	37
23R8G	26'8"	8'	10'9"	25K	2,607	530	4,883	54	37	37
265BHG	28'11"	8'	10'9"	25K	1,000	820	6,000	54	37	37
36FRSG	38'8"	8'	10'9"	30K	3,314	1,340	8,066	N/A	37	37
<b>TRAVEL TRAILERS</b>										
24RKL	27'11"	8'	10'9"	25K	1,890	890	5,683	54	74	37
260RLS	29'8"	8'	10'9"	25K	4,710	850	6,540	54	37	37
268RBK	30'8"	8'	10'9"	25K	1,710	820	6,110	54	37	37
269BHL	30'8"	8'	10'9"	25K	1,710	820	6,110	54	37	37
277DDS	31'2"	8'	10'9"	25K	1,520	958	6,678	54	37	37
279QBL	32'7"	8'	10'9"	25K	1,929	860	5,931	54	74	37
281RLS	32'3"	8'	10'9"	30K	4,400	930	6,930	54	74	37
295SBW	34'9"	8'	10'9"	30K	4,473	1,080	6,767	54	74	37
297DBS	32'7"	8'	10'9"	30K	3,260	720	6,691	54	37	37
30FRK	35'8"	8'	10'9"	30K	3,390	1,120	8,130	54	37	37
323TBR	35'8"	8'	10'9"	30K	3,300	850	7,850	54	37	37
32TBHT	37'0"	8'	10'9"	30K	2,500	1,020	8,920	54	74	37
<b>LODGE SERIES</b>										
34FLS	38'8"	8'	10'9"	30K	3,314	1,340	8,066	N/A	37	37
397RMS	39'11"	8'	11'1"	30K	2,310	1,300	9,030	N/A	37	37
398FRS	39'11"	8'	11'1"	30K	2,310	1,300	9,030	N/A	37	37
399DLS	39'11"	8'	11'1"	30K	2,310	1,300	9,030	N/A	37	37
408TBS	40'6"	8'	11'1"	30K	2,790	1,360	9,570	N/A	74	37

## INTERIOR DECOR CHOICES



Designer-approved for style and durability

- WOOD LOOK VINYL
- SLATE LOOK VINYL (Opt)
- CARPET (Selected Floor Plans)
- CABINETRY
- GRANITE LOOK COUNTERTOP

# INNSBRUCK

BY GULF STREAM®

Where Experience and Innovation Come Together to Give You Unmatched Quality and Value

## STANDARD FEATURES

### Furnishings & Decor

- Maple Cabinetry w/Solid Wood Doors & Drawers
- Solid-Panel Privacy Bedroom Doors
- Hi-Performance Vinyl Flooring throughout
- Scald and Stain-Resistant Laminated Countertops
- Flip-Up Queen Bed w/Innerspring Mattress & Quilted Comforter
- Wall Mirror

### Heating, Cooling & Plumbing

- Two LP Bottles w/Auto Change & EZ Access Cover
- Ducted 13,500 BTU Roof Air Conditioner (Optional in SE Models)
- Gas Furnace w/Insulated In-Floor Heat Ducts
- 6 Gal Rapid Flow Gas DSI Water Heater
- Monitor Panel for Tank Levels
- Water Tank and Pump (N/A in Lodge Series)
- Water Heater By-Pass Valve

### Electrical & Safety

- Cable TV Hook-Up
- AM/FM/CD/DVD w/4 Speakers & Antenna (N/A in SE Models)
- 30 Amp Service w/45 Amp Converter w/Charger
- TV Antenna w/Signal Booster
- Wall Mounted Light Switches
- Wall Mounted Fire Extinguisher
- Smoke Detector, Combo CO/LP Detector
- Patio Light, Utility Light by LP Tanks, Step Light
- Safety Chains

### Kitchen & Bath

- 3-Burner Range w/Superburner & Oven (Optional on SE Models)
- Power Range Hood w/Light
- 6.0 Cu. Ft. Double Door Refrigerator (opt. on SE)
- Carousel Microwave Oven
- Full Extension Roller Bearing Drawer Guides
- 60/40 Kitchen Sink in White
- Glass Shower Door in Neo-Angle Showers
- Power Bath Vent
- Foot Flush Toilet
- Wood Medicine Cabinet

## STANDARD FEATURES (continued)

### Windows & Doors

- Radius Windows
- Mini-Blinds throughout
- Padded Valance Boxes w/Privacy Sides
- Radius Entry Door(s) w/Window & Deadbolt Lock(s)

### Exterior

- Color-Coordinated Pull-Down Awning
- Modular Wheels w/Radial Tires
- Lighted Storage Area
- EZ-Fold Double or Triple Steps
- Radius Skirt Metal & Matching Fender Skirts (N/A in SE Models)
- Diamond Plate Lower Front (Optional on SE Models)

### Key Construction Details

- One-Piece Seamless Roof w/12 year Warranty
- 2" x 4<sup>1/2</sup>" Truss-Style Crowned Roof System
- Sidewalls, Ceiling and Floor screwed, glued and tied together with steel straps for unmatched Uni-Body strength & resilience
- 2" x 6" Laminated Slide Room Header reinforced w/solid 1/4" x 4" steel plate in Super Slides
- 5/8" Floor Decking screwed and glued
- Hand-cut and glued fiberglass insulation
- Powder-coated Steel I-Beam Frame w/welded Outriggers

### Additional Standards, Lodge Series

- Sliding Patio Door
- 10 Gal Gas DSI/110V Water Heater
- Residential Oven
- 6' 5" Slide Room Height
- Residential Refrigerator
- Detachable Hitch
- Fiberglass Front
- Raised Serving Bar
- 50 Amp Service w/65 Amp Converter w/Charger

## LUXURY PACKAGE

- Electric Awning
- Electric Hitch Jack
- 26" TV OR Electric Stabilizer Jacks

## SUPREME VALUE PACKAGE

- Pleated Shades
- Tub Surround
- Outside Hot & Cold Shower
- Outside Speakers
- Swing-Away Grab Handle
- Pots-N-Pans Drawer

## POPULAR OPTIONS

- Bright Trim Package: Wheel Trim & Polished Bumper Cover, Swing-Away Assist Handle
- Fiberglass "Slick Side" Exterior Walls
- Tri-Fold Hide-A-Bed Sofa (select Slide-Outs)
- 60" Premium Foam Mattress
- 8.0 Cu. Ft. Double Door Refrigerator Upgrade
- Stove Cover; Sink Cover
- 15,000 BTU Air Conditioner in place of 13,500
- 6 Gal Gas DSI/110V Water Heater Upgrade
- Shower Pan in place of Tub
- Sunroom w/Table, 4 Chairs, 3 Vista Windows
- TV Brackets for inside (Bedroom) and Outside
- Swing Arm for TV Brackets
- Spin-Around Entertainment Cntr. (select models)
- Manual or Electric Stabilizer Jacks
- Electric Hitch Jack(s)
- Ceiling Paddle Fan (Lodge Series)
- Fantastic Attic Fan
- Electric Fireplace/Heater
- Outside Kitchen (select models)
- Beauflor Vinyl Flooring Upgrade
- Bedroom Carpet in place of Vinyl
- Fully Enclosed Underbelly
- Kids Kube (32TBHT, 323TBR or 408TBS)
- Bike Rack (select models)
- Roof Rack & Ladder
- Spare Tire w/Carrier & Cover

Why kids love Innsbruck camping: Bunks! 408TBS shown w/optional Kids Kube.



Your New Innsbruck is backed by a 24 Month Warranty



In addition to a standard one-year warranty, Gulf Stream Coach, Inc. offers an exclusive 24 month warranty on structural components.\* In addition, major component manufacturers are providing 24 month warranties on their products installed in Gulf Stream units such as the refrigerator, antenna, furnace, water heater, air conditioner, awning, range, microwave and more. See the official written Gulf Stream Coach, Inc. Warranty for details.

\*For purposes of this warranty, 'Structural Components' shall be limited to the structure of the side walls, front & back walls, roof & floor.

See the newest pictures, floor plans, styles and features from Innsbruck at [www.gulfstreamcoach.com](http://www.gulfstreamcoach.com)



Your Gulf Stream Coach Dealer:



For complete product information see your Gulf Stream Coach Dealer or visit [www.gulfstreamcoach.com](http://www.gulfstreamcoach.com). Gulf Stream Coach, Inc. reserves the right to change or discontinue features, specifications, colors, materials and components at any time without further notice. Not responsible for typographic errors. Photos may show optional features available at additional cost. Experience and review a current model at a Gulf Stream Coach Dealer near you. © 2013 Gulf Stream Coach Inc., Nappanee, Indiana USA. #INN012013