

Sandpiper



DESTINATION SERIES

**SELECT
SERIES**

FIFTH WHEELS







Thank You!

At Sandpiper we appreciate our loyal customers, and want to say "Thank You". To future customers, we would like to extend to you an invitation to become part of the Sandpiper family and experience camping the Sandpiper way.



Upload a photo of you and your Sandpiper on our Facebook page keyword "Sandpiper RV's"



Sandpiper



TV NOT INCLUDED



TV NOT INCLUDED

30IOK

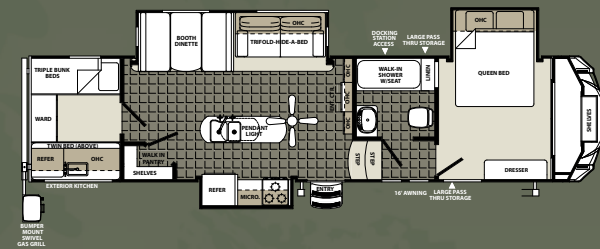

The 30IOK is a great bunkhouse floorplan that includes 4 bunks. It also features an island kitchen with abundant countertop space and a large walk in pantry. This bunkhouse comes complete with an exterior kitchen, a perfect feature for any camp chef. To round out the 30IOK we have included a spacious bath with walk-in shower and glass door, and a large master bedroom with standard queen size bed and large wardrobe.

FEATURES



High rise faucet with undermount sink and solid surface sink covers.



Relax in the comfort of the swivel glider recliners.



Optional theater seats in place of recliners.



Full extension, soft close ball bearing drawer guides.



The fireplace warms and is a great focal point for the living area.



Sandpiper's control center allows you to monitor tanks and other systems quickly and easily.



Serta™ Memory Foam mattress is a Forest River exclusive feature.



32" LED HDTV with AM/FM/CD/DVD player with Bluetooth.



Contemporary ceiling fan.



Control your comfort with the dual zone Dometic thermostat.



The outdoor kitchen is a great feature that allows you to cook a great meal or grab a cold drink while enjoying the great outdoors. (Select models)



Heated and enclosed underbelly protects your coach and improved airflow allows for a sturdier ride.

STANDARDS AND OPTIONS

EXTERIOR FEATURES

- Painted Aerodynamic fiberglass front cap with LED light strips (fifth wheels)
- Colored exterior fiberglass
- Enclosed and heated dump valves
- Docking station: easy winterization, hot and cold spray port, black Tank flush, pull valves for tanks (fifth wheels)
- Large tinted windows with 80/20 UV prohibitor
- Dexter axles with self adjusting brakes
- Hickory Springs™ radius triple steps with 9" riser (no pinched fingers)
- Dometic™ "One-Touch" electric awning with adjustable arms and LED strip light
- Power front jacks with spring loaded snap pins (fifth wheels)
- 15" Radial tires (TT), 16" (FW)
- Automotive-style fender skirts
- Hitch light -travel trailers
- Porch light with interior switch
- 30 lb. double LP tanks with auto change over
- Black tank flush
- 2 exterior speakers
- Rain gutters with extra long drip spouts (prevents black streaking)
- Insulated heavy duty slam lock baggage doors
- Exterior foldable grab handle
- Unobstructed pass-through storage area with cable jacks and 110V outlet (fifth wheels)
- 2 spray ports with 25' hose (one on each side)
- Outside kitchen with swing arm grill standard on 30IOK, 31ZIP, 32QBBS, 357TRIP

INTERIOR FEATURES

- 84" interior height with 6'4" slide heights (fifth wheels)
- Solid surface kitchen countertops
- Four color coordinated interiors
- Raised panel refrigerator insert
- Full extension ball bearing drawer glides
- Serta® memory foam mattress
- Stone cast under mounted kitchen sink
- Handmade cabinetry with screwed lumber core stile construction
- Designer slideout fascia
- Extra large picture windows throughout
- Vented side windows in slideouts
- Digital TV antenna with booster
- 32" Flatscreen LED/HD TV
- Premium sound TV hook-up
- Solid wood drawer fronts with pine sides
- Raised panel cabinet doors (uppers)
- Bedroom slideout fascia
- Shower with glass door (where available)
- Designer window treatment accented per decor
- Overhead cabinet in slideout
- Ceiling fan (fifth wheels)
- LED lighting throughout (fifth wheels)
- Residential stain resistant carpeting
- Center mounted A/C unit for even cooling
- Quilted bedspread
- Shower surround with etched tile pattern
- Tile pattern Beauflor™ linoleum

APPLIANCES/SYSTEMS

- Ducted Dometic® 15K A/C with quick cool
- Sandpiper command center for switches

- Floor ducted 35,000 BTU furnace
- Three burner High output range with 22" oven
- Double door refrigerator
- Interior monitor panel for holding tanks
- Interior digital thermostat for heating and cooling
- Flush floor slideouts (per floorplan)
- Satellite and cable hookup with RG-6 cable for high quality picture
- Porcelain foot flush toilets
- Water heater with quick recovery

CONSTRUCTION

- Welded aluminum-framed, vacuum bonded laminated superstructure
- 3/8" roof decking (full walk-on roof)
- Cambered powder coated frame with rust prohibitor
- Fully enclosed heated underbelly
- 5" truss roof rafters
- R-10 sidewall insulation

FOR YOUR SAFETY

- Smoke alarm
- Fire extinguisher
- Breakaway switch (battery hook-up required)
- Dead-bolt lock on entry door
- Liquid propane (LP) gas detector
- Fire escape windows

POLAR TECH PACKAGE

- Thermal pane windows
- Heated holding tanks
- R-38e roof & all floors insulation
- 40K BTU furnace
- Double fiberglass insulation in roof & floor

POPULAR OPTIONS

- Free-standing dinette with 4 chairs
- Roof ladder
- 50 Amp service (travel trailers)
- Spare tire kit
- Rustic wood plank pattern Beauflor™ linoleum
- Exterior storage bin (FW)
- Hydraulic landing gear (FW)
- Electric stabilizer jacks

SANDPIPER SIGNATURE PACKAGE

- 50 Amp service with 2nd AC prep (fifth wheels)
- Serta memory foam mattress
- 15K BTU air conditioner
- Porcelain foot flush toilet
- Safety glass windows - 80% tint
- Docking station with bypass (fifth wheels)
- High rise faucet
- High gloss fiberglass exterior
- Designer window shades
- Surround sound system
- "One Touch" Dometic electric awning with LED lights
- 8 cu. ft. refer with oak insert
- Full walk on roof
- 32" flat screen television
- Undermount sink
- Jensen am/fm cd/dvd player with bluetooth
- Aerodynamic front cap (fifth wheels)
- Fantastic fan in bathroom
- Designer tile Beauflor™
- Tri-fold hide-a-bed sofa
- Aluminum wheels

DECOR OPTIONS

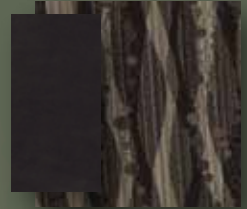

GRANITE INTERIOR



PEWTER INTERIOR



PECAN INTERIOR



WALNUT INTERIOR

Sandpiper

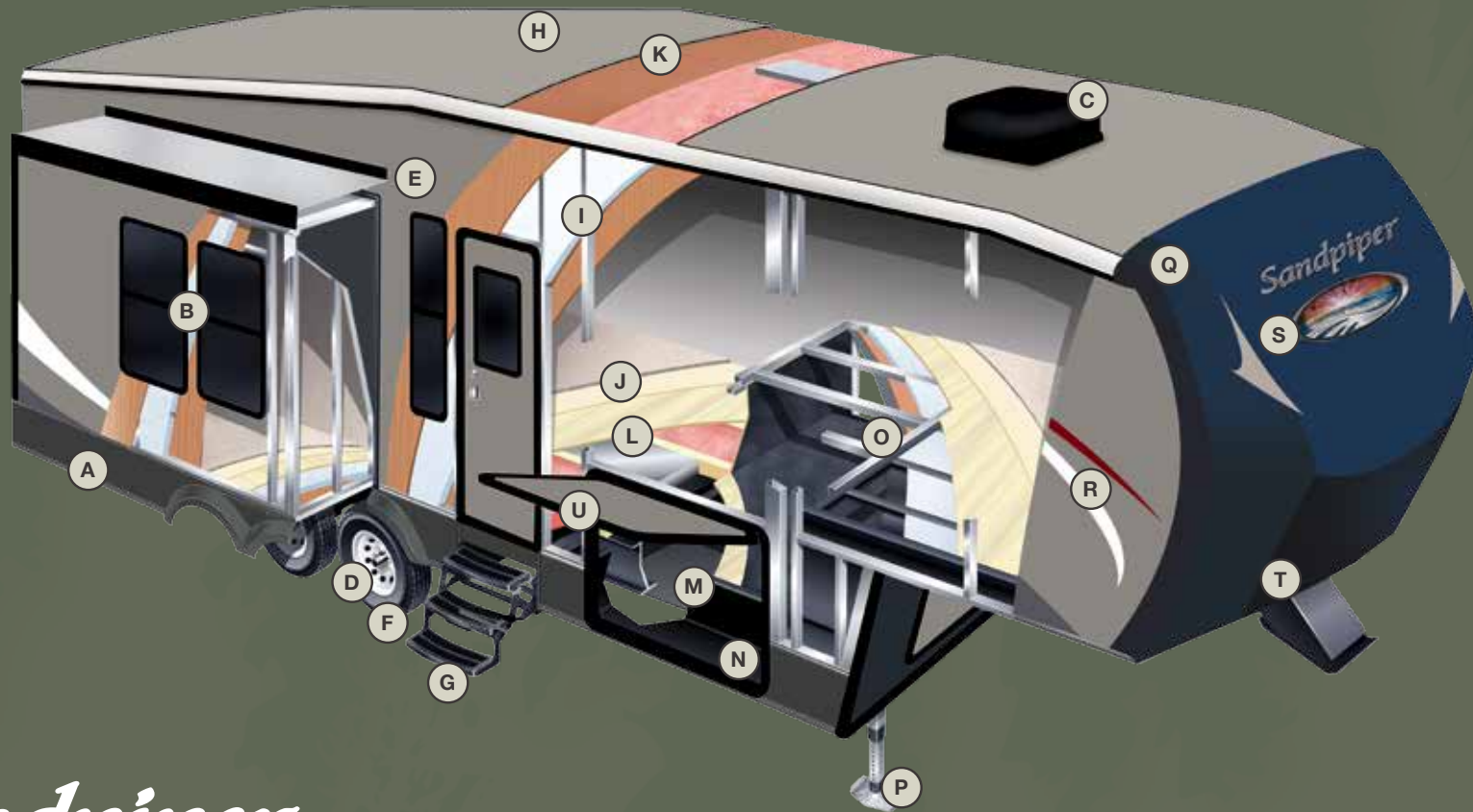

Sandpiper

BUILT TO LAST.

The Sandpiper is built to last using only the best materials to ensure that your coach is in it for the long haul. Careful engineering, well appointed craftsmanship and an uncompromising sense of pride go into every fifth wheel that we produce. Rest assured that your Sandpiper is built for Luxury Living.

- A. ROLLED ALUMINUM SIDE SKIRTING
- B. TINTED SAFETY GLASS WINDOWS (80%)
- C. DUAL ZONE DUCTED 15K BTU AIR CONDITIONING
- D. DEXTER AXLES WITH AUTO ADJUST BRAKES
- E. LAMINATED VACUUM BONDED ALUMINUM SIDEWALLS
- F. E-RATED RADIAL TIRES
- G. HICKORY SPRINGS RADIUS ENTRY STEPS

- H. COLOR MATCHED SEAMLESS RUBBER ROOF (12 YR. WARRANTY)
- I. 2" BLOCK FOAM INSULATION
- J. RESIDENTIAL STAIN RESISTANT CARPET WITH PADDING
- K. 3/8" ROOF DECKING (FULL WALK-ON ROOF)
- L. 5/8" TONGUE AND GROOVE PLYWOOD FLOORING
- M. ENCLOSED, HEATED UNDERBELLY
- N. I-BEAM POWDER-COATED FRAME W/ RUST INHIBITOR

- O. ALUMINUM LAMINATED & INSULATED BATH DECK
- P. POWER FRONT JACKS WITH QUICK RELEASE SNAP PINS (HYDRAULIC OPTIONAL)
- Q. SLEEK RADIUS ROOF
- R. PAINTED COLOR MATCHED HIGH GLOSS GEL-COATED FIBERGLASS EXTERIOR
- S. FRONT GEL-COAT FIBERGLASS CAP (STANDARD)
- T. IMPROVED FRONT CAP FOR SHARPER TURNING RADIUS
- U. INSULATED SLAM LOCK BAGGAGE DOORS

31FK

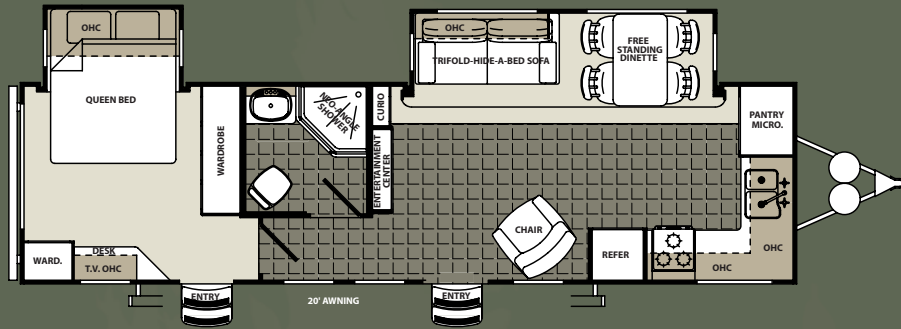

31ZIP

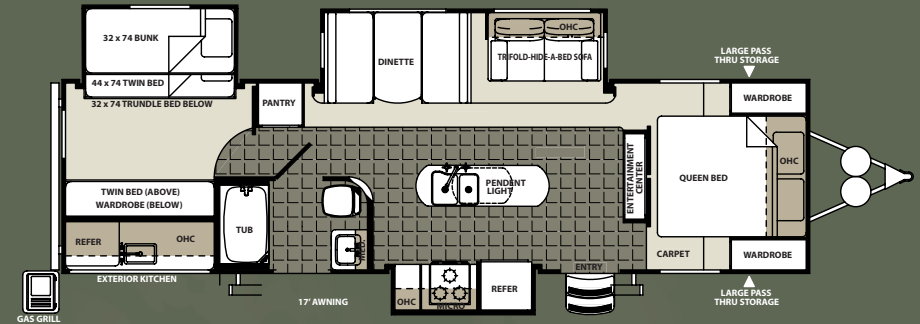

32RE

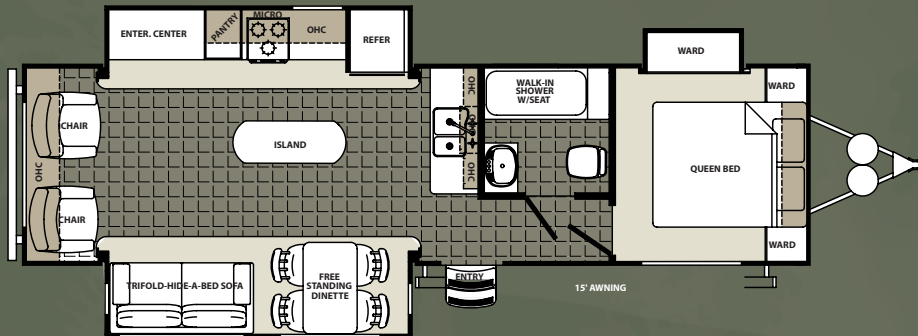

TRAVEL TRAILER SPECIFICATIONS

MODEL	31FK	31ZIP	32RE
Hitch	1,213	871	1,055
Ship	7,745	8,887	9,100
GVWR	11,373	12,871	11,215
Cargo	3,628	3,984	2,115
Length	34' 6"	34' 5"	35' 10"
Height	11' 9"	11' 9"	11' 9"
Awning	20'	21'	14'
Gray	62	67	89
Black	31	35	54
Fresh	42	60	43



25RLS

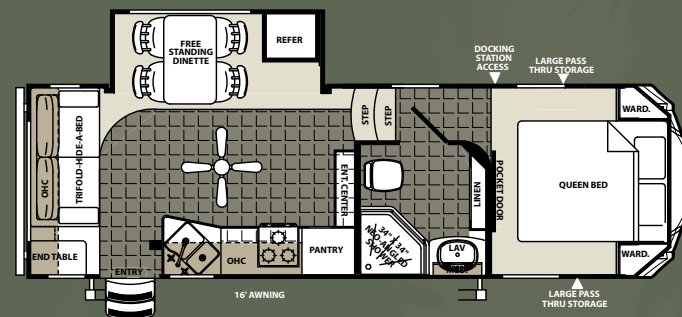

329RE

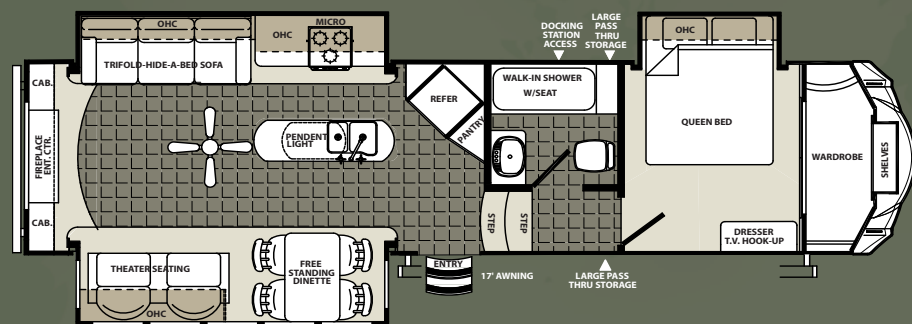

34CK

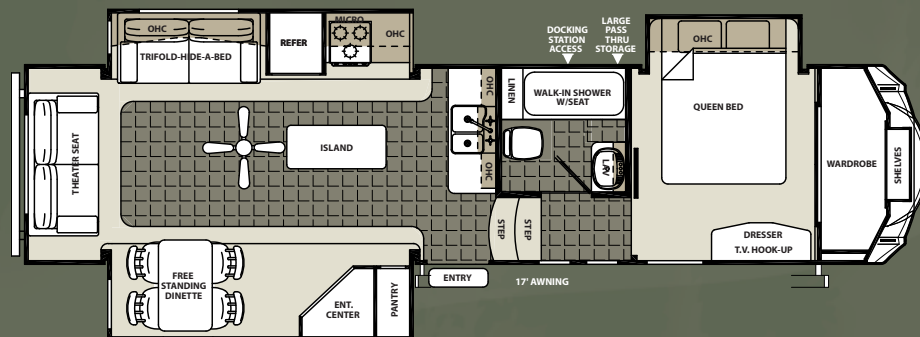

3010K

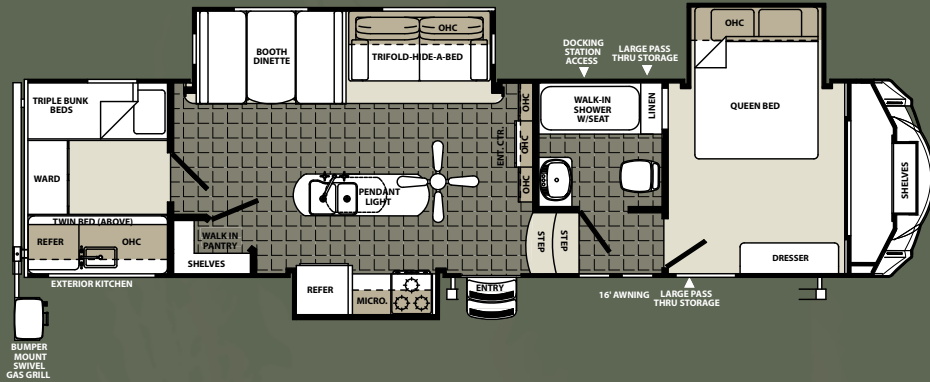

32QBBS

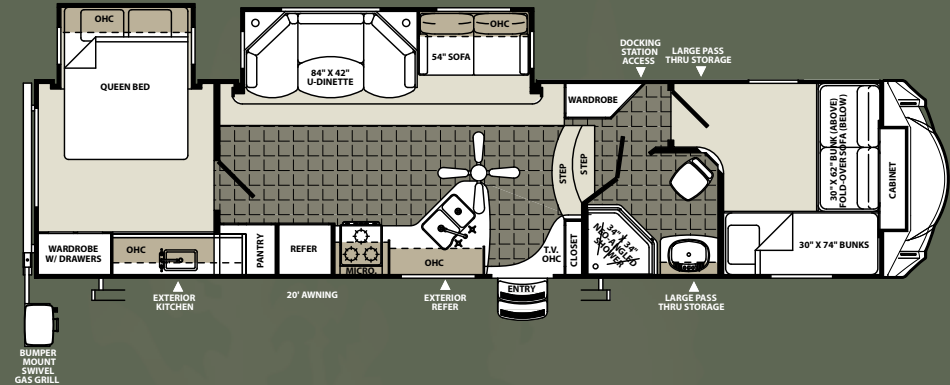

357TRIP

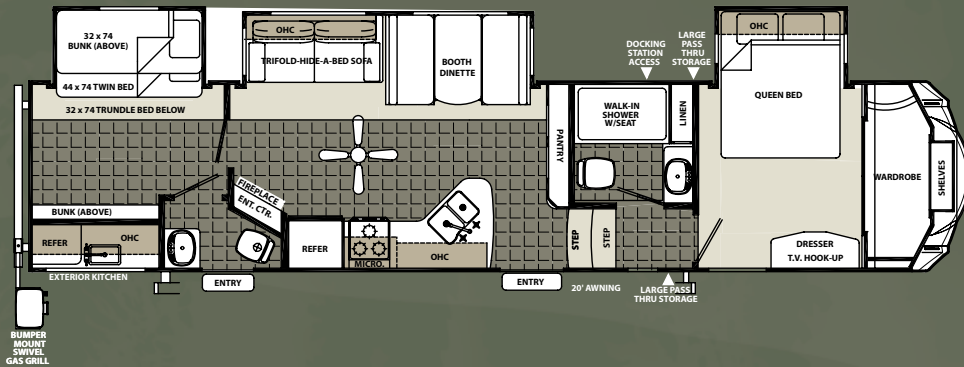

FIFTH WHEEL SPECIFICATIONS

MODEL	25RLS	3010K	32QBBS	329RE	34CK	357TRIP
Hitch	1,472	1,930	1,896	2,218	2,007	1,980
Ship	7,526	10,427	9,000	9,996	10,108	11,189
GVWR	13,472	13,930	13,896	14,218	14,007	13,980
Cargo	5,946	3,503	4,896	4,222	3,899	2,791
Length	29' 0"	37' 11"	36' 11"	36' 3"	39' 11"	40' 3"
Height	12' 6"	12' 6"	13' 0"	13' 3"	13' 2"	13' 2"
Awning	18'	16'	20'	16'	16'	20'
Gray	32	81	62	89	108	135
Black	32	54	31	54	54	108
Fresh	43	43	43	60	60	60

Sandpiper SELECT SERIES



PRE-DELIVERY INSPECTION FACILITY

20,000 square feet of quality assurance. The bare essentials for a premium product. This state-of-the-art facility gives immediate daily feedback to production for quality assurance in every unit built.



Forest River, Inc. encourages our customers to purchase their Forest River products from a local dealership whenever possible for the following reasons:

- 1) Forest River, Inc. dealers are independently owned and operated businesses so priority service and scheduling is at their discretion and is often provided to customers that purchased their unit at that dealership.
- 2) Purchasing locally allows customers to establish meaningful relationships with a dealer, enhancing the RV experience through assistance with product questions, user tips or RV regulations for your state or country, and much more!
- 3) Canadian customers must meet requirements to bring an RV purchased out of the country to their home. These requirements may involve additional inspections and certifications, taxes and fees. Your local Canadian Dealer is a professional at meeting these requirements.
- 4) Scheduling timely warranty repairs and adjustments through a local dealership provides far greater flexibility and convenience to you, the customer!

It is the goal of Forest River, Inc. that all of our RV owners fully enjoy the RV experience and that customer satisfaction meets or exceeds their expectations!

24/7 EMERGENCY ROADSIDE ASSISTANCE

Coach-Net®

For a worry-free ownership experience Forest River includes one year of Coach-Net RV Technical & Roadside Assistance with each RV purchase. Whether new to the RV lifestyle or an experienced RV enthusiast, Forest River owners have 24/7 access to technical, operational and emergency road service coverage throughout the US & Canada. Coach-Net's fast, dependable service is just a phone call away.

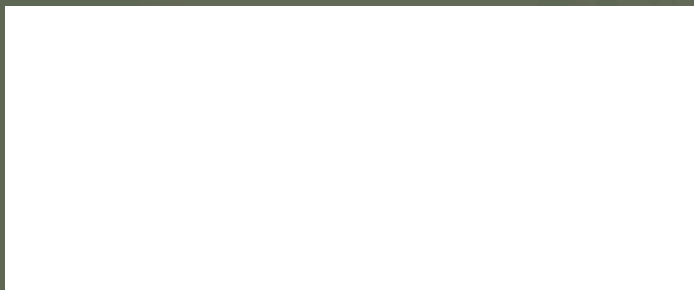

Learn More

Scan this barcode using a QR Reader on your smart phone to learn more about Forest River.



A Berkshire Hathaway company.

Forest River, Inc.
2012 Century Dr.
Goshen, IN 46528
(574) 389-4600
www.forestriverinc.com/Sandpiper
www.forestriveraccessories.com



All specifications herein are based on the latest product information at the time of printing. Forest River reserves the right to make changes in colors, materials, equipment and specifications at any time without notice and assumes no responsibility for any errors in this brochure. The photos in this brochure may show props and/or optional equipment. PLD418

© 2015- Sandpiper- a division of Forest River Inc.
A Berkshire Hathaway company