

HAMPTON

BY CROSS ROADS



HAMPTON

BY CROSS ROADS

CROSSROADS[®]
RECREATIONAL VEHICLES



HT400FL Living Area in Armani Decor



HT400FL Bedroom



HT400FL Kitchen

HAMPTON LIVING

Hampton is the perfect, affordable way to enjoy favorite vacation spots for extended times. Quality building materials, modern construction techniques, residential household appliances, huge amounts of storage with all the conveniences and comforts of home.

FLOOR PLANS

HT380FD



HT380MD

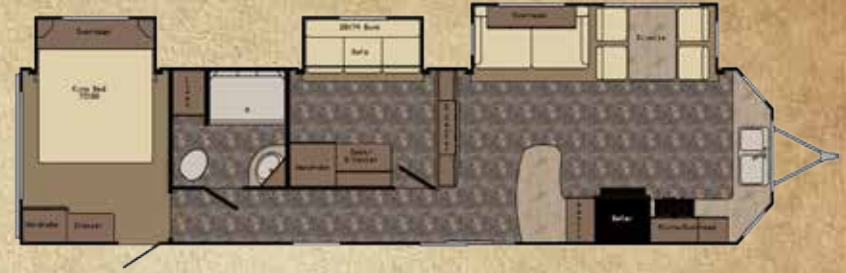

HT380QB



HT400FL



HAMPTON	HT380FD	HT380MB	HT380QB	HT400FL
SHIPPING WEIGHT	11602	11370	11672	10750
GVWR	13872	13598	13368	13182
CARRYING CAP	2270	2228	1696	2432
HITCH WEIGHT	1872	1598	1368	1182
AXLE WEIGHT	9730	9772	10304	9568
EXT LENGTH	40' 10"	43' 0"	40' 11"	43' 1"
EXT. HEIGHT W/AC	12' 8"	12' 8"	12' 8"	12' 8"
FRESH WATER	56	56	56	56
BLACK WATER	40	40	80	40
GRAY	80	80	80	80
TIRE SIZE	235/80R16E	235/80R16E	235/80R16E	235/80R16E



STANDARDS

LIVING ROOM

- *Exterior cable with satellite hookup & booster
- *8' from floor to ceiling height
- *6' 8" headroom in slide-outs
- *Two toned wood fascia
- *Decorative accent lighting
- *Recliner (Varies By Model)
- *AM/FM/CD/DVD player w/Bluetooth
- *Three décor choices
- *TV antenna with cable input
- *HD LED TV
- *Living room tri-fold Hide-a-bed sofa
- *Patio door with swing-out assist rail
- *Power ventilation fan
- *Fireplace

KITCHEN

- *Stainless steel appliances:
18 cu ft. fridge with icemaker;
24" range & 22" microwave
- *Hardwood raised panel cabinet doors
- *Deep stainless steel sink
- *Faucet with pull-out sprayer
- *Residential overhead cabinets with lighting
- *Freestanding table & chairs
- *Full extension ball bearing drawer guides

BEDROOM

- *Armoire
- *TV hook-up
- *Deluxe closet
- *Coordinated window treatments and bedspread

- *Bedroom speakers
- *King sized residential mattress
- *Living room and bedroom ceiling fan
- *Prep for second A/C

BATHROOM

- *Large satin-finish lavatory bowl
- *48" one piece fiberglass tub (VBM)
- *Corner shower with one-piece surround (VBM)
- *Porcelain toilet
- *Linen storage
- *Mirrored medicine cabinet
- *Washer/dryer hook-up (VBM)
- *Power ventilation fan

EXTERIOR

- *Detachable Hitch
- *Tinted glass windows
- *Patio awning
- *Exterior speakers
- *Outside shower

CONSTRUCTION

- *50 amp service
- *One piece radius rubber roof with 12-year manufacturer's warranty
- *3/8" roof decking
- *16" OC truss rafters with 4-1/2" crown
- *Aluminum framed laminated fiberglass sidewalls

- *Rain gutters along entire roof line
- *15,000 BTU ducted A/C wired & prepped for second A/C in master bedroom
- *40,000 BTU floor ducted furnace
- *5/8" floor decking (glued & screwed)
- *16" tires with white rims
- *60"x76" Patio door
- *8' Interior floor width
- *Electric slides throughout
- *Dual LP tank hookup (front and back)
- *PolarTec upgrade insulation package
- *10/16 gallon DSI gas/electric water heater
- *Black tank flush
- *Enclosed insulated underbelly
- *Painted full fiberglass front cap
- *Swing-out entry assist handle at second door

OPTIONS

- *Spare tire and carrier
- *13.5 A/C for bedroom
- *Solid surface counter tops
- *(6) 30" Stabilizer jacks
- *Power Awning

CROSSROADS[®]
RECREATIONAL VEHICLES

Your Authorized CrossRoads Dealer: