

CRUISER



CRUISER

CROSSROADS[®]
RECREATIONAL VEHICLES

CRUISER MODELS

CF305RS



CF315RL



CF326RE



CF333RL



CF362FL



CF368BH



CRUISER	CF305RS	CF315RL	CF322RL	CF326RE	CF333RL	CF345BH	CF362FL	CF368BH
SHIPPING WEIGHT	9624	10084	10544	10352	10538	10897	11224	11280
GVWR	12192	12478	12286	12334	12132	14188	14528	14248
CARRYING CAP	2568	2394	1742	1982	1594	3291	3304	2968
HITCH WEIGHT	1792	2078	1886	1934	1732	2188	2528	2248
AXLE WEIGHT	7832	8006	8658	8418	8806	8709	8696	9032
EXT LENGTH	33' 3"	35' 3"	37' 3"	35' 9"	36' 3"	37' 10"	39' 3"	39' 3"
EXT. HEIGHT W/AC	12' 8"	12' 8'	12' 8"	12' 8'	12' 8"	12' 8"	12' 8"	12' 8"
FRESH WATER	56	56	56	56	56	56	56	56
BLACK WATER	40	40	40	40	40	40	40	40
GRAY	40	80	80	80	80	80	80	80
TIRE SIZE	235/80R16E	235/80R16E	235/80R16E	235/80R16E	235/80R16E	235/80R16E	235/80R16E	235/80R16E

STANDARDS &

STANDARDS

EXTERIOR

- *High gloss laminated sidewalls
- *5-sided Aluma frame construction
- *Aerodynamic front cap with LED accent lights
- *One-piece seamless rubber roof covering
- *Radius roof line
- *Total Truss roof system
- *30" x 72" main entry door
- *Lighted triple entry step
- *Extendable grab handle at main entry
- *EZ lube axles
- *Trail air equa-flex suspension
- *16" nitrogen filled radial tires
- *Galvanized wheel well
- *Outside kitchen (VBM)
- *Super-Stor pass-through basement storage
- *Metal slam latch pass-through baggage doors
- *Electric rear jacks

- *Cable prep and electric outlet in basement
- *Manual slide override extends through frame for easy access
- *Dura-Cam I beam frame
- *Scare light
- *Exterior marine grade speakers (2)
- *Dual battery capacity
- *Battery disconnect
- *Heated and enclosed gate valves
- *ABS Enclosed underbelly
- *Forced heat to underbelly
- *Black tank flush
- *Quick recovery 10gal G/E DSI water heater (19.7 gal/hr)
- *Outside shower
- *Exterior utility center
- *50amp detachable power service
- *2nd AC prep
- *Cable/SAT prep
- *Digital TV antenna
- *Outside grill prep
- *Roof ladder

INTERIOR

- *LED lights through out interior
- *Lumber core screwed stile cabinetry construction
- *Raised panel cabinetry throughout
- *70-lb steel ball bearing guides, full extension
- *Solid wood drawer construction
- *Hardwood mullion style fridge front
- *Extendable free standing table and chairs
- *Self igniting 22" oven with 3-burner cook top
- *Range cover
- *Knife rack
- *Adjustable pantry shelving
- *Pull out kitchen faucet
- *Stainless steel kitchen sink w/sink cover
- *Maximum lino
- *Tri-Fold hide-a-bed sofa
- *Rocker recliner chairs (VBM)
- *Deluxe theater seating (VBM)
- *Ceiling fan
- *Fireplace w/remote
- *Slideout sidewall light (VBM)
- *Charging station



CF345BH Living Area

OPTIONS

- *OHC above sofa/chairs in slideout
- *Decorative wood slide fascias
- *Water heater by-pass kit
- *EZ winterization kit
- *Backlit command center for switches
- *65amp converter with distribution center
- *Bath skylight
- *Built medicine cabinet
- *Glass tub/shower enclosure
- *Deluxe bedding package
- *Full trunk under bed storage
- *Plywood bed base with strut assist
- *Spacious bedroom closets
- *Washer/dryer prep (VBM)
- *Fire extinguisher
- *LP/CO2 detector
- *Smoke detector

SELECT PACKAGE (MANDATORY)

- *8cu ft refer
- *12v Multi-media sound system
w/Bluetooth

- *Black Label furniture
- *Deluxe soft pull roller shades
- *Dark tinted safety glass windows
- *Glazed maple cabinetry
- *Interior safety step light
- *Interior grab handle
- *Dual 30# lb tanks w/auto changeover
- *Porcelain toilet with foot flush
- *32" – 46" LED TV in living area (VBM)
- *Microwave
- *10 gal G/E DSI water heater
- *35,000 btu furnace
- *15K ducted air system with quick cool
- *Spare tire
- *Solid surface kitchen countertops
- *Polartec insulation package
- *Aluminum rims
- *Vetro high gloss sidewalls
- *Electric awning with LED light
- *Trail Air roto-flex pin box
- *Equa flex suspension
- *Correct track alignment system
- *i-Cool Mattress (60"X80")

- *Rear hitch receiver
- *2nd power awning with LED lights (VBM)
- *Maxx Aire fan w/ rain sensor in kitchen

OPTIONS

- *12 cu.ft. Side by side refer (362FL & 363MB)
- *Bumper mount grill
- *Insulated windows
- *Rear fiberglass cap
- *Painted exterior (requires rear cap)
- *2nd AC (low-profile 13.5)
- *Maxx Aire fan in livingroom (362FL)
- *Maxx Aire fan w/ rain sensor in bathroom
- *King bed IPO queen (322RL)
- *Free standing table and chairs
with recliner (345BH)
- *Carpet in living area
- *32" TV in bedroom
- *Slide awning package
- *Ground control 3.0 electric auto
leveling system



CF326RE Living Area in the Latte Decor

CRUISER

Over the years, the Cruiser has evolved to continually meet and exceed our customers' expectations. It's all about livability and high end features. Let Cruiser redefine your home away from home. Our Standard is loaded!



CF322RL in the Espresso Decor



CF322RL Kitchen



Bedroom in a CF326RE

With Cruiser...
you can have
more.



CF322RL Kitchen in the Espresso Decor



CF362FL Living Room in Espresso Decor

Luxurious
touches
at every turn.



CF362FL Dining Area



Bathroom in the CF362FL



Kitchen in the CF362FL

OPTIONS

- *Thermotec insulation package
- *Aluminum rims
- *Vetro high gloss sidewalls
- *Electric awning with LED light
- *Correct track alignment system
- *1-Cool mattress (60"X80")
- *Rear hitch receiver
- *Electric rear jacks (FW)
- *Electric tongue jack (TT)
- *Electric stab jacks (TT)

OPTIONS

- *Bumper mount grill
- *Insulated windows
- *50amp service with 2nd A/C Prep
- *2nd A/C (low-profile 13.5)
- requires 50amp w/ 2nd A/C prep
- *Recliners ILO swivel rockers (VBM)
- *Free standing table and chairs
- *Solid surface countertops

- *Fire extinguisher
- *LP/CO2 detector
- *Smoke detector

SELECT PACKAGE (MANDATORY)

- *8 cu ft refer
- *12v Multi-media sound system
- w/Bluetooth
- *Black Label furniture
- *Deluxe soft pull roller shades
- *Dark tinted safety glass windows
- *Glazed maple cabinetry
- *Dual 30# lb tanks w/auto changeover
- *Porcelain toilet with foot flush
- *32" TV in living area
- *Microwave
- *35,000 BTU furnace
- *15K ducted air system with quick cool
- *Spare tire

- *Stainless steel kitchen sink w/sink cover
- *Charging station
- *Maximum lino
- *Tri-Fold hide-a-bed sofa
- *Swivel rocker chairs (VBM)
- *Slideout sidewall light (VBM)
- *OHC above sofa/chairs in slideout
- *Decorative slide fascias
- *Water heater by-pass kit
- *EZ winterization kit
- *Backlit command center for switches
- *65amp converter with distribution center
- *12-volt bath power vent
- *Bath skylight
- *Built medicine cabinet
- *Glass tub/shower enclosure
- *Deluxe bedding package
- *Full trunk under bed storage
- *Bed base with strut assist
- *Spacious bedroom closets



Bunks in a CAT32BH



CAT32BH Bunk Room

STANDARDS &

STANDARDS

EXTERIOR

- *High gloss laminated sidewalls
- *5-sided Alumina frame construction
- *Aerodynamic front cap with LED accent lights
- *One-piece seamless rubber roof covering
- *Radius roof line
- *Domed roof line (front to back-TT)
- *Total Truss roof system
- *30" x 72" main entry door
- *Lighted triple entry step
- *Extendable grab handle at main entry
- *EZ lube axles
- *Trail air equa-flex suspension
- *Nitrogen filled radial tires
- *Galvanized wheel well
- *Outside kitchen (VBM)
- *Super-Stor pass-through basement storage (FW)



CAT29RS Kitchen with Optional Solid Surface Counter Top

*Manual slide override extends through

- *Dura-Cam I beam frame
- *Exterior marine grade speakers (2)
- *LP cover (TT)
- *Battery disconnect (FW)
- *ABS Enclosed underbelly
- *Forced heat to underbelly
- *Black tank flush
- *Quick recovery 6gal G/E DSI water heater (17.8 gal/hr)
- *Outside shower
- *30amp detachable power service
- *Cable/SAT prep
- *Digital TV antenna
- *Stabilizer jacks
- *Outside grill prep
- *Roof ladder
- *Metal slam latch pass-through baggage doors

INTERIOR

- *LED lights through out interior
- *Lumber core screwed stile cabinetry construction
- *Raised panel cabinetry throughout
- *70-lb steel ball bearing guides, full extension
- *Solid wood drawer construction
- *Hardwood mullion style fridge front
- *Decorative dinette light
- *40" booth dinette (VBM)
- *U-dinette with snap up table (VBM)
- *Plywood dinette base
- *Self igniting 22" oven with 3-burner cook top
- *Range cover
- *Knife rack
- *Adjustable pantry shelving
- *High definition laminate countertops
- *High rise kitchen faucet



Outdoor Kitchen on a CAT32BH

FLOOR PLANS



CAF27RL



CAF28SE

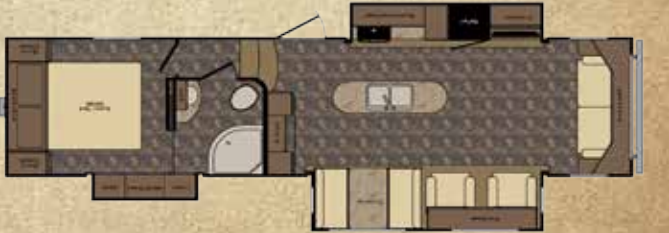

CAF29RS



CAF28RK

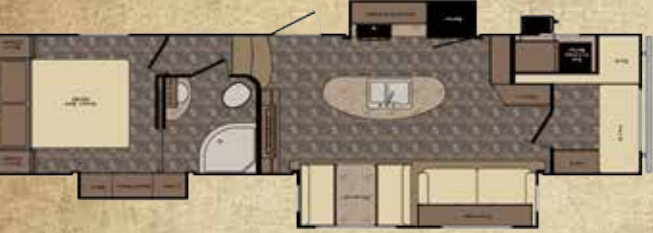

CAF29BH

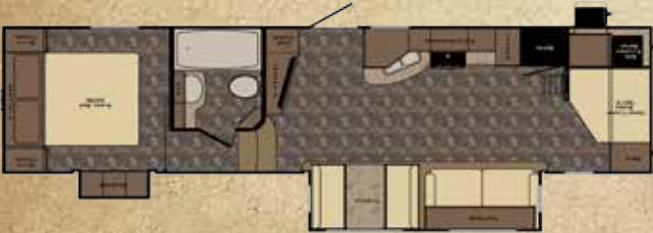

CAF30BH



Hutch in a CAF29RS



Living Area in a CAF29RS in the Cappuccino Decor

DISCLAIMER: Product information is as accurate as possible at the date of publication of this brochure. All features, floorplans, and specification in this brochure are subject to change without notice. Please also consult Crossroads RV's website at www.crossroadsw.com for more current product information and specifications. Tow Vehicle Disclaimer: CAUTION: Owners of Crossroads recreational vehicles are solely responsible for the selection and proper use of tow vehicles. All customers should consult with a motor vehicle manufacturer or their dealer concerning the purchase and use of suitable tow vehicles for Crossroads RV products. Crossroads RV disclaims any liability or damages suffered as a result of the selection, operation, use or misuse of tow vehicle. CROSSROADS RV'S LIMITED WARRANTY DOES NOT COVER DAMAGE TO THE RECREATIONAL VEHICLE OR TOW VEHICLE AS A RESULT OF THE SELECTION, OPERATION, USE OR MISUSE OF THE TOW VEHICLE.

TIRE SIZE	225/75R15D	225/75R15D	225/75R15D	225/75R15D	225/75R15D	225/75R15D	225/75R15D	225/75R15D	225/75R15D	225/75R15D	225/75R15D	225/75R15D
GRAY	80	80	80	80	80	80	80	80	80	80	80	80
BLACK WATER	40	40	40	40	40	40	40	40	40	40	40	40
FRESH WATER	56	56	56	56	56	56	56	56	56	56	56	56
EXT. HEIGHT W/AC	11' 2"	11' 2"	11' 2"	11' 2"	11' 2"	11' 2"	11' 2"	11' 2"	11' 2"	11' 2"	11' 10"	12' 0"
EXT LENGTH	32' 4"	35' 11"	35' 11"	36' 6"	29' 11"	31' 11"	30' 11"	32' 11"	32' 11"	32' 11"	33' 11"	33' 11"
AXLE WEIGHT	6245	7233	7213	7379	6801	6769	6851	7119	7159	7159	6949	6949
HITCH WEIGHT	682	826	824	904	1018	1612	1580	1826	1828	1828	1566	1566
CARRYING CAP	3915	2927	2947	2781	3359	3391	3309	3041	3001	3001	3211	3211
GVWR	10842	10986	10984	11064	11178	11772	11740	11986	11988	11988	11726	11726
SHIPPING WEIGHT	6927	8059	8037	8283	7819	8381	8431	8945	8987	8987	8515	8515
CRUISER AIRE	CAT29BH	CAT31RE	CAT32BH	CAT33RE	CAF27RL	CAF28RK	CAF28SE	CAF29BH	CAF29RS	CAF30BH		

Kitchen and Entertainment Center in a CAF28SE



CAF28SE Bedroom



CAT33RE



CAT32BH



CAT31RE



CAT29BH

CRUISER AIRE

CRUISER AIRE



CRUISER
AIRE