

NEWMAR | 2015 ESSEX



2015

# ESSEX

LUXURY MOTOR COACH



WHEN YOU KNOW THE DIFFERENCE <sup>SM</sup>

---

## MAGNIFICENCE BY THE MILE

It's only natural to want more. To strive to go higher, faster and farther than you ever dreamed possible. It's for those assured travelers that Newmar has designed the 2015 Essex. More powerful than ever, thanks to a 600HP Cummins ISX diesel engine. More versatile than ever, with your choice of standard Spartan K3 Tag Axle or optional Freightliner chassis for incredible carrying capacity and an amazingly smooth ride. More comforts than ever, including

advanced residential conveniences and Newmar's peerless craftsmanship. And more gorgeous than ever, with a sleek, stunning exterior showcased by all-new graphics and the exquisite Full-Paint Masterpiece™ Finish. This is luxury by popular demand, based on Newmar listening carefully to the needs of countless owners and exceeding their expectations at every turn. With our finest Essex yet, their wishes—and yours—have come true.

“

With Essex, Newmar makes another definitive statement on how best to combine luxury and performance.”

Essex

NEWMAR



---

## 2015 ESSEX

*A Gorgeous Way To Go*

How can something as substantial as the 2015 Essex be so nimble on the road? Credit Newmar's exclusive Comfort Drive™ Steering that takes the chore out of driving long distances. Along with an optional Safety Cruise collision avoidance that lets you potentially glide for hours without ever touching the brakes. Smooth move, indeed.

- Exterior Masterpiece™ Finish Full Painted Graphics with Cut & Buff
- Spartan® K3 Tag Axle Chassis with 600HP Cummins ISX Engine
- Cummins Onan® 12.5 Quiet Diesel™ Generator
- Optional Freightliner® Chassis



WHEN YOU KNOW THE DIFFERENCE <sup>SM</sup>









DUNE DÉCOR STYLE AND GINGER GLAZED CHERRY CABINETRY - FLOORPLAN 4568





---

## AN INTERIOR THAT SPEAKS VOLUMES

The 2015 Essex is a standing invitation to take a seat. With plush furnishings throughout, options for relaxation include captain and passenger chairs that swivel and recline, Ultra Leather furniture with two-toned accents, and a extenda flex dinette ensemble that comfortably seats four for breakfast or bridge.

And every seat is theatre-quality when it's time for big-screen entertainment from the 48" Sony® televisor display, situated in perfect view of a guest-sized sofa.

- Sony® 48" LED HDTV on televisor\*
- Ultra Leather extenda flex dinette\*
- Power duo day/night privacy window shades
- Villa sofa and driver/passenger seats with power footrest

\*Optional

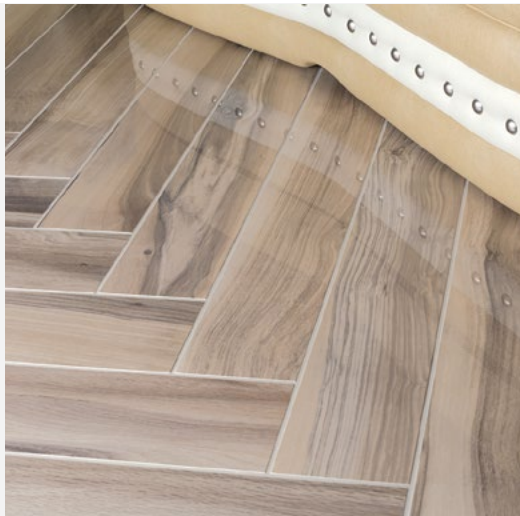



“

A kitchen where  
all the ingredients  
are fresh.”



## WHERE STYLE AND FUNCTION MEET

A spacious residential-style Essex kitchen completes the illusion of being at home, with high-end appliances and unexpectedly vast storage, carefully nestled into deep cabinets and roomy pull-out drawers. The large stainless steel sink even includes a Delta Touch Faucet for convenient operation with the merest tip of a finger.

Adding to the elegance: a decorator backsplash with LED accent lighting and new cloth-shaded LED wall sconces custom-designed for Newmar.

- Polished solid surface countertop with single bowl stainless steel sink
- Ginger Glazed Cherry hardwood unitized cabinets
- Delta Touch Faucet in kitchen
- GE® stainless steel microwave with convection\*

\*Optional



## ROOMY AND REFINED

Your comfort is customized within the peaceful confines of the Essex master bedroom. A king size Sleep Number® bed, topped with quilted spread and decorator scarf, lets you adjust mattress firmness beneath a beautiful canopy illuminated to your personal specifications.

Your mastery of the environment continues with the included Sony® Z Tablet, a 10" hand-held that lets you command the room's Sony® HDTV and Bose® Solo sound bar, interior lighting, window shades, and the Silverleaf multiplex coach control system.

- King size bed with Sleep Number® control mattress
- Sony® 40" LED HDTV with Blu-Ray® player
- Bose® Solo TV sound system
- Sony® tablet with Silverleaf® multiplex control app

**SONY®**





---

## SUBLIMELY SATISFYING

The spirit of a spa inspires the relaxing ambiance you'll discover in the master bath of the 2015 Essex. A newly designed shower features multiple body sprays, plus the option to switch between stationary and hand-held spray heads.

Outside the shower, a handsome double vanity has integrated polished solid surface sinks for a seamless look. And new vanity lighting helps add some bright appeal to the unit's handy half-bath.

- Floor-to-ceiling custom designed mosaic tiling in shower
- Demand water system
- Dual solid surface bathroom vanity sinks
- Fold down teak shower seat\*
- Body Sprays in Shower Walls

\*Optional





“

Essex embodies polish and sophistication everywhere you look.”





MALIBU EXTERIOR - FLOORPLAN 4568



---

## EXCELLENCE IS NEVER AN EXTRA

The astonishing surprises never stop with the new Essex. Like the Girard® name on all awnings, including the illuminated patio canopy. Storage compartments that are among the largest in the industry. A Rand McNally navigation system that adapts your route to your vehicle's capabilities. And so much more.

In fact, there's only one way to truly appreciate everything Essex has to offer. And that's to discover it for yourself.

- Exterior entertainment center with Bluetooth-compatible sound bar
- Optional Power silhouette window shades
- Optional Sunforce flexible solar panels on roof
- Rear docking lights to assist tow vehicle hookup at night



# EXTERIOR DECOR



---

MALIBU EXTERIOR



---

NEO EXTERIOR



---

KNOLL EXTERIOR



---

DUSK EXTERIOR

# INTERIOR DECOR

# WOOD OPTIONS

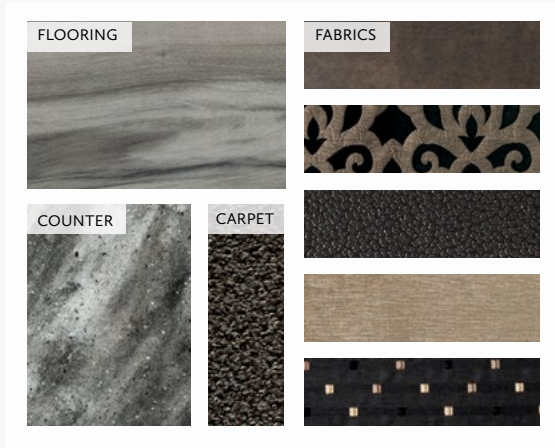

TWILIGHT INTERIOR

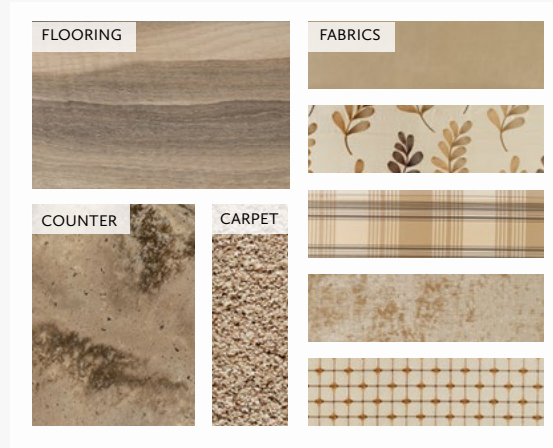

DUNE INTERIOR

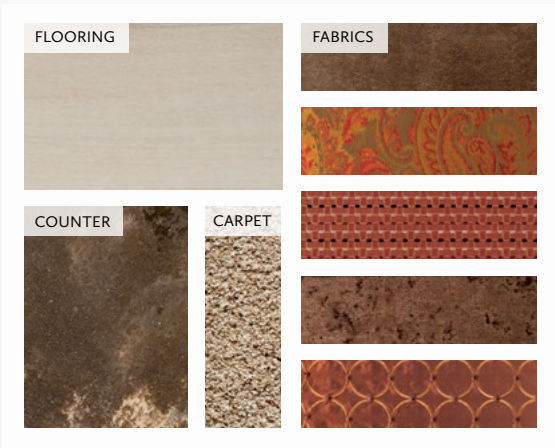

MATRIX INTERIOR

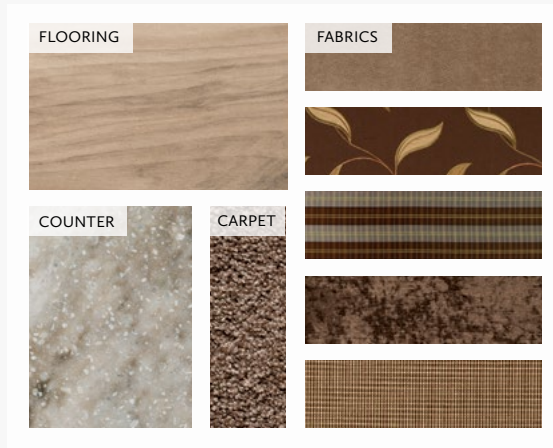

VENTURA INTERIOR



CARMEL GLAZED CHERRY



GINGER GLAZED CHERRY W/ HIGH GLOSS



MANHATTAN GLAZED MAPLE W/ HIGH GLOSS



SABLE MAPLE

# FLOOR PLANS

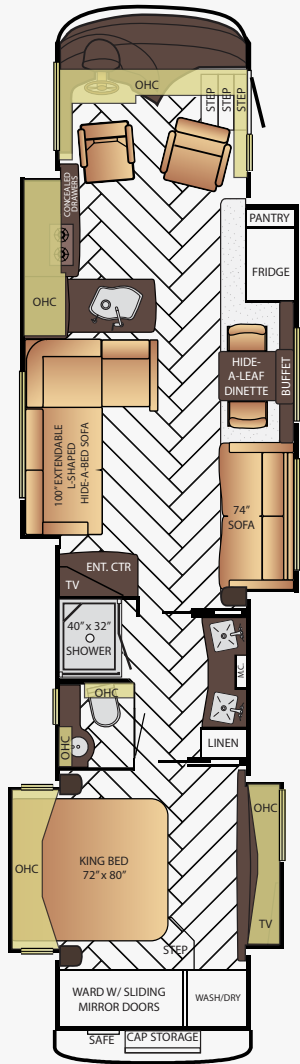

## 4501

App. Overall Length	44'11"
Width	101.5"
App. Overall Height	13'4"
Interior Width	95.5"
Interior Height	84"
Grey Tank	80 gal.
Sewage Tank	60 gal.
Water Tank	105 gal.
Propane Tank	22 gal.
Furnace	50,000 btu

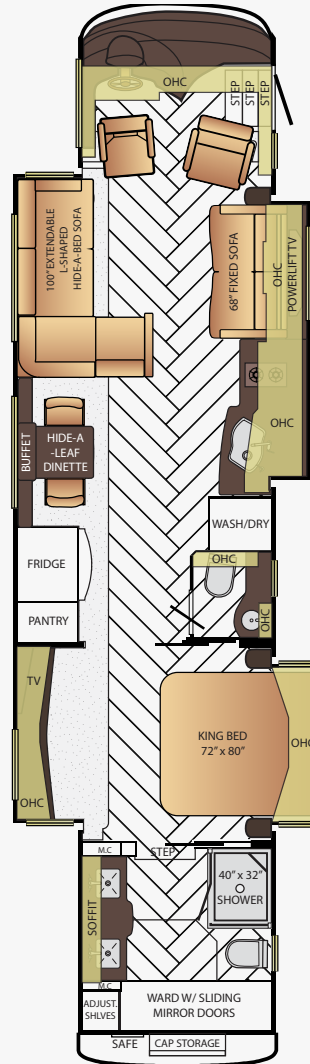

## 4503

App. Overall Length	44'11"
Width	101.5"
App. Overall Height	13'4"
Interior Width	95.5"
Interior Height	84"
Grey Tank	80 gal.
Sewage Tank	60 gal.
Water Tank	105 gal.
Propane Tank	22 gal.
Furnace	50,000 btu

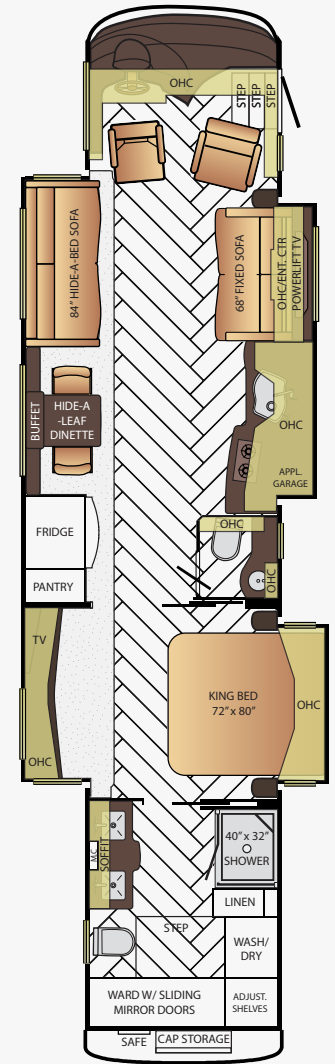

# FLOOR PLANS

## 4553

App. Overall Length	44'11"
Width	101.5"
App. Overall Height	13'4"
Interior Width	95.5"
Interior Height	84"
Grey Tank	80 gal.
Sewage Tank	60 gal.
Water Tank	105 gal.
Propane Tank	22 gal.
Furnace	50,000 btu

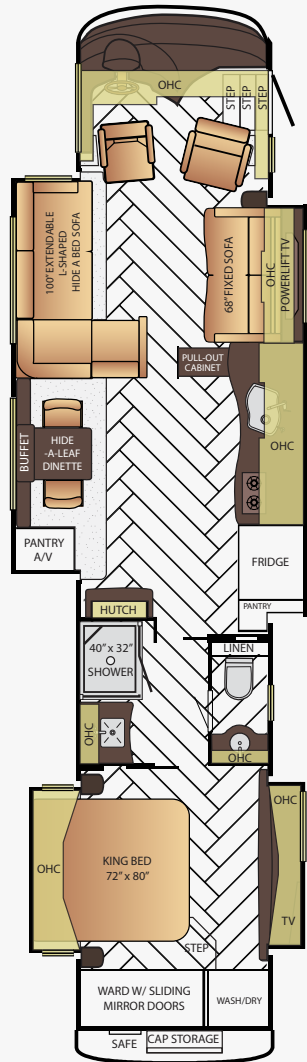

## 4568

App. Overall Length	44'11"
Width	101.5"
App. Overall Height	13'4"
Interior Width	95.5"
Interior Height	84"
Grey Tank	80 gal.
Sewage Tank	60 gal.
Water Tank	105 gal.
Propane Tank	22 gal.
Furnace	50,000 btu

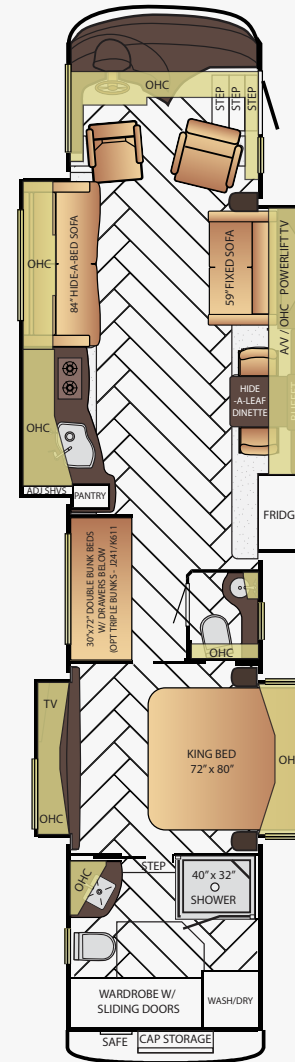

## 4599

App. Overall Length	44'11"
Width	101.5"
App. Overall Height	13'4"
Interior Width	95.5"
Interior Height	84"
Grey Tank	80 gal.
Sewage Tank	60 gal.
Water Tank	105 gal.
Propane Tank	22 gal.
Furnace	50,000 btu

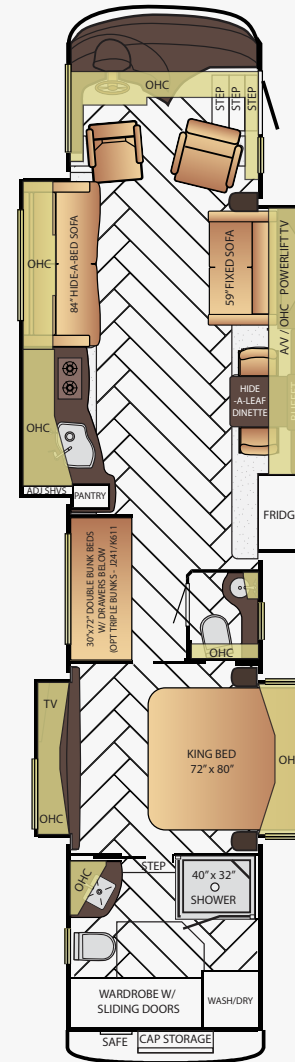

# CONSTRUCTION & CHASSIS SPECIFICATIONS



Standard



Driven By You

Optional



Comfort Drive™  
STEERING

LIKE A FINE HOME, Essex is framed 16 inches on center, allowing the best placement of outlets, switches and other components. Newmar uses only Sikaflex elastic adhesive throughout Essex's construction – one of the strongest bonding agents available. It seals against air and water and

helps dampen sound and vibration. Electrical wiring holes in Essex's aluminum frame are ringed with plastic grommets to protect wires from chafing. And Newmar's Total Comfort™ Central Air is two separate, fully ducted systems that distribute cool air and remove warm air.

**ROOF R-VALUE = 24**

- a. Fiberglass Roof
- b. Fiberglass Batten Insulation
- c. A/C Ducting
- d. Aluminum Rafter Framing
- e. Kraft Paper Vapor Barrier
- f. 5/8" Bead Foam
- g. 3/16" Panel
- h. Padded Vinyl Overlay

**SIDEWALL R-VALUE = 11**

- i. 3/16" Plywood Interior Wall
- j. 5/8" Bead Foam
- k. Kraft Paper Vapor Barrier
- l. Fiberglass Batten Insulation
- m. 3/16" Plywood Exterior Wall
- n. Composite One-Piece Gelcoat Exterior Sidewall
- o. Aluminum Framing with 3 1/2" Header Above

**FLOOR R-VALUE = 16**

- p. Carpet/Tile
- q. Carpet Padding
- r. 5/8" Floor Decking
- s. Fiberglass Batten Insulation
- t. 2"x 3" Wood Framing
- u. Polyethylene Moisture Barrier

**BASEMENT R-VALUE = 4**

- v. Cargo Liner
- w. 3/8" Floor Decking
- x. 3/16" Luan Panel
- y. 1 1/2" Bead Foam
- z. Aluminum Sheeting with Steel Support Rails to Prevent Bowing and Flexing

- 1. 15M Penguin™ Heat Pump Central Air Conditioners (3)
- 2. One-Piece Bonded Windshield
- 3. Coated Aluminum Wheels
- 4. Frameless, Double-Pane, Tinted Safety-Glass Windows
- 5. Side-Hinged Baggage Doors

Floor Plan	Engine HP	Axle Ratio	Fuel Cap.	Wheel Base	Front GAWR*	Rear GAWR*	Tag GAWR*	GVWR*	GCWR*	App. UVW	App. NCC
4501	600	4.30	150 gal.	292+TAG	20,000 lb.	20,000 lb.	14,000 lb.	54,000 lb.	69,000 lb.	44,100 lb.	9,900 lb.
4503	600	4.30	150 gal.	292+TAG	20,000 lb.	20,000 lb.	14,000 lb.	54,000 lb.	69,000 lb.	44,700 lb.	9,300 lb.
4553	600	4.30	150 gal.	292+TAG	20,000 lb.	20,000 lb.	14,000 lb.	54,000 lb.	69,000 lb.	44,700 lb.	9,300 lb.
4568	600	4.30	150 gal.	292+TAG	20,000 lb.	20,000 lb.	14,000 lb.	54,000 lb.	69,000 lb.	43,600 lb.	10,400 lb.
4599	600	4.30	150 gal.	292+TAG	20,000 lb.	20,000 lb.	14,000 lb.	54,000 lb.	69,000 lb.	43,600 lb.	10,400 lb.

Lengths, heights, widths and dry weights are approximate. Weight will vary based on optional equipment added to the above base weight.

**GAWR:** Gross Axle Weight Rating is the maximum permissible weight for an axle.

**GVWR:** Gross Vehicle Weight Rating is the maximum permissible weight for a fully loaded motor coach.

**GCWR:** Gross Combination Weight Rating is the value specified by the manufacturer of the vehicle as the maximum allowable loaded weight of this motor coach and any towed trailer or towed vehicle.

**UVW:** Unloaded Vehicle Weight is the weight of this motor coach as built at the factory with full fuel, engine oil and coolants. The UVW does not include cargo, fresh water, propane gas or dealer-installed accessories.

**NCC:** Net Carrying Capacity is the maximum weight of all occupants, including the driver, personal belongings, food, fresh water, waste water, propane gas, tools, tongue weight of towed vehicle, dealer-installed accessories, etc., that can be carried by the motor coach.

\*Specifications supplied by the chassis manufacturer.

# FEATURES & OPTIONS



## Chassis Features

*Built specifically for Newmar with the highest quality in handling, safety, performance and dependability.*

- Spartan® K3 Tag Axle Passive Steer Chassis with 600Hp Cummins® ISX Engine\*
- Allison® 4000 MH Transmission
- Comfort Drive™ Steering with Power Column and Adjustable Control
- Alcoa Dura-Brite™ Aluminum Wheels
- Hydraulic Leveling Jacks
- Power Tilt-and-Telescope VIP Smart Wheel®
- Memory Settings for Drivers Seat, Pedals, Steering Column and Mirrors
- Recessed Fuel Fills with Crossover to Fill from Either Side
- Back-Up Alarm
- Anti-Lock Braking System
- Electronic Chassis Information Display in Dash
- Tire Pressure Monitor System
- Air Leveling Control System
- Trip Travel Information, Displayed onto Rear View Monitor Screen

### OPTIONS

- Vorad® Adaptive Cruise System
- Freightliner® Tag Axle SLR Chassis with 600Hp ISX Cummins Engine & Passive Steer Tag\*



## Air Conditioning & Heating

*Total Comfort Air Conditioning and Hydronic Zone Heating systems make climate control simple and effective.*

- Three 15M Penguin™ Heat Pump Central Air Conditioners with Remote Control Thermostat
- Hydronic Zone Diesel Heating System
- Driver/Passenger Dash Overhead Ventilation System
- Roof Air Conditioning Drainage System

### OPTIONS

- Electric Heat Under Floor Tile



## Appliances

*All of the amenities of a fine home are integrated in the Newmar design, in form and capabilities.*

- 30" Convection Microwave Oven with Two-Burner Gas Cooktop
  - Whirlpool® Two-Piece Stacked Washer/Dryer
  - Whirlpool® Stainless Steel 19.8 Cf. Refrigerator with Icemaker and Water Dispenser
  - Dometic Freezer on Pullout Tray in Exterior Compartment
- ### OPTIONS
- 30" GE® Advantium Microwave
  - All Electric Operation with Flush Cooktop and Two Extra Batteries
  - All Electric with Flush Kenyon Cooktop and Two Extra Batteries
  - Central Vacuum with Tool Kit
  - Dishwasher in a Drawer Below Cooktop



## Audio, Video, & Accessories

*Stay entertained on the road and off, with spectacular visual and sound options from industry leaders.*

- Sony® 48" LED TV on Televator in Living Area\*
  - Sony LED TV and Blu-Ray DVD Player in Living and Bedroom Areas\*
  - Sony® Surround Sound System with Sub-Woofer
  - Bose® Solo Speaker with Bluetooth® Adapter in Bedroom
  - SIRIUS® Satellite Capability with Antenna (Does not Include SIRIUS® Monthly Subscription)
  - Dash Radio with Touch Screen Navigation and Dual Monitors
  - High Definition Component Wiring
  - Infra-Red Repeater System
  - Satellite Dish Prep on Roof
  - Winegard Power Lift Digital TV Antenna
  - Cellular Remote Access
  - Sony® Tablet with Control of AV Equipment, Lights, Shades, Keyless Entry and Silverleaf App
  - Wireless Router
- ### OPTIONS
- Sony® 40" LED TV in Front Overhead Cabinet
  - Sony® 48" LED TV on Televator\*
  - Remote-Controlled Rearview Color Camera
  - Exterior Entertainment Center Located in Sidewall with Sony® 40" LED TV and Soundbar

- External Entertainment Center Located in Storage Compartment with Sony 40" LED TV and Soundbar
- Security System
- 11" LCD Flip Down Monitor/DVD Player with Headphone, One at Each Bunk\*
- Extra Monitor for Navigation on Passenger Side
- Satellite Dish Without Receiver\*



## Cabinets & Furniture

*Amish craftsmanship and elegance in design meld the wood cabinetry and furniture seamlessly with the Newmar interior.*

- Sable Maple Hardwood Unitized Cabinets with Fully Overlayed Cabinet Doors
- Polished Solid Surface Countertop in Kitchen with Single Bowl Stainless Steel Sink Covers
- Polished Solid Surface Countertop in Bathroom with Integrated Bowl
- Polished Solid Surface Countertop on Bedroom Nightstands and Chests
- Residential Style Full Extension Ball Bearing Drawer Guides
- Villa™ Sofa and Driver/Passenger Seats
- Heated Front Seats with Power Lumbar, Footrest, Recline and Oversized Passenger Seat
- Sleep Number® Premier Air Mattress
- Cedar Paneling in Rear Wardrobe

### OPTIONS

- Manhattan Glazed Maple Hardwood Cabinets with High-Gloss Finish
- Carmel Glazed Cherry Hardwood Cabinets
- Ginger Glazed Cherry Hardwood Cabinets with High-Gloss Finish
- Corian® Double Bowl Kitchen Sink
- Villa™ Sofa/Dinette Ensemble
- Villa™ Sofa/Euro Booth Dinette Ensemble
- Villa™ Extenda Flex Dinette
- Villa™ Euro Booth Dinette
- Off Door Side Two Swivel Wall Hugger Recliners with Lamp Stand
- Off Door Side Extenda L Sofa
- Door Side 68" Dormi Sofa with Air Mattress\*
- Combination Desk/Dinette with Buffet Table, Two Fixed/Two Folding Chairs
- Door Side 48" Televator TV, Off Door Side Extenda L Sofa, Desk/Buffet Dinette and Overhead Cabinet
- Door Side 48" Televator TV, Off Door Side Extenda L Sofa, Villa® Euro Booth Dinette and Overhead Cabinet
- Door Side 48" Televator TV, Off Door Side Extenda L Sofa, Villa® U-Dinette and Overhead Cabinet
- Overhead Cabinet Above Sofa/Dinette Area\*



Power Flip Up sofa In Bed Base  
Power Incline Head of Bed  
Power Incline Retracting Bed Base



## Electrical Features

*A Newmar coach's electrical and lighting system is designed for maximum reliability, functionality, and style.*

12.5 KW Cummins Onan® Diesel Quiet Generator on Hydraulic Slide Tray  
50-Amp Electrical Service with Flexible Cord and Automatic Transfer Switch  
Six 6-Volt House Batteries on Pullout Tray  
5-Watt Solar Panel to Charge Chassis Battery  
2800-Watt Pure Sine Inverter  
110-Volt Exterior Recept  
12-Volt Auxiliary Recept on Dashboard  
Exterior LED Accent Lights Below Door Side Slideout  
Exterior LED Accent Lights Above Rear Tow Guard  
LED Lights Recessed in Ceiling and Overhead Cabinets  
LED Lights in Exterior Storage Compartments on Automatic Switches  
LED Side Docking Lights with Stainless Steel Trim  
Secondary multiple Touch Screen in Bedroom  
Engine Block Heater  
Emergency Engine Start Switch  
Accent Lights in Feature Ceiling, Lambrequins, Kitchen, Bed Base, Fascia & Under Dash  
Solar Prep  
Silverleaf® Multiplex Control System  
Manually Operated Hold-To-Run Slideout Switch  
Recept with Built in USB Charger at Dinette & Bedroom Dresser Cabinet  
Automatic Generator Start on Low Battery or Temperature Setting

### OPTIONS

Roof-Mounted Spot Light  
Six Sunforce Flexible 95-Watt Solar Panels on Roof



## Exterior Features

*The Full-Paint Masterpiece Finish is one of the most beautiful and durable in the industry.*

Full-Paint Masterpiece™ Cut & Buff Finish with Nano Shield Protection on Front Cap

Lighted Exterior Storage Compartments with Cargo Liner  
Convex Exterior Chrome Mirrors with Remote Control, Defrost, Turn Signals & Side View Cameras  
Rear Hitch for Towing Car  
Holding Tank Levels Displayed in Exterior Water Works Compartment  
Power Baggage Door Locks, Keyless Entrance Door with Touch Pad and Door Bell  
Rear Protective Stainless Tow Guard  
Undercoating  
Stainless Steel Trim Pieces

### OPTIONS

Large Storage Tray with Access from One Side or Either Side  
Power Sliding Storage Tray  
Large Storage Tray

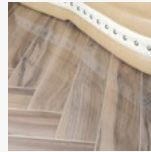

## Interior Features

*Flooring – both tile and carpet – is installed with Newmar's own in-house process, ensuring the best in quality and longevity, as well as the finest fit.*

Dual latch Front Door with Power Flush Stepwell Cover  
Kitchen Accent Rug  
Auto Motion Power Window Shades & Lambrequins  
Auto Motion Power Shades for Windshield & Driver/Passenger Side Windows  
Polished Solid Surface Window Sills  
Polished Porcelain Floor Tile in Kitchen, Bathroom, Living Areas  
Hardwood Raised-Panel Interior Passage Doors  
Safe Located in Bedroom Wardrobe  
Removable Transport Pads for Under Slideout Rollers

### OPTIONS

Carpet in Bedroom in Place of Tile  
Power Silhouette Window Shades



## Plumbing & Bath Features

*The Demand Water Systems residential flow response ensures that the comfort and reliability of home are never far away.*

Demand Water System  
Dometic Concerto Electric Flush or Macerator China Bowl Stool\*  
Systems Monitor Panel  
MANABLOC® Plumbing System  
Whole House Water Filter

Polished Solid Surface Shower Walls with Full Mosaic Tile Walls  
Automatic Fill for Fresh Water Tank  
Exterior Convenience Wash Station  
Touch Faucet Kitchen Sink

### OPTIONS

Fold Down Shower Seat  
RV Sanicon System  
Black China Bowl Stools

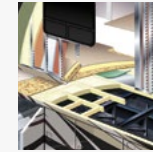

## Construction Features

*From the Chassis on up, Newmar coaches are built to be dependable, durable, comfortable, and beautiful.*

Mechanical Lock Arms on All Slideout Rooms  
5/8" Foam Insulation Laminated in Sidewalls & Ceiling  
Aluminum-Frame Sidewalls & Roof Construction 16" on Center  
Fiberglass Roof with Walkable Decking and Integrated Gutter Rail  
Polar Pak R19 Batten Insulation in Roof



## Windows, Awnings & Vents

*Experience as much – or as little – of the outdoors as you want in comfort and style.*

Frameless, Double-Pane Tinted Safety-Glass Windows  
Tinted One-Piece Windshield  
Fan-Tastic® Vent with Rain Sensor in Kitchen Area and Bathroom  
Driver's-Side Power Window  
Girard® Slideout Covers, Power Awnings on Windows and Entrance Door  
Two Girard® Nova Power Side Awnings with Wind Sensor, Remote Control & LED Lights

### OPTIONS

Large Window Above Bed Concealed with Sliding Doors

\*Check With Dealership On Floorplan Availability

---

## OUR PARTNERS

WHERE THE FINEST NAMES IN QUALITY AND PERFORMANCE ARE ALONG FOR THE RIDE.

To assure that you experience only the best in comfort, control and unsurpassed convenience in our incomparable family of Luxury Coaches, Newmar partners with the most prestigious names in mobile lifestyle, entertainment and technology. These brands are leaders in their fields – and legends in providing customers with new, unsurpassed levels of quality and reliability. Best in class performance from names you can trust. At Newmar, that's our difference. And our promise.

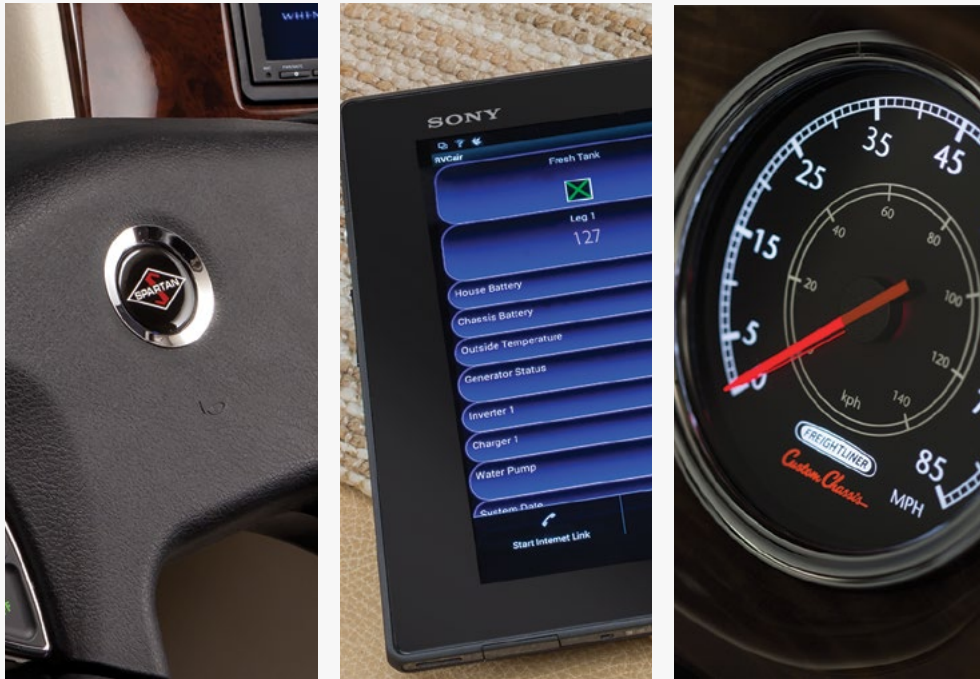

---

## TRUST

THE STRONGEST POSSIBLE FOUNDATION FOR A MOTOR COACH.

According to Newmar president Matthew Miller, “Customers say they’re loyal to us because they trust us to stand behind our products – from support, parts and service to paying our warranties. It feels good to own a coach that has all of that behind it.”

How do we sustain this high level of service? At Newmar, there’s a Miller way of doing things. These principles guide us every day. Courtesy. Integrity. And reliability. So when you buy from Newmar, you know that every single person who touches your coach or talks with you has your back. Period.



Matthew Miller, Newmar President, lifelong motor coach enthusiast.



2015  
**ESSEX**

**NEWMAR EXPRESS LIMITED WARRANTY**

Every Essex Diesel motor coach is backed by Newmar's one-year limited warranty/unlimited miles. Ask your Newmar dealer for details.

**NEWMAR EXPRESS LIMITED WARRANTY**

If any part of your Newmar recreational vehicle superstructure (which is the steel/aluminum structure of the sidewall, roof or frame) fails to perform properly within five years from the date of purchase because of faulty workmanship or material supplied by Newmar, it will be repaired without charge for either parts or labor by Newmar. This structural warranty is available only to the original purchaser and is non-transferable.

Some features in our literature are optional. Colors and finishes are photographic representations. The actual materials may look different. Prices, specifications and floor plans are subject to change at Newmar's discretion, without prior notice or obligation. Please see your dealer for actual samples and specifications.



WHEN YOU KNOW THE DIFFERENCE <sup>SM</sup>