

HURRICANE

MADE TO FIT
YOUR TRAVELS



HURRICANE

 BY THOR MOTOR COACH

WHEN WE SAY *MADE TO FIT*, WE MEAN IT.

With so many unique models available, Thor Motor Coach motorhomes are priced to fit anyone's budget – from families buying their first motorhome, to full-timers looking for a roaming “dream home”. No matter how you choose to spend your time or your money, there's a TMC motorhome that fits your needs. Welcome to the Hurricane, the motorhome that is ***Made to Fit*** your travels.



34E | VIENNA GOLD | OLYMPIC CHERRY



34J | TOASTED ALMOND | SYDNEY MAPLE



34J | TOASTED ALMOND | SYDNEY MAPLE



34E | VIENNA GOLD | OLYMPIC CHERRY



BEAUTY INSIDE & OUT

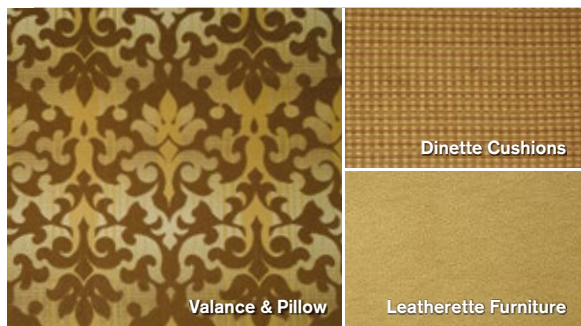

AMBER ELEGANCE



FLOORING



BRAZILIAN TEAK FULL-BODY PAINT

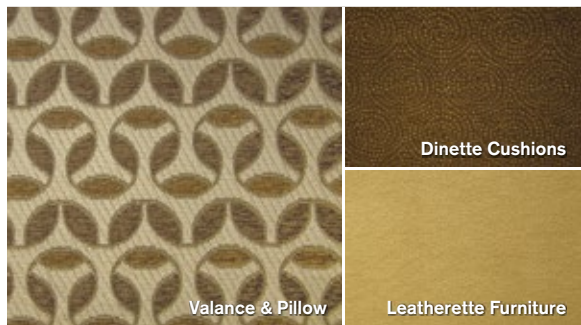

TOASTED ALMOND

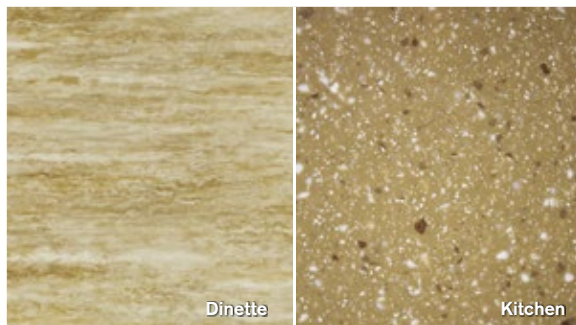

COUNTERTOPS



MAUI BEIGE FULL-BODY PAINT

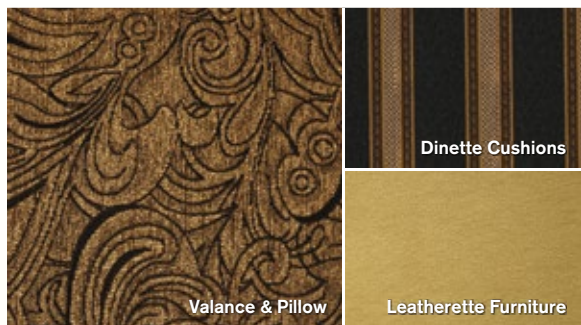

VIENNA GOLD



OLYMPIC CHERRY



SYDNEY MAPLE



COPPER GLAZE HD-MAX™ 



POLISHED BRASS HD-MAX™ 



A | TRITON® V10 ENGINE

The 6.8L V10 engine has a proven track record of durability and low-hassle maintenance. Extremely smooth running with a commanding 362-horsepower and 457 lb.-ft. of torque.

B | POWER 4-WHEEL DISC ANTI-LOCK BRAKES

Maintains brake balance in heavy use and varying road conditions. Reduces wheel lock up and helps maintain superior steering control.

C | BILSTEIN SHOCKS

Long lasting, rugged shocks provide greater stability and better road handling.

D | TORQSHIFT™ 5-SPEED AUTOMATIC TRANSMISSION

Provides crisp, firm and quick shifting without sacrificing driver comfort.

E | LIMITED WARRANTY

The Ford® Motorhome Chassis has a Bumper-to-Bumper Limited Warranty for 3 years or 36,000 miles and a Powertrain Limited Warranty for 5 years or 60,000 miles, whichever comes first.

Taking the extra time to ensure the best possible structure is exactly what you deserve, and this is why Thor Motor Coach insists on vacuum-bond laminating not only the sidewalls of the motorhome, but also the floor and roof. Vacuum-bonding is the optimum manufacturing process to ensure multi-layer integrity.



ROOF

- A** One-piece exterior TPO membrane
- B** Luan panels
- C** Aluminum structure with bowed framing
- D** Block foam insulation
- E** Interior panel with hard vinyl covering

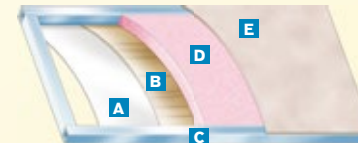

SIDEWALLS

- A** High-gloss or gel-coat fiberglass
- B** Luan panels
- C** Aluminum structure with framing at all openings
- D** Block foam insulation
- E** Interior panel with designer wall covering



FLOOR

- A** Residential vinyl flooring or carpet
- B** OSB structure wood base
- C** Structural steel framing
- D** Block foam insulation
- E** Luan with woven plastic exterior finish

FLOOR PLANS

27K

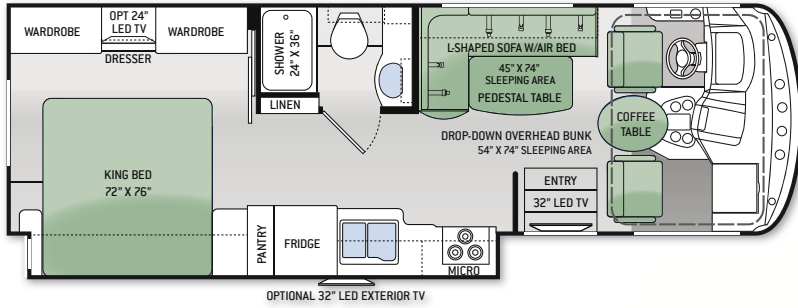

34E

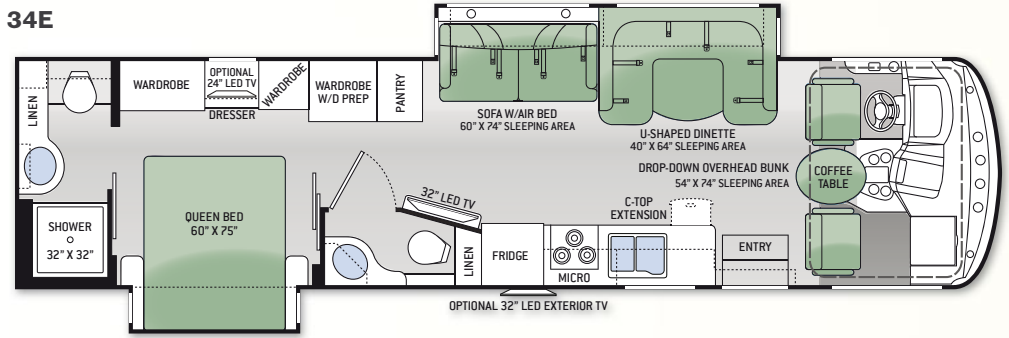

31S

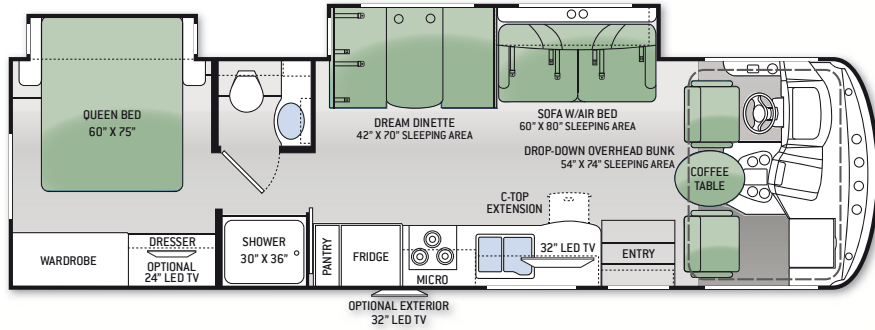

34F

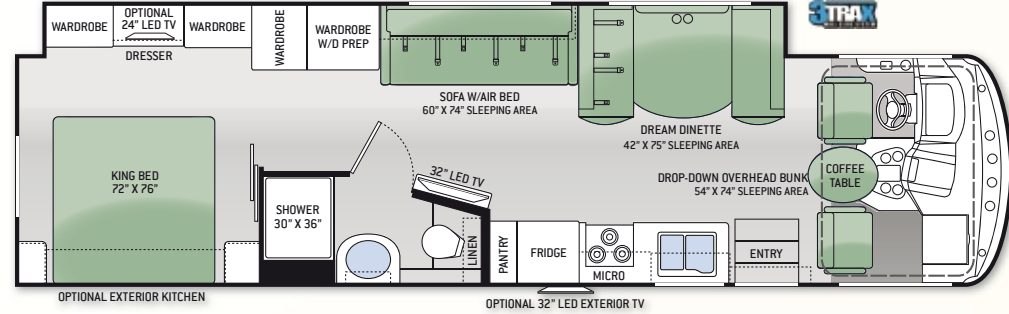

32N

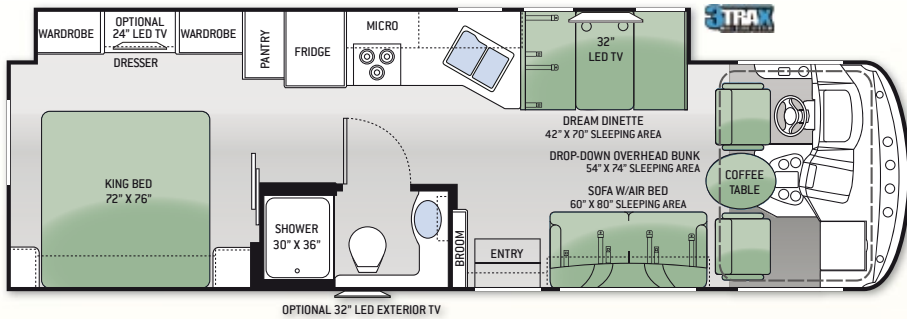

34J

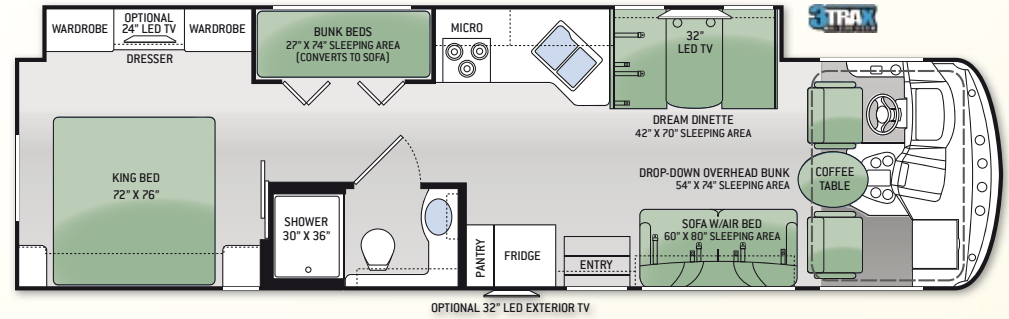

35C

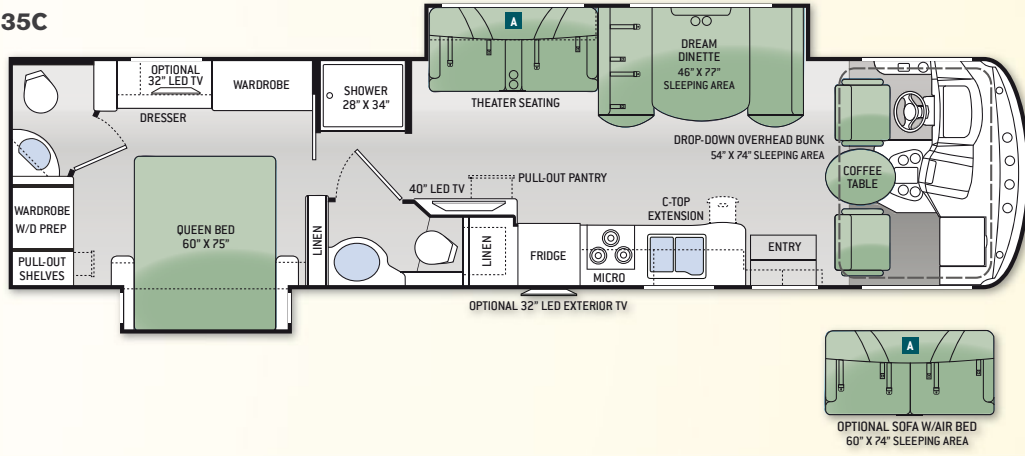

FLOOR PLAN

	27K	31S	32N	34E
Chassis	Ford	Ford	Ford	Ford
Gross Vehicle (GVWR)	18,000	18,000	20,500	22,000
Gross Combined (GCWR)	23,000	23,000	26,000	26,000
Wheel Base	178"	190"	208"	228"
Exterior Length (w/out ladder)	28'-9"	31'-9"	32'-10"	35'-5"
Exterior Height (w/AC)	12'-2"	12'-2"	12'-2"	12'-2"
Exterior Width (w/out mirrors)	99"	99"	99"	99"
Interior Height	82"	82"	82"	82"
Awning Size	16'	18'	18'	18'
Fuel (gal)	80	80	80	80
LPG (lbs)	88	88	88	88
Fresh/Waste/Gray Water (gal)	50 / 29 / 44	49 / 24.5 / 44	50 / 43 / 43	50 / 32R-43F / 44
Water Heater (gal)	6	6	6	6
Furnace (BTUs)	30,000	35,000	35,000	35,000
Exterior Storage Capacity (cu. ft.)	80	91	89	56

FLOOR PLAN

	34F	34J	35C
Chassis	Ford	Ford	Ford
Gross Vehicle (GVWR)	22,000	22,000	22,000
Gross Combined (GCWR)	26,000	26,000	26,000
Wheel Base	242"	242"	242"
Exterior Length (w/out ladder)	35'-10"	35'-5"	36'-11"
Exterior Height (w/AC)	12'-2"	12'-2"	12'-2"
Exterior Width (w/out mirrors)	99"	99"	99"
Interior Height	82"	82"	82"
Awning Size	18'	18'	18'
Fuel (gal)	80	80	80
LPG (lbs)	88	88	88
Fresh/Waste/Gray Water (gal)	50 / 40 / 43	50 / 43 / 43	50 / 32R-43F / 44R-43F
Water Heater (gal)	6	6	6
Furnace (BTUs)	35,000	35,000	35,000
Exterior Storage Capacity (cu. ft.)	85	109	58



31S | AMBER ELEGANCE | SYDNEY MAPLE



34E | VIENNA GOLD | OLYMPIC CHERRY



34J | TOASTED ALMOND | SYDNEY MAPLE

STANDARDS & OPTIONS

CONSTRUCTION & EXTERIOR

- Ford® F-53 SuperDuty Chassis - 6.8L Triton® V10 Engine, 362HP, 457 lb.-ft. Torque - TorqShift® 5-Speed Automatic with Overdrive Transmission
- One-Piece Fiberglass Front & Rear Caps
- One-Piece Windshield
- Slick Fiberglass Exterior Sidewalls
- HD-MAX™ Exterior with Graphics Package
- Rotocast Storage Compartments
- Side Hinged Flush Mount Radius Luggage Doors (In Select Areas)
- Automatic Leveling Jacks with Touchpad Controls
- Power Patio Awning with Integrated LED Lighting
- 3TRAX™ Wall Slide System (32N, 34F & 34J) 
- Rubber Tread Entry Steps
- Electric Automatic Entry Step
- Roof Ladder
- Outside Shower
- Frameless Windows

CONSTRUCTION & EXTERIOR OPTIONS

- Full-Body Paint Package with Gel-Coat Sidewalls
- Frameless Dual Pane Windows

AUTOMOTIVE & COCKPIT

- Touchscreen AM/FM Dash Radio with CD Player, Bluetooth® & Back-Up Monitor
- Heated/Remote Exterior Mirrors with Integrated Side View Cameras
- Reclining/Swivel Leatherette Captain's Chairs with Stow-Away Coffee Table
- Tilt Steering Wheel
- Driver Conversation Mirror
- Fog Lights
- 19.5" Tires with Stainless Steel Wheels

- 8,000-lb. Trailer Hitch with 7-pin Round Connector*
- Valve Stem Extenders on Rear Tires*
- Dash Workstation with 110-volt & 12-volt Outlets

AUTOMOTIVE & COCKPIT OPTION

- 6-Way Power Adjustment Driver's Seat

INTERIOR

- Residential Vinyl Flooring Throughout (Except Cab Area)
- 82" Interior Ceiling Height
- LED Ceiling Lights
- Ceiling Ducted Air Conditioning System
- Raised Panel Overhead Cabinet Doors with Nickel Finish Hardware
- Full Extension Drawer Guides Throughout
- Super-Sized Dream Dinette™ Booth (34F & 35C)
- Dream Dinette™ Booth (31S, 32N & 34J)
- Leatherette U-Shaped Dinette (34E)
- Leatherette L-Shaped Sofa with Air Bed & Pedestal Table (27K)
- Leatherette Theater Seating with Footrest (35C)
- Window Privacy Shades
- Power Drop-Down Hide-Away Overhead Bunk*

INTERIOR OPTION

- Leatherette Sofa with Air Bed (STD 31S, 32N, 34E, 34F & 34J. OPT 35C)

KITCHEN

- Double Door Refrigerator
- 3-Burner Gas Cooktop with Oven
- 30" Over-the-Range Microwave Oven
- Solid Surface Kitchen Countertops with Designer Backsplash & Pressboard Dinette Countertops*

- Large Double Bowl Sink with Single Handle Kitchen Faucet & Sprayer
- Countertop Extension (31S, 34E & 35C)
- Pantry

KITCHEN OPTION

- 12-volt Attic Fan

BEDROOM & BATHROOM

- Denver Mattress® King Size Bed (27K, 32N, 34F & 34J)
- Denver Mattress® Queen Size Bed (31S, 34E & 35C)
- Designer Headboard, Bedspread & Pillow Shams
- Bunk Beds in Hallway Slideout (34J)
- Foot Flush Porcelain Toilet
- Shower with Glass Door
- Power Vent

ENTERTAINMENT

- 32" LED TV in Living Area (N/A 35C)
- 40" LED TV in Living Area (35C)
- 13" & 24" LED TVs & DVD Player in Bunk Beds (34J)
- Overhead Speakers above Sofa (Above Dinette in 27K)
- Cable TV & HDMI Ready
- Bluetooth® Coach Radio System in Bedroom with Exterior Speakers
- Power Charging Center for Electronics

ENTERTAINMENT OPTIONS

- 24" LED TV in Bedroom (N/A 35C)
- 32" LED TV in Bedroom (35C)
- Exterior 32" LED TV

- Exterior Kitchen - Includes: 2.5-cu. ft. Refrigerator, Sink, Portable Gas Grill & 1000-watt Inverter (31S, 32N, 34F & 34J)

ELECTRICAL & PLUMBING

- Cummins Onan® RV QG 4000 Gas Generator (27K & 31S)
- Cummins Onan® RV QG 5500 Gas Generator (32N, 34E, 34F, 34J & 35C)
- 30-amp Service & Detachable Shoreline Power Cord (27K & 31S)
- 50-amp Service & Detachable Shoreline Power Cord with Dual Auxiliary House Batteries (32N, 34E, 34F, 34J & 35C)
- 13,500 BTU Front Roof Air Conditioner
- 13,500 BTU Rear Roof Air Conditioner (N/A 27K & 31S)
- Battery Disconnect Switch
- 6-gallon DSI Gas/Electric Water Heater
- Water Heater Bypass System
- Enclosed, Heated Holding Tanks (27K & 31S)
- Washer/Dryer Prep (34E, 34F & 35C)
- Systems Control Center
- **Rapid Camp™** Wireless Control System

ELECTRICAL & PLUMBING OPTIONS

- 15,000 (IPO 13,500) BTU Front Roof Air Conditioner (27K & 31S)
- Second Auxiliary House Battery (27K & 31S)
- Holding Tanks with Heat Pads (32N, 34E, 34F, 34J & 35C)

*INCLUDED ON UNITS BUILT AFTER 10/1/14

Thor Motor Coach is the industry leader in innovative design and builds a variety of unique styles, sizes and floor plans that feel custom-made – at a truly competitive price.

IMPORTANT - PLEASE READ: This brochure reflects product design, fabrication, material, components and specifications at the date of printing, which date is disclosed on the last page. PLEASE VISIT US ONLINE AT THORMOTORCOACH.COM OR CONSULT WITH YOUR SELLING DEALERSHIP FOR THE LATEST IN STANDARDS, OPTIONS, SPECIFICATION AND TECHNICAL INFORMATION. Photographs in the brochure may depict optional equipment or may only be available in certain floor plans. Components, appliances and the chassis may have been manufactured in a calendar year before the vehicle's designated model year. All capacities are approximate. The actual length of the vehicle may differ from that indicated in the brochure due to variances in the manufacturing processes and/or installed components. All dry weights are based on standard model features and do not include optional features or equipment. Component part and appliance manufacturers issue limited warranties covering portions of the vehicle not covered under the limited warranty we issue.

Copyright Thor Motor Coach, Inc. © 12/15/14

YOUR LOCAL THOR MOTOR COACH DEALER



Made to fit.

P.O. Box 1486, Elkhart, IN 46515
Sales Department: 800.860.5658
Customer Service: 877.855.2867



Hurricane-RV.com