

# AMPED

Travel Trailer Toy Haulers

It's Time to  
Get Down  
and Dirty.



EVER  GREEN  
RECREATIONAL VEHICLES

# We've Reinvented the Toy Hauler Travel Trailer.



You can take it all with you in an Amped Toy Hauler from EverGreen.

Amped Z-Frame Technology results in the storage capacity of a fifth wheel in an easy-to-tow travel trailer. Our Amped boasts more storage than any toy hauler in its class. The unique Amped Z-Frame Technology opens up massive pass-through basement storage by engineering a step-up bedroom similar to a fifth wheel. More storage space means more camping gear stows-and-goes in an Amped toy hauler from EverGreen.

Amped toy hauler interior walls are built with a tough inner shell, our DuraLite™ Double Welded Aluminum Structure sidewall and finished in a high-gloss exterior gel-coat outside.



Over 200% more storage than most Toy Hauler Travel Trailers. Over 200 cubic feet of storage.



# Go Where You Have to Go in the Amped.



## The Amped. rough and ready.

Whether you're on a challenging Western elk hunt, or just taking the kids out to the desert for a weekend of four wheeling, the business end of the Amped is engineered like no other. The Amped is your sport utility trailer, limited only by your imagination!

First up, you can load your Amped to the max because there are no interior wheel wells in the way! The Amped Z-Frame Technology results in the floor system set over the axles, to eliminate cumbersome wheel wells inside the garage area. This allows more room side-to-side for easier loading and unloading (**24 inches = 25 percent of overall width**) — the Amped has a full **102-inch** exterior width. Once you're loaded, **6,000 pound**, D-ring tie-downs are bolted to the frame to keep equipment secure.

## Getting you there.

Setting the frame over the axles also provides the Amped with higher ground clearance when you're off road. In addition, the standard Trailair suspension features the Equa-Flex™ system for added stability and less vibration.

When it's time to unload, the Amped is ramped-up with a standard beavertail ramp system. The standard beavertail on all Amped trailers makes loading and unloading easier and smoother. In addition, a built-in toolbox is flush to the floor on all models. The entire floor of the Amped toy hauler garage area is engineered with marine-grade plywood decking. A heavy-duty ramp door system is rated for **3,000 pounds** with an integrated spring assist that eliminates exposed cables. The ramp is coated with a tough, non-skid surface.



Enjoy the optional patio system to turn your garage into a place to relax.



Four additional cubic feet of clearance lets you load your Amped wall-to-wall with no wheel wells in the way! Beavertail ramp is standard.

26FS



### Amped Interior Color Selections

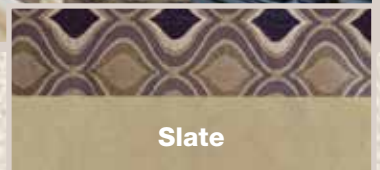



# No one builds toy haulers like EverGreen.

Take the time to compare because there is an “EverGreen Difference.” Since we first revolutionized the RV industry with the Ever-Lite travel trailer, we’ve been busy focusing on the innovation front with new manufacturing and material specifications to build a better trailer for your family.

## Construction Features

### Walls

- 1** Tough laminated walls in garage area
- 2** Fully welded aluminum frame
- 3** High-density, block foam insulation
- 4** Large screened window for superior ventilation
- 5** Glossy fiberglass-reinforced exterior

### Roof

- 6** Full five inch barrel roof for improved run off
- 7** High-density, block foam insulation
- 8** Full 101-inch interior height
- 9** Reflective, white roofing

### Floor

- 10** Enclosed underbelly
- 11** Fully welded aluminum frame
- 12** Marine grade plywood in garage area
- 13** High-density, block foam insulation
- 14** Padded “No-Crack” vinyl floor
- 15** Rigid Steel I-beam frame



## DuraLite™ Double Welded Aluminum Structure



The Amped is built on the DuraLite Double Welded Aluminum Structure. It includes aluminum frame construction in the walls and floors with header framing around all doors, windows and baggage door openings. Our strong, durable frame eliminates flexing for a longer lasting coach.

## Crowned Roof Provides Ample Headroom

Full five inch barrel ceilings create more space in the garage and living area, more than **8-feet**, and **6 feet 4 inches** in the bedroom.



## Amped Z-Frame Technology

Our Z-Frame Technology is what gives Amped the storage capacity of a fifth wheel in an easy-to-tow travel trailer. This raised bedroom design creates furnace, utility and generator compartments in the basement area freeing up space in the living area. The step-up master bedroom also provides more privacy. There is gas-strut assisted storage under the bed.



# Standard Features and Optional Packages

## CONSTRUCTION

- Rigid Z-Frame Technology chassis
- No wheel wells inside — 24-inches more
- Higher ground clearance
- Trailair, Equa-Flex™ suspension system
- DuraLite Double Welded Aluminum Structure in walls and floor
- Standard beavertail with flush mount toolbox
- 6,000-pound D-ring tie-downs mounted to frame
- EZ-LUBE hubs, axles
- 101-inch interior height
- 8-foot, 3,000 pound capacity ramp door
- Massive pass-through storage
- Built to Canadian CSA standards

## INTERIOR

- 8-cubic foot double door refrigerator
- Corian® countertops
- Two jack knife sofas
- Rear power bed with bottom lounge
- Overhead storage cabinets/shelves with cargo netting
- Queen bed in bedroom
- Two large wardrobes in bedroom (select models)
- Two large dresser drawers in bedroom (select models)
- Radio with DVD and CD player
- 30-inch microwave with built in range hood
- Resort shower—tri-slide with bench seat
- Rear roll down screen
- 101-inch interior height with industry first full five inch “barrel ceiling”
- 3-burner stove with gas oven
- Porcelain foot flush toilet

## EXTERIOR

- Aluminum wheels
- Power awning
- One-piece rubber roof
- Slam latch baggage doors
- Battery housing for up to four batteries with disconnect
- Four spot lights — two door side, two rear mounts
- High gloss gel coat finish
- 16-inch wheels
- Heated and enclosed underbelly
- Detachable power cord
- Welded toy lock connection
- Massive pass-through storage

## UTILITY

- EZ lube 6,000 pound axles (7,000 pound axle on 32GS)
- Six gallon DSI water heater
- Interior LED lighting
- Exterior LED lighting
- 174-gallon fresh water tank
- 50-gallon gray water tank
- 50-gallon black water tank with flush
- Quick connect water port
- Dual LP tanks with crimped rubber lines
- Monitor panel
- 18-gallon generator fuel tank
- 40-gallon equipment fuel tank
- Standard Onan 4000k generator

## INTERIOR OPTIONS

- Stereo upgrade/kicker marine speakers with LCD touch screen
- 10-inch kicker sub-woofer with power amp
- Two barrel chairs in place of sofa
- LED TV

## EXTERIOR OPTIONS

- Ramp patio option
- Outside LED TV bracket

## UTILITY OPTIONS

- CSA
- 15,000 BTU low profile AC
- 50 Amp service with 2nd AC prep
- Extra tie downs

## OPTIONAL “AMPED UP PACKAGE”

- Power stabilizer jacks/front and rear
- Power tongue jack
- Front fiberglass cap

# Choose your floor plan from a wide range

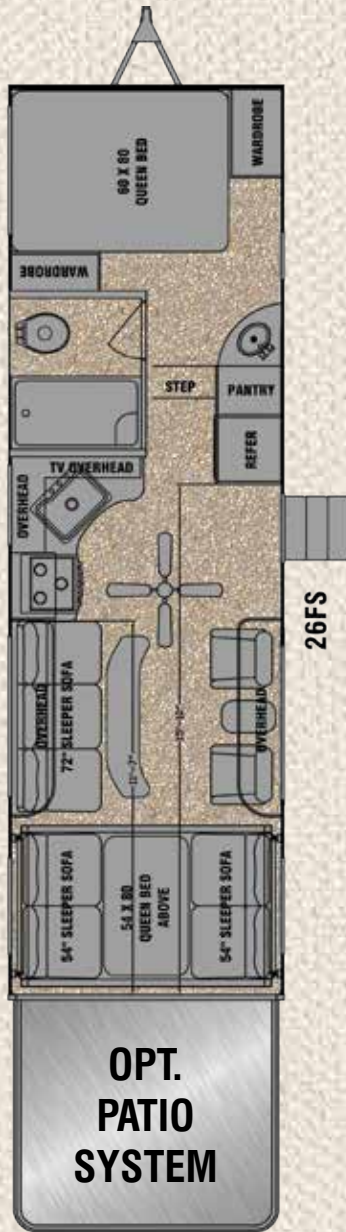

## 26FS

Ext Length	30' 8"
Ext Width	102"
Ext Height	13'
Int Height	96"/101"
Cargo R/S	11' 7"
Cargo C/S	15' 10"
GVWR	12,900
Axle Weight	6,951
Hitch Weight	1,303
<b>UVW</b>	<b>8,254</b>
Payload	4,646
Fresh Water	174 Gal
Gray Water	50 Gal
Black Water	50 Gal
Fuel Tank	40/18 Gal

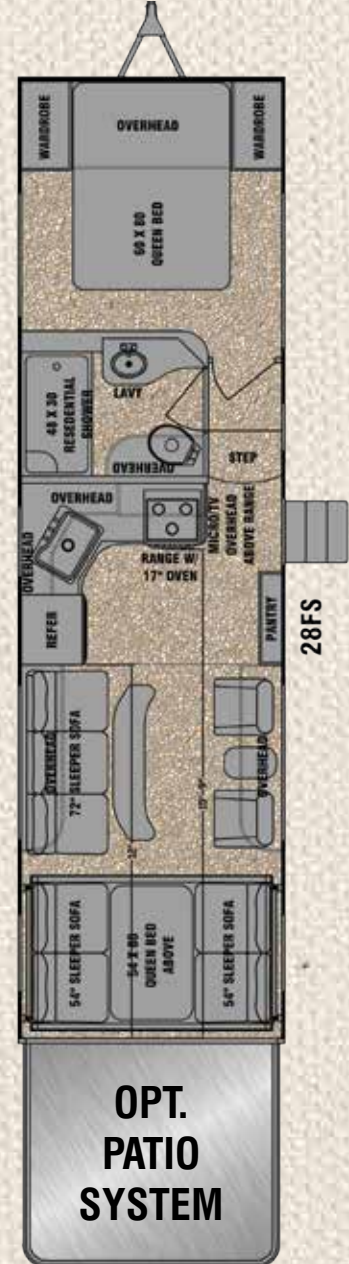

## 28FS

Ext Length	33' 5"
Ext Width	102"
Ext Height	13'
Int Height	96"/101"
Cargo R/S	12'
Cargo C/S	15' 9"
GVWR	12,900
Axle Weight	7,374
Hitch Weight	1,318
<b>UVW</b>	<b>8,692</b>
Payload	4,208
Fresh Water	174 Gal
Gray Water	50 Gal
Black Water	50 Gal
Fuel Tank	40/18 Gal

\*EverGreen RV reserves the right to change or discontinue at any time, without notice, prices, colors, materials, equipment, accessories, specifications, models, and packages, without incurring any obligations to make the same or similar changes to trailers previously sold. Colors shown may vary due to reproduction and printing processes.



of popular choices.

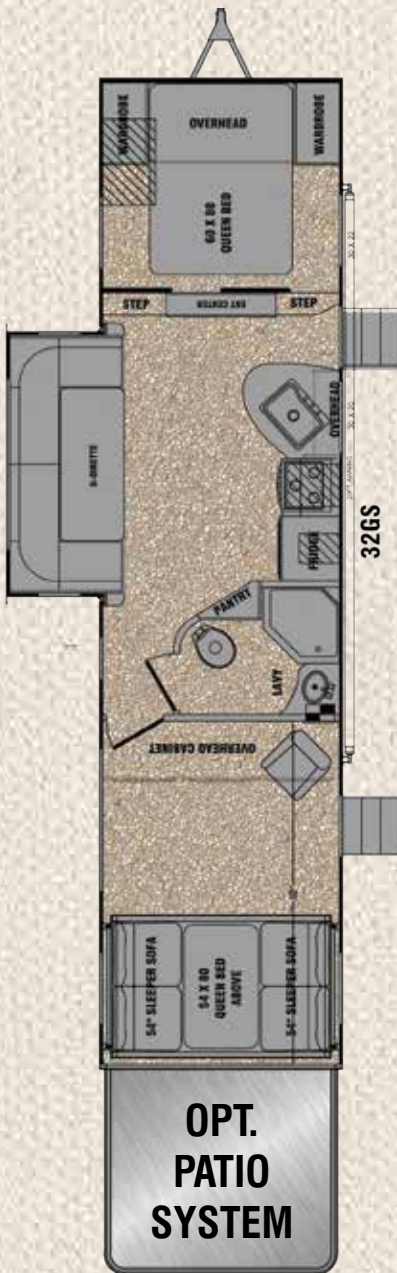

**32GS**

Ext Length	36' 11"
Ext Width	102"
Ext Height	13.2'
Int Height	96"/101"
Cargo R/S	12'
Cargo C/S	12'
GVWR	14,900
Axle Weight	8,757
Hitch Weight	1,183
<b>UVW</b>	<b>9,940</b>
Payload	4,123
Fresh Water	174 Gal
Gray Water	100 Gal
Black Water	50 Gal
Fuel Tank	40/18 Gal

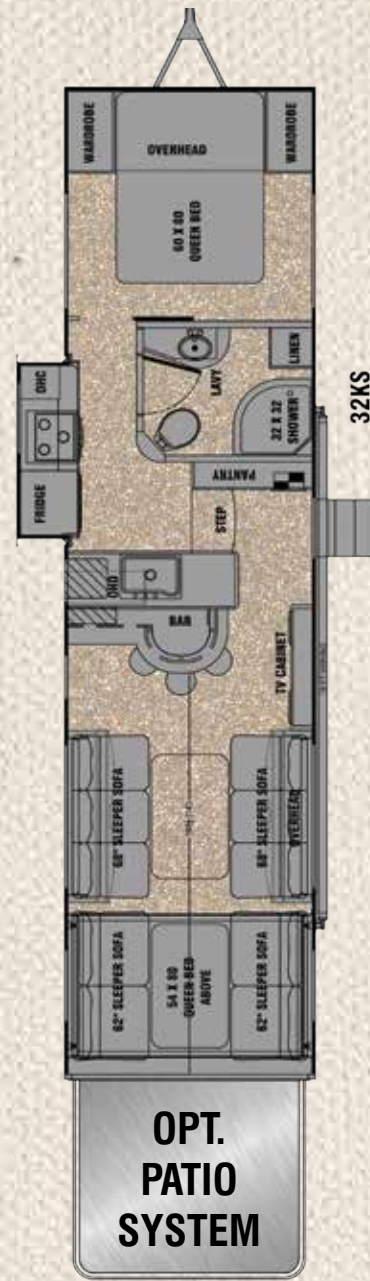

**32KS**

Ext Length	36' 11"
Ext Width	102"
Ext Height	13.2'
Int Height	96"/101"
Cargo R/S	14'
Cargo C/S	14'
GVWR	12,900
Axle Weight	TBD
Hitch Weight	TBD
<b>UVW</b>	<b>TBD</b>
Payload	TBD
Fresh Water	176 Gal
Gray Water	50 Gal
Black Water	50 Gal
Fuel Tank	40/18 Gal

## Check out Amped's Features and Benefits

- ✓ Z-Frame Technology provides fifth wheel storage and increased living space
- ✓ Garage has no interior wheel wells for maximum stowing capacity
- ✓ Heavy duty marine plywood decking in garage
- ✓ Standard beavertail for easy loading and unloading
- ✓ Built-in tool box in the garage floor
- ✓ Trailair suspension adds stability and lessens the vibration
- ✓ Inner shell walls have superior strength, durability and resist moisture
- ✓ DuraLite™ Double Welded Aluminum Structure
- ✓ All the storage of a fifth wheel in the finished, lighted basement storage
- ✓ 174-gallon fresh water tank allows for longer trips
- ✓ Full five inch barrel ceiling for a 101-inch interior height
- ✓ Ducted, heated enclosed underbelly protects water tanks and water lines
- ✓ Solid wood cabinets are screwed and glued—never stapled
- ✓ Ball bearing drawer guides—residential quality

### Compliments of:

See the above dealer for further information and prices.



## The EverGreen Peace of Mind Warranty.

We're so confident in our quality that we're willing to stand behind our travel trailers and fifth-wheels with one of the best warranties in the industry.

- 1-Year Limited Warranty
- 3-Year Limited Structural Warranty\*
- 12-Year Roofing Materials Warranty (except the Ascend)
- 1-Year Free Roadside Assistance Program

\*Contact your EverGreen dealer for an applicable copy of all limited warranties

## Learn more about our full line of quality EverGreen Travel Trailers, Fifth Wheels, Toy Haulers and Motorhomes.



**EVERGREEN**  
RECREATIONAL VEHICLES

10758 County Road 2 • Middlebury, IN 46540  
Phone: (574) 825-4298 • Fax: (574) 825-4299



[www.GoEverGreenRV.com](http://www.GoEverGreenRV.com)  
[www.LifestyleLRV.com](http://www.LifestyleLRV.com)

