

Open Range

A stylized, metallic-looking horse head in profile, facing right, with a flowing mane. It is positioned above the 'Open Range' text.



Model: 349RLS Shown with All Dark Wood



Open Range
FIFTH WHEELS





349RLS



Pull-Out Vanity



349RLS



388RKS



Model: 388RKS Shown with All Dark Wood



U-Lounge Bed



W/D Prep



Hide-A-Bed Sofa



Corian® Island on Castors



Model: R430RLS Shown with All Dark Wood & Lace Decor

Residential
FIFTH WHEELS





R417RSS



R417RSS



R398RLS



Model: R417RSS Shown with Sedonna Decor (Optional Pub Chairs)



TV Storage



Residential
Pantry



Hide-A-Bed Sofa



23 cu.ft
Refrigerator



SLIDE-OUT SYSTEM

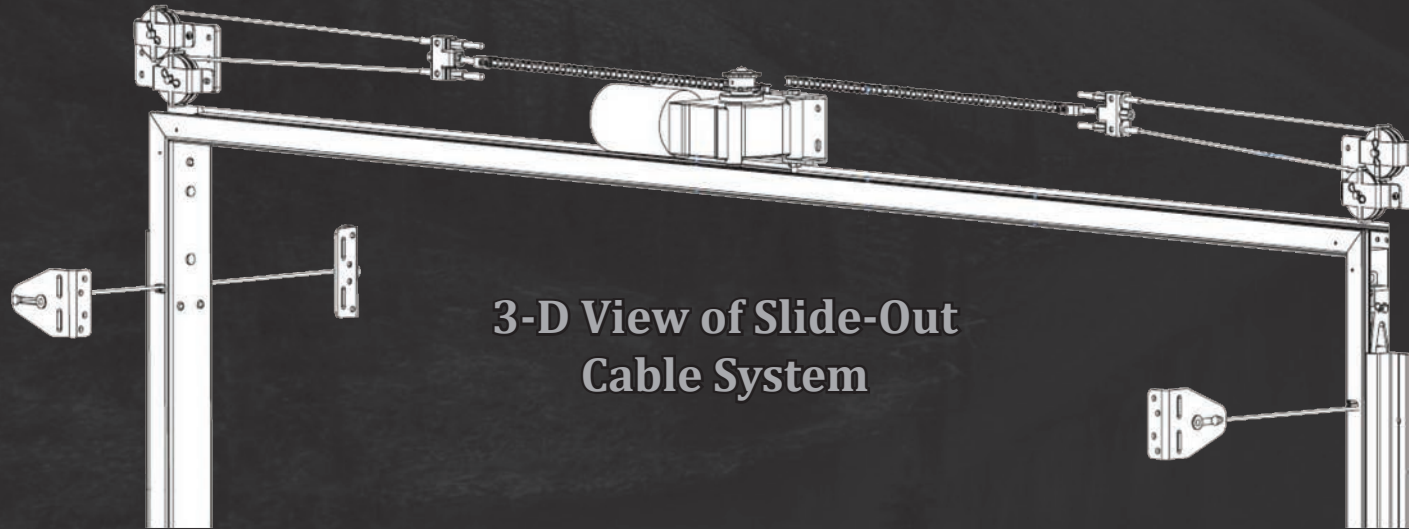

3-D View of Slide-Out Cable System

10 Reasons Why... Accu-Slide

1. Above floor design means more storage area for your RV
2. Lightweight design promotes fuel savings
3. High strength stainless steel aircraft cable is used for control
4. Cable control at all 4 room corners helps stop leaks
5. Working components are in your RV, safe from the elements
6. Locking motor secures room in or out to help stop leaks
7. Above floor design minimizes maintenance requirements
8. A clean system - no leaky hydraulic lines or greasy drives
9. Smooth, quiet room movement - no jumping or jerking
10. It's built in the U.S.A. and backed by BAL since 1972

1- Dimensional Side Profile Of Slide-Out Cable System

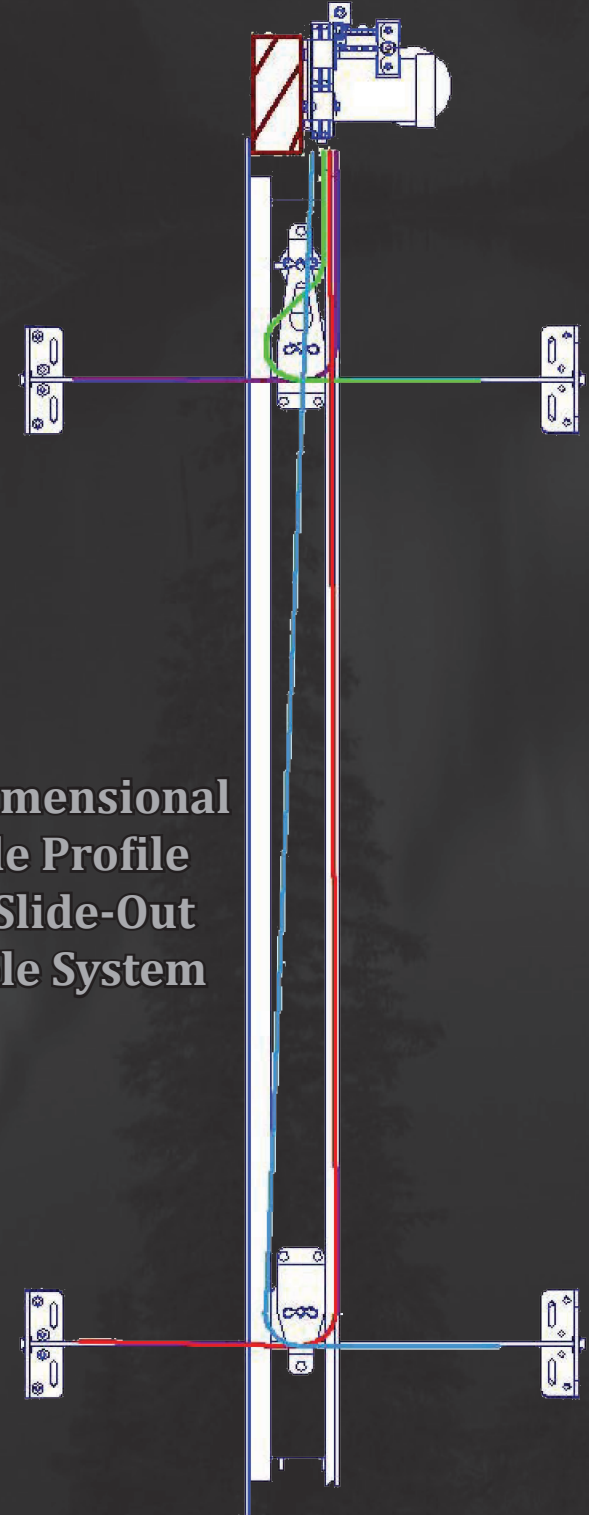

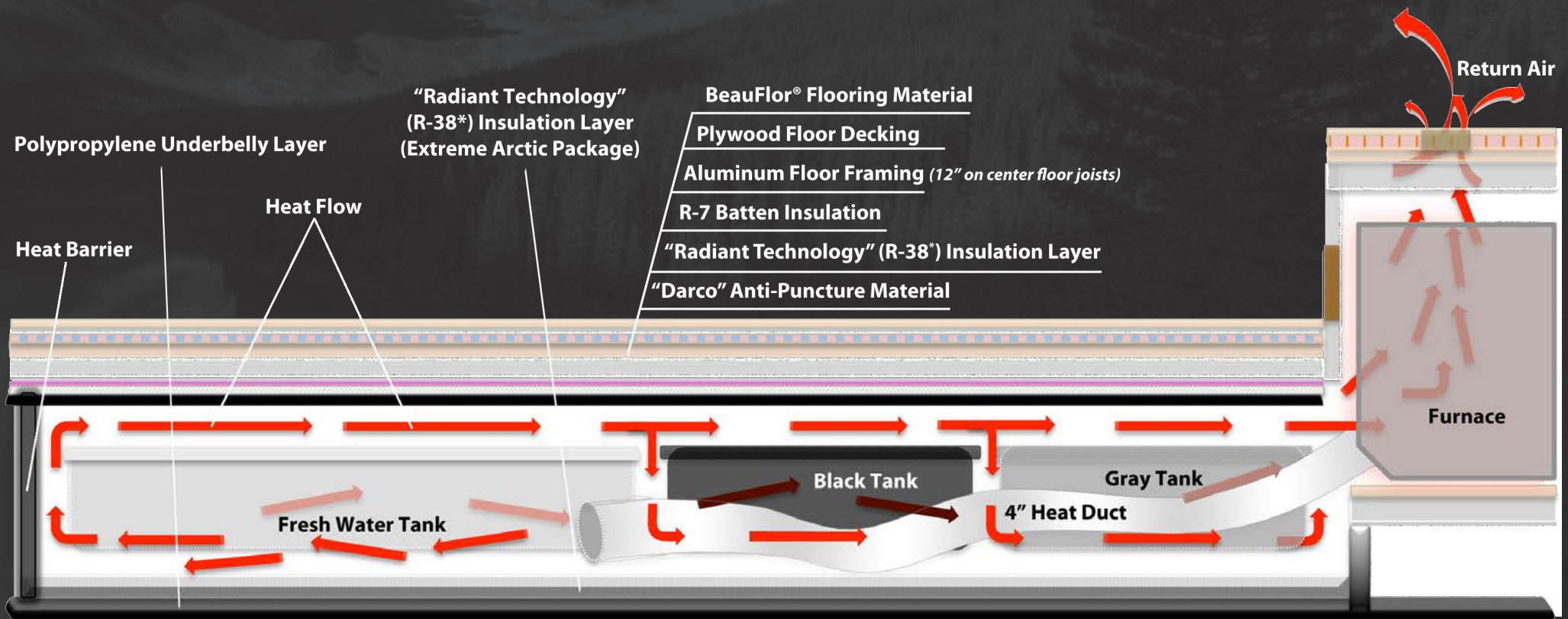

HEATING SYSTEM:

The Open Range and Residential product lines have the most efficient heating system in the industry. The extra large 4" heat duct hose is placed right next to the fresh water tank. The suspended holding tanks are specifically designed to allow for heat to surround all sides adequately as it moves throughout the belly area. As the heat moves it reflects off of a "heat barrier" that is installed just behind the rear tank to keep the heat isolated to the tank area only. As the heat reflects, it moves its way forward where the heat naturally rises and then returns back into the camper through a return air vent. This system keeps the heat isolated, delivering as much heat to the tanks as possible while returning back into the camper for propane efficiency and maximum performance!

FIFTH WHEEL CONSTRUCTION

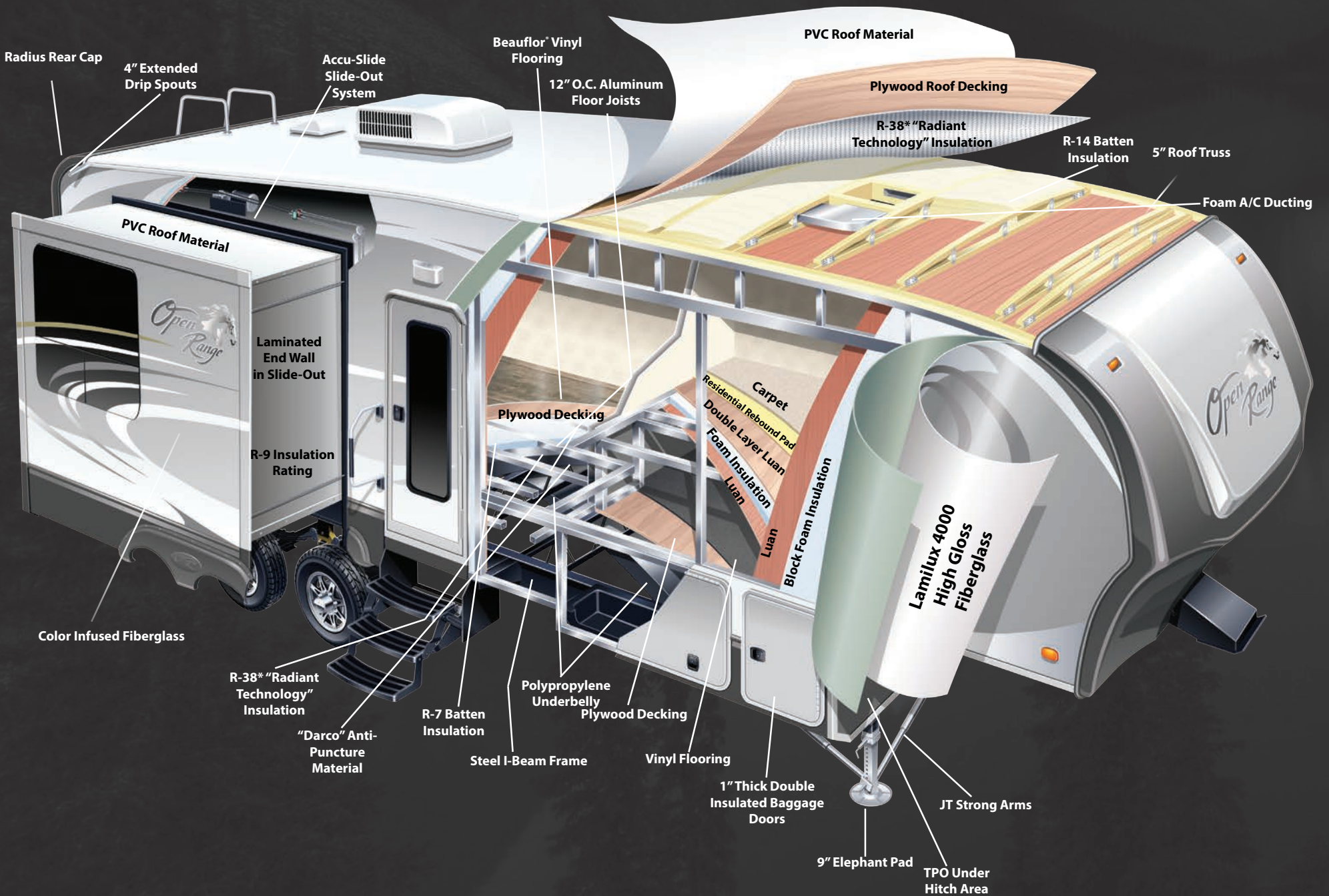

STANDARD FEATURES:

- STAINLESS STEEL SINK W/SPRAY FAUCET
- HEAVY DUTY FULL EXTENSION DRAWER GUIDES
- PULL-OUT WASTEBASKET
- CEILING FAN W/MARBLE LIGHT
- WASHER/DRYER PREP
- LIPPERT WIDE-STANCE AXLES
- LIPPERT EQUA-FLEX SUSPENSION
- WIRED AND FRAMED FOR 2ND A/C
- 16" ALUMINUM WHEELS AND TIRES
- REMOVEABLE REAR LADDER
- FULL VIEW VENTED ENTRANCE DOOR
- DUAL LP SLIDE TRAYS (80 LBS CAPACITY)
- PVC ROOF MATERIAL
- NITROGEN FILLED RADIAL TIRES
- 50 AMP SERVICE
- 100" WIDE BODY FRAME

EXECUTIVE PACKAGE: (MANDATORY)

- UPGRADED AUTOMATIC LEVELING SYSTEM
- FLAT SCREEN TV IN LIVING AREA
- 12V CD/DVD PLAYER W/ BLUETOOTH®
- USB /12V CHARGING PORT
- MULTI-PORT SATELLITE HOOK-UP
- DIGITAL TV ANTENNA W/BOOSTER
- 30" OTR MICROWAVE
- 15k BTU A/C W/"QUICK COOL" FEATURE
- WIRED AND FRAMED FOR 2ND A/C
- 10 GAL. GAS/ELECTRIC WATER HEATER
- CORIAN® COUNTERTOPS
- FLUSH MOUNT CORIAN® STOVE COVER
- FANTASTIC FAN IN KITCHEN
- POWER AWNING W/ LED AWNING LIGHT
- RAISED PANEL CABINET DOORS
- CONCEALED HINGES
- WESTERN ASPEN CABINET DOORS
- DOVETAIL DRAWER CONSTRUCTION
- METAL SLAM LATCH BAGGAGE DOORS
- 6-PERSON EXTENDABLE TABLE (DUAL LEAF)
- ONE-PIECE FIBERGLASS SHOWER
- WOOD FRAMED SLIDING WARDROBE DOORS
- HIGH-RISE STAINLESS STEEL FAUCET
- JT STRONG ARM STABILIZER BARS
- RESIDENTIAL PANTRY (SELECT FLOORPLANS)
- RESIDENTIAL 23 CU FT REFRIGERATOR (RES ONLY)
- RESIDENTIAL STYLE 22" OVEN

FOUR SEASONS PACKAGE: (MANDATORY)

- R-38⁺ INSULATION IN ROOF & FLOOR
- R-9 INSULATION IN SIDEWALL
- ATWOOD® HIGH PERFORMANCE FURNACE
- HEATED STORAGE AREA
- HEATED AND ENCLOSED UNDERBELLY
- INSULATED SLIDE FLOORS
- DOUBLE INSULATED BAGGAGE DOORS
- HEATED & ENCLOSED DUMP VALVES
- DIGITAL THERMOSTAT
- EXTREME ARCTIC INSULATION

*CALCULATED

OPTIONS:

- FIREPLACE (MOST FLOORPLANS)
- DYSON VACUUM CLEANER
- ALL DARK WOOD
- ADDITIONAL FANTASTIC FAN
- 2ND A/C (13.5k BTU DUCTED)
- DUAL PANE WINDOWS
- LP GENERATOR PREP
- ONAN 5500 LP GENERATOR
- SLIDE-OUT AWNING COVERS
- 2 EXTRA FOLDING DINETTE CHAIRS
- PATIO DECK (SELECT FLOORPLANS)
- FULL BODY PAINT
- ANNIVERSARY PACKAGE
- 24" BEDROOM TV
- TRAILAIR® AIR RIDE PIN BOX
- CORIAN® ISLAND ON CASTORS (SELECT FLOORPLANS)
- LIFT-TOP COFFEE TABLE

OPEN RANGE ONLY

- 12 CU. FT. REFER
- OTTOMAN W/STORAGE (U-LOUNGE OPTION)
- U-LOUNGE IPO TABLE & CHAIRS/SOFA

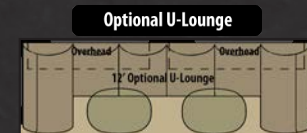

**PLEASE CONTACT YOUR LOCAL DEALER TO ENSURE AVAILABILITY OF STANDARDS AND OPTIONS ON A SPECIFIC FLOORPLAN.

INTERIOR DECORS:



LACE

Sofa Accent
U-Lounge Back
Booth Back



Sofa
Recliner
Booth Dinette
U-Lounge Seat



PINTO

Sofa Accent
U-Lounge Back
Booth Back



Sofa
Recliner
Booth Dinette
U-Lounge Seat



SEDONNA

Sofa Accent
U-Lounge Back
Booth Back



Sofa
Recliner
Booth Dinette
U-Lounge Seat



STORM

Sofa Accent
U-Lounge Back
Booth Back



Sofa
Recliner
Booth Dinette Seat
U-Lounge Seat

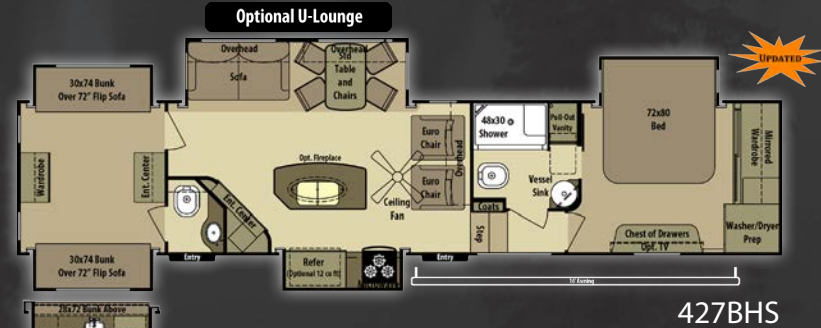
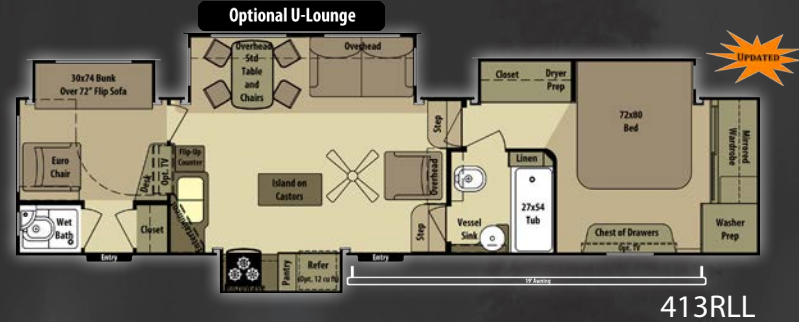
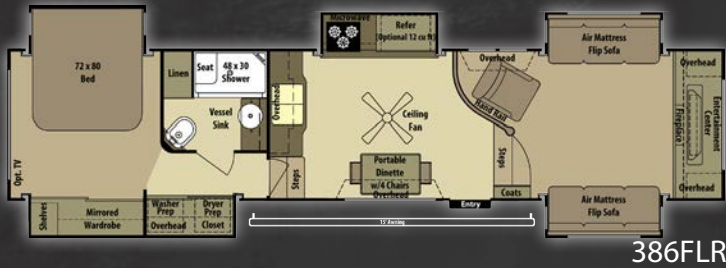
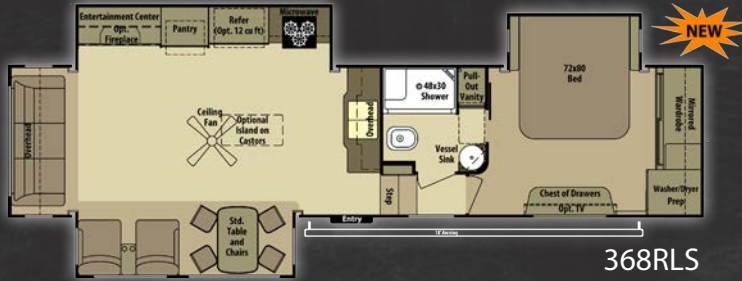

Open Range FIFTH WHEELS

	UVW	Hitch Wt.	Axle Wt.	Gross NCC	Net NCC	Ext. Length	Ext. Height	Ext. Width	Water Heater Gas/Elec	Fresh Water	Gray Water	Waste	LP Gas (Lbs)	Furnace (BTU's)	Tire Size	Awning Size
349RLS	10645	1975	8670	3330	2544	36'1"	155"	100"	10 Gal	85	57	41	80	35,000	16"	16'
368RLS	11115	2390	8725	5275	4489	38'2"	155"	100"	10 Gal	85	51	41	80	40,000	16"	18'
386FLR	11205	2515	8690	5310	4524	40'	155"	100"	10 Gal	85	57	41	80	40,000	16"	15'
388RKS	11860	2375	9485	4515	3729	39'	155"	100"	10 Gal	85	82	41	80	40,000	16"	16'
397FBS	11905	2285	9620	4380	3594	42'	155"	100"	10 Gal	85	82	82	80	40,000	16"	18'
413RLL	11970	2165	9805	4195	3409	39'9"	155"	100"	10 Gal	85	82	82	80	40,000	16"	19'
427BHS	13145	2305	10840	3160	2374	41'9"	155"	100"	10 Gal	85	82	82	80	40,000	16"	16'

Residential FIFTH WHEELS

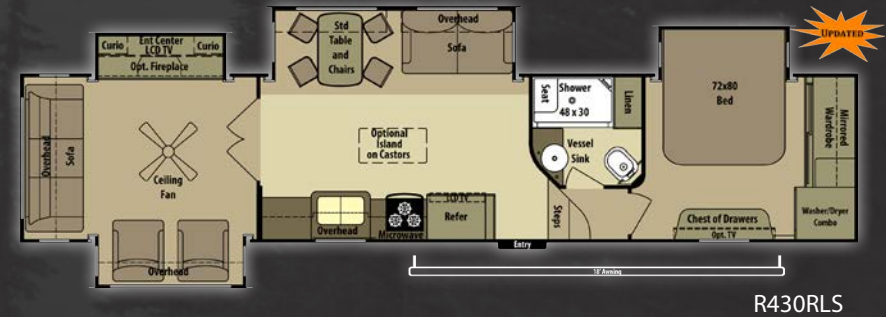

	UVW	Hitch Wt.	Axle Wt.	Gross NCC	Net NCC	Ext. Length	Ext. Height	Ext. Width	Water Heater Gas/Elec	Fresh Water	Gray Water	Waste	LP Gas (Lbs)	Furnace (BTU's)	Tire Size	Awning Size
R398RLS	10995	1960	9035	2965	2179	39'	155"	100"	10 Gal	85	82	41	80	40,000	16"	16'
R417RSS	11795	2386	9409	2591	1805	39'3"	155"	100"	10 Gal	85	82	41	80	40,000	16"	16'
R430RLS	12130	2530	9600	3470	2684	42'	155"	100"	10 Gal	85	82	41	80	40,000	16"	16'

Visit Us @ www.OpenRangeRV.com



- "Build Your Own"
- Detailed Floorplans & Specs
- Contact Information
- Photo Galleries
- Frequently Asked Questions
- Customer Testimonials
- Virtual 360° Videos
- Dealer Locator
- And Much More



PURCHASE LOCALLY

Open Range RV strongly encourages our retail customers to purchase from their local dealership whenever possible due to the following reasons:

- 1) Our Dealers are, as a rule, independently owned and operated businesses. Outside of those customers they personally sold products to, they are not obligated to perform warranty service on Open Range RV products that were purchased elsewhere. There may be an occasion that the customer will be required to return to the point of purchase to satisfy warranty requirements.
- 2) Although many dealerships will eventually service products not purchased at their dealership, they will usually take care of their customers and other Open Range RV customers who are traveling away from their local dealer as a priority.
- 3) Local purchases allow a customer to establish a relationship with a dealer close to home. This relationship provides the customer with a convenient location for service and support from a "local" professional.
- 4) The opportunity for a thorough PDI (Pre Delivery Inspection) and product orientation is an additional benefit of buying from a local dealer. The opportunity for refresher courses or the ability to get questions answered more promptly is another additional benefit of buying from a local dealer.
- 5) For our Canadian customers, there are also requirements which must be met to bring an RV purchased out of the country to their home. Although not impossible, these requirements may involve such things as additional inspections, certifications, taxes and fees. The local Canadian Dealer is a professional at meeting these requirements.
- 6) Open Range's goal is for all RV Owners to fully enjoy their RV experience. In light of this goal, and considering the advantages of buying locally, we encourage you to be thorough when determining what product to purchase and which dealer to purchase it from as both are key to your ultimate satisfaction.



Your Open Range Dealer:

OPEN RANGE

Open Range RV Company 3195 N. St. Rd. 5 Shipshewana, IN 46565

Phone: (260) 768-7771 - www.OpenRangeRV.com

Due to continual research and advances, manufacturer reserves the right to change specifications, design, price, and equipment without notice, and assumes no responsibility for any error in the literature. Some items shown are not included as standard or optional equipment.

©2013 Open Range RV Company, Shipshewana, Indiana

Published Date: Nov. 29th, 2013