



**Jayco**<sup>®</sup>

Generations of family fun.

# EAGLE

2015 TRAVEL TRAILERS AND FIFTH WHEELS BY JAYCO



This 1986 brochure cover inspired our 2015 literature.

**2**  
**YEAR**  
WARRANTY

# BUILT FOR FAMILY-SIZED getaways



**On the cover:** The 1986 brochure artwork, illustrated by Tim MacDonald, was part of a successful ad campaign. These illustrations inspired the 2015 Jayco brochure covers, which are live re-creations of Tim's artwork.



For 45 years, Jayco has helped create generations of family fun, and over the course of that time, fun still looks remarkably the same. From campfires to fishing, from relaxing to eating, fun has the same feel generations later—and all with a Jayco RV nearby. Today, we're the largest family-owned RV manufacturer in the world, and our promise is to continually strive to build family-friendly products that will outlast just about everything but your memories. Join us in our generations of family fun.

**Every family defines fun a little differently,** but thanks to our robust 2015 Eagle lineup, it's easier than ever to find the perfect family getaway. Introducing the Eagle family:



### Eagle Travel Trailers



Jayco's top-of-the-line travel trailer — PAGE 4

	TRAVEL LENGTH		33' 11" - 39' 3"
	WEIGHT		6,605 - 8,710 lbs.
	SLEEPS		3 - 12



### Eagle HT



Our lightest fifth wheel yet — PAGE 8

	TRAVEL LENGTH		25' 5" - 33' 9"
	WEIGHT		6,220 - 8,300 lbs.
	SLEEPS		3 - 10



### Eagle Touring Edition



Tour in affordable comfort — PAGE 10

	TRAVEL LENGTH		31' - 33' 11"
	WEIGHT		7,985 - 9,145 lbs.
	SLEEPS		4 - 8



### Eagle Fifth Wheels



A family-favorite fifth wheel — PAGE 14

	TRAVEL LENGTH		33' 3" - 37' 1"
	WEIGHT		8,650 - 10,305 lbs.
	SLEEPS		3 - 10



### Eagle Premier

Jayco's luxury fifth wheel — PAGE 18

	TRAVEL LENGTH		34' 3" - 42' 4"
	WEIGHT		10,510 - 13,005 lbs.
	SLEEPS		3 - 11



EAGLE TRAVEL TRAILER 338RETS | ALMOND

# Eagle

## Travel Trailers

The 2015 Jayco Eagle travel trailer delivers top-of-the-line comfort in this family-friendly lineup. Brimming with a list of premium standard features, like Heritage Series furniture, room-brightening skylights and a spacious 8 cu. ft. refrigerator, Eagle will put the word *treat* into your next family retreat.



EAGLE TRAVEL TRAILER | 8 CU. FT. FRIDGE



EAGLE TRAVEL TRAILER 338RETS | ALMOND



## PREMIUM STANDARDS

You won't find other travel trailers loaded with so many premium standard features, like LED lighting, a kitchen skylight, dark-tinted frameless windows, residential Shaw carpeting and a command center.



EAGLE TRAVEL TRAILER 338RETS | ALMOND

EAGLE TRAVEL TRAILER 338RETS | ALMOND

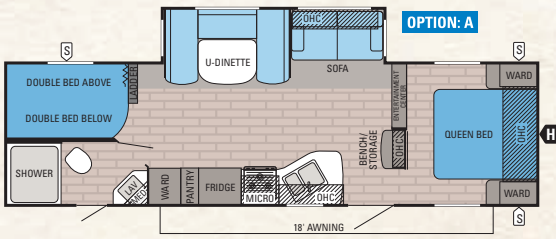

**EAGLE TRAVEL TRAILER | 284BHBE**

Ext. Length: 33' 11" Ext. Height: 137" Unloaded Wt. (lbs.): 6,605 Sleeps: 8-10

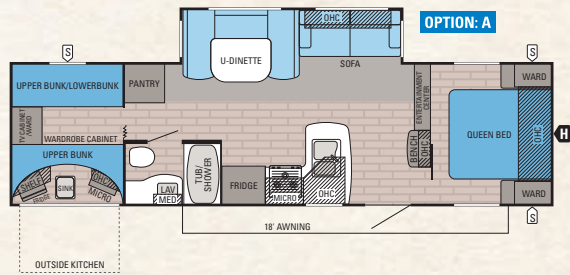

**EAGLE TRAVEL TRAILER | 294QBOK**

Ext. Length: 34' 9" Ext. Height: 138" Unloaded Wt. (lbs.): 6,985 Sleeps: 7-9

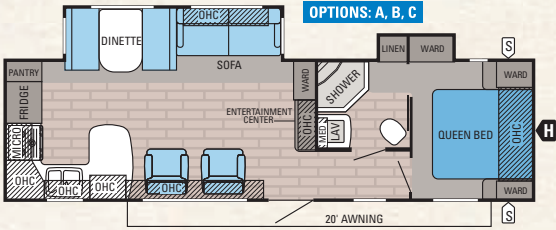

**EAGLE TRAVEL TRAILER | 306RKDS**

Ext. Length: 34' 5" Ext. Height: 138" Unloaded Wt. (lbs.): 7,095 Sleeps: 3-6

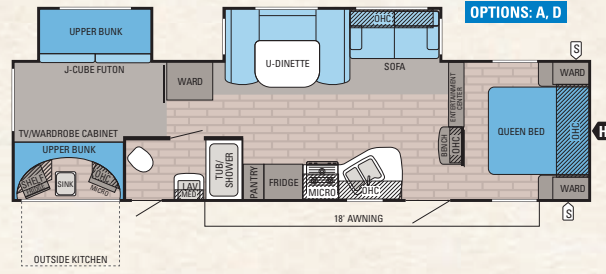

**EAGLE TRAVEL TRAILER | 314BHDS**

Ext. Length: 37' 3" Ext. Height: 137" Unloaded Wt. (lbs.): 7,710 Sleeps: 8-10

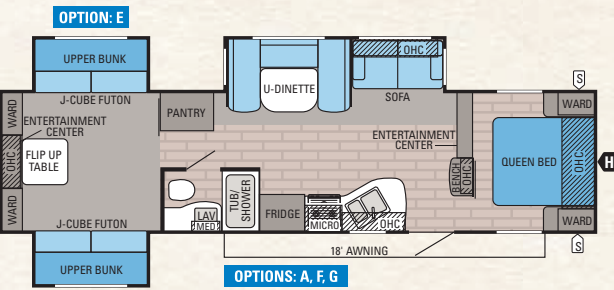

**EAGLE TRAVEL TRAILER | 314TSBH**

Ext. Length: 37' 10" Ext. Height: 137" Unloaded Wt. (lbs.): 7,945 Sleeps: 9-12

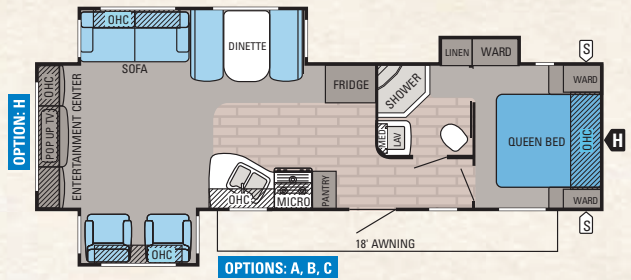

**EAGLE TRAVEL TRAILER | 318RETS**

Ext. Length: 35' 3" Ext. Height: 136" Unloaded Wt. (lbs.): 7,275 Sleeps: 3-6

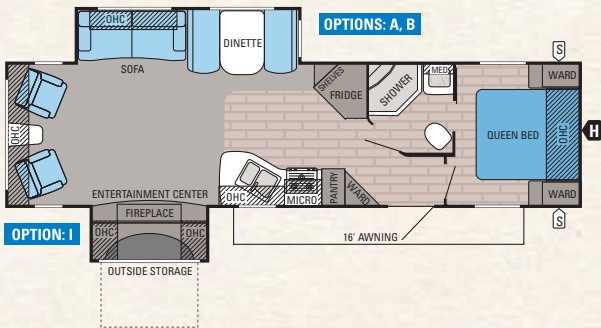

**EAGLE TRAVEL TRAILER | 321RLDS**

Ext. Length: 35' 11" Ext. Height: 135" Unloaded Wt. (lbs.): 7,475 Sleeps: 3-6

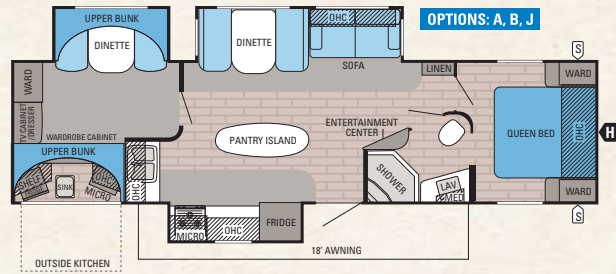

**EAGLE TRAVEL TRAILER | 324BHTS**

Ext. Length: 37' 2" Ext. Height: 138" Unloaded Wt. (lbs.): 8,240 Sleeps: 6-10

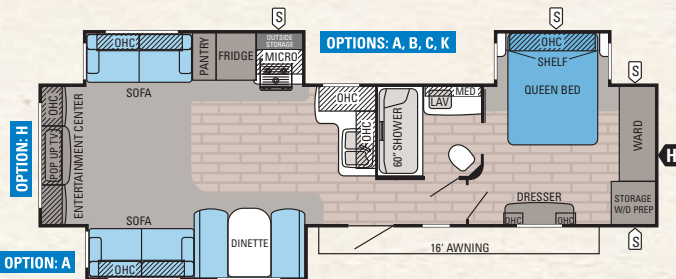

**EAGLE TRAVEL TRAILER | 338RETS**

Ext. Length: 39' 3" Ext. Height: 138" Unloaded Wt. (lbs.): 8,710 Sleeps: 3-8

## FLOORPLAN OPTIONS

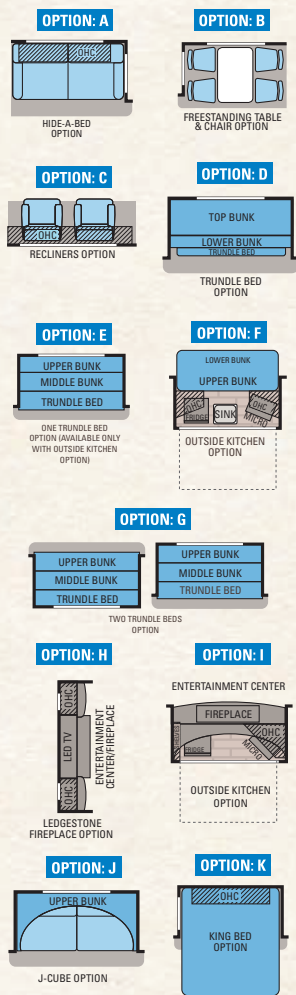

### STANDARD EXTERIOR EQUIPMENT

Deluxe Graphics Package with Russet Brown Glazed accent cap/skirting  
 High-gloss, Ivory fiberglass shell  
 TuffShell vacuum-bonded laminated sidewalls, slideout walls and rear wall  
 Fully enclosed and heated underbelly  
 80-plus gal. fresh water tank  
 Magnum Truss Roof System with one-piece DiFlex II material  
 Climate Shield (see package details)  
 I-Class cambered structural steel I-beams  
 Radial tires  
 Aluminum rims  
 E-Z Lube axles  
 Nev-R-Adjust brakes  
 MOR/ryde CRE 3000 suspension system  
 Completely enclosed and protected slide mechanisms  
 30" x 72" main entrance door  
 Extendable main entrance grab handle  
 Oversized entry step with safety light  
 Exterior marine-grade speakers (2)  
 Frameless, G20 dark-tinted, safety-glass windows  
 Pass-thru basement storage with slam latches and light  
 Electric patio awning with LED lights  
 Outside kitchen (294QBOK, 314BHDS and 324BHTS)  
 Dual battery capacity  
 30-amp power service  
 Black tank flush  
 Cable/satellite prep  
 Digital TV antenna  
 Under-mounted spare tire  
 Frame fully prepped for bike rack/cargo tray

### STANDARD INTERIOR EQUIPMENT

Steel ball bearing drawer guides, 75-lb. capacity, full extension  
 Large, split kitchen sink with (2) cutting board covers and pull-out style kitchen faucet  
 18-gal./hr. quick recovery gas/electric DSI water heater (6 gal.)  
 8 cu. ft. refrigerator  
 LED interior lights throughout  
 Command center for switches, includes 12V cell phone charger  
 Arched 84" ceiling with decorative transitions  
 Closeable and directional air conditioner vents  
 Residential window casing in living areas  
 Sofa pillows  
 Hardwood ceiling mantle with LED lighting and skylight in kitchen and dinette  
 Pleated night shades  
 Glass shower enclosure  
 Porcelain bath stool with foot flush

Pillowtop Denver Mattress with quilted bedspread  
 300-lb. bunk bed capacity (600-lb. 284BHBE)

### CUSTOMER VALUE PACKAGE (MANDATORY)

Outside shower  
 13,500-BTU air conditioner with Chillgrille feature  
 Cap-integrated 30-lb. propane bottles with auto regulator  
 Microwave  
 Oven  
 Water heater bypass  
 Bathroom fan  
 Bath skylight  
 Tile-look tub/shower surround

### PREMIER PACKAGE

Gel-coat sidewalls  
 Key fob remote for slideouts, awnings, patio lights and jacks  
 Raised-panel cabinetry with lumbercore, screwed-style construction  
 Large bath power vent

### TECH PACKAGE

Multi-media premium sound system with AM/FM/CD/DVD player and MP3 input jack (n/a on 338RETS or 318RETS with LedgeStone fireplace option; forced option on 321RLDS)  
 32" HDTV

### OPTIONS

Thermal-pane, tinted, safety-glass windows  
 Electric tongue jack  
 Electric stabilizer jacks  
 Outside kitchen (314TSBH and 321RLDS)  
 Bumper-mounted grill  
 Bike rack/cargo tray  
 15,000-BTU air conditioner  
 2nd air conditioner in bedroom (13,500-BTU)  
 50-amp service with 2nd air conditioner prep (standard 338RETS, 321RLDS)  
 Roof ladder  
 Solid-surface kitchen countertops with undermount sink and covers  
 Free-standing table and chairs (select models)  
 Linoleum in living area (306RKDS, 318RETS, 321RLDS and 338RETS)  
 LedgeStone fireplace with 40" HDTV (318RETS and 338RETS)  
 Recliners in lieu of swivel chairs (306RKDS, 318RETS and 321RLDS)  
 Recliners in lieu of door-side sofa (338RETS)  
 Hide-a-bed sofa with tri-fold Denver Mattress  
 Door-side hide-a-bed sofa with tri-fold Denver Mattress (338RETS)  
 King-sized bed (338RETS)  
 Trundle bed in lieu of J-Cube (314BHDS and 314TSBH)  
 J-Cube futon with folding bunk (324BHTS)

## SPECIFICATIONS

MODELS	DIMENSIONS				WEIGHTS (LBS.)				TANKS (GALS.)		
	FLOORPLAN	EXTERIOR TRAVEL LENGTH	EXTERIOR WIDTH	EXT. HEIGHT (WITH A/C)	INTERIOR HEIGHT	UNLOADED VEHICLE WEIGHT*	DRY HITCH WEIGHT	GROSS VEHICLE WEIGHT RATING	CARGO CARRYING CAPACITY	FRESH (INCLUDES WATER HEATER)	GRAY
284BHBE	33' 11"	96"	137"	84"	6,605	630	9,250	2,645	82	32.5	32.5
294QBOK	34' 9"	96"	138"	84"	6,985	760	9,500	2,515	82	40.5	32.5
306RKDS	34' 5"	96"	138"	84"	7,095	1,025	9,750	2,655	82	65	32.5
314BHDS	37' 3"	96"	137"	84"	7,710	920	9,975	2,265	82	40.5	32.5
314TSBH	37' 10"	96"	137"	84"	7,945	860	10,750	2,805	82	40.5	32.5
318RETS	35' 3"	96"	136"	84"	7,275	815	9,975	2,700	82	32.5	32.5
321RLDS	35' 11"	96"	139"	84"	7,475	1,035	10,250	2,775	86	32.5	32.5
324BHTS	37' 2"	96"	138"	84"	8,240	940	10,950	2,710	86	65	32.5
338RETS	39' 3"	96"	138"	85"	8,710	1,140	10,950	2,240	84	65	32.5

\*The weights of certain options and/or option packages are not included in the UVW listed in the specification charts.

**Unloaded Vehicle Weight (UVW):** Sometimes referred to as "Dry Weight," UVW means the typical weight of this trailer as built at the factory. The UVW, as used in product literature and other promotional materials, does not include cargo, fresh water, propane, options or dealer-installed accessories.

**Gross Vehicle Weight Rating (GVWR):** GVWR means the maximum permissible weight of the trailer, including the UVW plus passengers, personal items, all cargo, fluids, options, and dealer-installed accessories. The GVWR is equal to or greater than the sum of the UVW and the CCC.

**Cargo Carrying Capacity (CCC):** CCC means the maximum weight of all passengers, personal items, food, fresh water, propane, tools, other cargo and dealer-installed accessories that can be carried by the trailer. CCC is equal to or less than GVWR minus UVW. The addition of options will decrease the CCC.

**Hitch Weight (HW):** The hitch weight, as used in product literature and other promotional materials, does not include cargo, fresh water, propane gas, options or dealer-installed accessories. The addition of these types of items will either add to or subtract from the stated hitch weight.

It is important for your safety and enjoyment that your tow vehicle be adequately sized and equipped to tow and handle the GVWR of the RV you select. Review weights and rating of your tow vehicle and consult a competent advisor for questions or advice. Whether you are new to RVing or a veteran, get a feel for the performance of your tow vehicle before heading out on the roadways. When you tow an RV, you must drive differently than when you drive a single vehicle. Practice hooking up, driving, backing up and braking in a safe environment or seek out professional instruction. Jayco affixes a weight label to each RV which lists weight information for that vehicle. See specifications chart above.



EAGLE HT FIFTH WHEEL 29.5BHDS | PEWTER

# Eagle HT

## Lightweight Fifth Wheels

The 2015 Eagle HT is our lightest fifth wheel yet, but don't let its lightweight label fool you. This spacious model is loaded with conveniences that make it just as fun to camp in as it is to tow. From full-featured kitchens — inside and out — to a myriad of sleeping arrangements, including Denver Mattress bunk beds, Eagle HT packs lightweight fun.

### YOUR TRUCK HAS MET ITS LIGHTWEIGHT MATCH

MAKE	MODEL	ENGINE	CAB/BED	AXLE RATIO / EQUIPMENT
<b>Chevrolet</b>	Silverado 1500 2WD	6.2L V-8	Extended/Standard	3.73:1, Towing Package
<b>Dodge</b>	Ram 1500 2WD	5.7L V-8	Regular/Short	3.73:1, 5-speed AT
<b>Ford</b>	F-150 2WD	5.0L V-8	Regular/Long	3.73:1
<b>GMC</b>	Sierra 1500 2WD	6.2L V-8	Extended/Standard	3.73:1, Towing Package
<b>Nissan</b>	Titan 2WD	5.6L V-8	King/Short	Premium Utility Package
<b>Toyota</b>	Tundra 2WD	5.7L V-8	Regular/Long	Towing Package

\*It is important for your safety and enjoyment that your tow vehicle be adequately sized and equipped to tow and handle the GVWR of the RV you select. Review weights and rating of your tow vehicle and consult a competent advisor for questions or advice.



EAGLE HT FIFTH WHEEL 29.5BHDS | PEWTER





#### STANDARD EXTERIOR EQUIPMENT

Deluxe Graphics Package with Russet Brown front cap and radius skirt  
 Ivory high-gloss, gel-coated fiberglass sidewalls  
 TuffShell vacuum-bonded laminated sidewalls, slideout walls and rear wall  
 I-Class cambered structural steel I-beams  
 Fully enclosed and heated underbelly  
 Magnum Truss Roof System with one-piece DiFlex II material  
 Climate Shield (see package details)  
 Radial tires  
 E-Z Lube axles  
 Nev-R-Adjust brakes  
 Completely enclosed and protected slideout mechanisms  
 30" x 72" main entrance door with oversized entry step with safety light  
 Extendable grab handle at main entry  
 Exterior marine-grade speakers (2)  
 Large pass-thru basement storage (n/a 23.5RBS)  
 Slam latches on all pass-through compartment doors  
 Maxi Stor storage (27.5BHS)  
 Large patio scare light  
 Frameless, G20 dark-tinted, safety-glass windows  
 Black tank flush  
 Outside shower  
 Cable/satellite prep and digital TV antenna  
 30-amp power service  
 Battery disconnect switch  
 Rear hitch prep with wiring  
 Stabilizer jacks (2)

#### STANDARD INTERIOR EQUIPMENT

Hardwood cabinetry with lumbercore, screwed-stile construction  
 Steel ball bearing drawer guides, 75-lb. capacity, full extension  
 Oversized pots and pans drawers (select models)  
 Full-height kitchen cabinetry  
 Large, split kitchen sink with pull-out style kitchen faucet  
 Kitchen countertop extension (select models)  
 6 cu. ft. Norcold refrigerator with adjustable temperature  
 18-gal./hr. quick recovery gas/electric DSI water heater (6 gal.)  
 Key fob remote for slideouts, awning, patio light and jacks  
 Command center for switches with 12V cell phone charger  
 Hardwood ceiling mantle with LED lighting and skylight in kitchen and dinette  
 (kitchen skylight n/a in 23.5RBS)  
 LED lighting throughout  
 Heritage Series hide-a-bed sofa with tri-fold Denver Mattress  
 Sofa pillows  
 32" LED HDTV (26" in 23.5RBS)  
 Residential window casing in living areas  
 Pleated night shades  
 Private bath with porcelain bath stool and foot flush  
 Glass shower enclosure (n/a 23.5RBS)  
 60" x 80" pillowtop Denver Mattress  
 300-lb. rated bunk bed capacity (select models) (600 lbs. on 29.5BHDS)

#### CUSTOMER VALUE PACKAGE (MANDATORY)

Electric patio awning with LED lights  
 Aluminum rims  
 Under-mounted spare tire  
 Dual 30-lb. propane gas bottles with auto regulator  
 13,500-BTU air conditioner with Chillgrille and closeable, directional A/C vents  
 Water heater bypass  
 Microwave oven  
 Kitchen sink cutting board covers (2)  
 Multi-media premium sound system with AM/FM, CD/DVD and MP3 input jack  
 Bath skylight  
 Tile look tub/shower surround  
 Quilted bedspread  
 Dual shirt closets in main bedroom

#### OPTIONS

MOR/ryde pin box  
 Electric rear stabilizer jacks  
 Bolt-on rear hitch  
 Rear bumper-mounted grill  
 Thermal-pane, tinted, safety-glass windows  
 15,000-BTU air conditioner  
 Free-standing table and 4 chairs (select models)  
 Living area linoleum (select models)  
 Recliner rocker(s) in lieu of swivel rocker(s) (26.5RKS, 26.5RLS and 27.5RLTS)  
 Electric fireplace (28.5RSTS)



EAGLE HT FIFTH WHEEL 29.5BHDS | PEWTER



EAGLE TOURING EDITION FIFTH WHEEL 28.5RLTS | CHESTNUT

## Eagle Touring Edition

The 2015 Eagle Touring Edition has so many residential touches you might forget you left home in a fifth wheel. This affordable fifth wheel boasts Shaw carpet, a top-selling brand in residential homes, along with durable Diamondfloor vinyl flooring. Stunning Amish-crafted cabinetry, standard skylights and spacious slideouts will complete your comfortable tour.



RESIDENTIAL-GRADE SHAW CARPETING



EAGLE TOURING EDITION FIFTH WHEEL 28.5RLTS | CHESTNUT



EAGLE TOURING EDITION FIFTH WHEEL 28.5RLTS | CHESTNUT

#### STANDARD EXTERIOR EQUIPMENT

Deluxe Graphics Package with Russet Brown Glazed accent cap and skirting  
 Ivory high-gloss, gel-coated fiberglass sidewalls  
 TuffShell vacuum-bonded laminated sidewalls, slideout walls and rear wall  
 Fully enclosed and heated underbelly  
 Magnum Truss Roof System with one-piece DiFlex II material  
 Climate Shield (see package details)  
 I-Class cambered structural steel I-beams  
 E-Z Lube axles  
 Nev-R-Adjust brakes  
 MOR/ryde CRE 3000 suspension system  
 30" x 72" main entrance door  
 Frameless, G20 dark-tinted, safety-glass windows  
 Drop-frame, pass-thru storage  
 Cable TV and outlet in basement  
 Electric patio awning with LED lights  
 Exterior marine-grade speakers (2)  
 Outside kitchen (28.5BHDS and 31.5BHTS)  
 Dual 30-lb. propane gas bottles with auto regulator  
 Enclosed and heated Uni-Dock utility center  
 Black tank flush  
 Oversized fresh water system and holding tanks  
 50-amp service  
 Cable/satellite prep  
 Bedroom air conditioner prep  
 Electric, wide-stance rear stabilizer jacks

#### STANDARD INTERIOR EQUIPMENT

Raised-panel cabinetry with lumbercore, screwed construction  
 Steel ball bearing drawer guides, 75-lb. capacity, full extension  
 20-gal./hr. quick recovery gas/electric DSI water heater (10 gal.)  
 8 cu. ft. refrigerator  
 Oversized 21" oven  
 Command center for switches includes 12V cell phone charger  
 32" HDTV  
 Key fob remote for slideouts, awning, patio light and jacks  
 Hardwood ceiling mantle with LED lighting and skylight in kitchen and dinette  
 LED interior lights throughout  
 Ceiling fan  
 Closeable and directional air conditioner vents  
 Residential window casing in living areas  
 Hide-a-bed sofa with tri-fold Denver Mattress  
 Sofa pillows  
 Porcelain bath stool with foot flush  
 60" x 80" pillowtop Denver Mattress with quilted bedspread  
 300-lb. bunk bed capacity

#### CUSTOMER VALUE PACKAGE (MANDATORY)

Outside shower  
 13,500-BTU air conditioner with Chillgrille feature  
 Outside speakers (2)  
 Roof ladder  
 Security light  
 Spare tire with carrier  
 Multi-media premium sound system with AM/FM/CD/DVD and MP3 input jack  
 3-burner range with oven  
 Microwave  
 Water heater bypass  
 Black tank flush  
 Tile-look tub/shower surround

#### OPTIONS

Keyless main entrance door  
 Thermal-pane, tinted, safety-glass windows  
 MOR/ryde pin box  
 Outside grill (standard 28.5BHDS and 31.5BHTS)  
 Bolt-on rear hitch  
 15,000-BTU air conditioner  
 Solid-surface kitchen countertops with undermount sink/covers  
 Free-standing table and chairs (standard on 28.5RLTS and n/a 31.5BHTS)  
 Linoleum in living area (28.5RLTS and 29.5RLDS)  
 J-Cube in lieu of bunk room dinette (28.5RLTS and 31.5BHTS)  
 Recliners in lieu of swivel chairs (select models)  
 2nd air conditioner in bedroom, 13,500-BTU ducted

## EAGLE HT FLOORPLANS

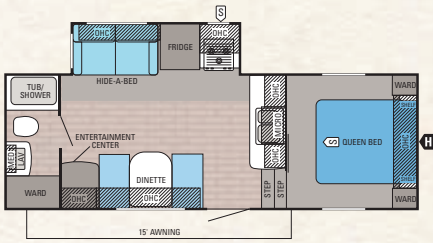

**EAGLE HT FIFTH WHEEL | 23.5RBS**

Ext. Length: 25' 5" Ext. Height: 141" Unloaded Wt. (lbs.): 6,220 Sleeps: 4-6

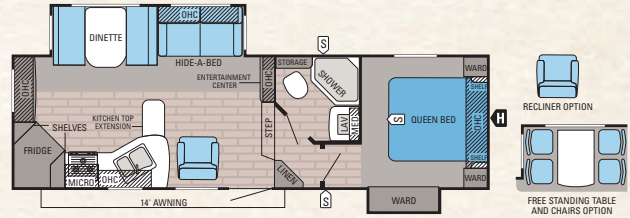

**EAGLE HT FIFTH WHEEL | 26.5RKS**

Ext. Length: 29' 4" Ext. Height: 145" Unloaded Wt. (lbs.): 7,040 Sleeps: 6

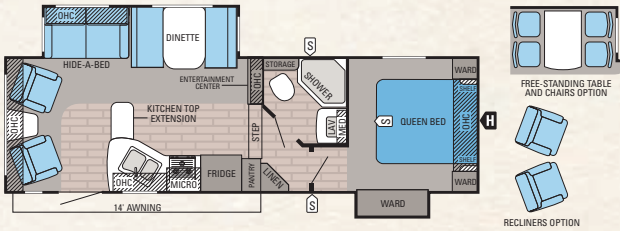

**EAGLE HT FIFTH WHEEL | 26.5RLS**

Ext. Length: 29' Ext. Height: 147" Unloaded Wt. (lbs.): 7,170 Sleeps: 5

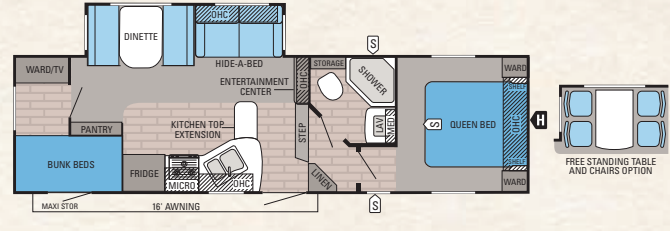

**EAGLE HT FIFTH WHEEL | 27.5BHS**

Ext. Length: 30' 11" Ext. Height: 147" Unloaded Wt. (lbs.): 7,195 Sleeps: 8

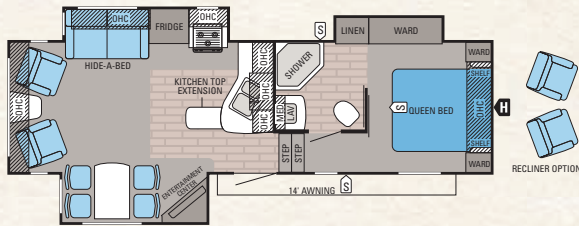

**EAGLE HT FIFTH WHEEL | 27.5RLTS**

Ext. Length: 30' Ext. Height: 141" Unloaded Wt. (lbs.): 7,625 Sleeps: 3

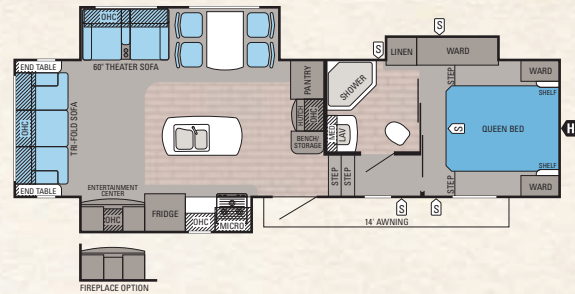

**EAGLE HT FIFTH WHEEL | 28.5BHS**

Ext. Length: 32' 5" Ext. Height: 144" Unloaded Wt. (lbs.): 8,110 Sleeps: 3-4

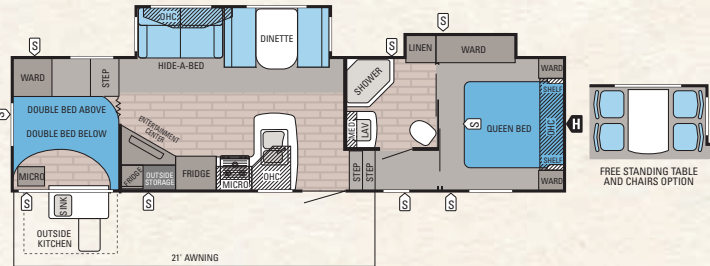

**EAGLE HT FIFTH WHEEL | 29.5BHDS**

Ext. Length: 33' 9" Ext. Height: 148" Unloaded Wt. (lbs.): 8,300 Sleeps: 8-10

## EAGLE HT SPECIFICATIONS

MODELS	DIMENSIONS				WEIGHTS (LBS.)				TANKS (GALS.)			
	FLOORPLAN	EXTERIOR TRAVEL LENGTH*	EXTERIOR WIDTH	EXT. HEIGHT (WITH A/C)	INTERIOR HEIGHT	UNLOADED VEHICLE WEIGHT**	DRY HITCH WEIGHT	GROSS VEHICLE WEIGHT RATING	CARGO CARRYING CAPACITY	FRESH (INCLUDES WATER HEATER)	GRAY	BLACK
23.5RBS	23	25' 5"	96"	141"	73"	6,220	1,235	9,950	3,730	48	65	32.5
26.5RKS	26	29' 4"	96"	145"	75"	7,040	1,380	9,950	2,910	48	65	32.5
26.5RLS	26	29'	96"	147"	77"	7,170	1,325	9,950	2,780	48	65	32.5
27.5BHS	27	30' 11"	96"	147"	79"	7,195	1,340	9,950	2,755	48	65	32.5
27.5RLTS	27	30'	96"	141"	74"	7,625	1,260	9,950	2,325	48	65	32.5
28.5RSTS	28	32' 5"	96"	144"	74"	8,110	1,435	9,950	1,840	48	65	32.5
29.5BHDS	29	33' 9"	96"	148"	74"	8,300	1,515	9,950	1,650	48	73	32.5

\*Distance from the pin box to the bumper; total exterior length may be longer. \*\*The weights of certain options and/or option packages are not included in the UUV listed in the specification charts.

# EAGLE TOURING EDITION FLOORPLANS

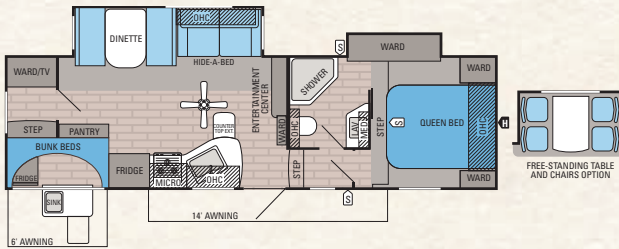

## EAGLE TOURING EDITION | 28.5BHDS

Ext. Length: 31' 1" Ext. Height: 143" Unloaded Wt. (lbs.): 8,180 Sleeps: 6-8

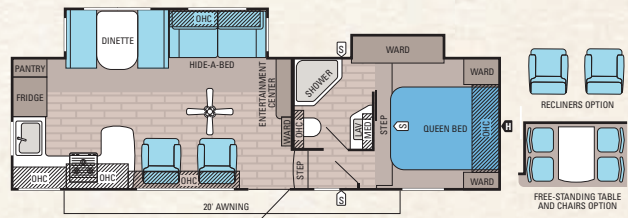

## EAGLE TOURING EDITION | 28.5RKDS

Ext. Length: 31' Ext. Height: 145" Unloaded Wt. (lbs.): 8,010 Sleeps: 4-6

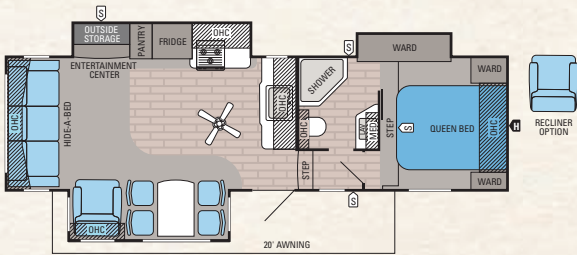

## EAGLE TOURING EDITION | 28.5RLTS

Ext. Length: 31' 5" Ext. Height: 142" Unloaded Wt. (lbs.): 8,290 Sleeps: 4-6

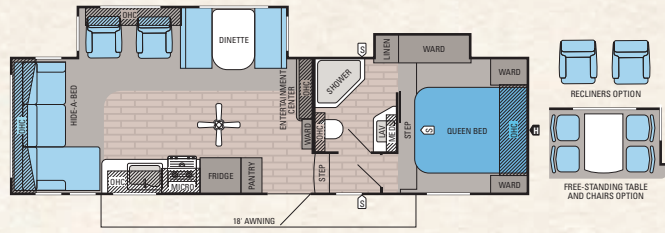

## EAGLE TOURING EDITION | 29.5RLDS

Ext. Length: 31' 8" Ext. Height: 142" Unloaded Wt. (lbs.): 7,985 Sleeps: 4-6

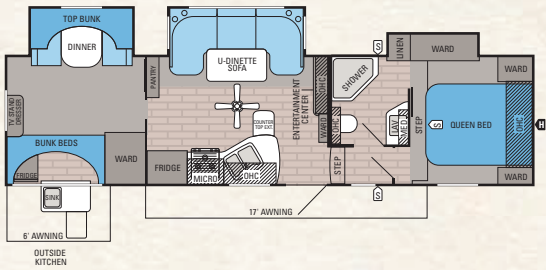

## EAGLE TOURING EDITION | 31.5BHDS

Ext. Length: 33' 11" Ext. Height: 146" Unloaded Wt. (lbs.): 9,145 Sleeps: 6-7

- S STORAGE
- H TRAILER HITCH
- LAV BATHROOM SINK
- MICRO MICROWAVE
- OHC OVERHEAD CABINETS
- FRIDGE REFRIGERATOR
- WARD WARDROBE

# EAGLE TOURING EDITION SPECIFICATIONS

MODELS	DIMENSIONS					WEIGHTS (LBS.)				TANKS (GALS.)		
	FLOORPLAN	EXTERIOR TRAVEL LENGTH*	EXTERIOR WIDTH	EXT. HEIGHT (WITH A/C)	EXT. HEIGHT (WITH OPT. BEDROOM A/C)	INTERIOR HEIGHT	UNLOADED VEHICLE WEIGHT**	DRY HITCH WEIGHT	GROSS VEHICLE WEIGHT RATING	CARGO CARRYING CAPACITY	FRESH (INCLUDES WATER HEATER)	GRAY
28.5BHDS	31' 1"	96"	143"	146"	73"	8,180	1,635	9,950	1,770	73	62	31
28.5RKDS	31'	96"	145"	145"	72"	8,010	1,710	10,500	2,490	73	62	31
28.5RLTS	31' 5"	96"	142"	146"	73"	8,290	1,825	10,500	2,210	73	29	29
29.5RLDS	31' 8"	96"	142"	146"	73"	7,985	1,795	9,950	1,965	73	62	31
31.5BHDS	33' 11"	96"	146"	146"	72"	9,145	1,810	11,250	2,105	73	62	31

\*Distance from the pin box to the bumper; total exterior length may be longer. \*\*The weights of certain options and/or option packages are not included in the UJVW listed in the specification charts.

**Unloaded Vehicle Weight (UVW):** Sometimes referred to as "Dry Weight," UVW means the typical weight of this trailer as built at the factory. The UVW, as used in product literature and other promotional materials, does not include cargo, fresh water, propane, options or dealer-installed accessories.

**Gross Vehicle Weight Rating (GVWR):** GVWR means the maximum permissible weight of the trailer, including the UVW plus passengers, personal items, all cargo, fluids, options, and dealer-installed accessories. The GVWR is equal to or greater than the sum of the UVW and the CCC.

**Cargo Carrying Capacity (CCC):** CCC means the maximum weight of all passengers, personal items, food, fresh water, propane, tools, other cargo and dealer-installed accessories that can be carried by the trailer. CCC is equal to or less than GVWR minus UVW. The addition of options will decrease the CCC.

**Hitch Weight (HW):** The hitch weight, as used in product literature and other promotional materials, does not include cargo, fresh water, propane gas, options or dealer-installed accessories. The addition of these types of items will either add to or subtract from the stated hitch weight.

It is important for your safety and enjoyment that your tow vehicle be adequately sized and equipped to tow and handle the GVWR of the RV you select. Review weights and rating of your tow vehicle and consult a competent advisor for questions or advice. Whether you are new to RVing or a veteran, get a feel for the performance of your tow vehicle before heading out on the roadways. When you tow an RV, you must drive differently than when you drive a single vehicle. Practice hooking up, driving, backing up and braking in a safe environment or seek out professional instruction. Jayco affixes a weight label to each RV which lists weight information for that vehicle. See specifications chart above and left.



EAGLE FIFTH WHEEL 34.5BHTS | CHESTNUT

# Eagle

## Fifth Wheels

The 2015 Eagle fifth wheel gives you countless reasons to love camping, starting with the newest touches we've added to this popular lineup. Boasting L-shaped sofas, functional kitchens, kid-favorite bunk rooms and a private bedroom with Denver Mattress, you're certain to find a perfect getaway.



EAGLE FIFTH WHEEL 33.5RETS | ALMOND



EAGLE FIFTH WHEEL 33.5RETS | ALMOND



## OUR NEWEST TOUCHES

This 2015 lineup delivers stylish functionality with solid-surface countertops, skylights and LED lighting throughout.



EAGLE FIFTH WHEEL 33.5RETS | ALMOND

EAGLE FIFTH WHEEL 34.5BHTS | CHESTNUT

## EAGLE FIFTH WHEEL FLOORPLANS

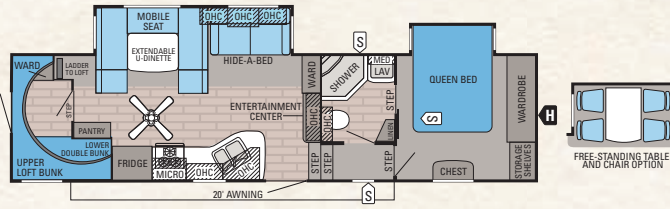

### EAGLE FIFTH WHEEL | 30.5BHLT

Ext. Length: 33' 10" Ext. Height: 156" Unloaded Wt. (lbs.): 9,170 Sleeps: 9

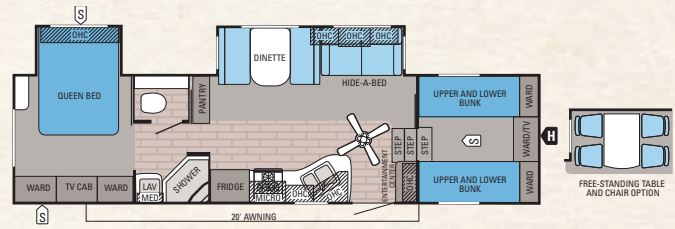

### EAGLE FIFTH WHEEL | 31.5FBHS

Ext. Length: 33' 5" Ext. Height: 156" Unloaded Wt. (lbs.): 8,650 Sleeps: 10

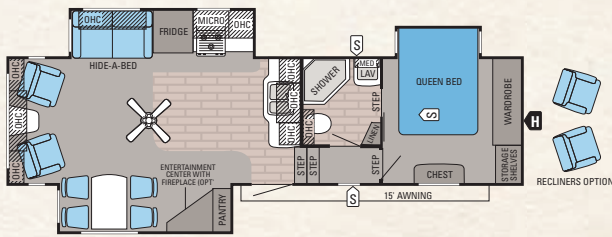

### EAGLE FIFTH WHEEL | 31.5RLTS

Ext. Length: 33' 3" Ext. Height: 150" Unloaded Wt. (lbs.): 9,325 Sleeps: 4

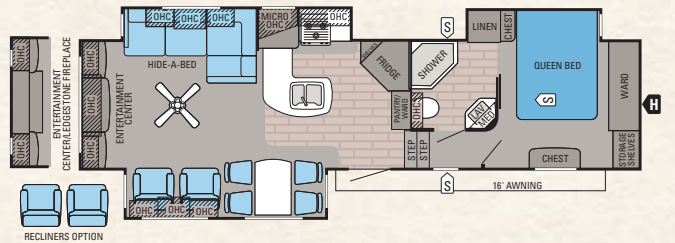

### EAGLE FIFTH WHEEL | 33.5RETS

Ext. Length: 35' 5" Ext. Height: 160" Unloaded Wt. (lbs.): 9,805 Sleeps: 3-4

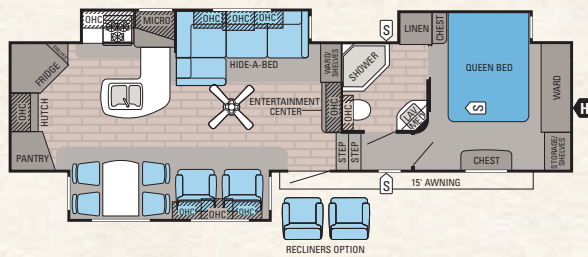

### EAGLE FIFTH WHEEL | 33.5RKTS

Ext. Length: 35' 5" Ext. Height: 161" Unloaded Wt. (lbs.): 9,980 Sleeps: 3-4

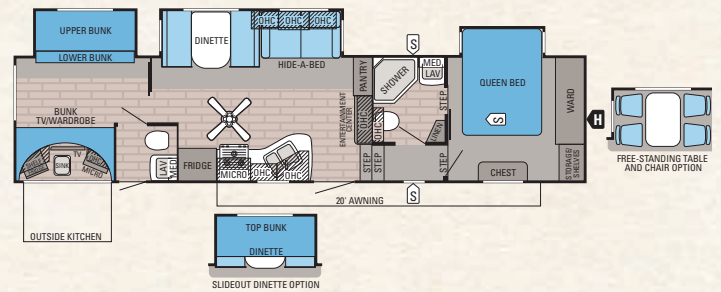

### EAGLE FIFTH WHEEL | 34.5BHTS

Ext. Length: 37' 1" Ext. Height: 149" Unloaded Wt. (lbs.): 10,305 Sleeps: 6-9

## EAGLE FIFTH WHEEL SPECIFICATIONS

MODELS	DIMENSIONS					WEIGHTS (LBS.)				TANKS (GALS.)		
	FLOORPLAN	EXTERIOR TRAVEL LENGTH*	EXTERIOR WIDTH	EXT. HEIGHT (WITH A/C)	EXT. HEIGHT (WITH OPT. BEDROOM A/C)	INTERIOR HEIGHT	UNLOADED VEHICLE WEIGHT**	DRY HITCH WEIGHT	GROSS VEHICLE WEIGHT RATING	CARGO CARRYING CAPACITY	FRESH (INCLUDES WATER HEATER)	GRAY
30.5BHLT	33' 10"	96"	156"	158"	73"	9,170	1,710	11,700	2,530	96	65	32.5
31.5FBHS	33' 5"	96"	156"	158"	69"	8,650	1,685	11,200	2,550	85	65	32.5
31.5RLTS	33' 3"	96"	150"	158"	73"	9,325	1,975	11,900	2,575	86	65	32.5
33.5RETS	35' 5"	96"	160"	160"	76"	9,805	1,835	11,995	2,190	85	65	32.5
33.5RKTS	35' 5"	96"	161"	161"	76"	9,980	2,085	12,250	2,270	85	65	32.5
34.5BHTS	37' 1"	96"	149"	158"	73"	10,305	1,835	12,995	2,690	85	73	65

\*Distance from the pin box to the bumper; total exterior length may be longer. \*\*The weights of certain options and/or option packages are not included in the UJVW listed in the specification charts.

**Unloaded Vehicle Weight (UVW):** Sometimes referred to as "Dry Weight," UVW means the typical weight of this trailer as built at the factory. The UVW, as used in product literature and other promotional materials, does not include cargo, fresh water, propane, options or dealer-installed accessories.

**Gross Vehicle Weight Rating (GVWR):** GVWR means the maximum permissible weight of the trailer, including the UVW plus passengers, personal items, all cargo, fluids, options, and dealer-installed accessories. The GVWR is equal to or greater than the sum of the UVW and the CCC.

**Cargo Carrying Capacity (CCC):** CCC means the maximum weight of all passengers, personal items, food, fresh water, propane, tools, other cargo and dealer-installed accessories that can be carried by the trailer. CCC is equal to or less than GVWR minus UVW. The addition of options will decrease the CCC.

**Hitch Weight (HW):** The hitch weight, as used in product literature and other promotional materials, does not include cargo, fresh water, propane gas, options or dealer-installed accessories. The addition of these types of items will either add to or subtract from the stated hitch weight.

It is important for your safety and enjoyment that your tow vehicle be adequately sized and equipped to tow and handle the GVWR of the RV you select. Review weights and rating of your tow vehicle and consult a competent advisor for questions or advice. Whether you are new to RVing or a veteran, get a feel for the performance of your tow vehicle before heading out on the roadways. When you tow an RV, you must drive differently than when you drive a single vehicle. Practice hooking up, driving, backing up and braking in a safe environment or seek out professional instruction. Jayco affixes a weight label to each RV which lists weight information for that vehicle. See specifications chart above.





## FRAMELESS WINDOWS

For 2015, we introduced hassle-free standard frameless windows on all of our Eagle products, while all Jayco fifth wheels and travel trailers boast new residential window casings in the living areas.



## RESIDENTIAL FEATURES

Eagle is best known for its home-like features, and for 2015, we're packing in more comfort for the family, including residential-grade Shaw carpet, durable Diamondflor vinyl flooring and a comfortable Denver Mattress.

### STANDARD EXTERIOR EQUIPMENT

Deluxe Graphics Package with Russet Brown Glazed accent cap and skirting  
 Ivory high-gloss, gel-coated fiberglass sidewalls  
 TuffShell vacuum-bonded laminated sidewalls, slideout walls and rear wall  
 Fully enclosed and heated underbelly  
 Magnum Truss Roof System with one-piece DiFlex II material  
 Climate Shield (see package details)  
 I-Class cambered structural steel I-beams  
 E-Z Lube axles  
 Nev-R-Adjust brakes  
 MOR/ryde CRE 3000 suspension system  
 30" x 72" main entrance door  
 Frameless, G20 dark-tinted, safety-glass windows  
 Pass-thru storage (n/a 31.5FBHS)  
 Slam-latch baggage doors  
 Exterior marine-grade speakers (2)  
 Outside kitchen (34.5BHTS)  
 Dual 30-lb. propane gas bottles with auto regulator  
 Enclosed and heated Uni-Dock utility center  
 Black tank flush  
 85-plus gal. fresh water tanks  
 50-amp service  
 Cable/satellite prep  
 Bedroom air conditioner prep  
 Electric, wide-stance rear stabilizer jacks  
 Under-mounted spare tire  
 Frame fully prepped for bike rack/cargo tray (n/a 30.5BHLT)

### STANDARD INTERIOR EQUIPMENT

Raised-panel cabinetry with lumbercore, screwed construction  
 Steel ball bearing drawer guides, 75-lb. capacity, full extension  
 20-gal./hr. quick recovery gas/electric DSI water heater (10 gal.)  
 8 cu. ft. refrigerator  
 Command center for switches includes 12V cell phone charger  
 Key fob remote for slideouts, awning, patio light and jacks  
 Residential window casing in living areas  
 Ceiling fan  
 Closeable and directional air conditioner vents  
 Hardwood ceiling mantle with LED lighting and skylight in kitchen and dinette  
 LED interior lights throughout  
 Hide-a-bed sofa with tri-fold Denver Mattress  
 Sofa pillows  
 Porcelain bath stool with foot flush  
 60" x 80" pillowtop Denver Mattress with quilted bedspread  
 300-lb. bunk bed capacity

### CUSTOMER VALUE PACKAGE (MANDATORY)

16" radial tires with aluminum rims  
 Electric patio awning with LED lights  
 Outside shower  
 13,500-BTU air conditioner with Chillgrille feature  
 32" HDTV  
 Multi-media premium sound system with AM/FM/CD/DVD and MP3 input jack  
 Microwave  
 Oversized 21" oven  
 Water heater bypass  
 Bath power vent  
 Tile-look tub/shower surround

### OPTIONS

Keyless main entrance door  
 Thermal-pane, tinted, safety-glass windows  
 MOR/ryde pin box  
 Bumper-mounted grill  
 Bike rack/cargo tray (n/a 30.5BHLT)  
 15,000-BTU air conditioner  
 Solid-surface kitchen countertops with undermount sink/covers  
 Free-standing table and chairs (standard 31.5RLTS, 33.5RETS and 33.5RKTS)  
 Electric fireplace (31.5RLTS)  
 Ledgestone fireplace with 40" HDTV (33.5RETS)  
 Linoleum in living area (31.5RLTS and 33.5RETS)  
 Recliners in lieu of swivel chairs (select models)  
 2nd air conditioner in bedroom, 13,500-BTU ducted  
 Dinette with folding bunk in bunk room (34.5BHTS)



EAGLE PREMIER FIFTH WHEEL 361REQS | BROWNSTONE

# Eagle Premier

**Fifth Wheels**

The name *Eagle Premier* says it all. This extraordinary fifth wheel delivers more premium upgrades than anything in its price range, making it the envy of the campground. Starting in the kitchen and moving into the bathroom, Premier flaunts stunning solid-surface countertops and Amish-crafted cabinetry. Outside, select model exterior kitchens boast a standard 32" LED television.



EAGLE PREMIER 361REQS | BROWNSTONE



EAGLE PREMIER FIFTH WHEEL 361REQS | BROWNSTONE



## PREMIUM COMFORT

The Eagle Premier wouldn't be premier without high-end comforts. From the new Heritage Series furniture line to the master suite's cedar-lined, walk-in closet, this fifth wheel has it all.



EAGLE PREMIER FIFTH WHEEL 375BHFS | ALMOND

EAGLE PREMIER 361REQS | BROWNSTONE

## EAGLE PREMIER FIFTH WHEEL FLOORPLANS

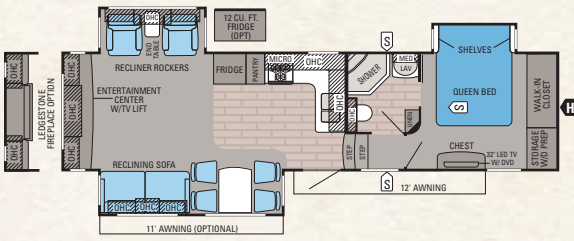

### EAGLE PREMIER | 321RLTS

Ext. Length: 34' 3" Ext. Height: 159" Unloaded Weight (lbs.): 10,510 Sleeps: 4-6

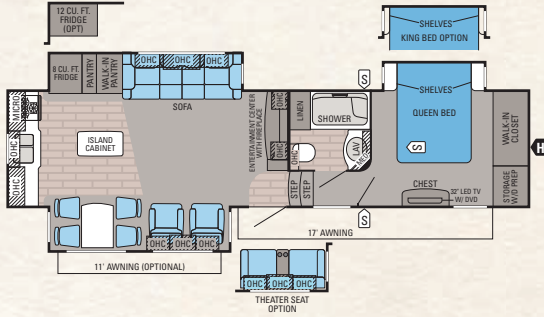

### EAGLE PREMIER | 331RRTS

Ext. Length: 36' 5" Ext. Height: 160" Unloaded Wt. (lbs.): 11,045 Sleeps: 3

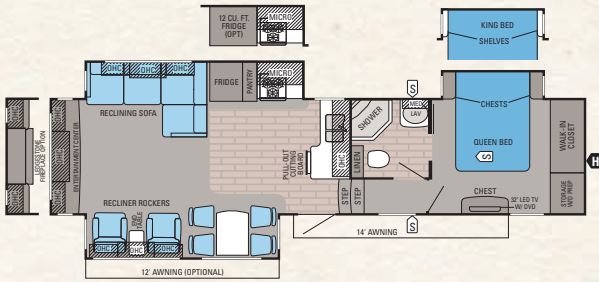

### EAGLE PREMIER | 351RLTS

Ext. Length: 37' 5" Ext. Height: 159" Unloaded Wt. (lbs.): 11,340 Sleeps: 4

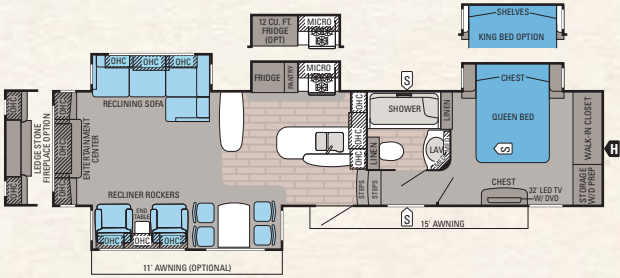

### EAGLE PREMIER | 361REQS

Ext. Length: 39' 1" Ext. Height: 156" Unloaded Weight (lbs.): 11,825 Sleeps: 4-6

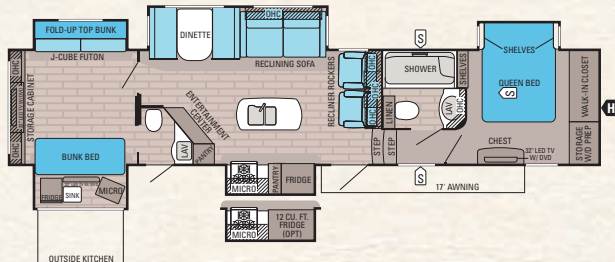

### EAGLE PREMIER | 375BHFS

Ext. Length: 41' 9" Ext. Height: 159" Unloaded Wt. (lbs.): 13,005 Sleeps: 8-11

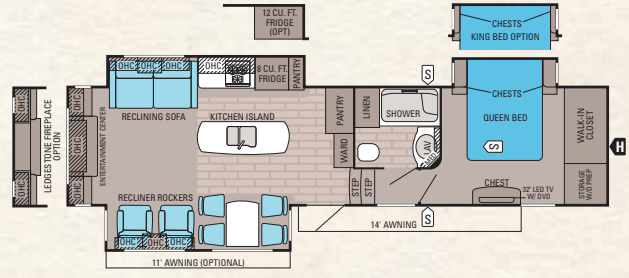

### EAGLE PREMIER | 331RETS

Ext. Length: 36' 8" Ext. Height: 159" Unloaded Wt. (lbs.): 11,150 Sleeps: 3-4

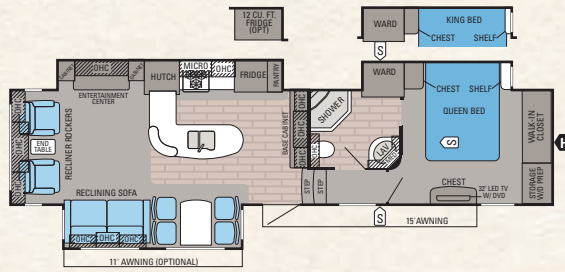

### EAGLE PREMIER | 351MKTS

Ext. Length: 38' 4" Ext. Height: 156" Unloaded Wt. (lbs.): 11,275 Sleeps: 4

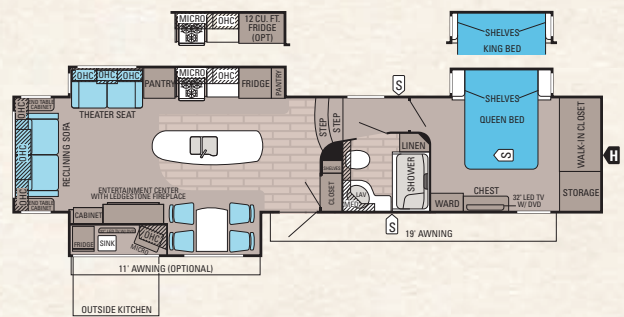

### EAGLE PREMIER | 351RSTS

Ext. Length: 40' 9" Ext. Height: 158" Unloaded Weight (lbs.): 12,005 Sleeps: 3

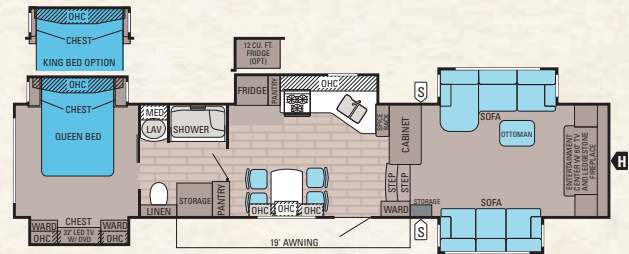

### EAGLE PREMIER | 371FLFS

Ext. Length: 42' 4" Ext. Height: 160" Unloaded Wt. (lbs.): 11,860 Sleeps: 4-5

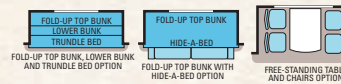

### STANDARD EXTERIOR EQUIPMENT

TuffShell vacuum-bonded laminated walls
Ultra high-gloss, Ivory gel-coat exterior
Aerodynamic front cap with LED lighting
One-piece seamless roof covering
Magnum Truss Roof System with one-piece DiFlex II material
Climate Shield (see package details)
10" I-Class cambered structural I-beams
Completely enclosed and protected slideout mechanisms
Frameless, dark-tinted, safety-glass windows
30" x 72" entry door with oversized window
Heavy-duty entrance step
Front awning arm convenience outlet
16" radial tires
Nev-R-Adjust brakes
E-Z Lube axles
MOR/ryde CRE 3000 suspension system
Wide-stance front landing gear
Exterior kitchen with 32" LED TV, sink, refrigerator and microwave (351RSTS and 375BHFS)
Enclosed, protected basement drop frame
Stor-Galore pass-thru basement storage with slam latches and strut assist
Cable TV and outlet in basement
Exterior marine-grade speakers (2)
Sliding propane tray with 30-lb. bottles
Dual battery compartment with disconnect
Heated, enclosed Uni-Dock utility center
50-amp power service with detachable cord
35,000-BTU furnace (minimum)
75-gal. fresh water tank
70-gal. gray tank capacity (minimum)
44-gal. black tank capacity (minimum)
Cable/satellite prep
Digital TV antenna
Electric rear stabilizer jacks
Under-mounted spare tire
Outside grill prep
Frame prepped for cargo accessory receiver
Roof ladder

### STANDARD INTERIOR EQUIPMENT

Raised-panel cabinetry with lumbercore, screwed construction and hidden hinges
Steel ball bearing drawer guides, 75-lb. capacity, full extension

Hardwood slideout fascias
Large, split, undermount Stonecast kitchen sink with covers
Pull-out kitchen faucet
LG brand, high-gloss, solid-surface kitchen countertops
Water heater bypass
8 cu. ft. refrigerator with high-gloss front
Oversized 21" oven with 3-burner cooktop and range cover
Diamondflor deluxe linoleum flooring
Free-standing table and 4 chairs (optional 375BHFS)
90-amp power center with Charge Wizard
Backlit command center for switches with 12V cell phone charger
Floor-level convenience light switch for safe entry
Key fob remote for slideouts, patio awning, power jacks (n/a with levelers) and patio light
Ceiling fan
LED ceiling lights throughout
Decorative ceiling mantle (select models)
Closeable and directional A/C vents
Prep for 2nd ducted A/C
42" LED HDTV
Recliner rockers (n/a 351RSTS and 371FLFS)
Hide-a-bed sofa with tri-fold Denver Mattress (n/a 371FLFS, equipped with air mattress)
Pleated day/night shades (main living area)
6' 5" tall living area slideouts
One-piece fiberglass shower with glass doors (select models)
Porcelain bath stool with foot flush
Robe hooks in bath
Deluxe bedding package
Full-trunk, under-bed storage
Walk-in style front closet with dual hanging rods
Washer/dryer prep, accommodates stackable unit
Floor-to-ceiling bedroom dresser with 32" LED TV/DVD player and opera-style window (n/a 371FLFS)

### CUSTOMER VALUE PACKAGE (MANDATORY)

Aluminum rims
Extendable main entrance grab handle
Large patio scare lights (2)
Electric patio awning with LED lighting
30" over-the-range residential microwave
20-gal./hr. quick recovery gas/electric DSI water heater
Canister style, in-line water filter
15,000-BTU low-profile Whisper Quiet air conditioner
Arched interior ceiling

Multi-media premium sound system AM/FM/CD/DVD/MP3 player with toggle switch for outside speakers
Bath power vent
Bath skylight
Denver Mattress Advanced queen-sized (60" x 80") pillowtop mattress
Under-bed floor safe

### LUXURY PACKAGE (MANDATORY)

Power kitchen vent, MOR/ryde pin box, 6-point auto leveling system
--

### OPTIONS

Customer Value Package with heat pump
Slideout awnings
2nd electric power patio awning, mounted on slideout (n/a 375BHFS and 371FLFS)
Keyless entry at main entrance
Thermal-pane, tinted, safety-glass windows
Generator prep
5,500-watt gasoline generator (includes prep)
Power cord reel (manual)
Cargo accessory receiver
Outside grill
12 cu. ft. refrigerator
30" residential-grade convection microwave with oven
Ledgestone fireplace (321RLTS, 331RETS, 351RLTS, 361REQS) (standard on 351RSTS and 371FLFS)
Fireplace (n/a 351RSTS and 371FLFS)
Theater-seating sofa (331RKTS)
Theater-seating ILO recliner rockers (331RKTS)
Free-standing table and 4 chairs (375BHFS)
Living area linoleum (n/a 371FLFS, 375BHFS)
King-sized mattress (n/a 321RLTS, 375BHFS)
2nd 13,500-BTU low-profile, ducted A/C
Dyson cordless vacuum
Bunk beds with trundle bed on off-doorside (375BHFS)
Bunk bed with hide-a-bed on off-doorside (375BHFS)

## EAGLE PREMIER FIFTH WHEEL SPECIFICATIONS

MODELS	DIMENSIONS					WEIGHTS (LBS.)				TANKS (GALS.)		
	FLOORPLAN	EXTERIOR TRAVEL LENGTH*	EXTERIOR WIDTH	EXT. HEIGHT (WITH A/C)	EXT. HEIGHT (WITH OPT. BEDROOM A/C)	INTERIOR HEIGHT	UNLOADED VEHICLE WEIGHT**	DRY HITCH WEIGHT	GROSS VEHICLE WEIGHT RATING	CARGO CARRYING CAPACITY	FRESH (INCLUDES WATER HEATER)	GRAY
321RLTS	34' 3"	96"	159"	159"	81"	10,510	2,300	14,500	3,990	85	87	50
331RETS	36' 8"	96"	159"	159"	81"	11,150	2,345	14,900	3,750	85	87	50
331RKTS	36' 5"	96"	160"	160"	81"	11,045	2,250	14,995	3,950	85	87	50
351MKTS	38' 4"	96"	156"	157"	77"	11,275	2,265	14,995	3,720	85	87	50
351RLTS	37' 5"	96"	159"	159"	81"	11,340	2,340	14,995	3,655	85	85	50
351RSTS	40' 9"	96"	158"	158"	81"	12,005	2,445	15,500	3,495	85	95	50
361REQS	39' 1"	96"	156"	158"	81"	11,825	2,475	14,995	3,170	85	70	50
371FLFS	42' 4"	96"	160"	160"	91"	11,860	2,455	15,975	4,115	85	70	44
375BHFS	41' 9"	96"	159"	159"	80"	13,005	2,550	15,975	2,970	85	93	94

\*Distance from the pin box to the bumper; total exterior length may be longer. \*\*The weights of certain options and/or option packages are not included in the UWW listed above.

**Unloaded Vehicle Weight (UWW):** Sometimes referred to as "Dry Weight," UWW means the typical weight of this trailer as built at the factory. The UWW, as used in product literature and other promotional materials, does not include cargo, fresh water, propane, options or dealer-installed accessories.

**Gross Vehicle Weight Rating (GVWR):** GVWR means the maximum permissible weight of the trailer, including the UWW plus passengers, personal items, all cargo, fluids, options, and dealer-installed accessories. The GVWR is equal to or greater than the sum of the UWW and the CCC.

**Cargo Carrying Capacity (CCC):** CCC means the maximum weight of all passengers, personal items, food, fresh water, propane, tools, other cargo and dealer-installed accessories that can be carried by the trailer. CCC is equal to or less than GVWR minus UWW. The addition of options will decrease the CCC.

**Hitch Weight (HW):** The hitch weight, as used in product literature and other promotional materials, does not include cargo, fresh water, propane gas, options or dealer-installed accessories. The addition of these types of items will either add to or subtract from the stated hitch weight.

It is important for your safety and enjoyment that your tow vehicle be adequately sized and equipped to tow and handle the GVWR of the RV you select. Review weights and rating of your tow vehicle and consult a competent advisor for questions or advice. Whether you are new to RVing or a veteran, get a feel for the performance of your tow vehicle before heading out on the roadways. When you tow an RV, you must drive differently than when you drive a single vehicle. Practice hooking up, driving, backing up and braking in a safe environment or seek out professional instruction. Jayco affixes a weight label to each RV which lists weight information for that vehicle. See specifications chart above.

# WE START WITH ONE OF THE INDUSTRY'S **strongest** foundations

4-6 ft.

**Full-width outriggers:** We build on full-width outriggers that are spaced 4-6 feet apart (vs. 8 ft.) to better support the weight of the wall.

**I-Class cambered structural steel I-beams:** Jayco uses a unique molded, one-piece design to prevent unit from twisting; competing three-piece I-beams can warp over time at the welded seams.

Jayco builds on custom-sized frames, designed specifically for each floorplan. Other manufacturers use stock frames, stretching and welding the frame to fit.

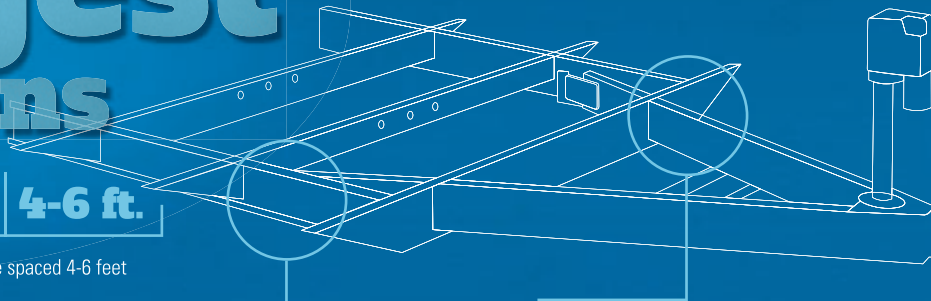

**Eagle travel trailer integrated A-frame:** The A-frame runs through the main frame, preventing the hitch from buckling like competing tack-welded frames.

**– so that we can build the industry's most reliable RV**



## CLIMATESHIELD

The Climate Shield features the following R-values.

### Most Eagle models (TT, HT, FW and Touring Edition)

#### VALUE UNIT AREA

- R-5 All vertical walls
- R-15 Behind front cap
- R-27 Roof
- R-29 Main floor
- R-14 Slide floor
- R-22 Bedroom floor
- R-14 Inside open pin box

### Eagle Premier models

#### VALUE UNIT AREA

- R-7 All vertical walls
- R-11 Behind front cap
- R-30 Roof
- R-22 Main floor
- R-14 Slide floor
- R-22 Bedroom floor
- R-14 Inside open pin box
- R-14 Enclosed drop-frame overhang

## Extend your camping season

with the Jayco Climate Shield — the ultimate in weather protection. Designed for efficient heating and cooling, Climate Shield protects against extreme heat and extreme freezing — even when temperatures hit a high of 100° F or a low of 0° F.

#### LIVING ROOM

0°F 70°F  
100°F 69°F

#### KITCHEN

0°F 69°F  
100°F 70°F

#### BATHROOM

0°F 71°F  
100°F 68°F

#### HOLDING TANK

0°F 60°F  
100°F 72°F

#### BEDROOM

0°F 71°F  
100°F 71°F

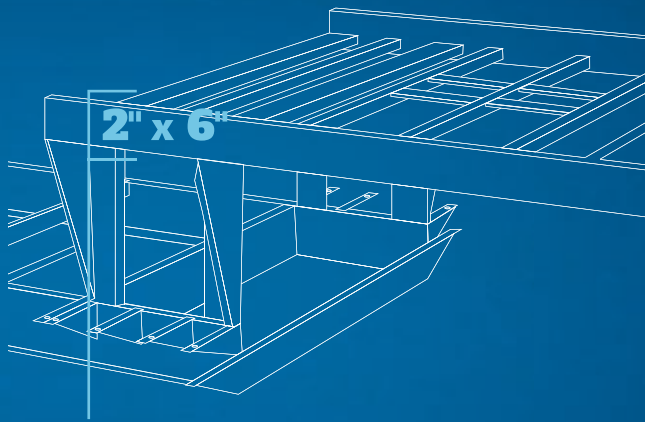

**Fifth wheel frame:** The frame over the truck bed is built on a superior 2"x 6" tube perimeter structure to better support the bedroom sidewalls. Competing fifth wheels have a smaller frame; these manufacturers add a sidewall support seam to compensate for expansion joints.

## THE MAGNUM TRUSS ROOF SYSTEM 50 percent stronger

In a side-by-side comparison test, Jayco's exclusive Magnum Truss Roof System withstood 4,500 lbs. — 50 percent more than other roofs. The difference?

- 1 Jayco uses 4 1/2" crowned wood trusses, solid-wood studs and oversized nail plates to maximize the roof's load capacity. (Eagle Premier uses 5" arched, stamped steel.)
- 2 Then, we screw down 3/8" roof decking at every seam, a process that is more durable than stapled construction.
- 3 Finally, our one-piece, sidewall-wrapped DiFlex II material provides the ultimate in leak protection.

## WALL CONSTRUCTION vacuum-bonded walls

- 4 Eagle features durable, vacuum-bonded, laminated sidewalls with smooth, high-gloss fiberglass exteriors that provide long-lasting appeal.
- 5 Welded aluminum frames give Eagle a durable, lightweight structure.

## FIFTH WHEEL CONSTRUCTION extra measures for extra warmth

- 6 In the upper area of the fifth wheel floorplan, Jayco uses a double layer of fiberglass insulation behind the front cap, along with Flexfoil and fiberglass insulation in the floor, to provide extra warmth where it's needed most — in the bedroom.
- 7 Jayco's aerodynamic front cap is engineered to withstand the rigors of the road. Paint infused and gel coated, this fiberglass cap features more support with 1/4" plywood bracing, not typically found on other fifth wheels.

## EAGLE INTERIOR DÉCOR CHOICES

### ALMOND "LEATHERETTE"

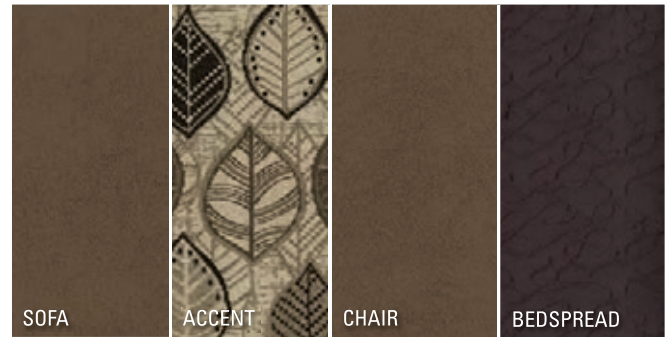

### CHESTNUT

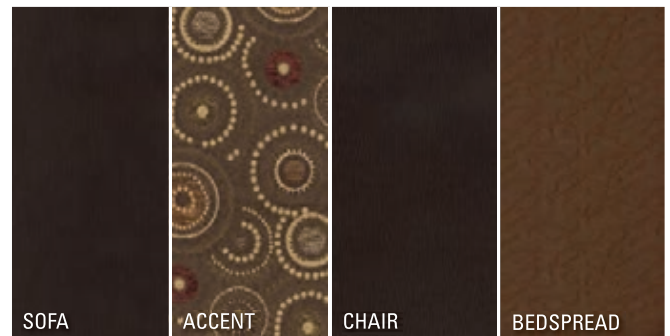

### BROWNSTONE "LEATHERETTE"

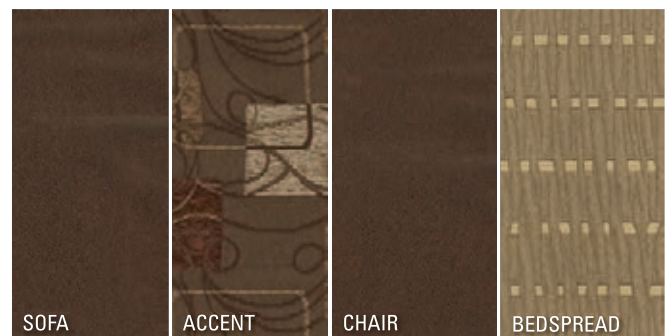

### PEWTER



### RESIDENTIAL-GRADE SHAW CARPET

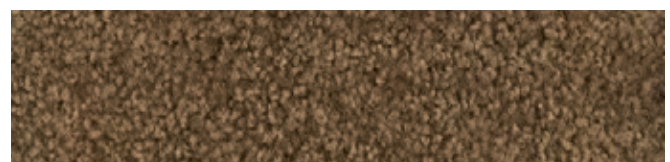

**2**  
**YEAR**  
WARRANTY



Bumper-to-front limited warranty\*

**Jayco**<sup>®</sup>  
Generations of family fun.

**FAMILY fun**  
starts with peace of mind

At Jayco, we build our RVs to handle every adventure, then we back our products with an industry-leading 2-year limited warranty. You won't find a better warranty in the business because the only strings we attach are those that deliver the ultimate in reliability. That's the Jayco difference. So go explore. We have the warranty that will follow you anywhere.

**FREE** Roadside Assistance

Travel worry-free with Jayco's Customer First Roadside Assistance program, yours at no cost during the first year of ownership. This program is offered through Coach-Net, the country's largest RV emergency road service, and gives you immediate access to assistance.

\*For a copy of our 2-year limited warranty with full terms and conditions, please contact your local Jayco dealer.

**eco** advantage™

Jayco's long-term commitment  
to generations of family fun

The fun starts with your local Jayco dealer

Find your local dealer:

From giving advice to selling and servicing products, we consider our loyal dealers the glue in our family bond. Establishing a solid relationship with your local Jayco dealer is a key component in the enjoyment of your new Jayco. By purchasing from a local dealer, you will have a convenient location for sales, parts and service support. We hope you consider them a part of your camping family.

Follow Jayco



Jayco, Inc., P.O. Box 460, Middlebury, IN 46540, [www.jayco.com](http://www.jayco.com) 

See dealer for further information and prices. All information in this brochure is the latest available at the time of publication approval. Jayco reserves the right to make changes and to discontinue models without notice or obligation. Photos in this brochure may show optional equipment and props for photography purposes. RVs built for sale in Canada may differ to conform to Canadian codes. ©2014 Jayco, Inc. 15-FDCT-PL 0614-30K Printed in U.S.A.