



Jayco®

Generations of family fun.

CAMPING TRAILERS

2015 CAMPING TRAILERS BY JAYCO

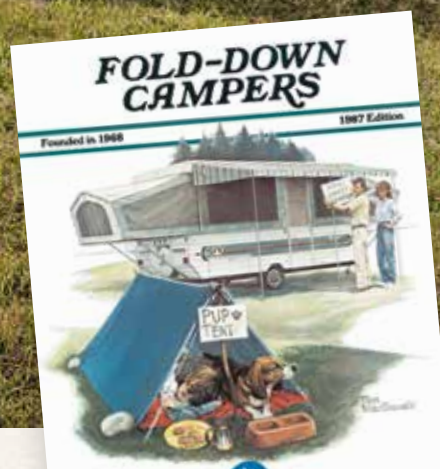

This 1987 brochure cover inspired our 2015 literature.

2
YEAR
WARRANTY

BUILT FOR A lifetime OF FAMILY FUN

5 LIFETIME WARRANTIES



JAY SERIES SPORT HARDWALL

JAY SERIES SPORT

JAY SERIES



For 45 years, Jayco has helped create generations of family fun, and over the course of that time, fun still looks remarkably the same. From campfires to fishing, from relaxing to eating, fun has the same feel generations later—and all with a Jayco RV nearby. Today, we're the largest family-owned RV manufacturer in the world, and our promise is to continually strive to build family-friendly products that will outlast just about everything but your memories. Join us in our generations of family fun.

On the cover: The 1987 brochure artwork, illustrated by Tim MacDonald, was part of a successful ad campaign. These illustrations inspired the 2015 Jayco brochure covers, which are live re-creations of Tim's artwork.



Scan this QR code to watch how Jayco has delivered Generations of Family Fun or visit www.GenerationsOfFamilyFun.com.

Forty five years ago, Jayco founder Lloyd Bontrager created an easy-to-use lifter system that led to a better fold-down camper. Today, thanks to his patented design and other innovations like it, Jayco backs its camping trailers with five lifetime component warranties.*

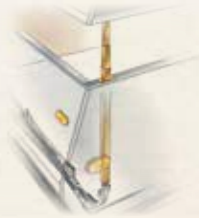

PATENTED LIFTER SYSTEM

1 LIFTER SYSTEM*

Fully enclosed** to protect against road debris and rust, our one-of-a-kind, patented lifter system uses strong, flexible push-rods to guide the roof, while our three-stage tubular lift posts include nylon bushings to reduce friction, shed water and protect the tent fabric. (Jay Series power lift components feature a 2-year warranty.)



1,050-LB. RATED BUNK ENDS

2 BED PLATFORM*

Rest easy on a bed of Jayco durability. A two-piece extruded aluminum bed frame, 1/2" decking and heavy-duty supports hold up to 1,050 pounds.



SEAMLESS DOME ROOF

3 ROOF*

The Jay Series' fiberglass roof features a unique dome design for better water runoff and one-piece construction for superior leak prevention, ensuring your RV will weather the elements.



INTEGRATED A-FRAME

4 FRAME

Powder coated to prevent corrosion, Jayco's custom-built frame is built for the long haul, featuring an integrated A-frame that prevents buckling and torque during towing.



POLY FLEX-WRAPPED FLOOR

5 FLOOR

Jayco wraps its one-piece wooden floor deck with water-resistant Poly Flex material. Using glue and screws to double bond the floor to the frame, Jayco's camping trailers boast one of the industry's strongest foundations.

* Not available on the Jay Series Sport Hardwall.

** The Jay Series Sport lifter system is not fully enclosed.



JAY SERIES SPORT 10SD

Jay Series Sport

Elevate your experience

JAY SERIES SPORT

The 2015 Jay Series Sport delivers all the comforts of a pop-up camper at a price you can afford. Boasting 1,050-lb. rated bunk ends, convertible dinettes and gauchito sofa sleepers, you can forget sleeping on the ground. Welcome to a new level of camping.



JAY SERIES SPORT 10SD



JAY SERIES SPORT 10SD



JAY SERIES SPORT HARDWALL

For 2015, Jayco is adding even more pop to its Jay Series Sport lineup with four hardwall floorplans — a new easy-to-setup design for on-the-go enthusiasts.

SPEND LESS TIME SETTING UP
**and more time
having fun**

Turn the page to learn
more about our easy setup.



JAY SERIES SPORT 12HFD



JAY SERIES SPORT 12HFD | CARGO AREA

JAY SERIES SPORT FLOORPLANS



LENGTH 11' 7"-22' 4"



WEIGHT 1,200-2,385 lbs.



SLEEPS 3-7

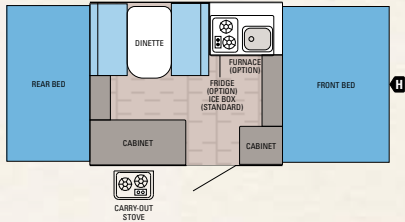

JAY SERIES SPORT | 8SD

Ext. Length: 11' 7" Travel Ht.: 57" Unloaded Wt. (lbs.): 1,200 Sleeps: 5-6

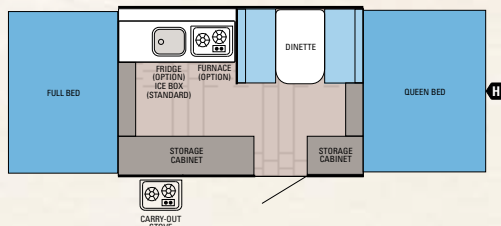

JAY SERIES SPORT | 10SD

Ext. Length: 13' 6" Travel Ht.: 57" Unloaded Wt. (lbs.): 1,435 Sleeps: 5-6

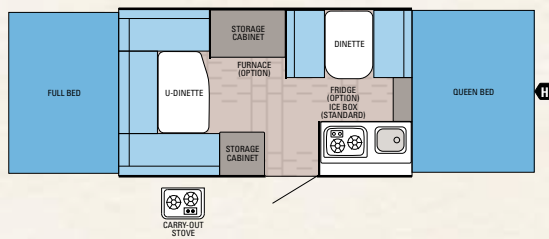

JAY SERIES SPORT | 12UD

Ext. Length: 15' 6" Travel Ht.: 57" Unloaded Wt. (lbs.): 1,570 Sleeps: 6-7

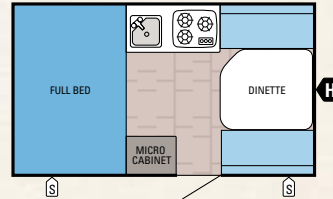

JAY SERIES SPORT HARDWALL | 12H

Ext. Length: 16' 3" Travel Ht.: 61" Unloaded Wt. (lbs.): 1,915 Sleeps: 3-4

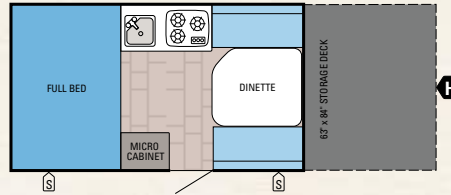

JAY SERIES SPORT HARDWALL | 12HFD

Ext. Length: 22' 4" Travel Ht.: 71" Unloaded Wt. (lbs.): 2,385 Sleeps: 3-4

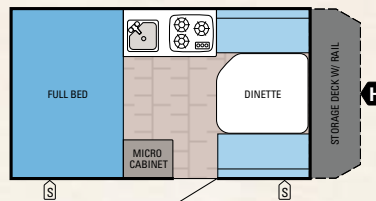

JAY SERIES SPORT HARDWALL | 12HMD

Ext. Length: 18' 8" Travel Ht.: 62" Unloaded Wt. (lbs.): 1,990 Sleeps: 3-4

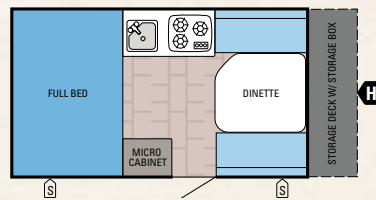

JAY SERIES SPORT HARDWALL | 12HSB

Ext. Length: 18' 8" Travel Ht.: 62" Unloaded Wt. (lbs.): 2,095 Sleeps: 3-4

SPECIFICATIONS

MODELS	DIMENSIONS				WEIGHTS (LBS.)				TANKS (GALS.)		
FLOORPLAN	EXTERIOR LENGTH	CAMPSITE LENGTH	EXTERIOR WIDTH	TRAVEL HEIGHT	UNLOADED VEHICLE WEIGHT*	DRY HITCH WEIGHT	GROSS VEHICLE WEIGHT RATING	CARGO CARRYING CAPACITY	FRESH (INCLUDES WATER HEATER)	GRAY	BLACK
8SD	11' 7"	16' 2"	85"	57"	1,200	175	1,995	795	10	n/a	n/a
10SD	13' 6"	19' 6"	85"	57"	1,435	165	2,250	815	10	n/a	n/a
12UD	15' 6"	21' 6"	85"	57"	1,570	210	2,350	780	10	n/a	n/a
12H	16' 3"	16' 3"	85"	61"	1,915	230	3,250	1,335	23	n/a	n/a
12HFD	22' 4"	22' 4"	85"	71"	2,385	385	4,150	1,765	23	n/a	n/a
12HMD	18' 8"	18' 8"	85"	62"	1,990	220	3,250	1,260	23	n/a	n/a
12HSB	18' 8"	18' 8"	85"	62"	2,095	305	3,250	1,155	23	n/a	n/a

* The weights of certain options and/or option packages are not included in the UVW listed in the specification charts.

JAY SERIES SPORT

STANDARD EXTERIOR EQUIPMENT

Heavy-duty, corrosion-resistant frame construction
Integrated A-frame
Floor constructed of one-piece wooden floor deck and wrapped with Poly Flex underbelly material
Scratch-resistant, embossed aluminum exterior finish
Mildew-resistant aluminum ceiling
Domed, seamless fiberglass roof
Lifter post covers integrated into tent
DuraTek water-repellent sectionalized tent with 1,050-lb. rated beds
One-piece construction entrance door with self-storing screen door and access when roof is lowered
Heavy-duty entrance door securement latches
12" D-range radial tires with polyethylene wheel wells
Leaf spring suspension system
12V electrical system with 110V converter
20-lb. propane gas bottle
30-amp power cord
120V G.F.C.I. protected exterior receptacle
Prep wiring for battery
City water hookup
Bumper-welded steel construction
Leveling tongue jack

STANDARD INTERIOR EQUIPMENT

Heritage Mocha cabinet doors and drawers
Ball bearing drawer guides, 75-lb. capacity with full-drawer extension
Acrylic sink and faucet
Appliances, pre-plumbed for propane
35-lb. ice box
Booth dinette with carry-out table
Coordinated furniture, designed and made by Jayco
Tinted vinyl windows with fine-mesh screening
Window drapes and 4" ceiling valances
Wall-to-wall Diamondfloor vinyl flooring
12V high-intensity lighting
Auxiliary 12V jack and privacy curtains for bunk ends

CUSTOMER VALUE PACKAGE

14" x 14" roof vent
E-Z Lube axles
Crank-down rear stabilizer jacks with sand pads (2)
Stainless-steel, carry-out stove with wind deflectors
10-gal. fresh water system with 12V demand pump
Non-sliding, 4" deep dinette cushions

OPTIONS

Self-storing awning made by Jayco
Electric brakes
Spare tire with carrier and cover
Prep for A/C, includes wiring, roof supports, 120V outlet and wire sleeve cover
16,000-BTU furnace with auto ignition
2-cu. ft. 3-way gas/electric refrigerator (110V/12V/propane)
Deluxe Plumbing Package: Outside shower and 6-gal. water heater (12UD)
Heated bed mats (2)

JAY SERIES SPORT HARDWALL

STANDARD EXTERIOR EQUIPMENT

Heavy-duty, corrosion-resistant frame construction
Integrated A-frame
Floor constructed of one-piece wooden floor deck and wrapped with Poly Flex underbelly material
Fiberglass roof
13" D-range radial tires with polyethylene wheel wells
E-Z Lube axles with TorFlex independent torsion-axle suspension
11,500-BTU air conditioner with heat pump
12V electrical system with 35-amp, 110V power converter
20-lb. propane gas bottles (2)
30-amp power cord
120V G.F.C.I. protected exterior receptacle
Prep wiring for battery
City water hookup
Bumper-welded steel construction
Leveling tongue jack

STANDARD INTERIOR EQUIPMENT

Heritage Mocha cabinet doors and drawers
Ball bearing drawer guides, 75-lb. capacity with full-drawer extension
Acrylic sink and chrome faucet
17-gal. fresh water tank with 12V demand pump
6-gal. gas water heater
Appliances, pre-plumbed for propane
3-burner stainless-steel stovetop
Microwave oven
Booth dinette with carry-out dinette table
Coordinated furniture, designed and made by Jayco
Non-sliding, 4" deep dinette cushions
Tinted vinyl windows with fine-mesh screening
Window shades
Privacy curtains
Wall-to-wall Diamondfloor vinyl flooring
12V high-intensity lighting
Multi-media stereo with AM/FM/CD/USB/SD
Comforter

CUSTOMER VALUE PACKAGE

Electric brakes
Crank-down stabilizer jacks with sand pads (4)
Spare tire with carrier and cover

OPTIONS

Self-storing awning and screen room
16,000-BTU furnace with auto ignition
Powered roof vent

HARDWALL SETUP

Sets up easily in less than 30 seconds.

- 1 Pitch the spring-loaded roof, guiding it up until it locks into place.



- 2 Step inside and shut the bottom door behind you before flipping up the top half. Secure with latch.
- 3 Push and latch the triangular sidewalls for final setup.



SET UP THE SIDEWALLS



LATCH THE SIDEWALLS

Unloaded Vehicle Weight (UVW): Sometimes referred to as "Dry Weight," UVW means the typical weight of this trailer as built at the factory. The UVW, as used in product literature and other promotional materials, does not include cargo, fresh water, propane, options or dealer-installed accessories.

Gross Vehicle Weight Rating (GVWR): GVWR means the maximum permissible weight of the trailer, including the UVW plus passengers, personal items, all cargo, fluids, options, and dealer-installed accessories. The GVWR is equal to or greater than the sum of the UVW and the CCC.

Cargo Carrying Capacity (CCC): CCC means the maximum weight of all passengers, personal items, food, fresh water, propane, tools, other cargo and dealer-installed accessories that can be carried by the trailer. CCC is equal to or less than GVWR minus UVW. The addition of options will decrease the CCC.

Hitch Weight (HW): The hitch weight, as used in product literature and other promotional materials, does not include cargo, fresh water, propane gas, options or dealer-installed accessories. The addition of these types of items will either add to or subtract from the stated hitch weight.

It is important for your safety and enjoyment that your tow vehicle be adequately sized and equipped to tow and handle the GVWR of the RV you select. Review weights and rating of your tow vehicle and consult a competent advisor for questions or advice. Whether you are new to RVing or a veteran, get a feel for the performance of your tow vehicle before heading out on the roadways. When you tow an RV, you must drive differently than when you drive a single vehicle. Practice hooking up, driving, backing up and braking in a safe environment or seek out professional instruction. Jayco affixes a weight label to each RV which lists weight information for that vehicle. See specifications chart left.



JAY SERIES 1209SC

Jay Series

Fold out the fun

JAY SERIES

Broaden your horizons in a 2015 Jay Series. Our most popular camping trailer lets you bring the outdoors in — and the indoors out — in four family-friendly floorplans with sleeping for up to eight people. A carry-out dinette table and stainless-steel carry-out stove let you enjoy the best of both worlds.



JAY SERIES 1209SC | OPTIONAL BATH/SHOWER



JAY SERIES 1007UD | KING BED TENT END



EASY ENTRANCE

Jayco's stepper door (n/a 1001XR) doubles as an entry door and swing-down step. Its swing-away function creates more ground clearance during travel, while its large design makes for a spacious step.



JAY SERIES 1007UD

JAY SERIES 1209SC

JAY SERIES FLOORPLANS



LENGTH

14' 2"-20' 6"



WEIGHT

1,800-2,460 lbs.



SLEEPS

5-8

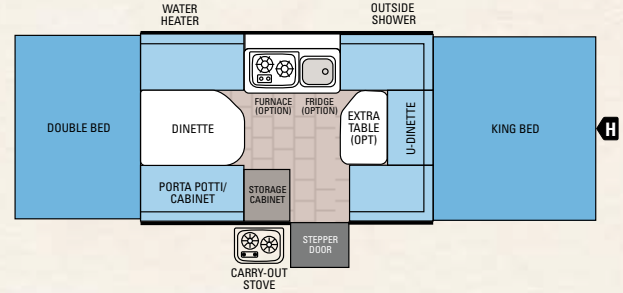
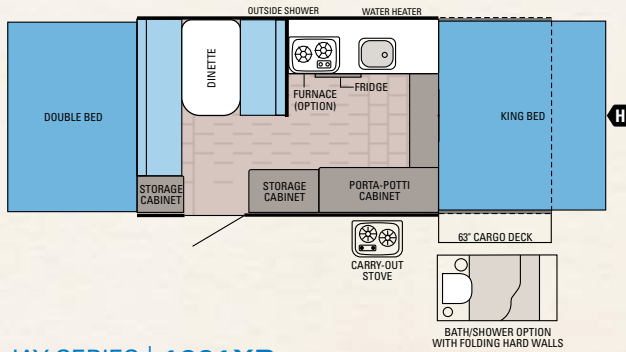

JAY SERIES | 1001XR

Ext. Length: 20' 6" Travel Ht.: 70" Unloaded Wt. (lbs.): 2,415 Sleeps: 5-6

JAY SERIES | 1007UD

Ext. Length: 14' 2" Travel Ht.: 59" Unloaded Wt. (lbs.): 1,800 Sleeps: 6-8

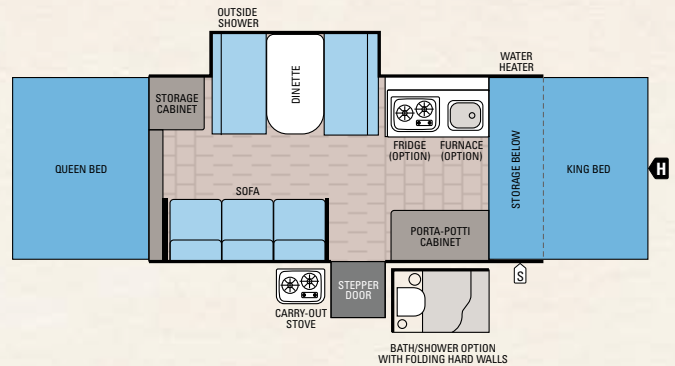
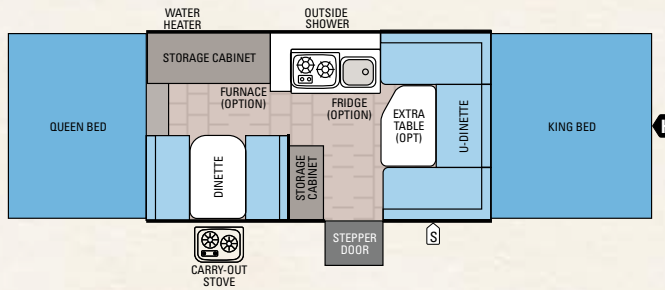

JAY SERIES | 1207UD

Ext. Length: 16' 2" Travel Ht.: 61" Unloaded Wt. (lbs.): 2,045 Sleeps: 6-7

JAY SERIES | 1209SC

Ext. Length: 18' 2" Travel Ht.: 60" Unloaded Wt. (lbs.): 2,460 Sleeps: 6-7

SPECIFICATIONS

MODELS	DIMENSIONS				WEIGHTS (LBS.)				TANKS (GALS.)		
FLOORPLAN	EXTERIOR LENGTH	CAMPSITE LENGTH	EXTERIOR WIDTH	TRAVEL HEIGHT	UNLOADED VEHICLE WEIGHT**	DRY HITCH WEIGHT	GROSS VEHICLE WEIGHT RATING	CARGO CARRYING CAPACITY	FRESH (INCLUDES WATER HEATER)	GRAY	BLACK
1001XR	20' 6"	24' 2"	85"	70"	2,415	265	4,550	2,135	36.5	11*	5*
1007UD	14' 2"	20' 10"	85"	59"	1,800	160	2,550	750	23	0	0
1207UD	16' 2"	23' 4"	85"	61"	2,045	180	2,950	905	23	0	0
1209SC	18' 2"	23' 4"	85"	60"	2,460	315	3,450	990	23	11*	5*

*With optional bath/shower. **The weights of certain options and/or option packages are not included in the UVW listed in the specification charts.

Unloaded Vehicle Weight (UVW): Sometimes referred to as "Dry Weight," UVW means the typical weight of this trailer as built at the factory. The UVW, as used in product literature and other promotional materials, does not include cargo, fresh water, propane, options or dealer-installed accessories.

Gross Vehicle Weight Rating (GVWR): GVWR means the maximum permissible weight of the trailer, including the UVW plus passengers, personal items, all cargo, fluids, options, and dealer-installed accessories. The GVWR is equal to or greater than the sum of the UVW and the CCC.

Cargo Carrying Capacity (CCC): CCC means the maximum weight of all passengers, personal items, food, fresh water, propane, tools, other cargo and dealer-installed accessories that can be carried by the trailer. CCC is equal to or less than GVWR minus UVW. The addition of options will decrease the CCC.

Hitch Weight (HW): The hitch weight, as used in product literature and other promotional materials, does not include cargo, fresh water, propane gas, options or dealer-installed accessories. The addition of these types of items will either add to or subtract from the stated hitch weight.

It is important for your safety and enjoyment that your tow vehicle be adequately sized and equipped to tow and handle the GVWR of the RV you select. Review weights and rating of your tow vehicle and consult a competent advisor for questions or advice. Whether you are new to RVing or a veteran, get a feel for the performance of your tow vehicle before heading out on the roadways. When you tow an RV, you must drive differently than when you drive a single vehicle. Practice hooking up, driving, backing up and braking in a safe environment or seek out professional instruction. Jayco affixes a weight label to each RV which lists weight information for that vehicle. See specifications chart above.



DURABLE INTERIORS

Jayco builds its camping trailers to hold up to the most rugged of family adventures, starting with DuraTek vinyl tent material, double-stitched for extra longevity. This material packs up well, resisting mold, mildew, scratches and cracks. Inside, 75-lb. rated ball bearing drawer guides provide durable storage.



FRESHEN UP

Who doesn't love hot water? Jay Series packs a 6-gal. water heater, water heater bypass and water filtration system for the ultimate in convenience. And a swing-level galley makes kitchen setup easier than ever.

INTERIOR DÉCOR



JAY SERIES

STANDARD EXTERIOR EQUIPMENT

Heavy-duty, corrosion-resistant frame construction
Integrated A-frame
One-piece wooden floor deck, wrapped with Poly Flex underbelly material
Scratch-resistant, embossed aluminum exterior finish
Mildew-resistant aluminum ceiling and domed, seamless fiberglass roof
14" x 14" roof vent
Prep for A/C accommodating all roof-mounted A/Cs
Roof prepped for bike carrier
Jayco's original, fully enclosed lifter system with lifter post covers integrated into tent (same design used since 1968)
Power roof lift with hand-held remote key fob
DuraTek water-repellent sectionalized tent with 1,050-lb. rated beds
Permanently attached bed support poles
Diamond plate on front and rear walls
One-piece entrance door with self-storing screen door, accessible when roof is lowered
Stepper door (n/a 1001XR)
12" D-range tires (1007UD)
13" D-range tires (1207UD and 1209SC)
15" off-road radial tires (1001XR)
E-Z lube axles with leaf-spring suspension
Spare tire and tire carrier with vinyl tire cover
Stainless-steel, carry-out stove with wind deflectors
Outside shower
1,000-lb. rated utility deck with ramps/deck railing and quick-connect attachment system (1001XR)
12V electrical system with 110V converter
30-amp power cord
Prep wiring for battery
Bumper-welded steel construction
Crank-down stabilizer jacks with sand pads
Leveling tongue jack

STANDARD INTERIOR EQUIPMENT

Heritage Mocha cabinetry with raised-panel doors and drawers
Ball bearing drawer guides, 75-lb. capacity and full-drawer extension
Acrylic sink and faucet
Swing-level kitchen galley
6-gal. water heater
17-gal. fresh water tank with 12V demand pump
Water heater bypass system
Appliances, pre-plumbed for propane
Booth dinette with carry-out table
Non-sliding, 4" deep cushions for dinette
Coordinated furniture, designed and made by Jayco
SoftShade window shades and valances
Tinted vinyl windows with fine-mesh screening
Porta-potti storage cabinet (select models)
Wall-to-wall Diamondfloor vinyl flooring
Auxiliary 12V jack and privacy curtains for bunk ends

CUSTOMER VALUE PACKAGE

Self-storing awning made by Jayco
2-cu. ft. 3-way gas/electric refrigerator (110V/12V/propane)
Water purification system
Bunk-end fan lights (2)

BAJA PACKAGE (1001XR)

Aluminum rims
E-Z Lube axles
20-lb. propane bottles (2)
Battery gauge
Solar prep
30-gal. fresh water tank

OPTIONS

Deluxe screen room
Electric brakes (standard on 1001XR, 1209SC)
Hydraulic surge brakes (1007UD, 1207UD, 1209SC)
Outside grill
Multi-media stereo with outside speakers (mandatory on 1001XR)
16,000-BTU furnace with auto ignition
2nd table with pedestal leg (1007UD, 1207UD)
Bath/shower with hard walls and shower curtain (1001XR, 1209SC)
Powered roof vent
Front storage box (1001XR)

2
YEAR
WARRANTY



Bumper-to-hitch limited warranty*



Generations of family fun.

FAMILY **fun** starts with peace of mind

At Jayco, we build our RVs to handle every adventure, then we back our products with an industry-leading 2-year limited warranty. You won't find a better warranty in the business because the only strings we attach are those that deliver the ultimate in reliability. That's the Jayco difference. So go explore. We have the warranty that will follow you anywhere.

*For a copy of our 2-year limited warranty with full terms and conditions, please contact your local Jayco dealer.

FREE Roadside Assistance

Travel worry-free with Jayco's Customer First Roadside Assistance program, yours at no cost during the first year of ownership. This program is offered through Coach-Net, the country's largest RV emergency road service, and gives you immediate access to assistance.

eco advantage™

Jayco's long-term commitment
to generations of family fun



Scan this QR code with your smartphone to watch a video about our efforts and the impact we're making on our planet.

ecoadvantage.jayco.com

The fun starts with your local Jayco dealer

Your local dealer

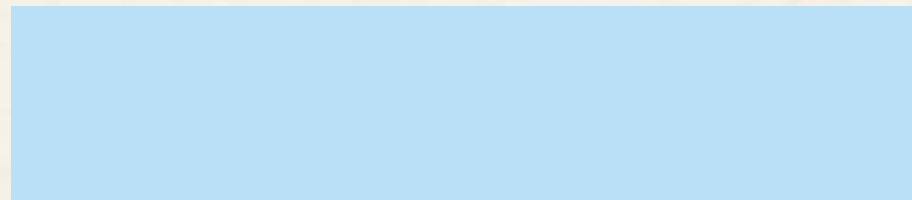

From giving advice to selling and servicing products, we consider our loyal dealers the glue in our family bond. Establishing a solid relationship with your local Jayco dealer is a key component in the enjoyment of your new Jayco. By purchasing from a local dealer, you will have a convenient location for sales, parts and service support. We hope you consider them a part of your camping family.

Follow Jayco



Jayco, Inc., P.O. Box 460, Middlebury, IN 46540, www.jayco.com See dealer for further information and prices. All information in this brochure is the latest available at the time of publication approval. Jayco reserves the right to make changes and to discontinue models without notice or obligation. Photos in this brochure may show optional equipment and props for photography purposes. RVs built for sale in Canada may differ to conform to Canadian codes. ©2014 Jayco, Inc. 15-FDCT-PL 0414-75K Printed in U.S.A.