

Clipper

Ultra Light
Conventional Travel Trailer



Clipper Ultra Light Conventional Travel Trailer



Clipper



The longstanding tradition of Coachmen Value in recreational vehicles continues with the all new Clipper travel trailer.

Designed with today's smaller, fuel efficient tow vehicles in mind, the Clipper travel trailers weigh in around 2,500 lbs. Fully equipped with all the comforts of larger more expensive models, the Clipper travel trailer provides the ultimate value in lightweight towables.

Coachmen Clipper... a product by campers for campers! From the most trusted name in camping.

SPECIFICATIONS	14R	15RB	16B	16FB	16RBD	17BH	17FQ	17RD
Hitch Weight	312 lbs	312 lbs	251 lbs	318 lbs	338 lbs	406 lbs	298 lbs	390 lbs
Ship Weight	2,335 lbs	2,335 lbs	2,553 lbs	2,503 lbs	2,840 lbs	2,818 lbs	2,731 lbs	2,847 lbs
GVWR	3,532 lbs	3,532 lbs	3,471 lbs	3,538 lbs	3,653 lbs	3,626 lbs	3,518 lbs	3,705 lbs
Cargo Capacity	1,180 lbs	1,180 lbs	901 lbs	1,018 lbs	813 lbs	791 lbs	770 lbs	858 lbs
Exterior length (add 10-1/4" for Spare)	16'8"	17'-8"	17'-9"	18'-8"	18'-8"	21'-8"	21'-8"	21'-8"
Exterior Width	88"	88"	88"	88"	88"	88"	88"	88"
Exterior Height*	9'-8"	9'-8"	9'-8"	9'-8"	9'-8"	9'-8"	9'-8"	9'-8"
Interior Height	76"	76"	76"	76"	76"	76"	76"	76"
Fresh Water Capacity**	33 gal	33 gal	33 gal	33 gal	33 gal	33 gal	33 gal	33 gal
Grey Water Capacity	25 gal	25 gal	25 gal	25 gal	25 gal	25 gal	25 gal	25 gal
Black Water Capacity	25 gal	25 gal	25 gal	25 gal	25 gal	25 gal	25 gal	25 gal
Tire Size (Radial)	13"	13"	13"	13"	13"	13"	13"	13"
Coupler Size	2-5/16"	2-5/16"	2-5/16"	2-5/16"	2-5/16"	2-5/16"	2-5/16"	2-5/16"

* With Air Conditioner **Including Water Heater

Floorplans

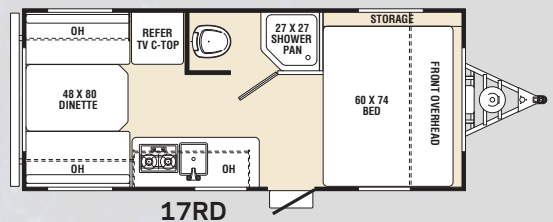
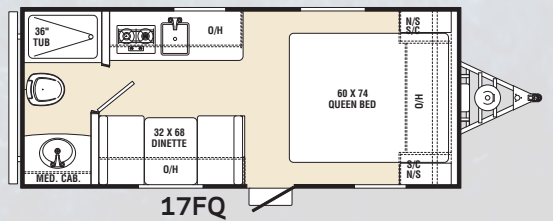
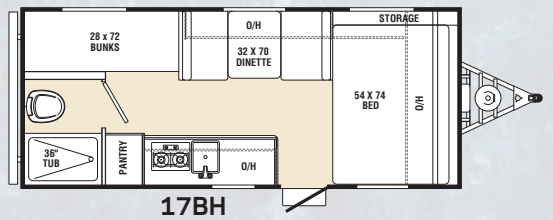
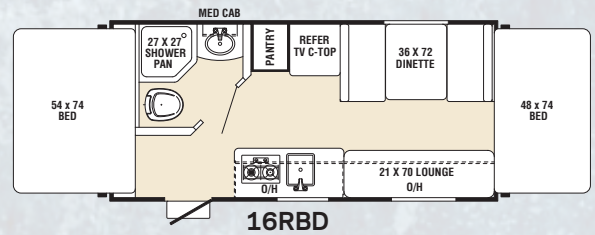
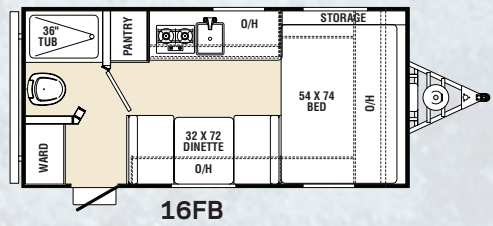
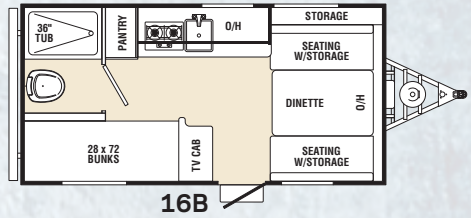
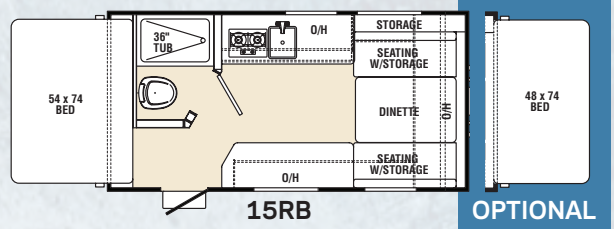
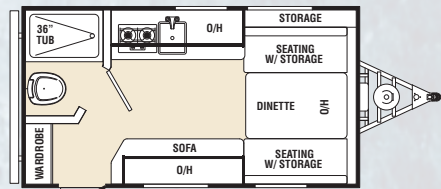

Clipper Ultra Light Conventional Travel Trailer



TRAVEL EASY™ ROADSIDE ASSISTANCE

RVing is easier with Coachmen's Travel Easy™ Roadside Assistance provided FREE the first year of ownership to those who purchase a New Coachmen RV. Administered by Coach-Net, this service provides you with 24/7 operational, technical and emergency road service coverage. Also included is towing, fuel delivery, jump starts, lockout service, tire changes, mobile mechanic and unlimited technical assistance. Anywhere. Anytime. Travel Easy™ is the security of knowing that help is an easy phone call away.



FREE ONE YEAR MEMBERSHIP - COACHMEN OWNERS ASSOCIATION!

Coachmen is proud to sponsor the largest manufacturer sponsored camping club in North America ... Coachmen Owners' Association (COA). COA provides you a world of ways to enjoy your RV. This is FUN ON OVERDRIVE and provides: Free Trip Routing, Exciting Tours & Rallies, Free Campground Directory, Local/State Club Activities, Easy RVing Magazine Free, Theme Park Discounts, Fuel Discounts, Free onebigplanet® Memberships with discounts at 180,000 merchants and Much More! Every new Coachmen RV buyer is eligible for a 1 Year FREE membership in the Coachmen Owners' Association. It all adds up to an easy ownership experience!



Forest River, Inc. encourages our customers to purchase their Forest River products from a local dealership whenever possible for the following reasons:

- 1) Forest River, Inc. dealers are independently owned and operated businesses so priority service and scheduling is at their discretion and is often provided to customers that purchased their unit at that dealership.
- 2) Purchasing locally allows customers to establish meaningful relationships with a dealer, enhancing the RV experience through assistance with product questions, user tips or RV regulations for your state or country, and much more!
- 3) Canadian customers must meet requirements to bring an RV purchased out of the country to their home. These requirements may involve additional inspections and certifications, taxes and fees. Your local Canadian Dealer is a professional at meeting these requirements.
- 4) Scheduling timely warranty repairs and adjustments through a local dealership provides far greater flexibility and convenience to you, the customer!

It is the goal of Forest River, Inc. that all of our RV owners fully enjoy the RV experience and that customer satisfaction meets or exceeds their expectations!

STANDARD FEATURES

Chassis

- Powder Coated I-Beam Frame
- Ultra Lube Leaf Spring Axles
- E-Z Crank Tongue Jack
- Dual Battery Rack
- Heavy Duty Safety Chains
- Radial Tires
- Tube Style Storage Bumper
- Galvanized Wheel Wells

Exterior

- Front Window w/Rock Guard
- .024 Mesa Aluminum Exterior
- .030 Rock Guard
- Diamond Plate Front Wall Protector
- 1 Piece Radius Door w/Window
- Radius Tinted Safety Glass Windows
- Patio Light
- 110V Exterior Recept
- Radius Locking Baggage Door
- Radius Trussed Roof
- 1 Piece Rubber Roof
- 6 Sided R-7 Insulation
- Exterior Speakers
- Bike Storage Door (16B, 17BH)

Interior

- Residential Grade Flooring
- Lumbercore Cabinetry
- Deep Maple Cabinetry
- Mortise and Tenon Cabinet Doors
- High Pressure Laminated Countertops
- High Neck Sink Faucet
- Stainless Steel Appliances
- Extra Deep Kitchen Sink
- Microwave
- Lighted Range Hood

- 2 Burner LP Range
- Monitor Panel
- Skylight in Bath
- TV Antenna w/Booster
- HDTV Cable Hook-up
- Mini Blinds
- Window Valances
- LP/CO2 Detector
- Fire Extinguisher
- Smoke Detector
- Power Bath Fan

Towable Essentials Package (Mandatory)

- 3 Cu. Ft. Dometic® Refrigerator
- 13,500 BTU A/C
- Spare Tire
- 20,000 BTU Furnace
- 6 Gal. DSI Water Heater
- 4 Crank Down Scissor Style Jacks
- Jensen AM/FM/CD/MP3 Stereo
- A & E Awning
- Electric Brakes

Options

- Front Expandable Bed (15RB only)
- Zamp 40 Watt Portable Solar Panel
- Zamp 80 Watt Portable Solar Panel

Deluxe Package

- Aluminum Wheels
- Lend a Hand Assist Handle
- Pleated Night Shades
- Tub Surround and Bath Door Mirror
- Exterior Shower



Coachmen RV, a Division of Forest River Inc.,
A Berkshire Hathaway Company
423 N. Main St., P.O. Box 30, Middlebury, IN 46540

To learn more about Coachmen RV and our products and see how Coachmen is making the easy life easier, visit www.coachmenrv.com

All information contained in this brochure is believed to be accurate at the time of publication. However, during the model year, it may be necessary to make revisions and Coachmen reserves the right to make all such changes without notice, including prices, colors, materials, equipment and specifications as well as the addition of new models and the discontinuance of models shown in this brochure. Therefore, please consult with your Coachmen dealer and confirm the existence of any materials, design or specifications that are material to your purchase decision.

©Copyright 2014 Coachmen RV a Division of Forest River Inc - All Rights Reserved



Learn More
Scan this barcode using a QR Reader on your smart phone to learn more about Forest River.



A Berkshire Hathaway company.

Your Dealer: