

FIFTH WHEELS



THE INTELLIGENT FIFTH WHEEL....

# Sanibel

by PRIME TIME Mfg.

...THE INTELLIGENT CHOICE!



Sanibel

"NORTH AMERICA'S  
FAVORITE RV COMPANY!"



[www.primetimerv.com](http://www.primetimerv.com)



# Sanibel

by PRIME TIME Mfg.



## INTELLIGENT.

» **in-tel-li-gent**, adj. smart; clever; sensible or rational; showing or resulting from an ability to think and understand things clearly and logically.

*Prime Time Manufacturing is proud to offer Sanibel – a luxury fifth wheel built to stand unequivocally on its own with a level of intelligence that far exceeds the status quo. Our objective for Sanibel is simple: to outperform by every measure and to invoke an experience that anticipates and satisfies your every need with thoughtful and intelligent design. From its well designed, spacious interior, to its modern amenities and extra creature comforts, the Sanibel is your home away from home.*

*Within minutes of entering, Sanibel can transform you. The interior is crafted around comfort, sight, and convenience. Modern cabinetry, residential appointments, and rich textures create a sophisticated space of warmth and elegance. Fabrics are specially treated to provide the softest touch and breath-ability for comfort in heat or cold. Every element of Sanibel will create a personal connection with the user that focuses on enjoyment and satisfaction.*

S





# LIVING ROOM.

## *The Intelligent Lighting Package*

» When choosing lighting for Sanibel, we took the same uncompromising approach to intelligent design. For instance, the "Stay Cool" LED lights found at the critical seating areas offer both a stunning presence and smarter thinking. Along with lower energy consumption and longer life, the LEDs emit significantly less heat helping to maximize your comfort both day and night.



S



# KITCHEN.

» *in-tel-li-gent*, adj. smart; clever; sensible or rational; showing or resulting from an ability to think and understand things clearly and logically.



» (Above) The Sanibel 3701 Pantry

» (Left) The Sanibel 3701 features a 20 Cubic Foot residential refrigerator powered by a 800 watt inverter.



## *The Intelligent Kitchen!*

*The Intelligent Kitchen is symbolic of the genius behind Sanibel's inspiration. Work spaces and storage areas have been carefully designed and positioned for instinctive reach and use. Premium components have been selected for long term durability. An advanced appliance package will indulge your residential desires while brilliant cabinet doors and drawers made from Native American Cherry Wood will welcome you with handsome looks. The Intelligent Kitchen, like each and every detail of the Sanibel, has been examined and questioned to ultimately provide a single result – the highest level of owner satisfaction.*



# BEDROOM.

» *in-tel-li-gent*, adj. smart; clever; sensible or rational; showing or resulting from an ability to think and understand things clearly and logically.



» All bedrooms are NOT created equal. LED lights, "Quiet Cool" ducted air conditioning, and extra storage details, make the Sanibel bedroom Intelligent.

## *The Intelligent Bedroom!*

*The expansive interior of the Sanibel was astutely designed to adapt its volume to your needs. A quick examination under the king size bed will expose a massive storage area that is up to 300% larger. Shoe storage in the wardrobe, six large vanity drawers, and multiple overhead cabinets are additional examples of intelligent space utilization. However, the creation of space was also a priority with Sanibel. That's why you will find extra "convenience inches" in the bed slide and large "hidden" drawers recessed into the front wall. Our designers even added radius corners to the Ever Pedic pillow top mattress to assist in traffic flow.*





# CONSTRUCTION.

*Intelligent Construction*

## Roof Construction (R-52)\*

- » 1. Dual Attic Vents
- » 2. Heavy Duty EPDM Rubber Roof with 12 Year Warranty
- » 3. Walk-on Roof with 3/8" Decking
- » 4. Radiant Shield Technology (R-38)
- » 5. Two Layers of Fiberglass Insulation (R-14)
- » 6. 5" Snow Load Approved Rafters on 16" Centers
- » 7. 1/8" Plywood
- » 8. Stain Resistant Vinyl Ceiling

\* R-Values Calculated at 80° Ambient Temperature

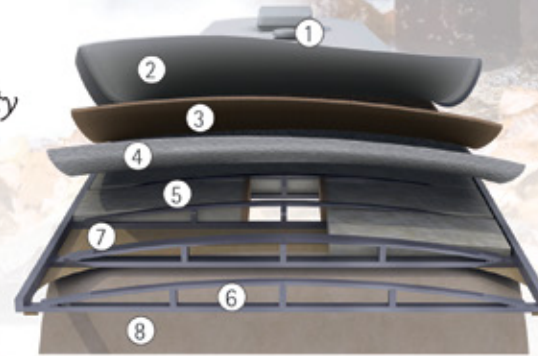

Attic Vent

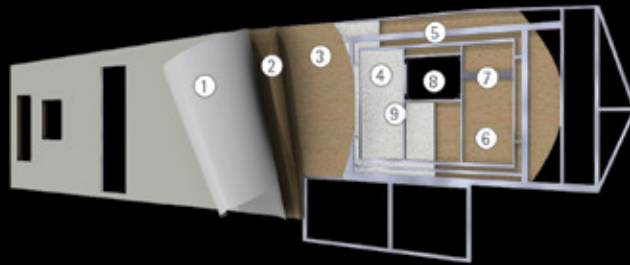

## Sidewall Construction (R-14)

- » 1. "Dura Gloss" Gel Coated Fiberglass
- » 2. First Layer of 1/8" Plywood
- » 3. Second Layer of 1/8" Plywood
- » 4. Hi Density EPS Foam
- » 5. Heavy Gauge Aluminum Framing
- » 6. Interior Layer of 1/8" Plywood Decor Board
- » 7. Strategically Placed Sheet Metal Backing Strips
- » 8. Aluminum Framed Window, Door, and Baggage Cut-Outs
- » 9. Radius Corner Blocks

## Floor Construction (R-52) \*

- » 1. 12" I Beam Powder Coated Frame (Most Models)
- » 2. Enclosed Underbelly
- » 3. Floor Vapor and Moisture Barrier Wrap
- » 4. Radiant Shield Technology (R-38)
- » 5. 1/8" Plywood
- » 6. 3" Heavy Gauge Aluminum Floor Joists
- » 7. 3" Hi-Density EPS Foam (R-14)
- » 8. 1/8" Plywood
- » 9. 5/8" One-Piece Floor Decking
- » 10. Residential Grade Carpet Pad
- » 11. Deep Pile Residential Grade Carpeting
- » 12. Enclosed and Heated Galley Water Lines
- » 13. In-Floor Straight Line Heat Ducting

\* R-Values calculated at 80° Ambient Temperature

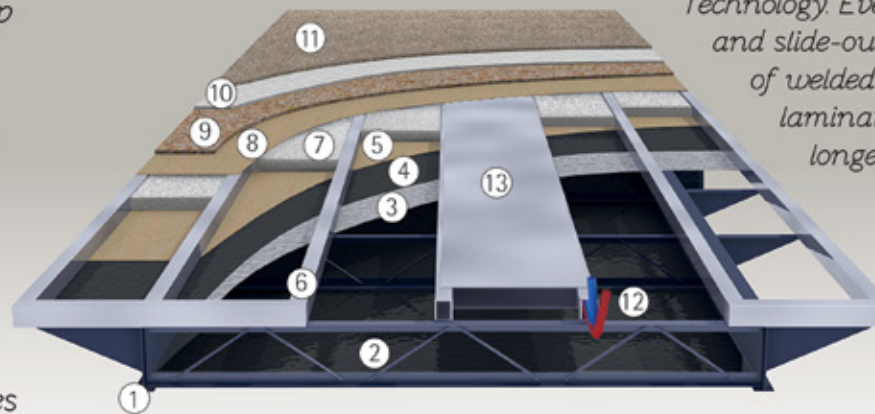

## ETERNABOND® Construction

Sanibel is built with Prime Time's ETERNABOND® Construction Technology. Every wall, floor and slide-out roof is made up of welded aluminum framework that is then laminated together in order to build a stronger, longer lasting Recreational Vehicle!





# HEATING & COOLING.

## *Intelligent Thermal Package!*



- » Tested at -13 Degrees
- » Heated, Enclosed Water Lines
- » Enclosed Underbelly
- » Heated Holding Tanks
- » 12 Volt Holding Tank Heat Pads

- » Radiant Shield Technology Wrapped Holding Tanks (R-38)
- » Double Layer of Fiberglass Insulation In Roof (R-14)
- » Radiant Shield Technology In Roof (R-38)
- » 3" Hi-Density EPS Foam in Main Floor (R-14)
- » Radiant Shield Technology Under Main Floor (R-38)

- » Double Layer of Fiberglass Insulation In End Walls (R-14)
- » Radiant Shield Technology In End Walls (R-38)
- » Insulated Slide Room Floors (R-38)
- » Insulated Bath and Bed Deck Floors (R-38)
- » Heated Pass Thru Storage
- » Heated Universal Docking Center
- » Dual Zone "Quiet Cool" Air Conditioners
- » Dual Attic Vents
- » 40,000 BTU Furnace



» Sanibel extends intelligent design to all parts of the fifth wheel including how the holding tanks are heated. Each tank is equipped with oversized ① 12 Volt heating pads for direct heat application. Every tank is then wrapped with ② Radiant Shield Technology (R-38) to help spread the heat over the tank surface while protecting it from cold exterior temperatures. This intelligent design ensures that ALL of your holding tanks are adequately protected while also ensuring that ALL of the heat from your furnace stays INSIDE your Sanibel to maximize your comfort. Unlike forced air applications, customers also appreciate that you can activate the heat pads during transit for additional protection.



R-Values calculated at 80° Ambient Temperature

# SUSPENSION.

## *Intelligent Suspension*



- » 1. 16" Aluminum Wheels
- » 2. Upgraded Radial Tires
- » 3. "E-Z LUBE" Axle Hubs
- » 4. Heavy Duty 8-Lug Hub Face
- » 5. "E-Z FLEX" Rubberized Suspension
- » 6. Eight Point "Wet" Bolt Assembly
- » 7. Heavy Duty Brass Bushing Assembly

**2 Year  
Warranty**  
DEXTER AXLE COMPANY



- » 8. Heavy Duty 1/2" Shackle Plates
- » 9. Heavy Duty Gas Shocks (4)
- » 10. Heavy Duty 7,000 lb. Axles



**2 YEAR  
WARRANTY**

Forest River's Optional 2 Year  
Warranty Included At No Charge!



Denver Mattress



Four Season Comfort Starts  
With A 40,000 BTU Furnace



The Pass-Thru Storage Is  
Extra Large and Heated



Stainless Steel Sink  
Sprayer and Faucet



Dual "Quiet Cool" Air Conditioners



Hydraulic Front Landing Gear  
Are Fast And Powerful  
(6 point Auto Leveling is optional)



Universal Docking Center Offers  
Amazing Convenience



30" Residential OTR Microwave  
Expands Your Cooking Options



Exterior Entertainment Center  
(TV not included)

# FLOORPLANS.

» *in-tel-li-gent*, adj. smart; clever; sensible or rational; showing or resulting from an ability to think and understand things clearly and logically.



3250



RESIDENTIAL 3251



3550



RESIDENTIAL 3551



3600



RESIDENTIAL 3601



3700



RESIDENTIAL 3701

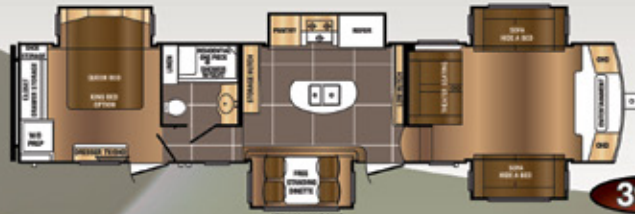

3900

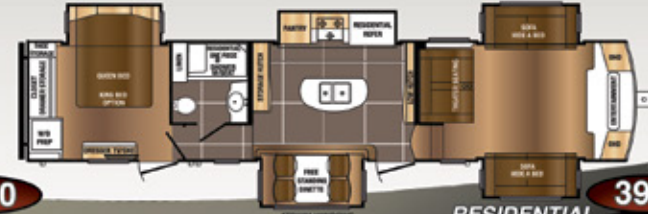

RESIDENTIAL 3901



**ADVANTAGE PACKAGE**

(\* \* MANDATORY)

ETERNABOND® Construction

- \* 2" Laminated Aluminum Framed Sidewalls
- \* 3" Laminated Aluminum Framed Main Floor
- \* 5/8" One-Piece Floor Decking
- \* Laminated Aluminum Framed Slide Room Walls And Roofs
- \* Welded Construction
- \* 100% Glue Coverage On All Laminated Parts
- \* EGS Backers In Walls And Floors

The Intelligent Thermal Package

- \* Tested At -13 Degrees
- \* Heated, Enclosed Water Lines
- \* Enclosed Underbelly
- \* Heated Holding Tanks
- \* 12 Volt Holding Tank Heat Pads
- \* Radiant Shield Technology Wrapped Holding Tanks (R-38)\*
- \* Double Layer Of Fiberglass Insulation In Roof (R-14)
- \* Radiant Shield Technology In Roof (R-38)\*
- \* 3" Hi-Density EPS Foam In Main Floor (R-14)
- \* Radiant Shield Technology Under Main Floor (R-38)\*
- \* Double Layer Of Fiberglass Insulation In End Walls (R-14)
- \* Radiant Shield Technology In End Walls (R-38)\*
- \* Insulated Slide Room Floors (R-38)\*
- \* Insulated Bath And Bed Deck Floors (R-38)\*
- \* Heated Pass Thru Storage
- \* Heated Universal Docking Center
- \* "DURA GLOSS" Fiberglass Sidewalls
- \* 15,000 BTU Premium Air Conditioner
- \* "Quiet Cool" Vented Return Air Ducting System
- \* 2nd A/C In Bedroom - "Quiet Cool" With Dual Zone Temperature Sensors
- \* 50 AMP (110) Power

Frameless Windows

The Intelligent Suspension

- \* "E-Z FLEX" Rubberized Suspension
- \* Heavy Duty Shock Absorbers
- \* 16" Aluminum Wheels
- \* 8 Lug Wheels
- \* Upgraded Radial Tires
- \* Eight Point Greasable "Wet" Bolts
- \* Long Lasting Brass Bushings
- \* Long Lasting 1/2" Shackles Plates
- \* 7,000 Pound Axles
- \* "E-Z LUBE" Greasable Axle Hubs

Exterior Entertainment

Center That Includes:

- \* Swing Arm TV Bracket
- \* Exterior AM/FM/CD Stereo With Speakers
- \* Coax TV Connection
- \* 110 V Electrical Outlet

Universal Docking Center That Includes:

- \* Outside Shower Flex Hose
- \* Black Tank Flush
- \* EZ Winterization Valve And Connection
- \* Easy Access Low Point Drains
- \* Low Point Drain Shut-Offs
- \* City Water Connection
- \* Battery Disconnect
- \* Separate Cable And Satellite Connection
- \* Holding Tank Gate Valve Pull Handles
- \* Light
- \* Ducted Heat
- \* No Mess Drain Tube

Electric Awning With LED Lights

Slam Latch Baggage Doors

With "Dura Gloss" Finish

Rear Back-Up Lights (Most Models)

Native American Glazed Cherry

Hardwood Cabinet Doors

Native American Glazed Cherry

Hardwood Drawers

12' SBS Refrigerator

20' Residential Refrigerator

(Residential Models Only)

30" OTR Microwave

Deluxe Range With Heavy Grates

LG Solid Surface Kitchen Countertop

LG Solid Surface Flush

Mount Sink Covers

Large LED Television

Residential Hide-A-Bed Sofa

Residential Recliners (Where Applicable)

Residential DVD Player With 5.1 Speakers

LED Bedroom TV

King Size Luxury Foam Pillowtop

Mattress (Most Models)

**CONSTRUCTION**

5" Truss Rafters, 16" On Center

3/8" Walk-On Roof Decking

One-Piece Rubber Roof

With 12 Year Warranty

Powder Coated I-Beam Frames

Drop Frame Storage Oversized Pass

Thru Storage With Intelligent Design

Pass Thru Luggage Tie Downs

"SUPER TURN" Aerodynamic

Fiberglass Front Cap

Automotive Styled Fiberglass

Rear Cap (Most Models)

Upgraded Oetiker Clamp Ring

Water Line Fittings

**UTILITIES**

Electric Rear Jacks

Hydraulic Front Landing Gear

"SOLID STANCE" Front Jack Legs

"SOLID STANCE" Oversized Landing Pads

Convenient Hydraulic Selector Valves

40,000 BTU Furnace

Digital Thermostat

10 Gallon Quick Recovery Water Heater

Direct Spark Ignition On Water Heater

Water Heater By-Pass

Hi-Capacity Water Pump

Detachable Power Cord

Large 12 Volt Converter

Washer/Dryer Prep

Dual 30# LP Bottles

CO Detector

LP Detector

Smoke Detector

Fire Extinguisher

Magnetic Baggage Door Catches

**Fresh Water Capacity - 64 Gallons**

**Black Water Capacity - 50 Gallons**

**Gray Water Capacity - 90 Gallons**

30" Wide Radius Entrance Door

Swing-Out Grab Handle

Hitch Cover

Digital Ready TV Antenna With Booster

Dual Vented Attic

Rear Back-Up Lights (Most Models)

2 Scare Lights

DOT Approved Deep Tint Safety Glass

Easy Access Fresh Water Drain Valve

Extra Large PVC Sewer Hose Storage

Extended Drip Spouts

**INTERIOR STANDARDS**

Baltic Birch Residential Drawer Boxes

The Intelligent Kitchen

\* High Arch Kitchen Faucet

With Sprayer

\* Stainless Steel Kitchen Sink

With Extra Deep Bowls

\* 13 Gallon Trash Can (Most Models)

\* Pots-N-Pans Drawer

\* Full Extension Drawer Guides

\* Large Easy-To-Pull Cabinet Pull Handles

Day/Night Shades In Living Area

Dinette With Leaf And Storage Drawer

(4) Dinette Chairs With Hidden Storage

"Atrium" Dinette Windows

Decorative "Space Saving"

Atrium Window Moldings

Laptop/Cell Phone Charging

Station At Dinette

**INTELLIGENT LIGHTING**

\* "Stay Cool" Adjustable LED

Reading Lights Above Sofa

\* "Stay Cool" Adjustable LED

Reading Lights Above Recliners

\* "Stay Cool" Adjustable LED

Reading Lights Above Bed

\* "Stay Cool" LED Ceiling Light Above Sofa

\* "Stay Cool" LED Vanity Light In Bath

\* Flush Mount LED Ceiling Lights

\* Easy-To-Reach Welcome Home Lighting

\* Safety Step Lights With

Illuminated Switch

**BATHROOM STANDARDS**

King Size Showers

Deluxe "Skyview" Skylight With

6"8" Of Headroom

"STOR MOR" Shower Caddy

Dual Lever Bath Faucet

Linen Cabinet

12V Power Vent Fan In Bath

Hi-Rise Porcelain Toilet

Heated Bathroom

**INTELLIGENT BEDROOM**

\* 30" Deep Bedroom Slide

Room (Most Models)

\* Massive Under-Bed Storage

\* Walk In Closet With Easy

Access Light Switch

\* Shoe Storage In Closet

\* Extra Wide Vanity With

Six Large Storage Drawers

\* Four Hidden Drawers In Front Cap

Decorative Bedroom Pillows

Stackable Washer/Dryer Prep

Solid Cherry Sliding Wardrobe Doors

Easy-To-Use Wardrobe Door

Travel Locks

Glass Bedroom Entrance Door

Cell Phone Charging Station

**OPTIONS**

Roto-Flex Pin Box

Dual Pane Windows

Slide Out Awnings

Fireplace

Generator Prep

Generator Install - Onan 5.5KW

Central Vacuum With 30' Hose

"LEVEL UP" 6 Point Auto Leveling System

Champagne High Gloss

Fiberglass (Mandatory)

\* \* Mandatory Effective 1/1/15

**Base Weight** - The weight of the unit with no fluids, cargo, optional equipment or accessories

**Carrying Capacity** - The amount of weight available for all fluids, cargo, optional equipment and accessories

**THE INTELLIGENT CHOICE!**

SPECIFICATIONS	3250	3251	3550	3551	3600	3601	3700	3701	3900	3901
Ship Weight	12,461	12,461	12,365	12,365	12,640	12,640	13,187	13,167	13,084	13,084
Carrying Capacity	2,980	2,980	3,076	3,076	2,801	2,801	2,254	2,254	2,357	2,357
Hitch Weight	2,472	2,472	2,432	2,432	2,390	2,335	2,311	2,311	2,649	2,649
Length	38' 4"	38' 4"	39' 2"	39' 2"	40' 2"	40' 2"	42' 2"	42' 2"	41' 10"	41' 10"
Height	13' 2"	13' 2"	13' 2"	13' 2"	13' 2"	13' 2"	13' 2"	13' 2"	13' 2"	13' 2"

**Sanibel**  
BY PIONEER TRAIL TRAILERS





# Sanibel FLOORPLANS.

## Traveler

FOR THE INTELLIGENT TRAVELER!

Prime Time Manufacturing is proud to introduce Sanibel Traveler - a luxury fifth wheel that exceeds your grandest desires for comfort and convenience while also meeting your full-timing needs and requirements. Our objective for the Sanibel Traveler is simple: create a luxury fifth wheel that employs lighter weight technologies with intelligent features that full-time Sanibel customers have come to love and expect. As an intelligent traveler, you will admire the

elegant exterior which features an aerodynamic, two-tone front cap, high gloss gel coat sidewalls and stylish frameless windows. Within minutes of entering, Sanibel Traveler will transform you. The interior is crafted around comfort, sight and convenience. Modern cabinetry, residential appointments, and rich textures create a sophisticated space of warmth and elegance. Sanibel Traveler is engineered and built to give you a GREAT camping experience!

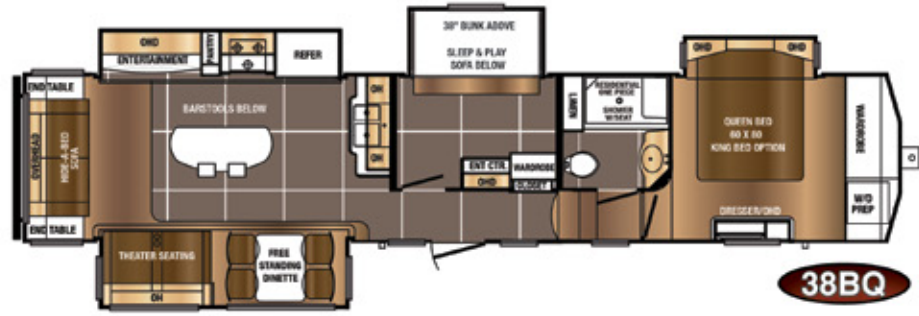

» (Above) The 33RS Kitchen and Entertainment Slide Features a Large TV, Fireplace and Huge Pantry.



» (Above) The Living Room in the 33RS showcases Stylish, Elegant and Comfortable Residential Furniture.



**SANIBEL TRAVELER SERIES**

**ADVANTAGE PACKAGE**

(\*\* MANDATORY)

**Exterior Features**

**ETERNABOND® Construction**

- \* Laminated Aluminum Framed Sidewalls (R-14)
- \* Laminated Aluminum Framed Main Floor (R-14)
- \* Laminated Aluminum Framed Slide-Out Walls And Roof
- \* Welded Construction
- \* 100% Glue Coverage On All Laminated Parts

**Universal Docking Center (UDC)**

- \* Heated With Ducting From Furnace
- \* Cable And Satellite Hook-Ups
- \* Black Tank Flush
- \* Battery Disconnect Switch
- \* Spray Port With Hot And Cold Water
- \* Coil Hose
- \* Simple Water Heater By-Pass Switch
- \* Simple Winterization Switch
- \* Simple Winterization Draw Line
- \* City Water Connection And Fresh Tank Gravity Fill

**Slam Latch Baggage Doors**

**Frameless Windows**

**Lighted Electric Awning**

**Two Tone "Super Turn" Front Cap**

**Magnetic Baggage Door Catches**

**30" Wide Entry Door**

**Spare Tire**

**Roof Ladder**

**Dexter "E-Z Flex" Rubberized Suspension**

**Upgraded "E" Rated Tires**

**16" Aluminum Wheels**

**50AMP Detachable Power Cord**

**Leak Guard Assurance**

**Interior Standards**

**Hardwood Cherry Cabinetry**

**LG Solid Surface Countertops**

**LG Solid Surface Sink Covers**

**High Rise Sprayer Faucet**

**Large Double Bowl Stainless Steel Sink**

**Fireplace**

**Central Vacuum**

**Residential Hide-A-Bed Sofa**

- Residential Recliners (Where Applicable)
- Residential Theater Seating (Where Applicable)
- Ever Rest Pillow-Top Memory Foam Mattress
- Deluxe (4) Door Side By Side Refrigerator
- 30" OTR Microwave Oven
- Large Oven
- Sony Surround Sound Home Theater System
- "One Touch" Electric Awning
- 15.0K "Quiet Cool" Air Conditioning System In Living Room
- 13.5K "Quiet Cool" Bedroom Air Conditioner
- Large LED Living Room TV
- Power Vent Fan In Kitchen Area
- 60AMP 12 Volt Converter
- Sanibel "PEACE OF MIND" 2 Year Warranty

**Thermal Package Features**

- Heated, Enclosed Water Lines
- Enclosed And Heated Underbelly
- Heated Holding Tanks
- 12 Volt Heat Pads On All Tanks
- Tanks Insulated And Wrapped With (R-38) Radiant Technology
- Enclosed Dump Valves
- Heated Dump Valves
- Radiant Technology (R-38) On Main Floor, Slide Out Floors And Front Cap
- Heated Pass Through Storage

**OPTIONAL EQUIPMENT**

- Generator Prep.
- Dual Pane Windows
- King Bed (IPO Queen)
- Ground Control Four Point Auto-Leveling (Mandatory)
- High Gloss Champagne Gel Coat Exterior (Mandatory)

\*\*Mandatory Effective 1/1/15

SPECIFICATIONS	33RS	38BQ
Ship Weight	11,415	12,913
Carrying Capacity	2,467	2,528
Hitch Weight	1,941	1,829
Length	36' 10"	42' 6"
Height	13' 2"	13' 2"
Fresh Water Capacity	64 Gal.	64 Gal.
Black Water Capacity	35 Gal.	35 Gal.
Gray Water Capacity	70 Gal.	70 Gal.



**Forest River's Optional 2 Year Warranty Included At No Charge!**



**Stainless Steel Sink Sprayer And Faucet.**

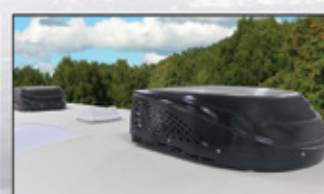

**Dual "Quiet Cool" Air Conditioners.**



**30" Residential OTR Microwave. Expands Your Cooking Options.**



**This one touch Auto Leveling System makes setting up your Sanibel Traveler quick and easy!**



**The Universal Docking Center Offers Amazing Convenience.**



**Dexter Axle "EZ Flex" Suspension Will Protect Your Valuable Investment From Rough Road Conditions.**



**Deep Tint Frameless Windows Highlight The Sanibels Sleek And Stylish Exterior.**



**\* R-52 Extreme Thermal Package Provides Superior Protection From The Outside Elements.**

\* R-Values calculated at 80° Ambient Temperature

**Base Weight** - The weight of the unit with no fluids, cargo, optional equipment or accessories

**Carrying Capacity** - The amount of weight available for all fluids, cargo, optional equipment and accessories

**Sanibel Traveler**





# DSI QUALITY CIRCLE AWARD WINNER -2010, 2011, 2012, 2013, 2014

Prime Time Manufacturing is proud to be recognized as an industry leader in value, reliability, and overall quality by the Recreational Vehicle Dealers Association. This was accomplished by committing ourselves to "A Higher Standard" in design, construction, testing, and customer service. Check us out - we know you'll be impressed!



Seal Tech Air Pressure Test



ETERNABOND Construction



Rain Bay



Seek-A-Leak Pressure Test



65 Point Secondary PDI



Web Based  
Customer Service



Executive Quality Audits



Advanced Engineering



24/7 EMERGENCY ROADSIDE ASSISTANCE

For a worry-free ownership experience Forest River includes one year of Coach-Net RV Technical & Roadside Assistance with each RV purchase. Whether new to the RV lifestyle or an experienced RV enthusiast, Forest River owners have 24/7 access to technical, operational and emergency road service coverage throughout the US & Canada. Coach-Net's fast, dependable service is just a phone call away.

**Coach-Net®**  
RV Technical & Roadside Assistance

www.primetimerv.com  
PO Box 330 • 55470 CR 1 • Elkhart, IN 46515



HERE'S JUST A SAMPLE OF THE BENEFITS\*

- ✓ Mobile Mechanic
- ✓ Free Jump Starts
- ✓ Tire Changes
- ✓ \$2000 Trip Interruption
- ✓ Appointment Assistance
- ✓ Lock Out Service
- ✓ Fuel Delivery
- ✓ Service Assistance
- ✓ Custom Trip Routing and Maps
- ✓ 24 Hour Emergency Messaging

\*Exclusions and restrictions apply. See member guide for details.

**FROG™ the Forest  
River Owners' Group!**



Forest River, Inc. encourages our customers to purchase their Forest River products from a local dealership whenever possible for the following reasons:

- 1) Forest River, Inc. dealers are independently owned and operated businesses so priority service and scheduling is at their discretion and is often provided to customers that purchased their unit at that dealership.
- 2) Purchasing locally allows customers to establish meaningful relationships with a dealer, enhancing the RV experience through assistance with product questions, user tips or RV regulations for your state or country, and much more!
- 3) Canadian customers must meet requirements to bring an RV purchased out of the country to their home. These requirements may involve additional inspections and certifications, taxes and fees. Your local Canadian Dealer is a professional at meeting these requirements.
- 4) Scheduling timely warranty repairs and adjustments through a local dealership provides far greater flexibility and convenience to you, the customer!

It is the goal of Forest River, Inc. that all of our RV owners fully enjoy the RV experience and that customer satisfaction meets or exceeds their expectations!

All information contained in this brochure is believed to be accurate at the time of publication. However, during the model year, it may be necessary to make revisions and Forest River, Inc., reserves the right to make all such changes without notice, including prices, colors, materials, equipment and specifications as well as the addition of new models and the discontinuance of models shown in this brochure. Therefore, please consult with your Forest River, Inc., dealer and confirm the existence of any materials, design or specifications that are material to your purchase decision.

© 2014 Prime Time Manufacturing  
A Division Of Forest River, Inc.,  
A Berkshire Hathaway Company.  
All Rights Reserved



Learn More  
Scan this barcode using a QR Reader on your smart phone to learn more about Forest River.



DEALER